

Siemens  
EcoTech



Circuit breaker size S00 for starter combination rated current 16 A N-release 208 A screw terminal Standard switching capacity



|   |                          |
|---|--------------------------|
| product brand name  | SIRIUS                   |
| product designation   | Circuit breaker          |
| design of the product   | For starter combinations |
| product type designation  | 3RV2                     |
| General technical data  |                          |
| size of the circuit-breaker                                     | S00                      |
| size of contactor can be combined company-specific              | S00, S0                  |
| product extension auxiliary switch                              | Yes                      |
| power loss [W] for rated value of the current                   |                          |
| • at AC in hot operating state                                  | 9.25 W                   |
| • at AC in hot operating state per pole                         | 3.1 W                    |
| insulation voltage with degree of pollution 3 at AC rated value | 690 V                    |
| surge voltage resistance rated value                            | 6 kV                     |
| shock resistance according to IEC 60068-2-27                    | 25g / 11 ms              |
| mechanical service life (operating cycles)                      |                          |
| • of the main contacts typical                                  | 100 000                  |
| • of auxiliary contacts typical                                 | 100 000                  |
| electrical endurance (operating cycles) typical                 | 100 000                  |
| reference code according to IEC 81346-2                         | Q                        |
| Substance Prohibitance (Date)                                   | 10/01/2009               |
| Weight  | 0.37 kg                  |
| Ambient conditions  |                          |
| installation altitude at height above sea level maximum         | 2 000 m                  |
| ambient temperature   |                          |
| • during operation  | -20 ... +60 °C           |
| • during storage  | -50 ... +80 °C           |
| • during transport  | -50 ... +80 °C           |
| relative humidity during operation                              | 10 ... 95 %              |
| Environmental footprint   |                          |
| Siemens Eco Profile (SEP)                                       | Siemens EcoTech          |
| Main circuit  |                          |
| number of poles for main current circuit                        | 3                        |
| type of voltage for main current circuit                        | AC                       |
| operating voltage   |                          |
| • rated value   | 20 ... 690 V             |
| • at AC-3 rated value maximum                                   | 690 V                    |
| • at AC-3e rated value maximum                                  | 690 V                    |

|  |              |
|--|--------------|
| <b>operating frequency rated value</b>   | 50 ... 60 Hz |
| <b>operational current rated value</b>   | 16 A         |
| <b>operational current</b>   |              |
| • at AC-3 at 400 V rated value   | 16 A         |
| • at AC-3e at 400 V rated value  | 16 A         |
| <b>operating power</b>   |              |
| • at AC-3  |              |
| — at 230 V rated value   | 4 kW         |
| — at 400 V rated value   | 7.5 kW       |
| — at 500 V rated value   | 7.5 kW       |
| — at 690 V rated value   | 11 kW        |
| • at AC-3e   |              |
| — at 230 V rated value   | 4 kW         |
| — at 400 V rated value   | 7.5 kW       |
| — at 500 V rated value   | 7.5 kW       |
| — at 690 V rated value   | 11 kW        |
| <b>operating frequency</b>   |              |
| • at AC-3 maximum  | 15 1/h       |
| • at AC-3e maximum   | 15 1/h       |
| <b>Auxiliary circuit</b>   |              |
| <b>type of voltage for auxiliary and control circuit</b>                                       | AC/DC        |
| <b>number of NC contacts for auxiliary contacts</b>  | 0            |
| <b>number of NO contacts for auxiliary contacts</b>  | 0            |
| number of CO contacts for auxiliary contacts   | 0            |
| <b>Protective and monitoring functions</b>   |              |
| <b>product function</b>  |              |
| • ground fault detection   | No           |
| • phase failure detection  | No           |
| <b>maximum short-circuit current breaking capacity (I<sub>cu</sub>)</b>                        |              |
| • at AC at 240 V rated value   | 100 kA       |
| • at AC at 400 V rated value   | 55 kA        |
| • at AC at 500 V rated value   | 10 kA        |
| • at AC at 690 V rated value   | 4 kA         |
| <b>operating short-circuit current breaking capacity (I<sub>cs</sub>) at AC</b>                |              |
| • at 240 V rated value   | 100 kA       |
| • at 400 V rated value   | 30 kA        |
| • at 500 V rated value   | 5 kA         |
| • at 690 V rated value   | 2 kA         |
| response value current of instantaneous short-circuit trip unit                                | 208 A        |
| <b>UL/CSA ratings</b>  |              |
| <b>full-load current (FLA) for 3-phase AC motor</b>  |              |
| • at 480 V rated value   | 16 A         |
| • at 600 V rated value   | 16 A         |
| <b>yielded mechanical performance [hp]</b>   |              |
| • for single-phase AC motor  |              |
| — at 110/120 V rated value   | 1 hp         |
| — at 230 V rated value   | 2 hp         |
| • for 3-phase AC motor   |              |
| — at 200/208 V rated value   | 3 hp         |
| — at 220/230 V rated value   | 5 hp         |
| — at 460/480 V rated value   | 10 hp        |
| <b>Short-circuit protection</b>  |              |
| <b>product function short circuit protection</b>   | Yes          |
| <b>design of the short-circuit trip</b>  | magnetic     |
| <b>design of the fuse link for IT network for short-circuit protection of the main circuit</b> |              |
| • at 240 V   | gL/gG 80 A   |
| • at 400 V   | gL/gG 63 A   |
| • at 500 V   | gL/gG 50 A   |
| • at 690 V   | gL/gG 40 A   |
| <b>Installation/ mounting/ dimensions</b>  |              |

|  |  |
|--|--|
| <b>mounting position</b>   | any  |
| <b>fastening method</b>  | screw and snap-on mounting onto 35 mm DIN rail according to DIN EN 60715 |
| <b>height</b>  | 97 mm  |
| <b>width</b>   | 45 mm  |
| <b>depth</b>   | 97 mm  |
| <b>required spacing</b>  |  |
| • with side-by-side mounting at the side                             | 0 mm   |
| • for grounded parts at 400 V  |  |
| — downwards  | 30 mm  |
| — upwards  | 30 mm  |
| — at the side  | 9 mm   |
| • for live parts at 400 V  |  |
| — downwards  | 30 mm  |
| — upwards  | 30 mm  |
| — at the side  | 9 mm   |
| • for grounded parts at 500 V  |  |
| — downwards  | 30 mm  |
| — upwards  | 30 mm  |
| — at the side  | 9 mm   |
| • for live parts at 500 V  |  |
| — downwards  | 30 mm  |
| — upwards  | 30 mm  |
| — at the side  | 9 mm   |
| • for grounded parts at 690 V  |  |
| — downwards  | 50 mm  |
| — upwards  | 50 mm  |
| — backwards  | 0 mm   |
| — at the side  | 30 mm  |
| — forwards   | 0 mm   |
| • for live parts at 690 V  |  |
| — downwards  | 50 mm  |
| — upwards  | 50 mm  |
| — backwards  | 0 mm   |
| — at the side  | 30 mm  |
| — forwards   | 0 mm   |
| <b>Connections/ Terminals</b>  |  |
| <b>type of electrical connection</b>                                 |  |
| • for main current circuit   | screw-type terminals   |
| <b>arrangement of electrical connectors for main current circuit</b> | Top and bottom   |
| <b>type of connectable conductor cross-sections</b>                  |  |
| • for main contacts  |  |
| — solid or stranded  | 2x (0,75 ... 2,5 mm <sup>2</sup> ), 2x 4 mm <sup>2</sup>                 |
| — finely stranded with core end processing                           | 2x (0.5 ... 1.5 mm <sup>2</sup> ), 2x (0.75 ... 2.5 mm <sup>2</sup> )    |
| • for AWG cables for main contacts                                   | 2x (18 ... 14), 2x 12  |
| <b>tightening torque</b>   |  |
| • for main contacts with screw-type terminals                        | 0.8 ... 1.2 N·m  |
| <b>design of screwdriver shaft</b>                                   | Diameter 5 to 6 mm   |
| <b>size of the screwdriver tip</b>                                   | Pozidriv size 2  |
| <b>design of the thread of the connection screw</b>                  |  |
| • for main contacts  | M3   |
| <b>Safety related data</b>   |  |
| product function suitable for safety function                        | Yes  |
| <b>suitability for use</b>   |  |
| • safety-related switching on  | No   |
| • safety-related switching OFF                                       | Yes  |
| <b>service life maximum</b>  | 10 a   |
| <b>test wear-related service life necessary</b>                      | Yes  |
| <b>proportion of dangerous failures</b>                              |  |
| • with low demand rate according to SN 31920                         | 40 %   |
| • with high demand rate according to SN 31920                        | 50 %   |

|  |  |
|--|--|
| B10 value with high demand rate according to SN 31920  | 5 000  |
| failure rate [FIT] with low demand rate according to SN 31920  | 50 FIT   |
| ISO 13849  |  |
| device type according to ISO 13849-1   | 3  |
| overdimensioning according to ISO 13849-2 necessary  | Yes  |
| IEC 61508  |  |
| safety device type according to IEC 61508-2  | Type A   |
| T1 value   | 10 a   |
| <ul style="list-style-type: none"> <li>for proof test interval or service life according to IEC 61508</li> </ul> |  |
| Electrical Safety  |  |
| protection class IP on the front according to IEC 60529  | IP20   |
| touch protection on the front according to IEC 60529   | finger-safe, for vertical contact from the front |
| Display  |  |
| display version for switching status   | Handle   |
| Approvals Certificates   |  |
| General Product Approval   |  |



[KC](#)



|                          |                   |                      |
|--------------------------|-------------------|----------------------|
| General Product Approval | Test Certificates | Maritime application |
|--------------------------|-------------------|----------------------|



[Type Test Certificates/Test Report](#)

[Special Test Certificate](#)



|                      |       |
|----------------------|-------|
| Maritime application | other |
|----------------------|-------|



[Miscellaneous](#)



[Confirmation](#)

|       |         |             |
|-------|---------|-------------|
| other | Railway | Environment |
|-------|---------|-------------|



[Special Test Certificate](#)

[Confirmation](#)



[Environmental Conformations](#)

#### Further information

Information on the packaging

<https://support.industry.siemens.com/cs/ww/en/view/109813875>

Information for data generation and storage

<https://support.industry.siemens.com/cs/ww/en/view/109995012>

Information- and Downloadcenter (Catalogs, Brochures,...)

<https://www.siemens.com/ic10>

Industry Mall (Online ordering system)

<https://mall.industry.siemens.com/mall/en/en/Catalog/product?mlfb=3RV2311-4AC10>

Cax online generator

<http://support.automation.siemens.com/WW/CAXorder/default.aspx?lang=en&mlfb=3RV2311-4AC10>

Service&Support (Manuals, Certificates, Characteristics, FAQs,...)

<https://support.industry.siemens.com/cs/ww/en/ps/3RV2311-4AC10>

Image database (product images, 2D dimension drawings, 3D models, device circuit diagrams, EPLAN macros, ...)

[http://www.automation.siemens.com/bilddb/cax\\_de.aspx?mlfb=3RV2311-4AC10&lang=en](http://www.automation.siemens.com/bilddb/cax_de.aspx?mlfb=3RV2311-4AC10&lang=en)

Characteristic: Tripping characteristics, I<sub>t</sub>, Let-through current

<https://support.industry.siemens.com/cs/ww/en/ps/3RV2311-4AC10/char>

Further characteristics (e.g. electrical endurance, switching frequency)

<http://www.automation.siemens.com/bilddb/index.aspx?view=Search&mlfb=3RV2311-4AC10&objecttype=14&gridview=view1>

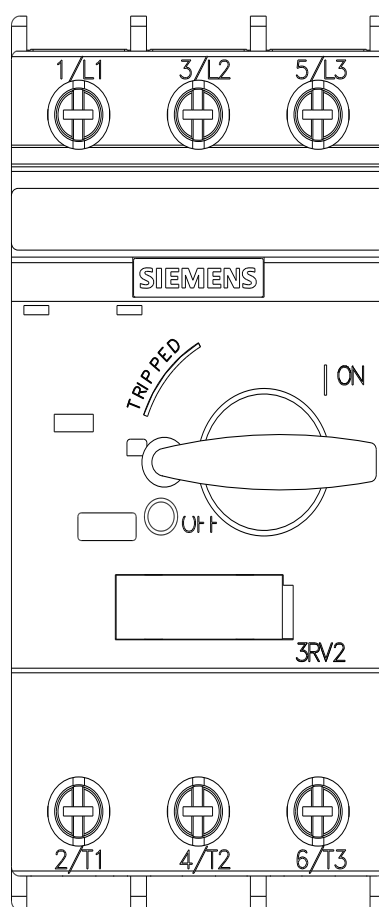
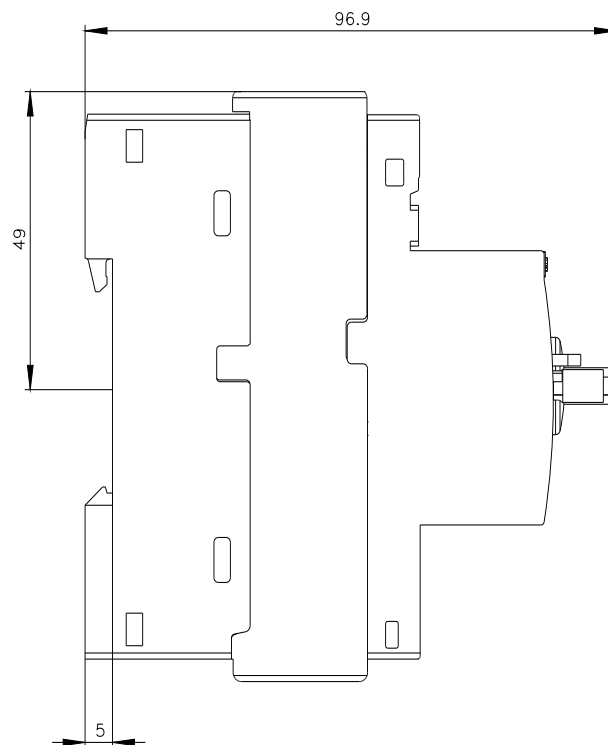



last modified:

5/17/2025