

NOTE:  
1. The parts have no obvious indentation, remove burrs, and blunt at acute angles  
2. After spraying, the parts are smooth and clean, without appearance defects such as leakage bottom  
3. The silk screen must be clear and free of rough edges

2		A1	Support Panel	SPCC	1	Nickel Plating
1		A1	Front Panel	SPCC	1	Nickel Plating
ITEM	DRAWING	REV	DESCRIPTION	MATERIAL	QTY.	NOTE

ProLabs					
MAT'L		PRODUCT NO.	C-PPST-48PTKSC6AS1U		
UNITS	mm	PRODUCT NAME	19-inch Shielded Cat6A 48-Port Straight 1U Patch Panel with Removable tool-less Keystone Sections		
SCALE	1:1	DRAWING NO.			
TYPE OF PROJECTION			SHEET 1 OF 1	REV	

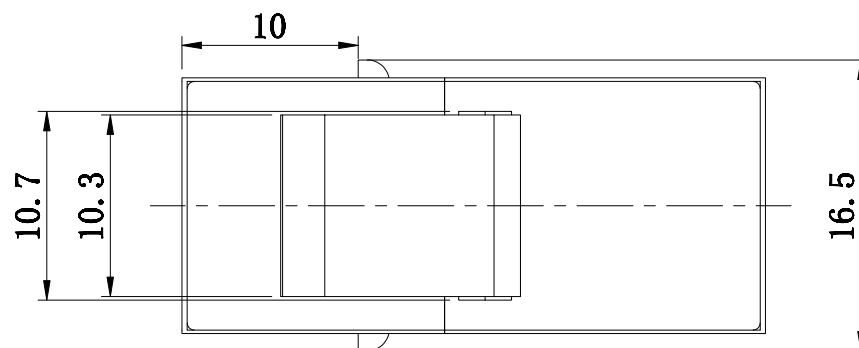
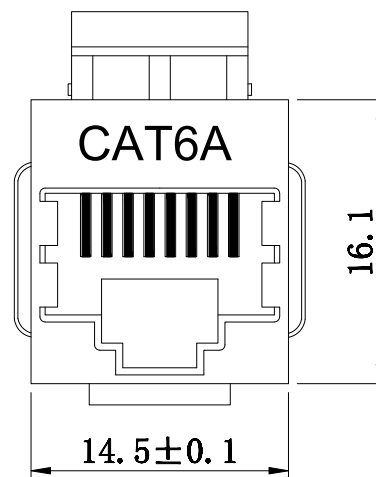
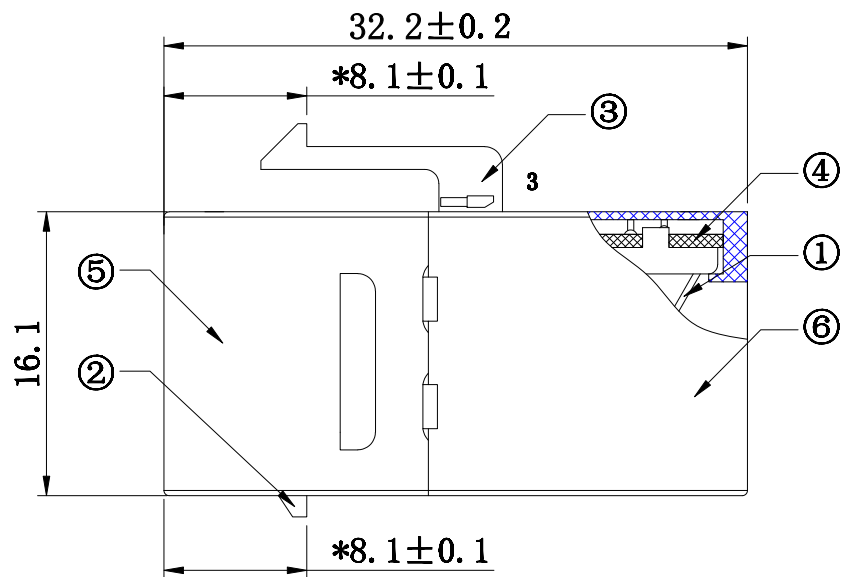

#### Material

1. RJ45 In-Line Coupler: PC +Brass nickel plated
2. RJ45 In-Line Coupler Contact:  
Phosphor Brone, 50U"gold planting

#### Performance:

- a. T568A & T568B wiring sticker.
- b. Meet ISO/IEC 11801 and EN50173
- c. Meet ANSI/TIA/EIA 568B.2

 ProLabs

MATERIAL	UNIT	MM	SCALE	1:1
DIMENSIONAL TOLERANCE	THIRD ANGLE PROJECTION	DRAWN	CHECK	APPROVAL
X.X	$\pm 0.3$			
X.XX	$\pm 0.10$			
X.XXX	$\pm 0.050$			
ANGLE	1°			