

1462724

<https://www.phoenixcontact.com/us/products/1462724>

Please be informed that the data shown in this PDF document is generated from our online catalog. Please find the complete data in the user documentation. Our general terms of use for downloads are valid.

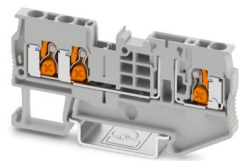

Your advantages

- The compact design and front connection enable wiring in a confined space<br/>
- In addition to the testing option in the double function shaft, all terminal blocks provide an additional test pick-off

Commercial data

Item number	1462724
Packing unit	50 pc
Minimum order quantity	50 pc
Sales key	BE25
Product key	BE2532
GTIN	4063151852160
Weight per piece (including packing)	9.94 g
Weight per piece (excluding packing)	9.94 g
Customs tariff number	85369010
Country of origin	CN

# XT 2,5-TWIN-TG - Disconnect terminal block



1462724

<https://www.phoenixcontact.com/us/products/1462724>

## Technical data

### Notes

#### General

Note	Current and voltage are determined by the plug used
------	---

### Product properties

Product type	Disconnect terminal block
Number of positions	1
Number of connections	3
Number of rows	1

#### Insulation characteristics

Overvoltage category	III
Degree of pollution	3

### Electrical properties

Rated surge voltage	6 kV
Maximum power dissipation for nominal condition	0.77 W

### Connection data

Number of connections per level	3
Nominal cross section	2.5 mm <sup>2</sup>
Connection method	Push-X-connection
Stripping length	10 mm ... 12 mm
Internal cylindrical gage	A3
Connection in acc. with standard	IEC 60947-7-1
Conductor cross-section rigid	0.5 mm <sup>2</sup> ... 4 mm <sup>2</sup>
Cross section AWG	20 ... 12 (converted acc. to IEC)
Conductor cross-section flexible	0.75 mm <sup>2</sup> ... 4 mm <sup>2</sup>
Conductor cross-section, flexible [AWG]	20 ... 12 (converted acc. to IEC)
Conductor cross-section flexible ultrasound-compressed	0.34 mm <sup>2</sup> ... 4 mm <sup>2</sup>
Conductor cross-section, flexible [AWG] ultrasound-compressed	22 ... 12 (converted acc. to IEC)
Conductor cross-section flexible (ferrule without plastic sleeve)	0.5 mm <sup>2</sup> ... 2.5 mm <sup>2</sup>
Flexible conductor cross-section (ferrule with plastic sleeve)	0.5 mm <sup>2</sup> ... 2.5 mm <sup>2</sup>
Nominal current	20 A
Maximum load current	20 A (with 4 mm <sup>2</sup> conductor cross-section, rigid)
Nominal voltage	500 V
Nominal cross section	2.5 mm <sup>2</sup>

### Dimensions

Width	5.2 mm
End cover width	2.2 mm
Height	73.7 mm

# XT 2,5-TWIN-TG - Disconnect terminal block



1462724

<https://www.phoenixcontact.com/us/products/1462724>

Depth	35.3 mm
Depth on NS 35/7,5	36.8 mm
Depth on NS 35/15	44.3 mm

## Material specifications

Color	gray (RAL 7042)
Flammability rating according to UL 94	V0
Insulating material group	I
Insulating material	PA
Static insulating material application in cold	-60 °C
Relative insulation material temperature index (Elec., UL 746 B)	130 °C
Fire protection for rail vehicles (DIN EN 45545-2) R22	HL 1 - HL 3
Fire protection for rail vehicles (DIN EN 45545-2) R23	HL 1 - HL 3
Fire protection for rail vehicles (DIN EN 45545-2) R24	HL 1 - HL 3
Fire protection for rail vehicles (DIN EN 45545-2) R26	HL 1 - HL 3
Surface flammability NFPA 130 (ASTM E 162)	passed
Specific optical density of smoke NFPA 130 (ASTM E 662)	passed
Smoke gas toxicity NFPA 130 (SMP 800C)	passed

## Electrical tests

### Surge voltage test

Test voltage setpoint	7.3 kV
Result	Test passed

### Temperature-rise test

Requirement temperature-rise test	Increase in temperature $\leq 45$ K
Result	Test passed
Result	Test passed

### Power-frequency withstand voltage

Test voltage setpoint	1.89 kV
Result	Test passed

## Mechanical properties

### Mechanical data

Open side panel	Yes
-----------------	-----

## Mechanical tests

### Mechanical strength

Result	Test passed
--------	-------------

### Attachment on the carrier

DIN rail/fixing support	NS 35
Result	Test passed

# XT 2,5-TWIN-TG - Disconnect terminal block



1462724

<https://www.phoenixcontact.com/us/products/1462724>

## Test for conductor damage and slackening

Rotation speed	9 rpm
Revolutions	135
Conductor cross-section/weight	0.5 mm <sup>2</sup> / 0.3 kg
	2.5 mm <sup>2</sup> / 0.7 kg
	4 mm <sup>2</sup> / 0.9 kg
Result	Test passed

## Environmental and real-life conditions

### Aging

Temperature cycles	192
Result	Test passed

### Needle-flame test

Time of exposure	30 s
Result	Test passed

### Oscillation/broadband noise

Specification	DIN EN 50155 (VDE 0115-200):2022-06
Spectrum	Long life test category 1, class B, body mounted
Frequency	$f_1 = 5 \text{ Hz}$ to $f_2 = 150 \text{ Hz}$
ASD level	0.964 (m/s <sup>2</sup> ) <sup>2</sup> /Hz
Acceleration	0.58g
Test duration per axis	5 h
Test directions	X-, Y- and Z-axis
Result	Test passed

### Shocks

Specification	DIN EN 50155 (VDE 0115-200):2022-06
Pulse shape	Half-sine
Acceleration	5g
Shock duration	30 ms
Number of shocks per direction	3
Test directions	X-, Y- and Z-axis (pos. and neg.)
Result	Test passed

### Ambient conditions

Ambient temperature (operation)	-60 °C ... 110 °C (Operating temperature range incl. self-heating; for max. short-term operating temperature, see RTI Elec.)
Ambient temperature (storage/transport)	-25 °C ... 60 °C (for a short time, not exceeding 24 h, -60 °C to +70 °C)
Ambient temperature (assembly)	-5 °C ... 70 °C
Ambient temperature (actuation)	-5 °C ... 70 °C
Permissible humidity (operation)	20 % ... 90 %
Permissible humidity (storage/transport)	30 % ... 70 %

# XT 2,5-TWIN-TG - Disconnect terminal block



1462724

<https://www.phoenixcontact.com/us/products/1462724>

## Standards and regulations

Connection in acc. with standard	IEC 60947-7-1
----------------------------------	---------------

## Mounting

Mounting type	NS 35/7,5
	NS 35/15

# XT 2,5-TWIN-TG - Disconnect terminal block



1462724

<https://www.phoenixcontact.com/us/products/1462724>

## Drawings

Circuit diagram



# XT 2,5-TWIN-TG - Disconnect terminal block





1462724

<https://www.phoenixcontact.com/us/products/1462724>

## Approvals

To download certificates, visit the product detail page: <https://www.phoenixcontact.com/us/products/1462724>

 <b>CSA</b> Approval ID: 2030668				
	Nominal voltage $U_N$	Nominal current $I_N$	Cross section AWG	Cross section $\text{mm}^2$
B				
	300 V	20 A	20 - 12	-
C				
	300 V	20 A	20 - 12	-
D				
	600 V	5 A	20 - 12	-

 <b>cULus Recognized</b> Approval ID: E60425				
	Nominal voltage $U_N$	Nominal current $I_N$	Cross section AWG	Cross section $\text{mm}^2$
B				
	300 V	20 A	20 - 12	-
C				
	300 V	20 A	20 - 12	-
F				
	500 V	20 A	20 - 12	-
D				
	600 V	5 A	20 - 12	-

# XT 2,5-TWIN-TG - Disconnect terminal block



1462724

<https://www.phoenixcontact.com/us/products/1462724>

## Classifications

### ECLASS

ECLASS-13.0	27250108
ECLASS-15.0	27250108

### ETIM

ETIM 9.0	EC000902
----------	----------

### UNSPSC

UNSPSC 21.0	39121400
-------------	----------

# XT 2,5-TWIN-TG - Disconnect terminal block



1462724

<https://www.phoenixcontact.com/us/products/1462724>

## Environmental product compliance

EU RoHS	
Fulfills EU RoHS substance requirements	Yes, No exemptions
China RoHS	
Environment friendly use period (EFUP)	EFUP-E
	No hazardous substances above the limits
EU REACH SVHC	
REACH candidate substance (CAS No.)	No substance above 0.1 wt%

# XT 2,5-TWIN-TG - Disconnect terminal block



1462724

<https://www.phoenixcontact.com/us/products/1462724>

## Accessories



Note: Applying some accessories below might limit this product.

### FBS 2-5 - Plug-in bridge

3030161

<https://www.phoenixcontact.com/us/products/3030161>



Max. current carrying capacity: 20 A



### FBS 3-5 - Plug-in bridge

3030174

<https://www.phoenixcontact.com/us/products/3030174>



Max. current carrying capacity: 20 A



# XT 2,5-TWIN-TG - Disconnect terminal block



1462724

<https://www.phoenixcontact.com/us/products/1462724>

## FBS 4-5 - Plug-in bridge

3030187

<https://www.phoenixcontact.com/us/products/3030187>



Plug-in bridge, pitch: 5.2 mm, number of positions: 4, length: 23 mm, color: red

 Max. current carrying capacity: 20 A

---

## FBS 5-5 - Plug-in bridge

3030190

<https://www.phoenixcontact.com/us/products/3030190>



 Max. current carrying capacity: 20 A

# XT 2,5-TWIN-TG - Disconnect terminal block



1462724

<https://www.phoenixcontact.com/us/products/1462724>

## FBS 10-5 - Plug-in bridge

3030213

<https://www.phoenixcontact.com/us/products/3030213>

 Max. current carrying capacity: 20 A



---

## FBS 20-5 - Plug-in bridge

3030226

<https://www.phoenixcontact.com/us/products/3030226>

 Max. current carrying capacity: 20 A



# XT 2,5-TWIN-TG - Disconnect terminal block



1462724

<https://www.phoenixcontact.com/us/products/1462724>

## FBS 50-5 - Plug-in bridge

3038930

<https://www.phoenixcontact.com/us/products/3038930>

 Max. current carrying capacity: 20 A



---

## FBSR 2-5 - Plug-in bridge

3033702

<https://www.phoenixcontact.com/us/products/3033702>

 Max. current carrying capacity: 17.5 A



# XT 2,5-TWIN-TG - Disconnect terminal block



1462724

<https://www.phoenixcontact.com/us/products/1462724>

## FBSR 3-5 - Plug-in bridge

3001591

<https://www.phoenixcontact.com/us/products/3001591>

 Max. current carrying capacity: 17.5 A



---

## FBSR 4-5 - Plug-in bridge

3001592

<https://www.phoenixcontact.com/us/products/3001592>

 Max. current carrying capacity: 17.5 A



# XT 2,5-TWIN-TG - Disconnect terminal block



1462724

<https://www.phoenixcontact.com/us/products/1462724>

## FBSR 5-5 - Plug-in bridge

3001593

<https://www.phoenixcontact.com/us/products/3001593>

 Max. current carrying capacity: 17.5 A



---

## FBSR 10-5 - Plug-in bridge

3033710

<https://www.phoenixcontact.com/us/products/3033710>

 Max. current carrying capacity: 17.5 A



# XT 2,5-TWIN-TG - Disconnect terminal block



1462724

<https://www.phoenixcontact.com/us/products/1462724>

## FBS 2-5 BU - Plug-in bridge

3036877

<https://www.phoenixcontact.com/us/products/3036877>

 Max. current carrying capacity: 20 A



---

## FBS 3-5 BU - Plug-in bridge

3036880

<https://www.phoenixcontact.com/us/products/3036880>

 Max. current carrying capacity: 20 A



# XT 2,5-TWIN-TG - Disconnect terminal block



1462724

<https://www.phoenixcontact.com/us/products/1462724>

## FBS 4-5 BU - Plug-in bridge

3036893

<https://www.phoenixcontact.com/us/products/3036893>

 Max. current carrying capacity: 20 A



---

## FBS 5-5 BU - Plug-in bridge

3036903

<https://www.phoenixcontact.com/us/products/3036903>

 Max. current carrying capacity: 20 A



# XT 2,5-TWIN-TG - Disconnect terminal block



1462724

<https://www.phoenixcontact.com/us/products/1462724>

## FBS 10-5 BU - Plug-in bridge

3036916

<https://www.phoenixcontact.com/us/products/3036916>

 Max. current carrying capacity: 20 A



---

## FBS 20-5 BU - Plug-in bridge

3036929

<https://www.phoenixcontact.com/us/products/3036929>

 Max. current carrying capacity: 20 A



# XT 2,5-TWIN-TG - Disconnect terminal block



1462724

<https://www.phoenixcontact.com/us/products/1462724>

## FBS 50-5 BU - Plug-in bridge

3032114

<https://www.phoenixcontact.com/us/products/3032114>

 Max. current carrying capacity: 20 A

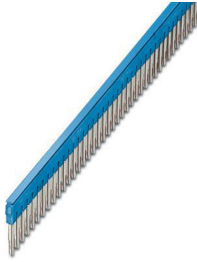

---

## RB ST (2,5/4)-1,5/S - Reducing bridge

3214356

<https://www.phoenixcontact.com/us/products/3214356>

 Max. current carrying capacity: 24 A



# XT 2,5-TWIN-TG - Disconnect terminal block



1462724

<https://www.phoenixcontact.com/us/products/1462724>

## RB ST 6-(2,5/4) - Reducing bridge

3030860

<https://www.phoenixcontact.com/us/products/3030860>

 Max. current carrying capacity: 35 A



---

## RB ST 10-(2,5/4) - Reducing bridge

3030873

<https://www.phoenixcontact.com/us/products/3030873>

 Max. current carrying capacity: 35 A



# XT 2,5-TWIN-TG - Disconnect terminal block



1462724

<https://www.phoenixcontact.com/us/products/1462724>

## RB ST 16-(2,5/4) - Reducing bridge

3030886

<https://www.phoenixcontact.com/us/products/3030886>

 Max. current carrying capacity: 35 A



---

## RB ST 35-(2,5/4) - Reducing bridge

3030899

<https://www.phoenixcontact.com/us/products/3030899>

 Max. current carrying capacity: 35 A



# XT 2,5-TWIN-TG - Disconnect terminal block



1462724

<https://www.phoenixcontact.com/us/products/1462724>

## RB ST (2,5/4)-1,5 - Reducing bridge

3038943

<https://www.phoenixcontact.com/us/products/3038943>

 Max. current carrying capacity: 24 A



---

## RB UT 6-ST(2,5/4) - Reducing bridge

3047264

<https://www.phoenixcontact.com/us/products/3047264>

 Max. current carrying capacity: 35 A



# XT 2,5-TWIN-TG - Disconnect terminal block



1462724

<https://www.phoenixcontact.com/us/products/1462724>

## RB UT 35-ST(2,5/4) - Reducing bridge

3047280

<https://www.phoenixcontact.com/us/products/3047280>

 Max. current carrying capacity: 40 A



---

## RB UT 10-ST(2,5/4) - Reducing bridge

3047086

<https://www.phoenixcontact.com/us/products/3047086>

 Max. current carrying capacity: 40 A



# XT 2,5-TWIN-TG - Disconnect terminal block



1462724

<https://www.phoenixcontact.com/us/products/1462724>

## RB UT 16-ST(2,5/4) - Reducing bridge

3047099

<https://www.phoenixcontact.com/us/products/3047099>

 Max. current carrying capacity: 40 A



---

## RB PTPower 35-ST(2,5/4) - Reducing bridge

3030900

<https://www.phoenixcontact.com/us/products/3030900>



Reducing bridge, for bridging of PTPower 35 to ST or PT ...N terminal blocks with nominal cross section of 2.5 mm<sup>2</sup> and 4 mm<sup>2</sup>, pitch: 10.8 mm, number of positions: 2, length: 5 mm, color: red

## XT 2,5-TWIN-TG - Disconnect terminal block

1462724

<https://www.phoenixcontact.com/us/products/1462724>



## ATP-ST QUATTRO - Partition plate

3030815

<https://www.phoenixcontact.com/us/products/3030815>



---

## D-PT 2,5-TWIN-MT - End cover

3211317

<https://www.phoenixcontact.com/us/products/3211317>

End cover, depth: 29.1 mm, width: 2.2 mm, height: 73.7 mm, color: gray



## XT 2,5-TWIN-TG - Disconnect terminal block

1462724

<https://www.phoenixcontact.com/us/products/1462724>



### LPS-5/E - Service connector

3270520

<https://www.phoenixcontact.com/us/products/3270520>



---

### LPS-5 - Service connector

3270521

<https://www.phoenixcontact.com/us/products/3270521>



# XT 2,5-TWIN-TG - Disconnect terminal block



1462724

<https://www.phoenixcontact.com/us/products/1462724>

## ST-BW 0 - Actuation tool

1200135

<https://www.phoenixcontact.com/us/products/1200135>

Actuation tool, for all 1.5 mm<sup>2</sup> spring cages from PT 1,5/S and FT 1,5/S



---

## SZS 0,4X2,5 VDE - Screwdriver

1205037

<https://www.phoenixcontact.com/us/products/1205037>

Screwdriver, slot-headed, VDE insulated, size: 0.4 x 2.5 x 80 mm, 2-component grip, with non-slip grip



# XT 2,5-TWIN-TG - Disconnect terminal block



1462724

<https://www.phoenixcontact.com/us/products/1462724>

## SF-SL 0,6X3,5-100 S-VDE - Screwdriver

1212587

<https://www.phoenixcontact.com/us/products/1212587>



Actuation tool, for ST terminal blocks, VDE insulated, with slimmer insulation integrated in the blade, also suitable for use as a bladed screwdriver, size: 0.6 x 3.5 x 100 mm, 2-component grip, with non-slip grip

---

## SZK PZ0 VDE - Screwdriver

1206447

<https://www.phoenixcontact.com/us/products/1206447>



Screwdriver, PZ crosshead, VDE insulated, size: PZ 0 x 80 mm, 2-component grip, with non-slip grip

## XT 2,5-TWIN-TG - Disconnect terminal block

1462724

<https://www.phoenixcontact.com/us/products/1462724>



### WS PT 2,5 - Warning label

1029026

<https://www.phoenixcontact.com/us/products/1029026>



---

### WS-DIO PT 2,5 - Warning label

1029037

<https://www.phoenixcontact.com/us/products/1029037>



## XT 2,5-TWIN-TG - Disconnect terminal block

1462724

<https://www.phoenixcontact.com/us/products/1462724>



## S-MT - Switching lock

3247954

<https://www.phoenixcontact.com/us/products/3247954>



Switching lock, depth: 23.1 mm, width: 3.5 mm, height: 10.5 mm, color: white

---

## NS 35/ 7,5 PERF 2000MM - DIN rail perforated

0801733

<https://www.phoenixcontact.com/us/products/0801733>



## XT 2,5-TWIN-TG - Disconnect terminal block

1462724

<https://www.phoenixcontact.com/us/products/1462724>



## NS 35/ 7,5 UNPERF 2000MM - DIN rail, unperforated

0801681

<https://www.phoenixcontact.com/us/products/0801681>



---

## NS 35/ 7,5 WH PERF 2000MM - DIN rail perforated

1204119

<https://www.phoenixcontact.com/us/products/1204119>



## XT 2,5-TWIN-TG - Disconnect terminal block

1462724

<https://www.phoenixcontact.com/us/products/1462724>



## NS 35/ 7,5 WH UNPERF 2000MM-VPE 10 - DIN rail, unperforated

1204122

<https://www.phoenixcontact.com/us/products/1204122>



---

## NS 35/ 7,5 AL UNPERF 2000MM - DIN rail, unperforated

0801704

<https://www.phoenixcontact.com/us/products/0801704>



## XT 2,5-TWIN-TG - Disconnect terminal block

1462724

<https://www.phoenixcontact.com/us/products/1462724>



## NS 35/ 7,5 ZN PERF 2000MM - DIN rail perforated

1206421

<https://www.phoenixcontact.com/us/products/1206421>



---

## NS 35/ 7,5 ZN UNPERF 2000MM - DIN rail, unperforated

1206434

<https://www.phoenixcontact.com/us/products/1206434>



## XT 2,5-TWIN-TG - Disconnect terminal block

1462724

<https://www.phoenixcontact.com/us/products/1462724>



## NS 35/ 7,5 CU UNPERF 2000MM-VPE 10 - DIN rail, unperforated

0801762

<https://www.phoenixcontact.com/us/products/0801762>



---

## NS 35/ 7,5 CAP - End cap

1206560

<https://www.phoenixcontact.com/us/products/1206560>

DIN rail end piece, for DIN rail NS 35/7.5



## XT 2,5-TWIN-TG - Disconnect terminal block

1462724

<https://www.phoenixcontact.com/us/products/1462724>



## NS 35/15 PERF 2000MM - DIN rail perforated

1201730

<https://www.phoenixcontact.com/us/products/1201730>



---

## NS 35/15 UNPERF 2000MM - DIN rail, unperforated

1201714

<https://www.phoenixcontact.com/us/products/1201714>



## XT 2,5-TWIN-TG - Disconnect terminal block

1462724

<https://www.phoenixcontact.com/us/products/1462724>



## NS 35/15 WH PERF 2000MM - DIN rail perforated

0806602

<https://www.phoenixcontact.com/us/products/0806602>



---

## NS 35/15 WH UNPERF 2000MM-VPE 10 - DIN rail, unperforated

1204135

<https://www.phoenixcontact.com/us/products/1204135>



## XT 2,5-TWIN-TG - Disconnect terminal block

1462724

<https://www.phoenixcontact.com/us/products/1462724>



## NS 35/15 AL UNPERF 2000MM - DIN rail, unperforated

1201756

<https://www.phoenixcontact.com/us/products/1201756>



---

## NS 35/15 ZN PERF 2000MM - DIN rail perforated

1206599

<https://www.phoenixcontact.com/us/products/1206599>



## XT 2,5-TWIN-TG - Disconnect terminal block

1462724

<https://www.phoenixcontact.com/us/products/1462724>



## NS 35/15 ZN UNPERF 2000MM - DIN rail, unperforated

1206586

<https://www.phoenixcontact.com/us/products/1206586>



---

## NS 35/15 CU UNPERF 2000MM-VPE 10 - DIN rail, unperforated

1201895

<https://www.phoenixcontact.com/us/products/1201895>



## XT 2,5-TWIN-TG - Disconnect terminal block

1462724

<https://www.phoenixcontact.com/us/products/1462724>



## NS 35/15 CAP - End cap

1206573

<https://www.phoenixcontact.com/us/products/1206573>

DIN rail end piece, for DIN rail NS 35/15



---

## NS 35/15-2,3 UNPERF 2000MM-VPE 10 - DIN rail, unperforated

1201798

<https://www.phoenixcontact.com/us/products/1201798>



## XT 2,5-TWIN-TG - Disconnect terminal block

1462724

<https://www.phoenixcontact.com/us/products/1462724>



## ZB 5 :UNBEDRUCKT - Zack marker strip

1050004

<https://www.phoenixcontact.com/us/products/1050004>



---

## ZB 5 CUS - Zack marker strip

0824962

<https://www.phoenixcontact.com/us/products/0824962>



# XT 2,5-TWIN-TG - Disconnect terminal block



1462724

<https://www.phoenixcontact.com/us/products/1462724>

## ZB 5,LGS:FORTL.ZAHLEN - Zack marker strip

1050017

<https://www.phoenixcontact.com/us/products/1050017>



---

## ZB 5,QR:FORTL.ZAHLEN - Zack marker strip

1050020

<https://www.phoenixcontact.com/us/products/1050020>

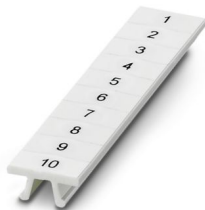

## XT 2,5-TWIN-TG - Disconnect terminal block

1462724

<https://www.phoenixcontact.com/us/products/1462724>



## ZB 5,LGS:GLEICHE ZAHLEN - Zack marker strip

1050033

<https://www.phoenixcontact.com/us/products/1050033>



## ZB 5,LGS:L1-N,PE - Zack marker strip

1050415

<https://www.phoenixcontact.com/us/products/1050415>



# XT 2,5-TWIN-TG - Disconnect terminal block



1462724

<https://www.phoenixcontact.com/us/products/1462724>

## UC-TM 5 - Marker for terminal blocks

0818108

<https://www.phoenixcontact.com/us/products/0818108>



---

## UC-TM 5 CUS - Marker for terminal blocks

0824581

<https://www.phoenixcontact.com/us/products/0824581>



## XT 2,5-TWIN-TG - Disconnect terminal block

1462724

<https://www.phoenixcontact.com/us/products/1462724>



### UCT-TM 5 - Marker for terminal blocks

0828734

<https://www.phoenixcontact.com/us/products/0828734>



---

### UCT-TM 5 CUS - Marker for terminal blocks

0829595

<https://www.phoenixcontact.com/us/products/0829595>



# XT 2,5-TWIN-TG - Disconnect terminal block



1462724

<https://www.phoenixcontact.com/us/products/1462724>

## GBS 5-25X12 - Group marker label for terminal marking

0810588

<https://www.phoenixcontact.com/us/products/0810588>



Group marker label, snaps onto terminal center for screw, spring-cage and quick connection terminal blocks, labeled with a 25 x 12 mm label or manually with the B-STIFT, in the foot part with ZB 5

---

## GBS 5-25X5 - Group marker label for terminal marking

0829126

<https://www.phoenixcontact.com/us/products/0829126>



Group marking label, can be snapped into terminal center for screw, spring-cage, push-in, and fast connection terminal blocks, can be labeled with a 24 x 4 mm label or manually using B-STIFT, in the foot part with ZB 5

## XT 2,5-TWIN-TG - Disconnect terminal block

1462724

<https://www.phoenixcontact.com/us/products/1462724>



## ZBF 5:UNBEDRUCKT - Zack Marker strip, flat

0808642

<https://www.phoenixcontact.com/us/products/0808642>



---

## ZBF 5 CUS - Zack Marker strip, flat

0825025

<https://www.phoenixcontact.com/us/products/0825025>



## XT 2,5-TWIN-TG - Disconnect terminal block

1462724

<https://www.phoenixcontact.com/us/products/1462724>



### ZBF 5,LGS:FORTL.ZAHLEN - Zack Marker strip, flat

0808671

<https://www.phoenixcontact.com/us/products/0808671>



---

### ZBF 5,QR:FORTL.ZAHLEN - Zack Marker strip, flat

0808697

<https://www.phoenixcontact.com/us/products/0808697>



## XT 2,5-TWIN-TG - Disconnect terminal block

1462724

<https://www.phoenixcontact.com/us/products/1462724>



### ZBF 5,LGS:GERADE ZAHLEN - Zack Marker strip, flat

0810821

<https://www.phoenixcontact.com/us/products/0810821>



---

### ZBF 5,LGS:UNGERADE ZAHLEN - Zack Marker strip, flat

0810863

<https://www.phoenixcontact.com/us/products/0810863>



# XT 2,5-TWIN-TG - Disconnect terminal block



1462724

<https://www.phoenixcontact.com/us/products/1462724>

## UC-TMF 5 - Marker for terminal blocks

0818153

<https://www.phoenixcontact.com/us/products/0818153>



---

## UC-TMF 5 CUS - Marker for terminal blocks

0824638

<https://www.phoenixcontact.com/us/products/0824638>

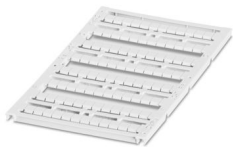

## XT 2,5-TWIN-TG - Disconnect terminal block

1462724

<https://www.phoenixcontact.com/us/products/1462724>



### UCT-TMF 5 - Marker for terminal blocks

0828744

<https://www.phoenixcontact.com/us/products/0828744>



---

### UCT-TMF 5 CUS - Marker for terminal blocks

0829658

<https://www.phoenixcontact.com/us/products/0829658>



## XT 2,5-TWIN-TG - Disconnect terminal block

1462724

<https://www.phoenixcontact.com/us/products/1462724>



## MPS-MT - Test plug

0201744

<https://www.phoenixcontact.com/us/products/0201744>



---

## MPS-IH WH - Insulating sleeve

0201663

<https://www.phoenixcontact.com/us/products/0201663>



## XT 2,5-TWIN-TG - Disconnect terminal block

1462724

<https://www.phoenixcontact.com/us/products/1462724>



### MPS-IH RD - Insulating sleeve

0201676

<https://www.phoenixcontact.com/us/products/0201676>



---

### MPS-IH BU - Insulating sleeve

0201689

<https://www.phoenixcontact.com/us/products/0201689>

Insulating sleeve, color: blue

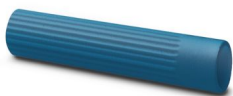

## XT 2,5-TWIN-TG - Disconnect terminal block

1462724

<https://www.phoenixcontact.com/us/products/1462724>



### MPS-IH YE - Insulating sleeve

0201692

<https://www.phoenixcontact.com/us/products/0201692>



---

### MPS-IH GN - Insulating sleeve

0201702

<https://www.phoenixcontact.com/us/products/0201702>



## XT 2,5-TWIN-TG - Disconnect terminal block

1462724

<https://www.phoenixcontact.com/us/products/1462724>



### MPS-IH GY - Insulating sleeve

0201728

<https://www.phoenixcontact.com/us/products/0201728>



---

### MPS-IH BK - Insulating sleeve

0201731

<https://www.phoenixcontact.com/us/products/0201731>



## XT 2,5-TWIN-TG - Disconnect terminal block

1462724

<https://www.phoenixcontact.com/us/products/1462724>



### ISH 2,5/0,2 - Insulating sleeve

3002843

<https://www.phoenixcontact.com/us/products/3002843>



---

### ISH 2,5/0,5 - Insulating sleeve

3002856

<https://www.phoenixcontact.com/us/products/3002856>



## XT 2,5-TWIN-TG - Disconnect terminal block

1462724

<https://www.phoenixcontact.com/us/products/1462724>



## ISH 2,5/1,0 - Insulating sleeve

3002869

<https://www.phoenixcontact.com/us/products/3002869>



---

## PAI-4-FIX-5/6 BU - Test adapter

3035975

<https://www.phoenixcontact.com/us/products/3035975>



4 mm test adapter, for terminal blocks with 5.2 mm and 6.2 mm pitch

## XT 2,5-TWIN-TG - Disconnect terminal block



1462724

<https://www.phoenixcontact.com/us/products/1462724>

### PAI-4-FIX-5/6 OG - Test adapter

3035974

<https://www.phoenixcontact.com/us/products/3035974>



4 mm test adapter, for terminal blocks with 5.2 mm and 6.2 mm pitch

---

### PAI-4-FIX-5/6 YE - Test adapter

3035977

<https://www.phoenixcontact.com/us/products/3035977>



4 mm test adapter, for terminal blocks with 5.2 mm and 6.2 mm pitch

# XT 2,5-TWIN-TG - Disconnect terminal block



1462724

<https://www.phoenixcontact.com/us/products/1462724>

## PAI-4-FIX-5/6 RD - Test adapter

3035976

<https://www.phoenixcontact.com/us/products/3035976>



4 mm test adapter, for terminal blocks with 5.2 mm and 6.2 mm pitch

---

## PAI-4-FIX-5/6 GN - Test adapter

3035978

<https://www.phoenixcontact.com/us/products/3035978>



4 mm test adapter, for terminal blocks with 5.2 mm and 6.2 mm pitch

# XT 2,5-TWIN-TG - Disconnect terminal block



1462724

<https://www.phoenixcontact.com/us/products/1462724>

## PAI-4-FIX-5/6 BK - Test adapter

3035980

<https://www.phoenixcontact.com/us/products/3035980>



4 mm test adapter, for terminal blocks with 5.2 mm and 6.2 mm pitch

---

## PAI-4-FIX-5/6 GY - Test adapter

3035982

<https://www.phoenixcontact.com/us/products/3035982>



4 mm test adapter, for terminal blocks with 5.2 mm and 6.2 mm pitch

## XT 2,5-TWIN-TG - Disconnect terminal block



1462724

<https://www.phoenixcontact.com/us/products/1462724>

### PAI-4-FIX-5/6 VT - Test adapter

3035979

<https://www.phoenixcontact.com/us/products/3035979>



4 mm test adapter, for terminal blocks with 5.2 mm and 6.2 mm pitch

---

### PAI-4-FIX-5/6 BN - Test adapter

3035981

<https://www.phoenixcontact.com/us/products/3035981>



4 mm test adapter, for terminal blocks with 5.2 mm and 6.2 mm pitch

# XT 2,5-TWIN-TG - Disconnect terminal block



1462724

<https://www.phoenixcontact.com/us/products/1462724>

## PAI-4-FIX-5/6 WH - Test adapter

3035983

<https://www.phoenixcontact.com/us/products/3035983>



4 mm test adapter, for terminal blocks with 5.2 mm and 6.2 mm pitch

---

## PS-5 - Test plug

3030983

<https://www.phoenixcontact.com/us/products/3030983>



Test plug, Modular test plug, number of positions: 1, color: red

# XT 2,5-TWIN-TG - Disconnect terminal block



1462724

<https://www.phoenixcontact.com/us/products/1462724>

## DP PS-5 - Spacer plate

3036725

<https://www.phoenixcontact.com/us/products/3036725>



Spacer plate, depth: 29 mm, width: 5.2 mm, height: 22.4 mm, number of positions: 1, color: red

---

## PS-5/2,3MM RD - Test plug

3038723

<https://www.phoenixcontact.com/us/products/3038723>



Test plug, number of positions: 1, color: red

## XT 2,5-TWIN-TG - Disconnect terminal block



1462724

<https://www.phoenixcontact.com/us/products/1462724>

### PROJECT COMPLETE - Software

1050453

<https://www.phoenixcontact.com/us/products/1050453>



Intuitive planning and marking software for configuring terminal strips and for professional marking of marking materials for terminal blocks, conductors, cables, devices, and systems. The software is available for download

---

### CLIPFIX 35 - End bracket

3022218

<https://www.phoenixcontact.com/us/products/3022218>



Quick mounting end clamp for NS 35/7,5 DIN rail or NS 35/15 DIN rail, with marking option, width: 9.5 mm, color: gray

# XT 2,5-TWIN-TG - Disconnect terminal block



1462724

<https://www.phoenixcontact.com/us/products/1462724>

## CLIPFIX 35-5 - End bracket

3022276

<https://www.phoenixcontact.com/us/products/3022276>



Quick mounting end clamp for NS 35/7,5 DIN rail or NS 35/15 DIN rail, with marking option, with parking option for FBS...5, FBS...6, KSS 5, KSS 6, width: 5.15 mm, color: gray

---

## E/NS 35 N - End bracket

0800886

<https://www.phoenixcontact.com/us/products/0800886>

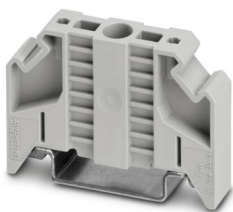

End clamp, width: 9.5 mm, color: gray

# XT 2,5-TWIN-TG - Disconnect terminal block



1462724

<https://www.phoenixcontact.com/us/products/1462724>

## CRIMPFOX CENTRUS 6S - Crimping pliers

1213144

<https://www.phoenixcontact.com/us/products/1213144>



Crimping pliers, for uninsulated and insulated ferrules, DIN 46228 Part 1 and 4, from 0.14 mm<sup>2</sup> ... 6 mm<sup>2</sup>, also for TWIN ferrules up to 2 x 4 mm<sup>2</sup>, automatic cross section adjustment, lateral insertion, equipped with fall protection

---

## CRIMPFOX CENTRUS 10S - Crimping pliers

1213154

<https://www.phoenixcontact.com/us/products/1213154>



Crimping pliers, for uninsulated and insulated ferrules, DIN 46228 Part 1 and 4, from 0.14 mm<sup>2</sup> ... 10 mm<sup>2</sup>, also for TWIN ferrules up to 2 x 4 mm<sup>2</sup>, automatic cross section adjustment, lateral insertion, equipped with fall protection

# XT 2,5-TWIN-TG - Disconnect terminal block



1462724

<https://www.phoenixcontact.com/us/products/1462724>

## CRIMPFOX CENTRUS 6H - Crimping pliers

1213146

<https://www.phoenixcontact.com/us/products/1213146>



Crimping pliers, for uninsulated and insulated ferrules, DIN 46228 Part 1 and 4, from 0.14 mm<sup>2</sup> ... 6 mm<sup>2</sup>, also for TWIN ferrules up to 2 x 4 mm<sup>2</sup>, automatic cross section adjustment, lateral insertion, equipped with fall protection

---

## CRIMPFOX CENTRUS 10H - Crimping pliers

1213156

<https://www.phoenixcontact.com/us/products/1213156>



Crimping pliers, for uninsulated and insulated ferrules, DIN 46228 Part 1 and 4, from 0.14 mm<sup>2</sup> ... 10 mm<sup>2</sup>, also for TWIN ferrules up to 2 x 4 mm<sup>2</sup>, automatic cross section adjustment, lateral insertion, equipped with fall protection

# XT 2,5-TWIN-TG - Disconnect terminal block



1462724

<https://www.phoenixcontact.com/us/products/1462724>

## CRIMPFOX 10S - Crimping pliers

1212045

<https://www.phoenixcontact.com/us/products/1212045>



Crimping pliers, for ferrules without insulating collar according to DIN 46228 Part 1 and ferrules with insulating collar according to DIN 46228 Part 4, 0.14 mm<sup>2</sup> ... 10 mm<sup>2</sup>, unlockable pressure lock, lateral entry

---

## CRIMPFOX 6H - Crimping pliers

1212046

<https://www.phoenixcontact.com/us/products/1212046>



Crimping pliers, for ferrules without insulating collar according to DIN 46228 Part 1 and ferrules with insulating collar according to DIN 46228 Part 4, 0.14 mm<sup>2</sup> ... 6 mm<sup>2</sup>, unlockable pressure lock, lateral entry

# XT 2,5-TWIN-TG - Disconnect terminal block



1462724

<https://www.phoenixcontact.com/us/products/1462724>

## CRIMPFOX 2,5-M - Crimping pliers

1212719

<https://www.phoenixcontact.com/us/products/1212719>



Crimping pliers, for ferrules without insulating collar according to DIN 46228 Part 1 and ferrules with insulating collar according to DIN 46228 Part 4, 0.25 mm<sup>2</sup> ... 2.5 mm<sup>2</sup>, lateral entry, trapezoidal crimp

---

## CRIMPFOX 6-M - Crimping pliers

1212720

<https://www.phoenixcontact.com/us/products/1212720>



Crimping pliers, for ferrules without insulating collar according to DIN 46228 Part 1 and ferrules with insulating collar according to DIN 46228 Part 4, 0.25 mm<sup>2</sup> ... 6.0 mm<sup>2</sup>, lateral entry, trapezoidal crimp

# XT 2,5-TWIN-TG - Disconnect terminal block



1462724

<https://www.phoenixcontact.com/us/products/1462724>

## CRIMPFOX 6 - Crimping pliers

1212034

<https://www.phoenixcontact.com/us/products/1212034>



Crimping pliers, for ferrules without insulating collar according to DIN 46228 Part 1 and ferrules with insulating collar according to DIN 46228 Part 4, 0.25 mm<sup>2</sup> ... 6.0 mm<sup>2</sup>, lateral entry, trapezoidal crimp

---

## CRIMPFOX 6T - Crimping pliers

1212037

<https://www.phoenixcontact.com/us/products/1212037>



Crimping pliers, for ferrules without insulating collar according to DIN 46228 Part 1 and ferrules with insulating collar according to DIN 46228 Part 4, 0.25 mm<sup>2</sup> ... 6 mm<sup>2</sup>, lateral entry, trapezoidal crimp

# XT 2,5-TWIN-TG - Disconnect terminal block



1462724

<https://www.phoenixcontact.com/us/products/1462724>

## CRIMPFOX 6T-F - Crimping pliers

1212038

<https://www.phoenixcontact.com/us/products/1212038>



Crimping pliers, for ferrules without insulating collar according to DIN 46228 Part 1 and ferrules with insulating collar according to DIN 46228 Part 4, 0.25 mm<sup>2</sup> ... 6 mm<sup>2</sup>, front entry, trapezoidal crimp

---

## CRIMPFOX 6S-F - Crimping pliers

1212043

<https://www.phoenixcontact.com/us/products/1212043>



Crimping pliers, for ferrules without insulating collar according to DIN 46228 Part 1 and ferrules with insulating collar according to DIN 46228 Part 4, 0.5 mm<sup>2</sup> ... 6 mm<sup>2</sup>, front entry, square crimp

## XT 2,5-TWIN-TG - Disconnect terminal block

1462724

<https://www.phoenixcontact.com/us/products/1462724>



## CRIMPFOX-M - Crimping pliers

1212072

<https://www.phoenixcontact.com/us/products/1212072>

Basic pliers, for accommodating dies for a wide range of type of contacts



---

## P-FIX - Feed-through connector

3038956

<https://www.phoenixcontact.com/us/products/3038956>



# XT 2,5-TWIN-TG - Disconnect terminal block



1462724

<https://www.phoenixcontact.com/us/products/1462724>

## P-CO - Component connector

3036796

<https://www.phoenixcontact.com/us/products/3036796>



Component connector, for installing components that can be individually selected, nom. voltage: 250 V, nominal current: 6 A, connection method: Plug-in connection, pitch: 5.2 mm, depth: 33.2 mm, width: 5.1 mm, height: 24.2 mm, number of positions: 1, color: gray, mounting type: Pluggable (slot)

---

## P-CO 1N4007/R-L - Component connector

3032457

<https://www.phoenixcontact.com/us/products/3032457>



## XT 2,5-TWIN-TG - Disconnect terminal block

1462724

<https://www.phoenixcontact.com/us/products/1462724>



## P-CO 1N4007/L-R - Component connector

3032460

<https://www.phoenixcontact.com/us/products/3032460>



Component connector, with diode 1N4007, depth: 33.3 mm, width: 5.2 mm, height: 24.2 mm, number of positions: 1, color: gray, mounting type: Plug-in mounting

---

## P-CO XL - Component connector

3036797

<https://www.phoenixcontact.com/us/products/3036797>



Component connector, for installing components that can be individually selected up to a diameter of 10 mm and power dissipation of up to 1 W, nom. voltage: 400 V, nominal current: 10 A, connection method: Plug-in connection, depth: 37.5 mm, width: 12.3 mm, height: 41.2 mm, number of positions: 1, color: gray, mounting type: Pluggable (slot)

# XT 2,5-TWIN-TG - Disconnect terminal block



1462724

<https://www.phoenixcontact.com/us/products/1462724>

## P-CO XL SKN - Component connector

3036798

<https://www.phoenixcontact.com/us/products/3036798>



Component connector, specifically for holding the SKN 2,5 diode, nom. voltage: 400 V, nominal current: 1.25 A, connection method: Plug-in connection, depth: 37.5 mm, width: 12.3 mm, height: 41.2 mm, number of positions: 1, color: gray, mounting type: Pluggable (slot)

---

## P-CO 2-5 R47K - Component connector

3032447

<https://www.phoenixcontact.com/us/products/3032447>



## XT 2,5-TWIN-TG - Disconnect terminal block

1462724

<https://www.phoenixcontact.com/us/products/1462724>



## P-FU 5X20-5 - Fuse plug

3209235

<https://www.phoenixcontact.com/us/products/3209235>



---

## P-FU 5X20 LED 24-5 - Fuse plug

3209248

<https://www.phoenixcontact.com/us/products/3209248>



## XT 2,5-TWIN-TG - Disconnect terminal block

1462724

<https://www.phoenixcontact.com/us/products/1462724>



## P-FU 5X20 LED 60-5 - Fuse plug

3209251

<https://www.phoenixcontact.com/us/products/3209251>



---

## P-FU 5X20 LED 250-5 - Fuse plug

3209264

<https://www.phoenixcontact.com/us/products/3209264>



# XT 2,5-TWIN-TG - Disconnect terminal block



1462724

<https://www.phoenixcontact.com/us/products/1462724>

## P-DI - Isolating plug

3036783

<https://www.phoenixcontact.com/us/products/3036783>



---

## P-DI GY - Isolating plug

3047390

<https://www.phoenixcontact.com/us/products/3047390>



# XT 2,5-TWIN-TG - Disconnect terminal block



1462724

<https://www.phoenixcontact.com/us/products/1462724>

## P-DI GN - Isolating plug

1071062

<https://www.phoenixcontact.com/us/products/1071062>



---

## P-CO L - Component connector

1782755

<https://www.phoenixcontact.com/us/products/1782755>



---

Phoenix Contact 2025 © - all rights reserved  
<https://www.phoenixcontact.com>

Phoenix Contact USA  
586 Fulling Mill Road  
Middletown, PA 17057, United States  
(+717) 944-1300  
[info@phoenixcon.com](mailto:info@phoenixcon.com)