

1424582

<https://www.phoenixcontact.com/us/products/1424582>

Please be informed that the data shown in this PDF document is generated from our online catalog. Please find the complete data in the user documentation. Our general terms of use for downloads are valid.



Cable feed-through plates, no. of conductors: 25, external cable diameter: 3x 3 mm ... 6 mm, 9x 3 mm ... 7 mm, 8x 6 mm ... 9 mm, 4x 6 mm ... 12 mm, 1x 10 mm ... 20 mm, material: PP (Core), material: TPE-SEBS (external material), color: black, length: 154 mm, width: 56 mm, height: 20 mm

Your advantages

- The panel cutouts of size B24 heavy-duty connectors can be used.

Commercial data

Item number	1424582
Packing unit	1 pc
Minimum order quantity	1 pc
Sales key	BF67
Product key	AF7CAX
GTIN	4055626374857
Weight per piece (including packing)	80.7 g
Weight per piece (excluding packing)	79.2 g
Customs tariff number	39269097
Country of origin	FI

# MH-25-MULTI-65-PV-BK - Cable feed-through plates



1424582

<https://www.phoenixcontact.com/us/products/1424582>

## Technical data

### Notes

General	incl. mounting screws
---------	-----------------------

### Product properties

Product type	Cable feed-through
No. of conductors	25

### Connection data

External cable diameter	3x 3 mm ... 6 mm
Tightening torque	1.8 Nm

### Dimensions

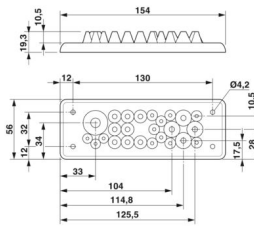
Dimensional drawing	
Width	56 mm
Height	20 mm
Length	154 mm
Drill hole distance, horizontal	130 mm
Drill hole distance, vertical	32 mm
Hole diameter	4 mm

### Material specifications

Color	black (RAL 9005)
Material interior	PP (Core)
Material exterior	TPE-SEBS (external material)
Flammability rating according to UL 94	V0

### Cable/line

External cable diameter	3x 3 mm ... 6 mm
	9x 3 mm ... 7 mm
	8x 6 mm ... 9 mm
	4x 6 mm ... 12 mm
	1x 10 mm ... 20 mm

### Environmental and real-life conditions

Ambient conditions
--------------------

# MH-25-MULTI-65-PV-BK - Cable feed-through plates



1424582

<https://www.phoenixcontact.com/us/products/1424582>

Degree of protection	IP65
Ambient temperature (operation)	-40 °C ... 90 °C

## Mounting

Assembly note	M4 mounting screw, torque: 1.8 Nm, SW5 Allen key
	<p>The mounting screws included should be used for assembly.</p> <p>Assembly steps:</p> <ol style="list-style-type: none"><li>1) Fix Multigates with the mounting screws provided (observe torque)</li><li>2) Make a hole in the membrane (with a screwdriver) or cut off the tip of the cone</li><li>3) Guide the cable through the opening (from the outside). Withdraw the cable approximately 20 mm (to improve strain relief).</li></ol>

## MH-25-MULTI-65-PV-BK - Cable feed-through plates

1424582

<https://www.phoenixcontact.com/us/products/1424582>



## Drawings

## Dimensional drawing

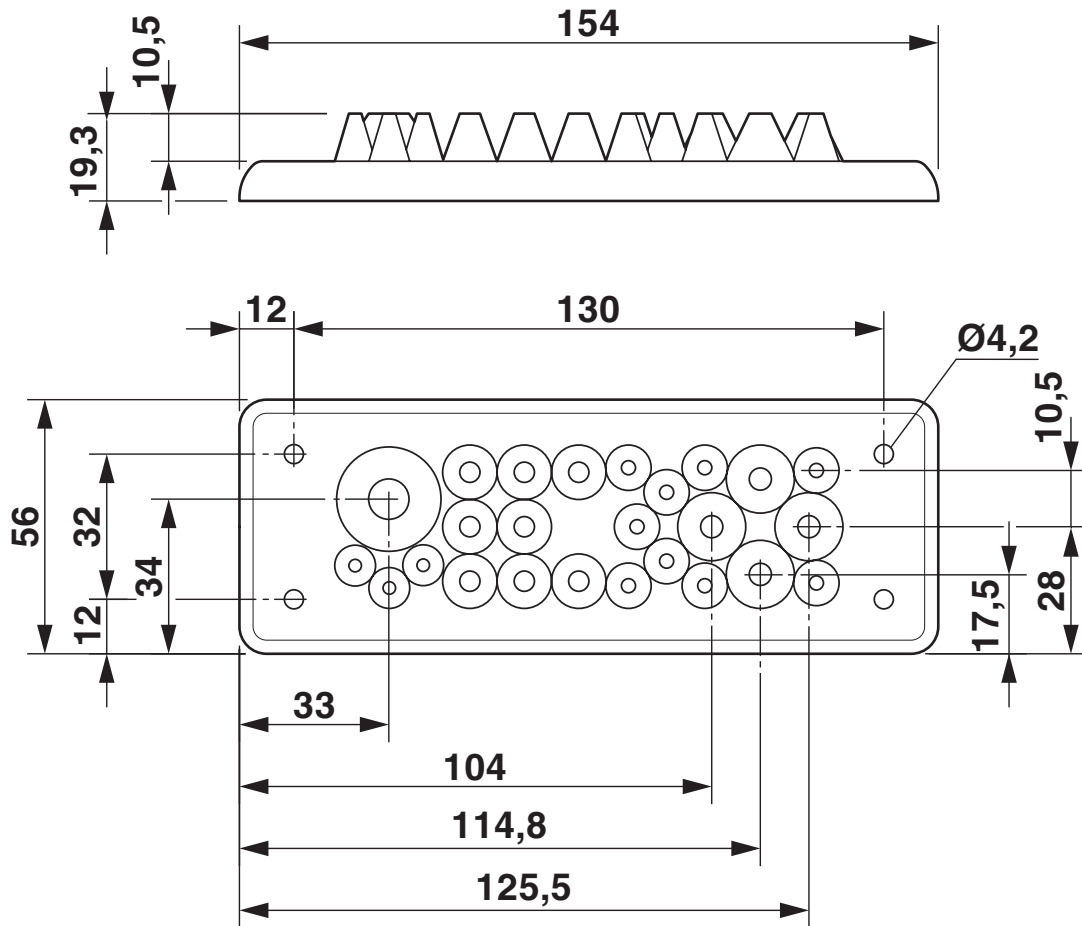

## Dimensional drawing

# MH-25-MULTI-65-PV-BK - Cable feed-through plates



1424582

<https://www.phoenixcontact.com/us/products/1424582>

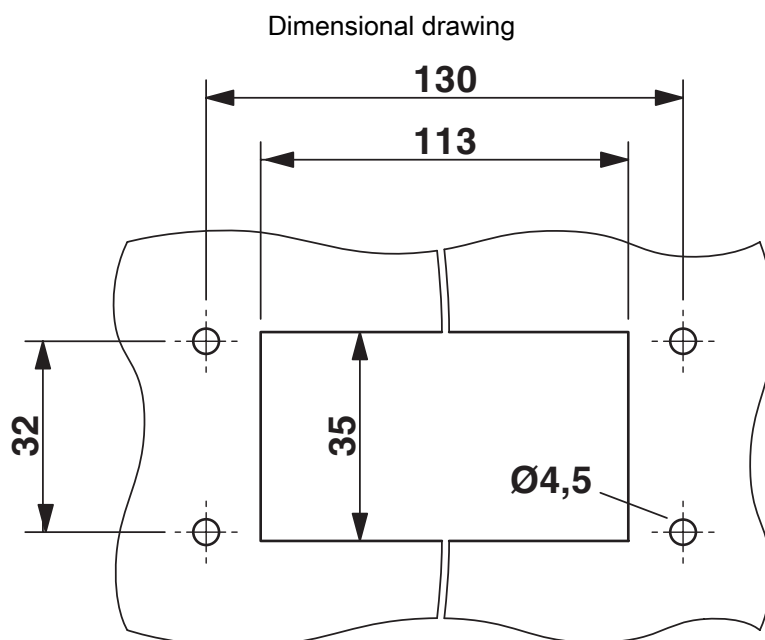

Wall cutout drawing

# MH-25-MULTI-65-PV-BK - Cable feed-through plates



1424582

<https://www.phoenixcontact.com/us/products/1424582>

## Approvals

📄 To download certificates, visit the product detail page: <https://www.phoenixcontact.com/us/products/1424582>



**EAC-RoHS**

Approval ID: RU D-DE.HB35.B.00387

# MH-25-MULTI-65-PV-BK - Cable feed-through plates



1424582

<https://www.phoenixcontact.com/us/products/1424582>

## Classifications

### ECLASS

ECLASS-13.0	27400569
ECLASS-15.0	27400569

### ETIM

ETIM 9.0	EC001004
----------	----------

### UNSPSC

UNSPSC 21.0	31163000
-------------	----------

Environmental product compliance

EU RoHS	
Fulfills EU RoHS substance requirements	Yes, No exemptions
China RoHS	
Environment friendly use period (EFUP)	EFUP-E
	No hazardous substances above the limits
EU REACH SVHC	
REACH candidate substance (CAS No.)	No substance above 0.1 wt%