

EV-GBM3PC-1AC16A-5,0M2,5ESOC00 - AC charging cable



1621471
<https://www.phoenixcontact.com/us/products/1621471>

Please be informed that the data shown in this PDF document is generated from our online catalog. Please find the complete data in the user documentation. Our general terms of use for downloads are valid.

CHARX connect, GB/T, 16 A permanent, 250 V AC, cable: 5 m, black, straight, housing: black, gray, GB/T 20234.2, Mobile AC charging cable with Vehicle Connector and Infrastructure Plug



Product description

Mobile AC charging cable with vehicle charging connector and infrastructure charging plug for charging electric vehicles with alternating current (AC), compatible with AC GB/T vehicle charging inlets and AC GB/T infrastructure charging sockets at charging stations

Commercial data

Item number	1621471
Packing unit	1 pc
Minimum order quantity	1 pc
Product key	XWBAEF
GTIN	4046356933971
Weight per piece (including packing)	2,000 g
Weight per piece (excluding packing)	2,000 g
Country of origin	DE

EV-GBM3PC-1AC16A-5,0M2,5ESOC00 - AC charging cable



1621471

<https://www.phoenixcontact.com/us/products/1621471>

Technical data

Product properties

Product type	AC charging cable
Product family	CHARX connect
Application	Mobile AC charging cable with Vehicle Connector and Infrastructure Plug
Charging standard	GB/T
Charging mode	Mode 3
Customer variations	On request
Label	14.1 mm x 44.8 mm (customer logo on request)

Electrical properties

Type of signal transmission	Pulse width modulation
Note on the connection method	Crimp connection, cannot be disconnected
Coding	680 Ω (between PE and CC)

Charging power and current (AC charging (1-phase))

Type of charging current	AC single-phase
Charging current	16 A AC (1-phase)
Charging power	4 kW

Pin assignment (Leistungskontakte)

Number	3 (L, N, PE)
Rated voltage	250 V
Rated current	16 A

Pin assignment (Signalkontakte)

Number	2 (CP, CC)
Rated voltage	30 V AC
Rated current	2 A

Material specifications

Color (Housing)	black (9005)
Color (Handle area)	black (9005)
Color (Actuating element)	silver grey (7001)
Color (Mating face)	black (9005)
Color (Protective cap)	black (9005)
Color (Cable)	black (9005)
Material (Vehicle charging connector)	Plastic
Material (Infrastructure charging plug)	Plastic
Material (Cable outer sheath)	TPE-U
Material (Contact surface)	Silver

Cable/line

EV-GBM3PC-1AC16A-5,0M2,5ESOC00 - AC charging cable



1621471

<https://www.phoenixcontact.com/us/products/1621471>

Cable length	5 m
Cable type	Class 6
Cable type	straight
Cable structure	3 x 2.5 mm ² + 1 x 0.5 mm ²
External cable diameter	10.50 mm ±0.4 mm
Outer sheath, material	TPE
Cable resistance	≤ 0.0076 Ω/m (based on a power core, at an ambient temperature of 20°C)
Bending radius	min. 157.5 mm (15x diameter)
Cable length	5 m
External cable diameter	10.50 mm ±0.4 mm
Cable type	Class 6
Cable resistance	≤ 0.0076 Ω/m (based on a power core, at an ambient temperature of 20°C)

Mechanical properties

Mechanical data

Insertion/withdrawal cycles	> 10000
Insertion force	< 100 N
Withdrawal force	< 100 N

Environmental and real-life conditions

Ambient conditions

Degree of protection (Vehicle charging inlet)	IP55 (plugged in; when plugged in and ready to operate, the degree of protection is only ensued if both plug-in components are original products from Phoenix Contact or suitable standard-compliant products)
Degree of protection (Infrastructure charging plug)	IP55 (plugged in; when plugged in and ready to operate, the degree of protection is only ensued if both plug-in components are original products from Phoenix Contact or suitable standard-compliant products)
Degree of protection (Protective cap)	IP54
Ambient temperature (operation)	-30 °C ... 50 °C
Ambient temperature (storage/transport)	-40 °C ... 80 °C
Altitude	5000 m (above sea level)

Standards and regulations

Standards

Standards/regulations	GB/T 20234.2
-----------------------	--------------

EV-GBM3PC-1AC16A-5,0M2,5ESOC00 - AC charging cable

1621471

<https://www.phoenixcontact.com/us/products/1621471>

Drawings

Connection diagram

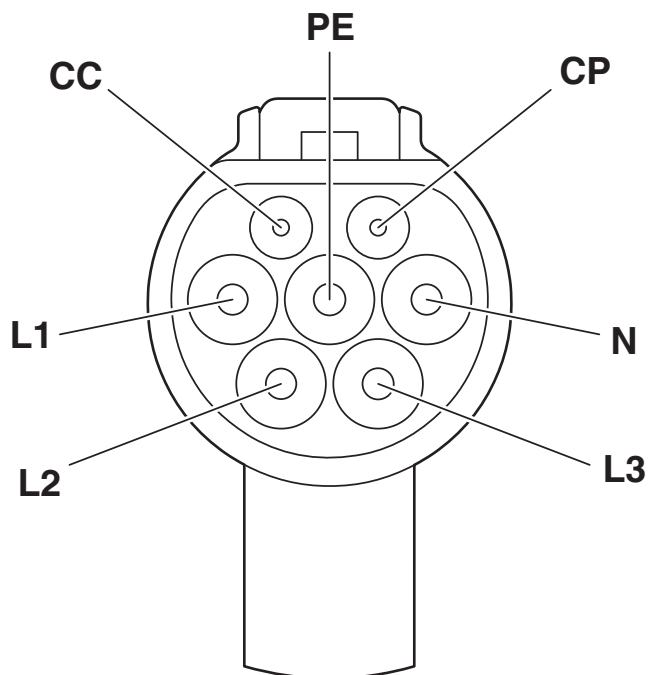

Pin assignment of the Vehicle Connector

Connection diagram

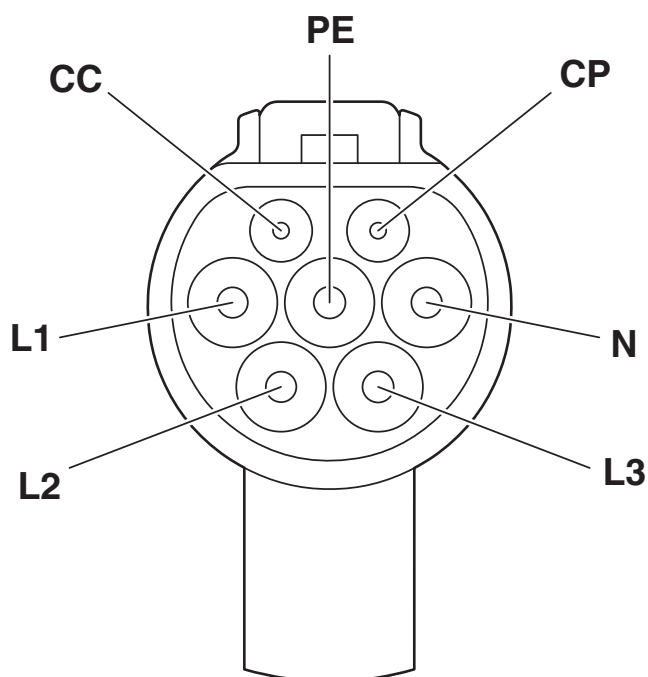

Pin assignment of Infrastructure Plug

EV-GBM3PC-1AC16A-5,0M2,5ESOC00 - AC charging cable

1621471

<https://www.phoenixcontact.com/us/products/1621471>

Schematic diagram

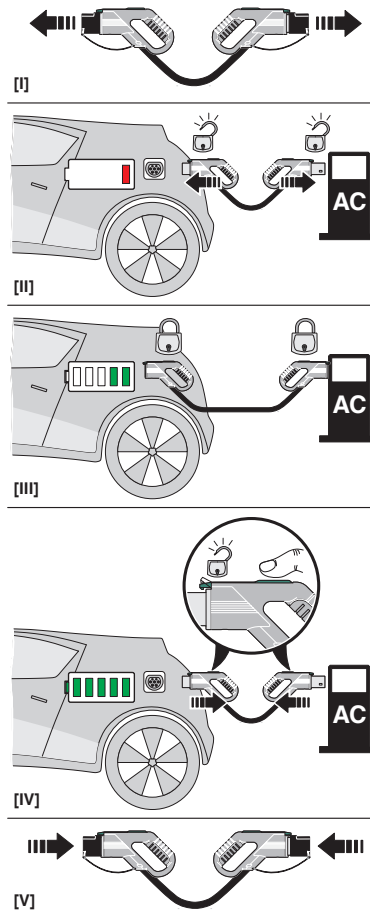

Operating instructions

EV-GBM3PC-1AC16A-5,0M2,5ESOC00 - AC charging cable



1621471
<https://www.phoenixcontact.com/us/products/1621471>

Classifications

UNSPSC

UNSPSC 21.0	39121522
-------------	----------

EV-GBM3PC-1AC16A-5,0M2,5ESOC00 - AC charging cable



1621471
<https://www.phoenixcontact.com/us/products/1621471>

Environmental product compliance

China RoHS	
Environment friendly use period (EFUP)	<div>EFUP-10</div> <div>An article-related China RoHS declaration table can be found in the download area for the respective article under "Manufacturer declaration". For all articles with EFUP-E, no China RoHS declaration table issued and required.</div>
EU REACH SVHC	
REACH candidate substance (CAS No.)	No substance above 0.1 wt%

Phoenix Contact 2025 © - all rights reserved
<https://www.phoenixcontact.com>

Phoenix Contact USA
586 Fulling Mill Road
Middletown, PA 17057, United States
(+717) 944-1300
info@phoenixcon.com