

# RC-12P1N320000 - Contact insert

1607006

<https://www.phoenixcontact.com/us/products/1607006>



Please be informed that the data shown in this PDF document is generated from our online catalog. Please find the complete data in the user documentation. Our general terms of use for downloads are valid.



Contact insert, M23, number of positions: 12, contact connection type: Pin, Solder-in connection, series: RC, TU, this item is expected to be lead-free from Q1 2027 in accordance with RoHS II without exception 6c (Pb < 0.1%), a lead-free alternative is possible on request in advance

## Commercial data

Item number	1607006
Packing unit	10 pc
Minimum order quantity	1 pc
Note	Made to order (non-returnable)
Sales key	AB31
Product key	ABRAFU
GTIN	4046356216067
Weight per piece (including packing)	9.7 g
Weight per piece (excluding packing)	6.784 g
Customs tariff number	85366990
Country of origin	DE

# RC-12P1N320000 - Contact insert



1607006

<https://www.phoenixcontact.com/us/products/1607006>

## Technical data

### Product properties

Product type	Contact insert
Series	RC
	TU
Application	Signal
Number of positions	12
Connection profile	12
Coding	N
Thread type	M23

### Electrical properties

Contact: Contact group 1

Contact diameter	1 mm
Nominal current $I_N$	8 A (for max. connection cross section)
Nominal voltage $U_N$	48 V AC
	74 V DC
Overvoltage category	III
Degree of pollution	3
Rated surge voltage	1.5 kV

### Connection data

Connection method	Solder-in connection
-------------------	----------------------

### Material specifications

Material Insulating body	PBT
Material Contact	CuZn
Material Contact surface	Ni/Au

### Connector

Direction of rotation	Standard
-----------------------	----------

### Mechanical properties

Mechanical data

Insertion/withdrawal cycles	50
-----------------------------	----

# RC-12P1N320000 - Contact insert

1607006

<https://www.phoenixcontact.com/us/products/1607006>



## Drawings

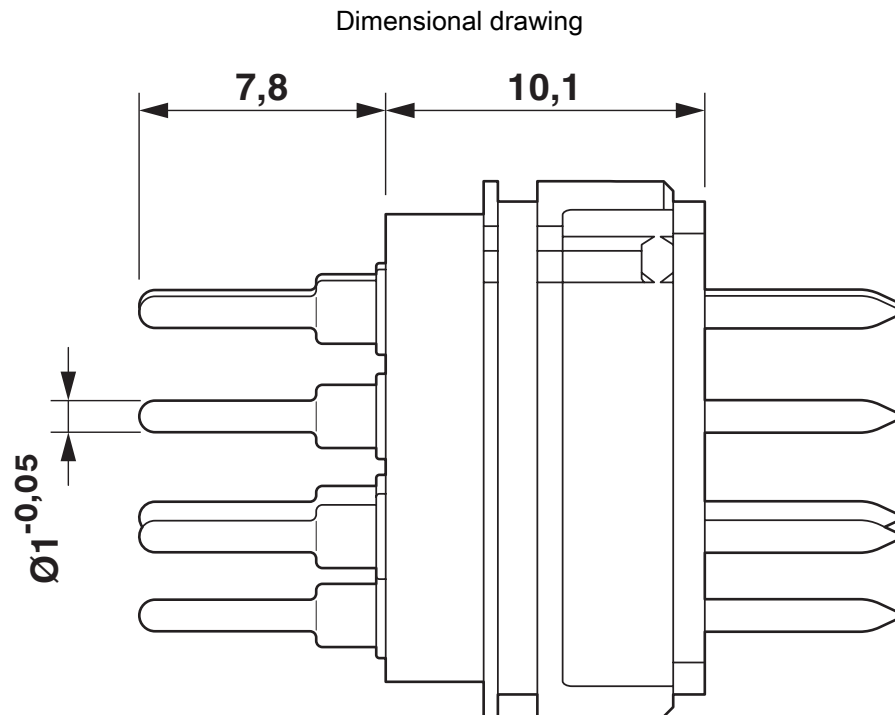

Dimensional drawing

# RC-12P1N320000 - Contact insert

1607006

<https://www.phoenixcontact.com/us/products/1607006>



Schematic diagram

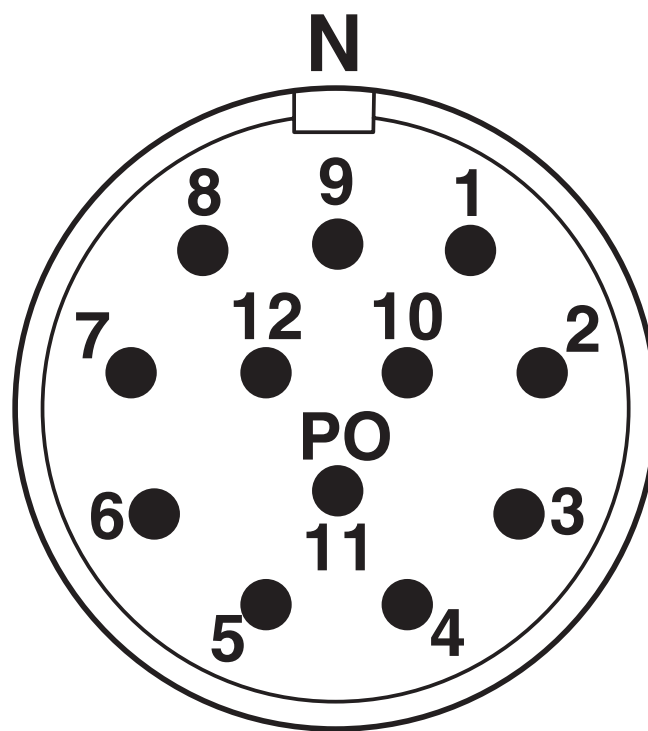

Connector pin assignment

# RC-12P1N320000 - Contact insert

1607006

<https://www.phoenixcontact.com/us/products/1607006>



Drilling plan/solder pad geometry

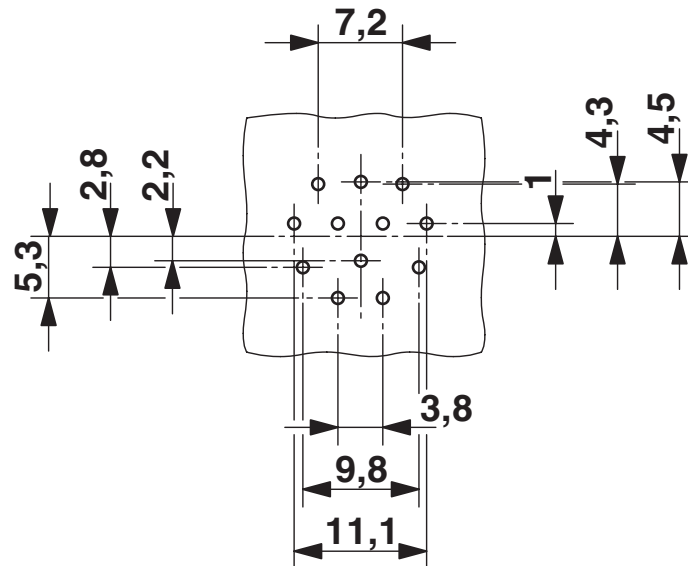

# RC-12P1N320000 - Contact insert



1607006

<https://www.phoenixcontact.com/us/products/1607006>

## Classifications

### ECLASS

ECLASS-13.0	27440223
ECLASS-15.0	27440223

### ETIM

ETIM 9.0	EC003557
----------	----------

### UNSPSC

UNSPSC 21.0	39121400
-------------	----------

# RC-12P1N320000 - Contact insert



1607006

<https://www.phoenixcontact.com/us/products/1607006>

## Environmental product compliance

### EU RoHS

Fulfills EU RoHS substance requirements	Yes
Exemption	6(c)

### China RoHS

Environment friendly use period (EFUP)	EFUP-50
	An article-related China RoHS declaration table can be found in the download area for the respective article under "Manufacturer declaration". For all articles with EFUP-E, no China RoHS declaration table issued and required.

### EU REACH SVHC

REACH candidate substance (CAS No.)	Lead(CAS: 7439-92-1)
SCIP	c8b243f1-a679-42b8-a3d4-53e1f9931b44

Phoenix Contact 2025 © - all rights reserved

<https://www.phoenixcontact.com>

Phoenix Contact USA  
586 Fulling Mill Road  
Middletown, PA 17057, United States  
(+717) 944-1300  
[info@phoenixcon.com](mailto:info@phoenixcon.com)