



# TSW304

v1.11



## HARDWARE

### FRONT VIEW

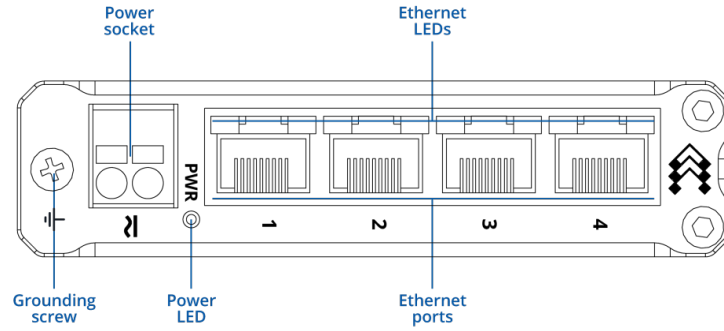

### BACK VIEW

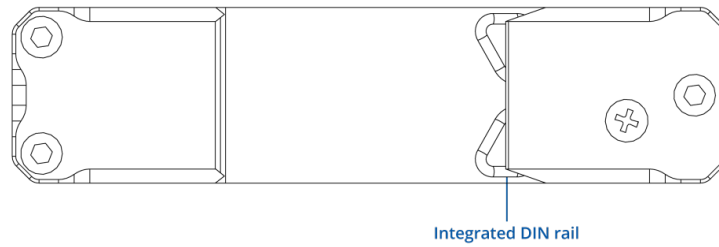

### POWER SOCKET PINOUT

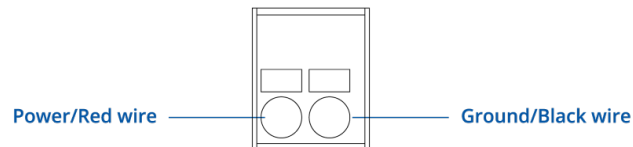

### RJ45 LED MEANING

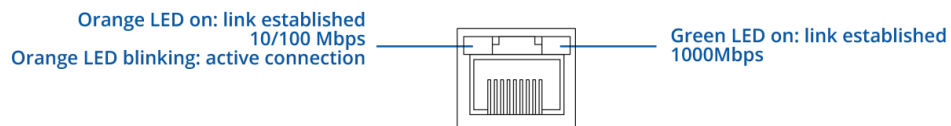

## FEATURES

### Ethernet

<b>ETH</b>	4 x ETH ports, 10/100/1000 Mbps, supports auto MDI/MDIX crossover
<b>IEEE 802.3 series standards</b>	802.3i, 802.3u, 802.3ab, 802.3x, 802.3az

### INDUSTRIAL PROTOCOLS

<b>Profinet</b>	Profinet Class A conformance (available with optional order code)
-----------------	---

### Performance Specifications

<b>Bandwidth (Non-blocking)</b>	8 Gbps
<b>Packer buffer</b>	128 KB
<b>MAC address table size</b>	2K entries
<b>Jumbo frame support</b>	9216 bytes

### Power

<b>Connector</b>	2-pin industrial DC power socket
<b>Input voltage range</b>	7 - 57 VDC; 9 - 40 VAC
<b>PoE (passive)</b>	Possibility to power up through ETH1 ports, not compatible with IEEE802.3af, 802.3at and 802.3bt standards, Mode B, 9 - 30 VDC
<b>Power consumption</b>	Idle: 0.26 W / Max: 1.44 W

### Physical Interfaces

<b>Ethernet</b>	4 x RJ45 ports, 10/100/1000 Mbps
<b>Status LEDs</b>	8 x ETH status LEDs, 1 x Power LED
<b>Power</b>	1 x 2-pin industrial DC power socket
<b>Other</b>	1 x Grounding screw

### Physical Specification

<b>Casing material</b>	Aluminium housing
<b>Dimensions (W x H x D)</b>	102 x 25 x 81.5 mm
<b>Weight</b>	210 g
<b>Mounting options</b>	Integrated DIN rail bracket; wall mount and flat surface (additional kit needed)

**Operating Environment**

---

<b>Operating temperature</b>	-40 °C to 75 °C
<b>Operating humidity</b>	5% to 95% non-condensing
<b>Ingress Protection Rating</b>	IP30

**Regulatory & Type Approvals**

---

<b>Regulatory</b>	CE, REACH, RoHS, WEEE, UKCA, FCC, IC, CB, RCM
-------------------	---

**Safety**

---

<b>Standards</b>	EN IEC 62368-1:2020+A11:2020 IEC 60068-2-6:2007 Environmental testing - Part 2-6 IEC 60068-2-27:2008 Environmental testing - Part 2-27 IEC 60068-2-31:2008 Environmental testing - Part 2-31
------------------	---

ORDERING

STANDARD PACKAGE\*



TSW304



QSG (QUICK START GUIDE)

- TSW304
- QSG (Quick Start Guide)
- Packaging box

\*Standard package contents may differ based on standard order codes.

For more information on all available packaging options – please [contact us](#) directly.

CLASSIFICATION CODES

**HS Code:** 851762

**HTS:** 8517.62.00

AVAILABLE VERSIONS

TSW304 *****0	N/A	TSW304000010 / Standard package
TSW304 *****1	N/A	
Profinet Class A conformance		TSW304000001 / Standard package without PSU

TSW304 SPATIAL MEASUREMENTS

PHYSICAL SPECIFICATION

Device housing (W x H x D)*	102 x 25 x 81.5 mm
Box (W x H x D):	175 x 35 x 150 mm

\*Housing measurements are presented without antenna connectors and screws; for measurements of other device elements look to the sections below.

**TOP VIEW**

The figure below depicts the measurements of device and its components as seen from the top:

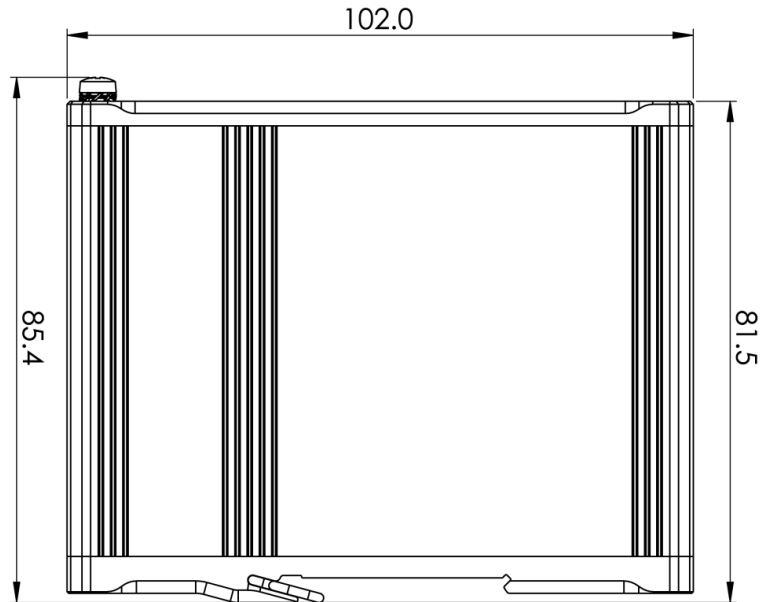

**RIGHT VIEW**

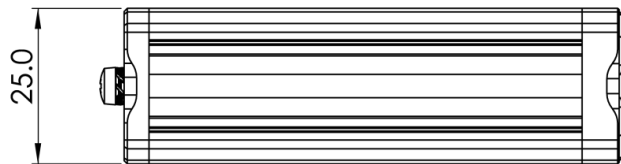
The figure below depicts the measurements of device and its components as seen from the right:

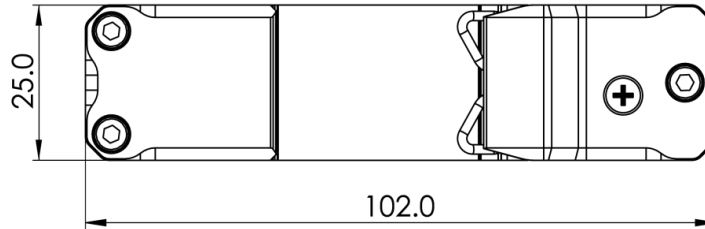

## REAR VIEW

The figure below depicts the measurements of device and its components as seen from the back panel side:



## FRONT VIEW

The figure below depicts the measurements of device and its components as seen from the front panel side:

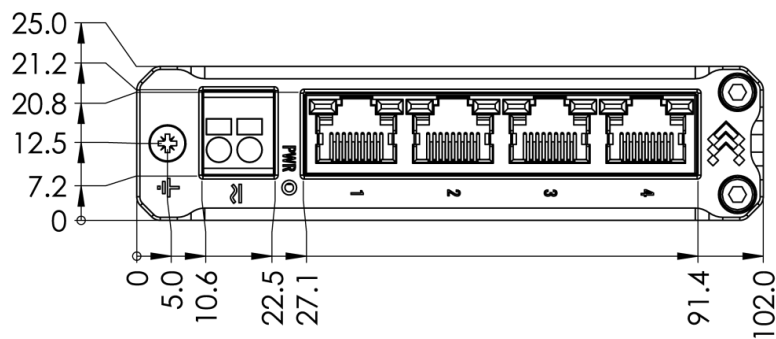

### MOUNTING SPACE REQUIREMENTS

The figure below depicts an approximation of the device's dimensions when cables and antennas are attached:

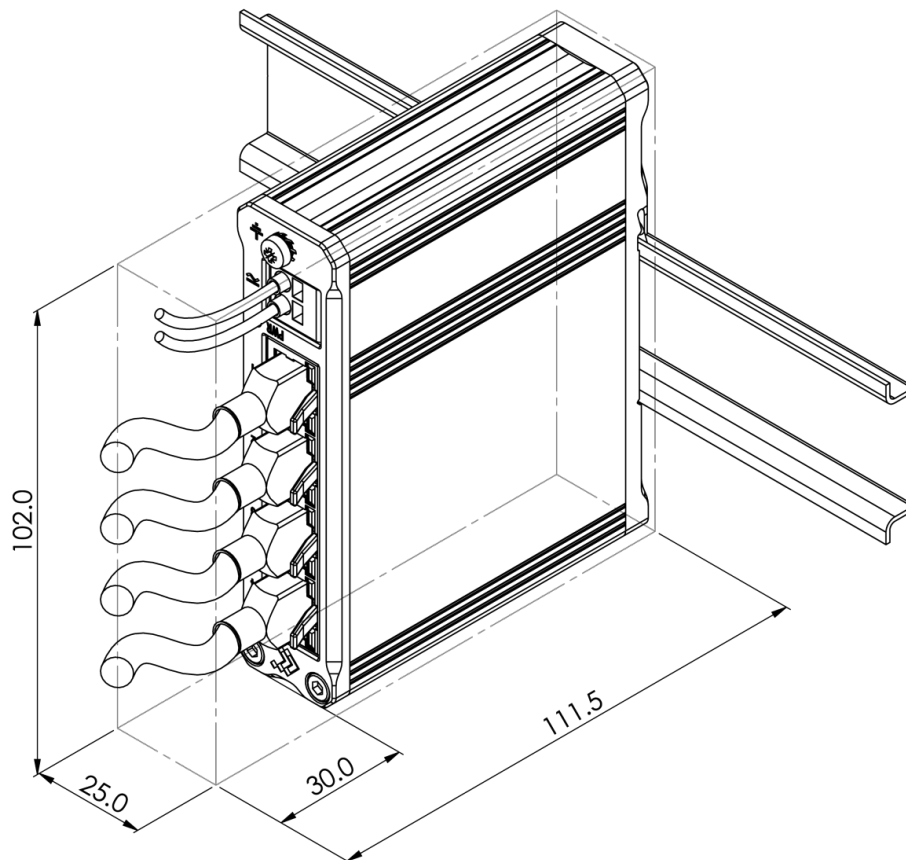



**DIN RAIL**

The scheme below depicts protrusion measurements of an attached DIN Rail:

