

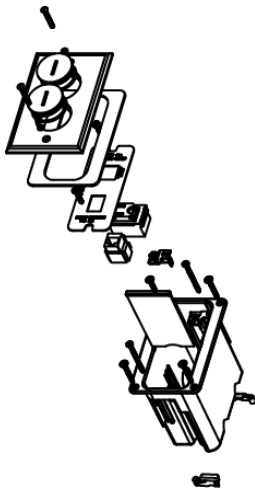

Wiremold
WMFB1SRKS1N Series Single-Gang Floor Box Assembly
Part No. WMFB1SRKS1N



Includes single-gang box, divider, one 15A, 125V receptacle, one opening for communication device, and nickel cover with two screw plugs. For hole cut dimensions, see installation instructions sheet. Box Dimensions: 2 1/8" W x 3 3/4" L x 3 7/8" D (54mm W x 95mm L x 98mm D) Device Plate: 3 1/8" W x 4 15/16" L (79mm W x 125mm L).

Features & Benefits

Includes single-gang box, divider, one 15A, 125V receptacle, one opening for communication device, and nickel cover with two screw plugs.

Box Dimensions: 2 1/8" W x 3 3/4" L x 3 7/8" D (54mm W x 95mm L x 98mm D) Device Plate: 3 1/8" W x 4 15/16" L (79mm W x 125mm L).

For hole cut dimensions, see installation instructions sheet.

Specifications

General Info

| | | | |
|-------------------|---|--------------------|--|
| Product Line | Wiremold | UPC Number | 786564054016 |
| Country Of Origin | Mexico | Material | PVC |
| Construction | Not Assembled | Cover Style | Surface |
| Cover Material | Nickel | Application Sector | Commercial, Residential |
| Standard | cULus Listed Nonmetallic Outlet Boxes: File E143222 Guide QCMZ. Meets Article 314.27(C) of NEC. | Warranty Type | 1-Year from Installation or 2-Years from Day of Sale |
| Type | Floor Box | | |

Dimensions

| | | | |
|------------------|----------|-------------------|---------|
| Product Width US | 2.125 in | Product Weight US | 1.07 lb |
|------------------|----------|-------------------|---------|

| | | | |
|------------------|----------|---------------|----------------|
| Product Depth US | 3.875 in | Knockout Size | 1/2 in, 3/4 in |
|------------------|----------|---------------|----------------|

Listing Agencies / 3rd Party Agencies

| | |
|--------------|-----|
| cULus Listed | Yes |
|--------------|-----|

Additional Information

| | |
|----------------|-----|
| RoHS Compliant | Yes |
|----------------|-----|

Technical Information

| | | | |
|------------|------|------------------|--------|
| Floor Type | Wood | Service Capacity | Single |
|------------|------|------------------|--------|

| | | | |
|---------------------|------|--------------|--------|
| Minimum Floor Depth | 5 in | Box Capacity | 1 Gang |
|---------------------|------|--------------|--------|

| | | | |
|-------------|---------------|----------|----------|
| Cable Entry | Through Floor | Box Type | Recessed |
|-------------|---------------|----------|----------|

| | |
|----------------------------|---------|
| Depth Behind Device Plates | 3.87 in |
|----------------------------|---------|
