

1. SPECIFICATION

APD-1405-KX2(RoHS)

ITEM		UNITS	SPECIFICATIONS	CONDITIONS
01	Rated Voltage	V	5	 Square wave 1/2 duty.
02	Operating Voltage	V	1 ~25	
03	Consumption Current	mA (Max)	3	
04	Sound pressure level (Distance at 10cm)	dB(A) (Min)	75	Rated voltage, rated frequency.
05	Capacitance	pF	12000±30%	At 1000Hz
06	Rated Frequency	Hz	4000± 500	

REV NO.	REVISION NOTE	APPROVAL	DATE
---------	---------------	----------	------

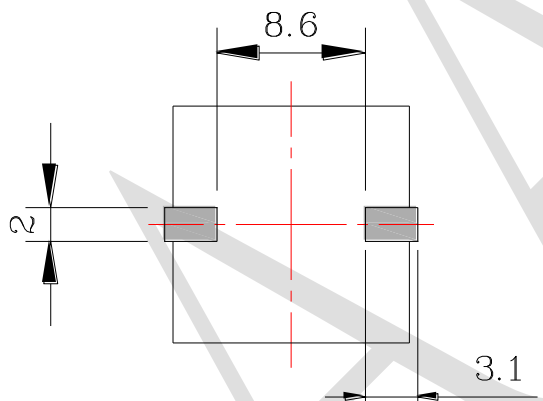
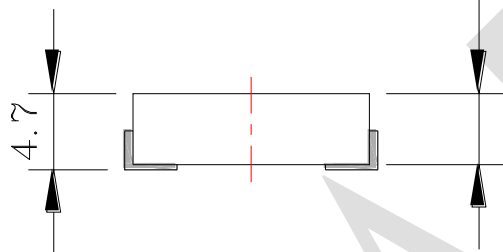
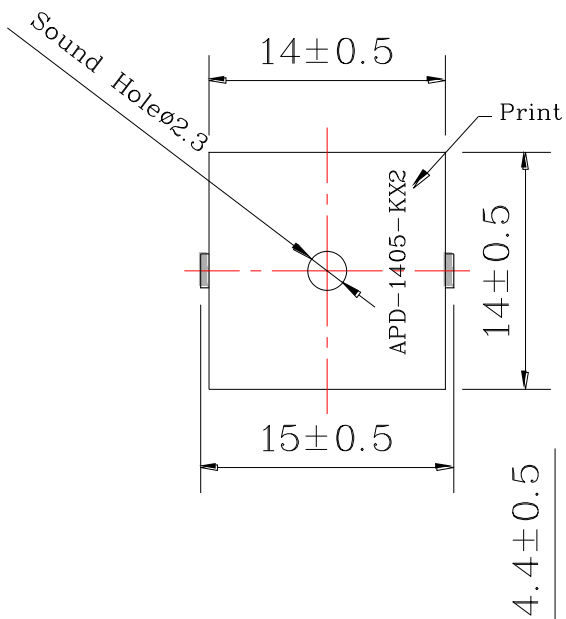

RECOMMENDED PCB LAYOUT

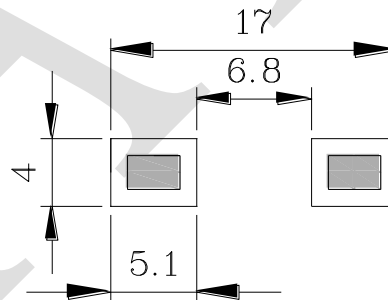

RoHS

TITLE: SMD PIEZO BUZZER		DRAWN: Moose	2018-02-12	SCALE: 2:1	SHEET: 1 of 1
PART NO. APD-1405-KX2		DESIGNED: R&D OF AAT		UNITS: mm	
DWG NO. LPT1440S-HS-05-4.0-12-R		CHECKED:		TOLERANCE \pm 0.3	
REV 3		APPROVAL:		UNLESS OTHERWISE SPECIFIED:	
		MATERIAL: PPS		ONE PLACE DECIMAL \pm ***	
				TWO PLACE DECIMAL \pm ***	
				THREE PLACE DECIMAL \pm ***	



ADVANCED ACOUSTIC TECHNOLOGY CORPORATION

For more information, please contact AATC.

AATC