

COMMENT:  
ALL RIGHTS ARE RESERVED BY US FOR THIS DRAWING. WITHOUT OUR PRIOR CONSENT,  
IT MAY NEITHER BE DUBLICATED NOR MADE AVAILABLE TO A THIRD PARTY,  
AND IT ALSO MAY NOT BE IMPROPERLY USED BY TE RECEIVER, OR A THIRD PARTY.

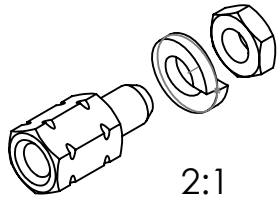

RoHS compliant

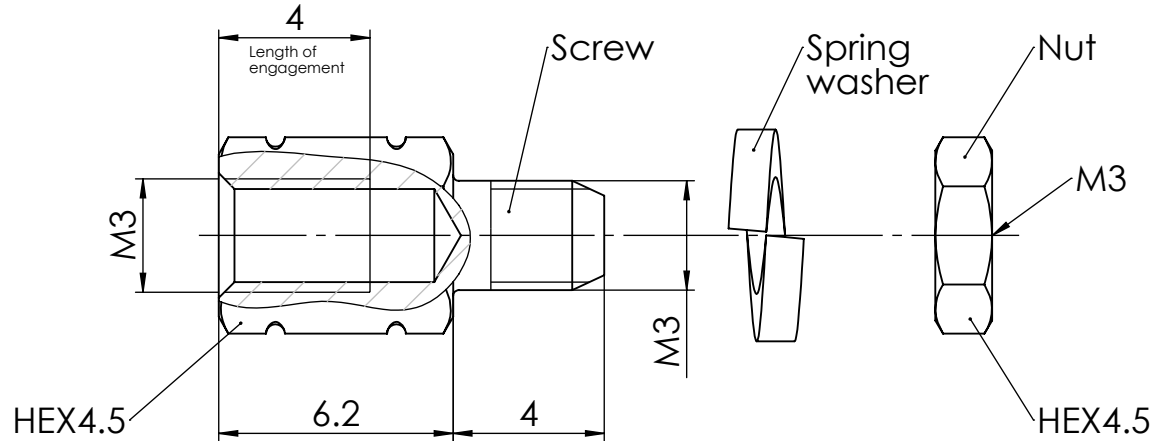

1731121023	F62M058S245+S	Steel (Lead free)	tin plated	1	-	-	-
1731120250	F-GSCH1/5-K699SN			1	-	1	1
<i>Material Number</i>	<i>FCT Part Number</i>	<i>Material</i>	<i>Surface</i>	<i>Screw (pc.)</i>	<i>Washer (pc.)</i>	<i>Spring Washer (pc.)</i>	<i>Nut (pc.)</i>

## FUNCTIONAL SYMBOLS

$$\begin{aligned} \nabla_A &= 0 \\ \nabla_C &= 0 \\ \nabla_P &= 0 \end{aligned}$$

THIS DRAWING CONTAINS INFORMATION THAT IS PROPRIETARY TO MOLEX ELECTRONIC TECHNOLOGIES, LLC AND SHOULD NOT BE USED WITHOUT WRITTEN PERMISSION

DIMENSION UNITS <b>mm</b>		SCALE <b>1:1</b>	MEASUREMENTS WITHOUT TOLERANCE ACC. TO ISO 2768-mK	
			CURRENT REVISION	
5	24410 / 24420		DRWN: DRAWN BY	mteubel 07-04-2025
4	24130		APPR: APPR BY	msteinbrueck 08-04-2025
3	22091			
2	2 1513		INITIAL REVISION	
1	21 222		DRWN: DRAWN BY	schref 28-05-2003
REV.	CH.-NO.		APPR: APPR BY	aschiekofer 28-05-2003

# molex

FCT Female Screw Lock  
F-GSCH1/5-K699

PRODUCT CUSTOMER DRAWING

MATERIAL NUMBER	
-----------------	--

see table

REVISION

5

REPLACEMENT FOR:

1731120250\_Rev.A1



FIRST ANGLE PROJECTION

DRAWING

A4-SIZE

DOCUMENT NUMBER

F62M058\_D

CUSTOMER

GENERAL MARKET

SHEET

1 OF 1

Generally twice a material number respectively FCT part number is needed per connector.

Packaging specification: 1731120003-PK