

SPECIFICATIONS:

MATERIALS:
HOUSING: PBT, UL94 V-0
CONTACTS: GOLD FLASH PLATED BRASS
SHELL: TIN PLATED STEEL

ELECTRICAL:
RATED CURRENT: 3A
WORKING VOLTAGE: 250V
INSULATION RESISTANCE: 1000 MOhms MIN.
CONTACT RESISTANCE: 15 mOhms MAX.

ENVIRONMENT:
OPERATING TEMPERATURE: -55°C TO +105°C

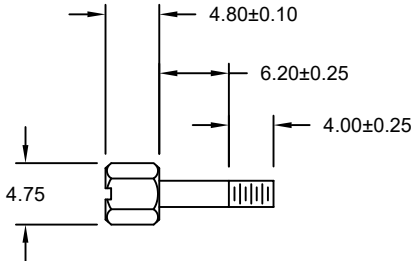
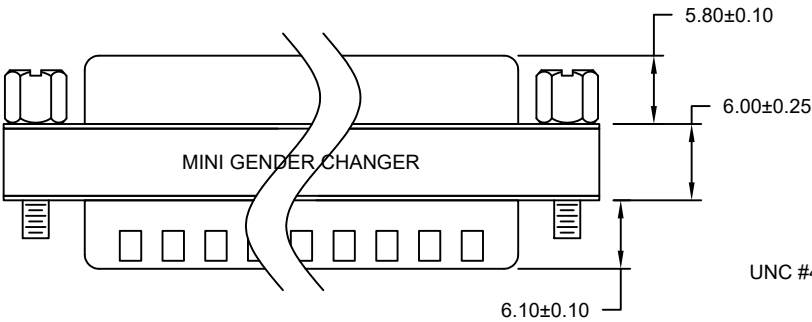
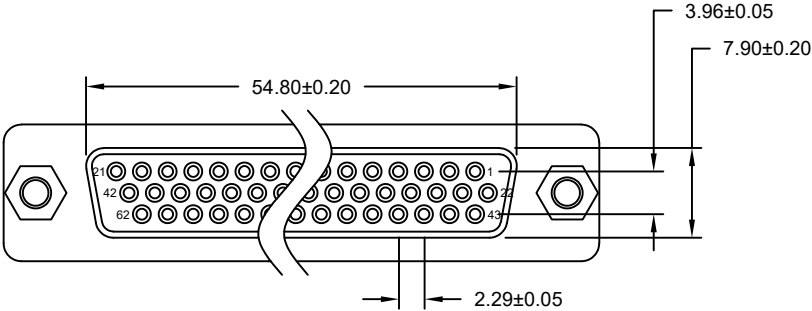

UNC #4-40 HEXSCREW (INTERNAL & EXTERNAL THREADS)

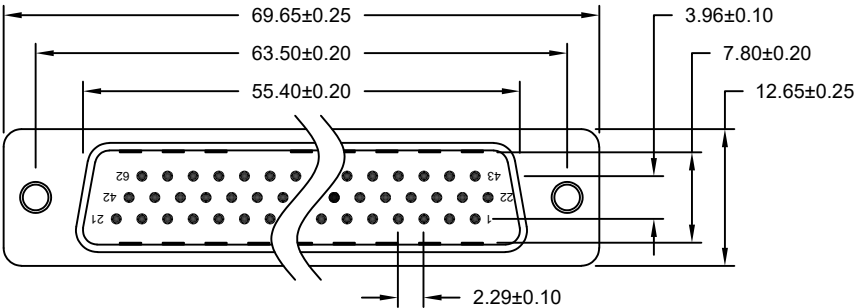

| 62-PIN MALE | | 62-PIN FEMALE |
|----------------|-----|------------------|
| 1 | --- | 1 |
| 2 | --- | 2 |
| 3 | --- | 3 |
| ~ | | |
| 61 | --- | 61 |
| 62 | --- | 62 |
| SHELL | --- | SHELL |
| — PIN OUT — | | |

RoHS COMPLIANT



THESE DRAWINGS AND SPECIFICATIONS ARE THE PROPERTY OF NorComp AND SHALL NOT BE REPRODUCED, COPIED OR USED AS THE BASIS FOR THE MANUFACTURE OR SALE OF APPARATUS WITHOUT WRITTEN PERMISSION.

DRAWN:
C. SMITH

DATE:
10/12/2007

UNITS = inch [mm]

DO NOT SCALE FROM DRAWING

NorComp

SCALE:
NTS

SHEET 1 OF 1

REV 4

DWG NO. GCHDLP62M62F