

DESCRIPTION: M16 // F // VERT PCB // REAR PANEL MOUNT // SHIELDED

SPECIFICATIONS:

MATERIALS:

HOUSING:	PA66, UL94 V-0, BLACK
CONTACTS:	GOLD FLASH PLATED BRASS
NUT:	NICKEL PLATED BRASS
SHELL:	NICKEL PLATED BRASS
ORING:	EPDM

ELECTRICAL:

RATED CURRENT:	7A (3,4,5A,5B) // 5A (6,7A,7B,8) // 3A (12)
RATED VOLTAGE:	250V (3,4,5A,5B,6,7A,7B,8) // 60V (12)
INSULATION RESISTANCE:	100 MOhms MIN.
CONTACT RESISTANCE:	10 mOhms MAX.

ENVIRONMENT:

OPERATING TEMPERATURE:	-40°C TO +85°C
WATER PROOF:	IP67

TORQUE:	0.7Nm to 1.5Nm
---------	----------------

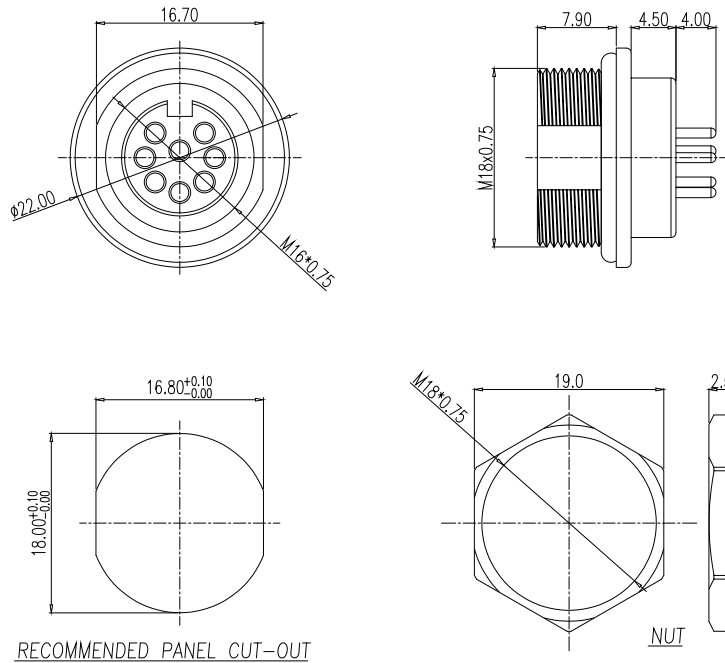

880-YYY-213R001

POSITIONS (SEE POSITION CHART)

003 = 3 POSITION
004 = 4 POSITION
05A = 5(A) POSITION
05B = 5(B) POSITION
006 = 6 POSITION
07A = 7(A) POSITION
07B = 7(B) POSITION
008 = 8 POSITION
012 = 12 POSITION

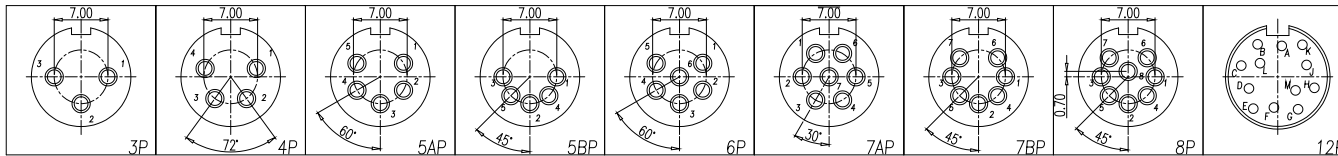

POSITION CHART (MATING SIDE SHOWN)

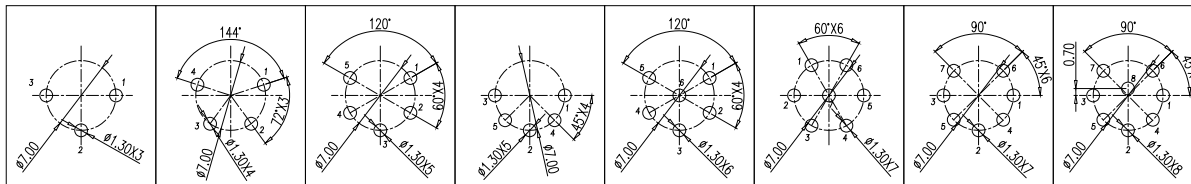

RECOMMENDED PCB LAYOUT // ALL PCB HOLE SIZES 1.30mm+0.10mm/-0.00mm (Except 12P)

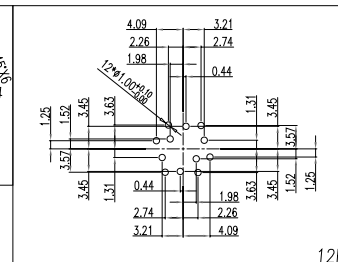

12P

UNITS = mm

DO NOT SCALE FROM DRAWING



THESE DRAWINGS AND SPECIFICATIONS ARE THE PROPERTY OF NorComp AND SHALL NOT BE REPRODUCED, COPIED OR USED AS THE BASIS FOR THE MANUFACTURE OR SALE OF APPARATUS WITHOUT WRITTEN PERMISSION.

DRAWN:

J. KADEL

DATE:

09/05/2023

NorComp

SCALE:

NTS

SHEET

OF

1

1

REV

4

DWG NO.

880-YYY-213R001