

DESCRIPTION: 0.085 RIBBON - SOLDER CUP

SPECIFICATIONS:

ELECTRICAL:

CURRENT RATING:	1 AMPS
INSULATION RESISTANCE:	1,000 MΩ MIN. @ 500 VDC
DIELECTRIC WITHSTANDING VOLTAGE:	1,000 VAC FOR 1 MINUTE
CONTACT RESISTANCE:	30 mΩ MAX.
OPERATING TEMPERATURE:	-55°C TO +105°C

MATERIALS:

INSULATION:	PBT, UL94 V-0 RATED
CONTACTS:	PHOSPHOR BRONZE
CONTACT PLATING:	GOLD FLASH IN MATING AREA BRIGHT TIN IN SOLDER AREA
SHELL:	STEEL, NICKEL PLATED

DIMENSIONS(mm)			
SIZE	A±0.38	B±0.25	C±0.25
14	44.00	25.50	36.00
24	54.70	36.20	46.70
36	67.70	49.00	59.70
50	82.70	64.50	74.70

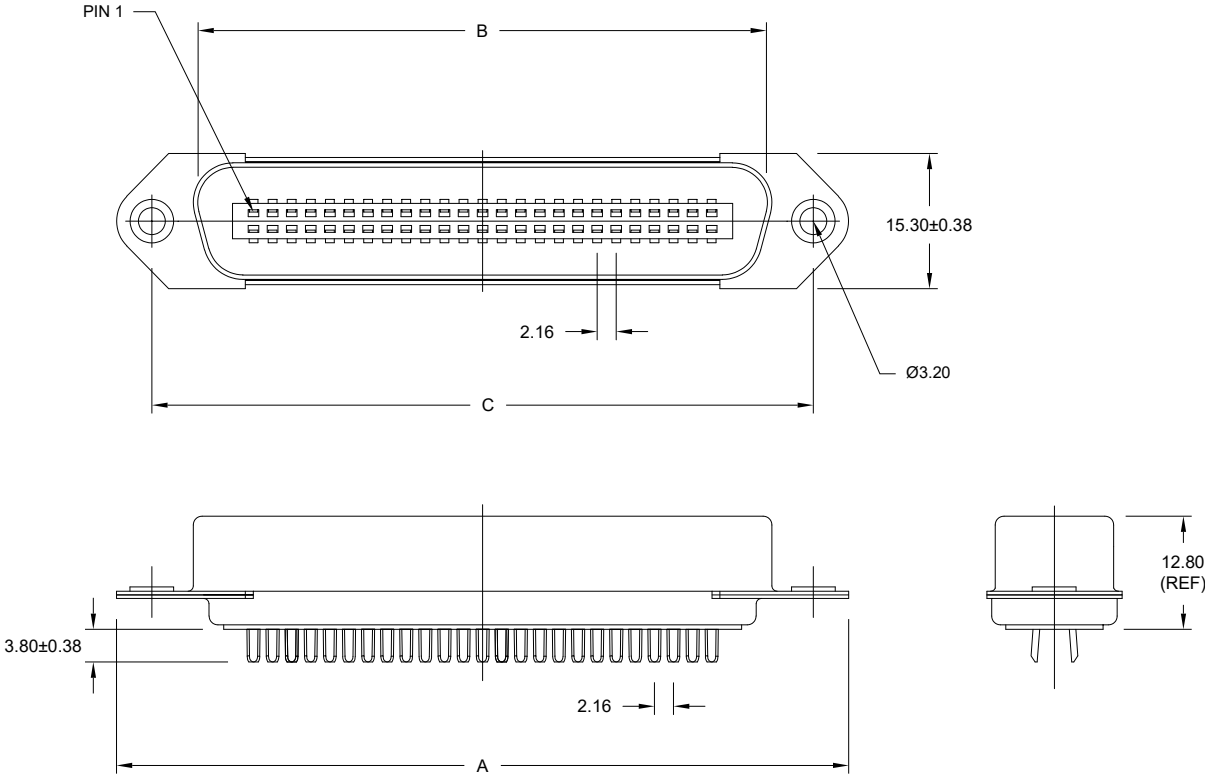

111-YYY-1 0 3 L 00 1									
SERIES	POSITIONS	014	024	036	050	GENDER	TERMINATION	SHELL PLATING	HARDWARE
						1 = MALE	0 = SOLDER CUP		00 = NO HARDWARE
								3 = NICKEL	
									1 = GOLD FLASH

WILL ACCEPT 26-20 AWG WIRE

RoHS COMPLIANT



THESE DRAWINGS AND SPECIFICATIONS ARE THE PROPERTY OF NorComp AND SHALL NOT BE REPRODUCED, COPIED OR USED AS THE BASIS FOR THE MANUFACTURE OR SALE OF APPARATUS WITHOUT WRITTEN PERMISSION.

DRAWN:
WAYNE ROBBINS
DATE:
01/16/2019

UNITS = mm

DO NOT SCALE FROM DRAWING

NorComp

SCALE: NTS	SHEET 1	OF 2	REV 15
DWG NO.	111-YYY-103L001		

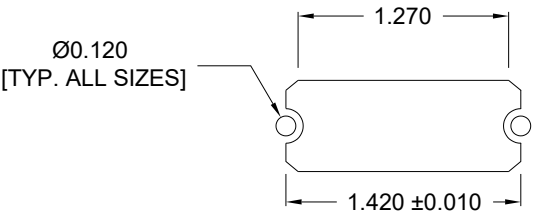

14 POSITION

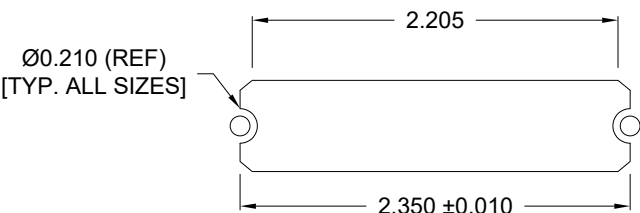

36 POSITION

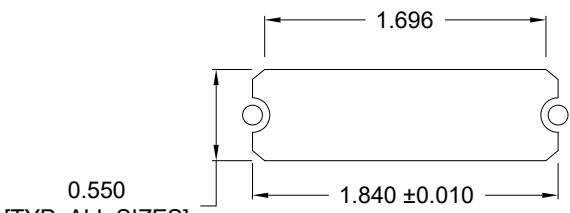

24 POSITION

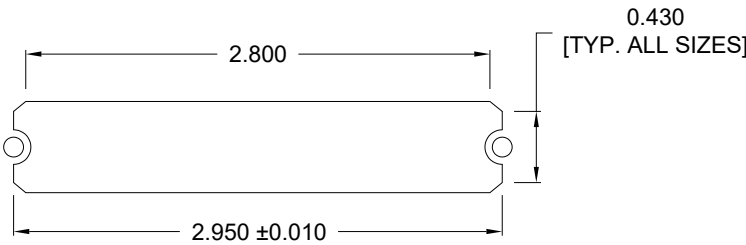

50 POSITION

RoHS COMPLIANT



THESE DRAWINGS AND SPECIFICATIONS ARE THE PROPERTY OF NorComp AND SHALL NOT BE REPRODUCED, COPIED OR USED AS THE BASIS FOR THE MANUFACTURE OR SALE OF APPARATUS WITHOUT WRITTEN PERMISSION.	DRAWN: WAYNE ROBBINS
	DATE: 01/16/2019

UNITS = inch

DO NOT SCALE FROM DRAWING

NorComp

SCALE: NTS	SHEET 2 OF 2	REV 15
DWG NO. 111-YYY-103L001		