

PANEL MOUNTING
MAX. PANEL THICKNESS 4mm

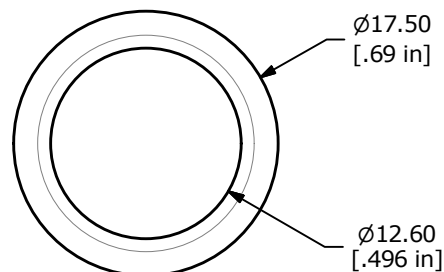

▲ DOMED ACTUATOR
COLOR: BLACK

▲ BODY:
STAINLESS STEEL

M12 x 1.0
THREAD

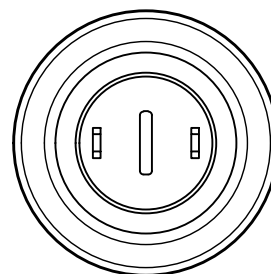
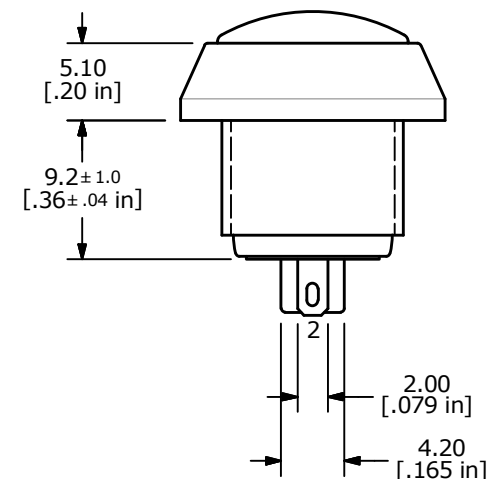
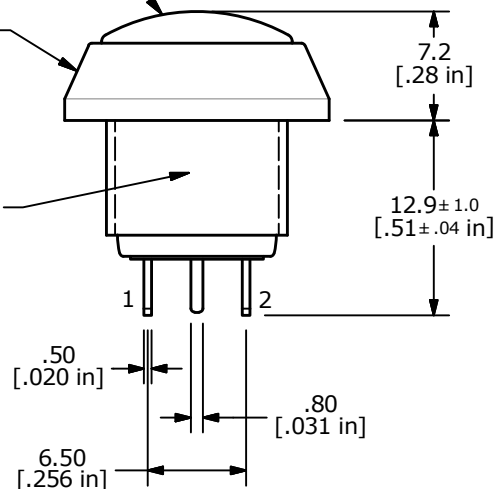

SWITCH FUNCTION	
POS. 1	POS. 2
OFF	(ON)
OPEN	1-2

(ON) = MOMENTARY

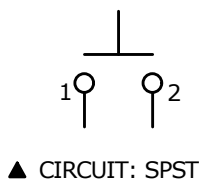

NOTE:

- ALL DIMENSIONS IN MM [INCH]
- GENERAL TOLERANCE: X.X = ± 0.4
X.XX = ± 0.25
- TERMINAL NUMBERS FOR REF ONLY
- ▲ CONTACT MATERIAL: SILVER
- RATING: 2A @ 36 VDC
- ELECTRICAL LIFE: 200,000 CYCLES
- CONTACT RESISTANCE: 50 mΩ MAX. @ 1A 12VDC (INITIAL)
- INSULATION RESISTANCE: 1,000 MΩ MIN. @ 500VDC
- DIELECTRIC STRENGTH: 2,000 VAC rms.
- OPERATING TEMPERATURE: -20°C to +70°C
- PANEL THICKNESS MAX: 4.0 mm.
- INGRESS PROTECTION: IP65
- ▲ DENOTES CRITICAL PARAMETER.
- ▲ 14. HARDWARE INCLUDED, 1 O-RING & 1 HEX NUT (NOT SHOWN)



E-SWITCH®

A	24193	RELEASE	2/17/20	MW
REV	PCR NO	DESCRIPTION	DATE	BY

THE INFORMATION CONTAINED IN THIS DOCUMENT IS PROPRIETARY
TO E-SWITCH AND IS NOT TO BE COPIED OR TRANSFERRED

TITLE PV5S240S1

SCALE
2:1

DATE
2/17/2020

DR
MW

DWG
52-PV5S240S1

REV
A