

PANEL MOUNTING
MAX. PANEL THICKNESS 4mm

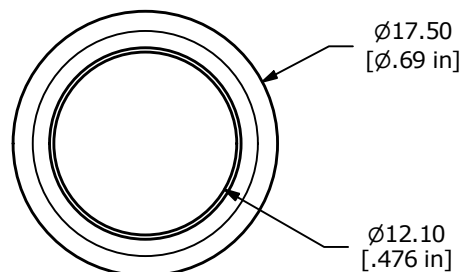

▲ SWITCH FUNCTION

POS. 1	POS. 2
OFF	(ON)
OPEN	1-2

(ON) = MOMENTARY

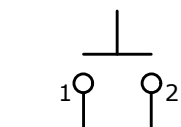

▲ CIRCUIT: SPST

▲ RAISED ACTUATOR
COLOR: GREEN

▲ BODY
STAINLESS STEEL

M12x1.0
THREAD

1 2

9.2±1.0
[.36±.04 in]

3.91
[.15 in]

10.3±1.0
[.41±.04 in]

12.7±1.0
[.50±.04 in]

5.30
[.21 in]

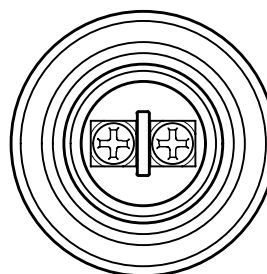

NOTE:

1. ALL DIMENSIONS IN MM [INCH]
2. GENERAL TOLERANCE: X.X = ±0.4
X.XX = ±0.25
3. TERMINAL NUMBERS FOR REF ONLY
- ▲ 4. CONTACT MATERIAL: SILVER
5. RATING: 2A @ 36 VDC
6. ELECTRICAL LIFE: 200,000 CYCLES
7. CONTACT RESISTANCE: 50 mΩ MAX. @ 1A 12VDC (INITIAL)
8. INSULATION RESISTANCE: 1,000 MΩ MIN. @ 500VDC.
9. DIELECTRIC STRENGTH: 2,000 VAC rms.
10. OPERATING TEMPERATURE: -20°C to +70°C.
11. PANEL THICKNESS MAX: 4.0 mm.
12. INGRESS PROTECTION: IP65
13. ▲ DENOTES CRITICAL PARAMETER.
- ▲ 14. HARDWARE INCLUDED: 1 O-RING & 1 HEX NUT (NOT SHOWN)



A	24726	RELEASE	2/26/21	MW
REV	PCR NO	DESCRIPTION	DATE	BY

THE INFORMATION CONTAINED IN THIS DOCUMENT IS PROPRIETARY
TO E-SWITCH AND IS NOT TO BE COPIED OR TRANSFERRED

TITLE PV5H640S8

SCALE 2:1	DATE 2/3/2021	DR MW	DWG 52-PV5H640S8	REV A
--------------	------------------	----------	---------------------	----------