

Parts List				
ITEM	QTY	PART NUMB	DESCRIPTION	
1	1	F060614	LASEEU11	
2	1	F060250	29MM LA U1 NUT	
3	1	F050420	50-004-20 (RED LED)	
4	1	F051701	29MM RING FOR LA SERIES	
5	1	F060214	29MM RED LENS	

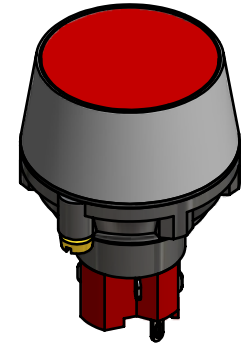

ISOMETRIC

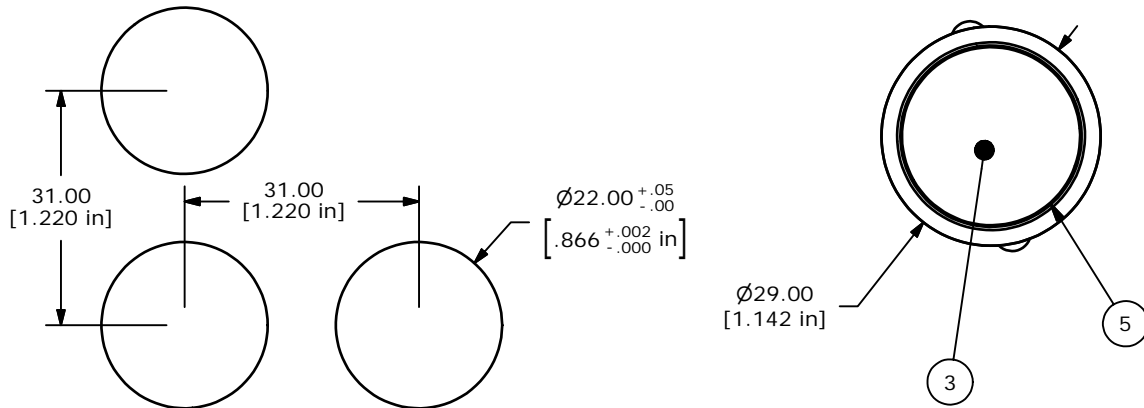
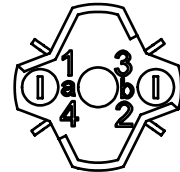

RECOMMEND PANEL MOUNTING

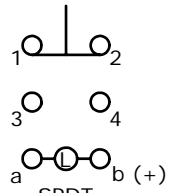

SPDT CONTACT CONFIGURATION

NOTES:

- ALL DIMENSIONS IN MM [INCH].
- GENERAL TOLERANCE: 0.0±0.4
0.00±0.25
- TERM. NOS. FOR REF. ONLY.
- RATING: 5A @250VAC
8A @125VAC
.2A @250VDC
6A @24VDC
- ELECTRIC LIFE: 25,000 MAKE-OR-BREAK CYCLES AT FULL LOAD.
- INSULATION: 1,000 MΩ MIN.
- DIELECTRIC STRENGTH: 2000V FOR 1 MIN.
- OPERATING TEMP: -25°C TO 55°C
- LENS COLOR: RED
- LAMP: LED 12VDC RED

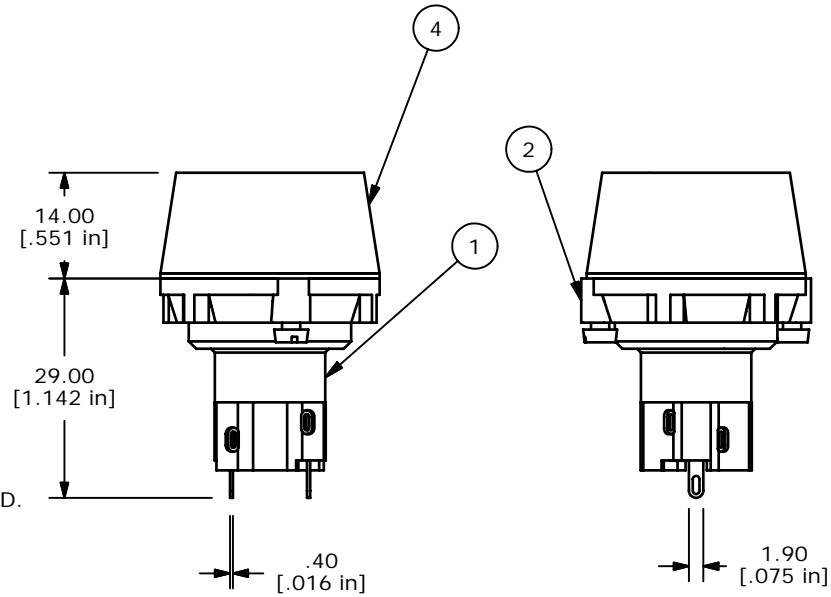

REV	PCR NO	DESCRIPTION	DATE	BY
B	15341	CHANGES TO PARTS LIST ITEM 1	9/28/05	PH
A	15332	CREATED NEW DWG FROM F060625	9/26/05	PH

TITLE LASEEU11JREDRED				
SCALE 1:1	DATE 9/26/2005	DR PH	DWG XF0644P	REV B

THE INFORMATION CONTAINED IN THIS DOCUMENT IS PROPRIETARY TO E-SWITCH AND IS NOT TO BE COPIED OR TRANSFERRED