

THIS IS A C.A.D. GENERATED DRAWING  
DO NOT MAKE MANUAL REVISIONS TO MASTER.

ISSUE NUMBER

ORIGINAL	①
UPDATE ELECTRICAL CHARACTERISTICS R.STA.MONICA JAN.21/2013	②
PANEL CUTOUT ADDED N.SONDH OCT.14/14	③
ADD NOTES: MECHANICAL PANEL CUTOUT REVISED R.STA.MONICA OCT.28/2014	④
UPDATE DWG AS PER NEW SUPPLIER DWG. P.M. NOV. 05/2019	⑤

SPECIFICATIONS

1. DVI-I

- 1.1 Voltage: 40 VAC(RMS) Max.
- 1.2 Current Rating: 1.5 Ampere per Contact
- 1.3 Contact Resistance: 20 Milliohms Max.
- 1.4 Insulation Resistance: 1000 Megohms Min.
- 1.5 Dielectric Withstanding Voltage: 500V DC(RMS)
- 1.6 Total Mating Force: 4.5 Kgf Max.
- 1.7 Total Unmating Force: 1.0 Kgf Min.
- 1.8 Operating Temperature: -55°C to +85°C

NOTES

1. MATERIAL:

Housing:PA66, UL 94V-0, Color:Ivory.  
Terminal:Copper Alloy.  
Shell:SPCC  
Boardlock:Copper Alloy.

2. FINISH:

Terminal:Gold Plated over Nickel at Contact Area.  
Tin Plated over Nickel at Solder Area.  
Shell:Nickel Plated.  
Boardlock:Tin Plated.

3. This Product is LEAD-FREE & RoHS Compliance Product.

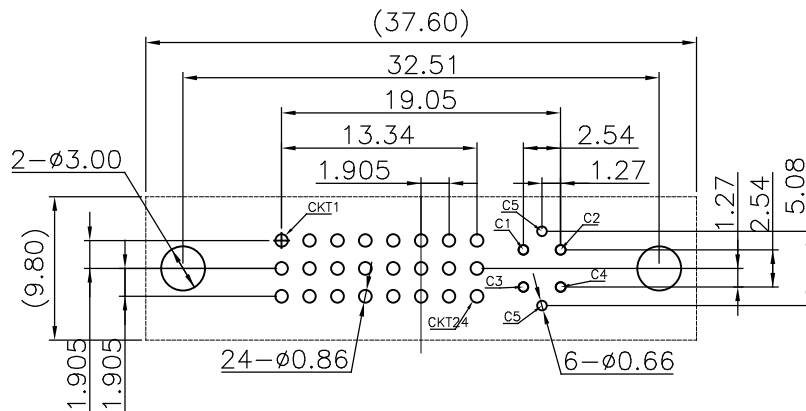
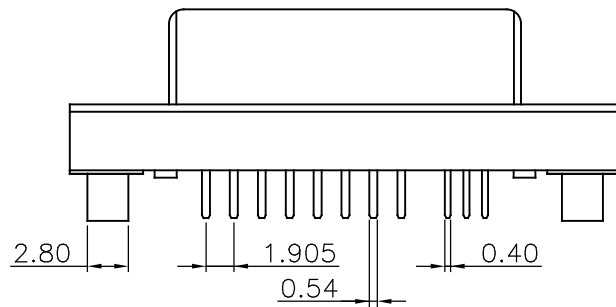
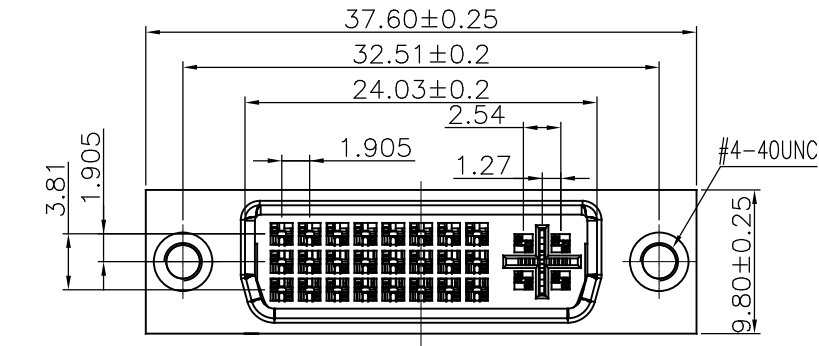

RECOMMENDED P.C.B LAYOUT

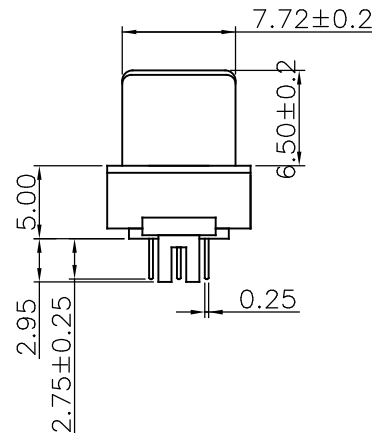

THIS SERIES FULLY CONFORMS TO THE  
EUROPEAN UNION DIRECTIVES 2002/95/EC  
AND 2002/96/EC FOR RoHS COMPLIANCY.

DVI-I RECEPTACLE VERTICAL CONNECTOR  
WITH GROUND POST



YOUR CONNECTION TO QUALITY & SERVICE

EDAC INC  
TORONTO, ONTARIO  
CANADA

THESE DRAWINGS AND SPECIFICATIONS  
ARE THE PROPERTY OF EDAC INC. AND  
SHALL NOT BE REPRODUCED OR COPIED  
OR USED AS THE BASIS FOR THE  
MANUFACTURE OR SALE OF APPARATUS  
WITHOUT WRITTEN PERMISSION.

ACAD REFERENCE NO. B10-029-220-032	
DRAWN: RSM	DATE: NOV. 05/2019
PART NUMBER B10-029-220-032	
DRAWING NUMBER B10-029-220-032	ISSUE 5