

P+ docking frame, socket side, 20 units

Reinforced frame design for highest mechanical requirements. High tolerance compensation: Axial play: 1 mm - Radial play: ± 2.5 mm. Double-sided floating supported. Recommended for modules with contact diameter > 5 mm or frame length > 40 units (depending on configuration). Mandatory for modules with contact diameter > 8 mm. Available in sizes from 5 to 60 units, from 61 on request. Non-magnetic version available upon request.



Basic information

Part number	610.730.020.600.000
Category	Frame
Number of units	20

Contact insert description

Contact diameter	0 mm
------------------	------

Mechanical and environmental data

Keying	Without keying
Mating cycles	minimum 100.000
Weight	111.06 g

In the ODU-MAC Silver-/ White-Line product portfolio we explicitly recommend that the modules are purchased assembled with the frames in order to prevent possible errors in the assembly process. Only in exceptional cases we can supply individual parts. However we cannot take any liability therefore. We would like to emphasize the usage of our ODU tools, as well as our current assembly instructions in the download area: <https://odu-connectors.com/silver-white-line-instructions>

ODU reserves the right to make changes based on the current state of knowledge without prior notice without being obliged to provide replacement deliveries or refinements of older designs.

Graphics and technical drawings

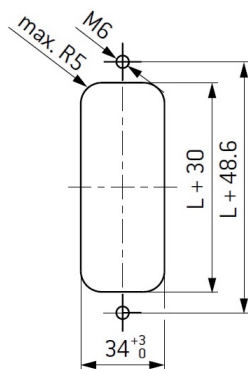
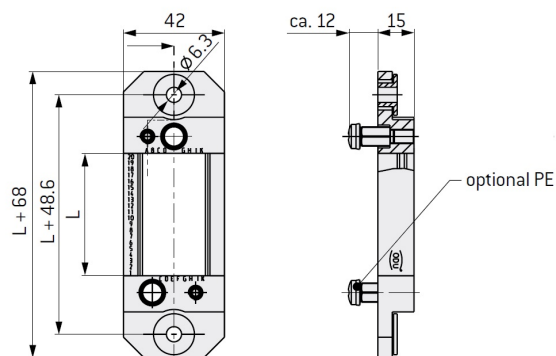

Further technical information and downloads

[3D-File \(STP File\)](#)

[Assembly Instruction](#)