

**SECTION A-A**

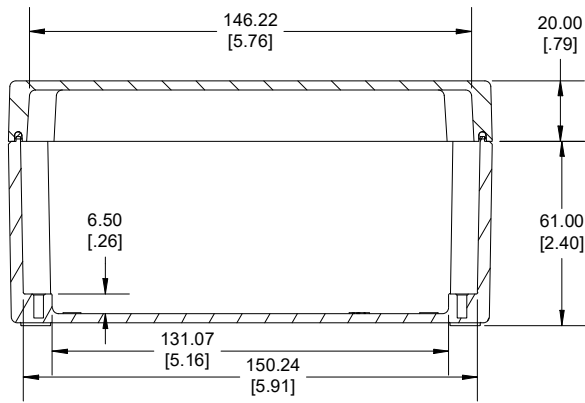

**SECTION B-B**

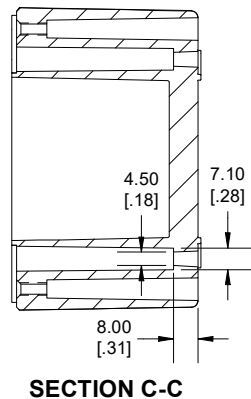
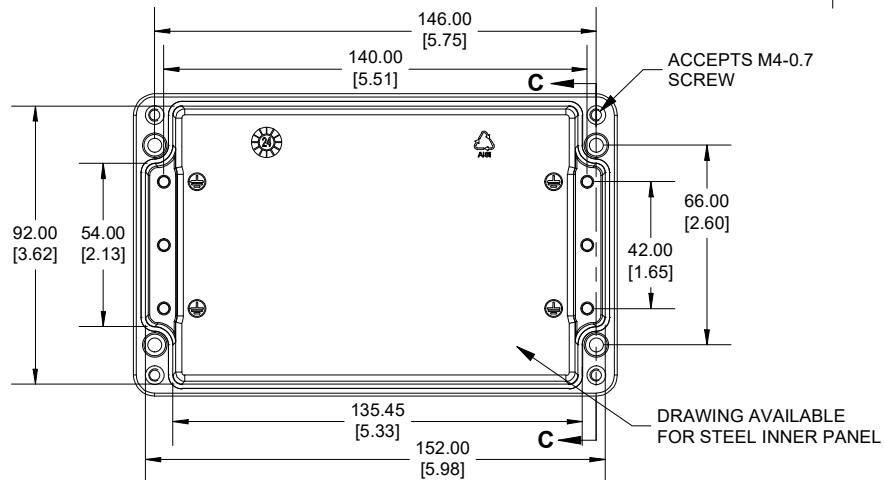
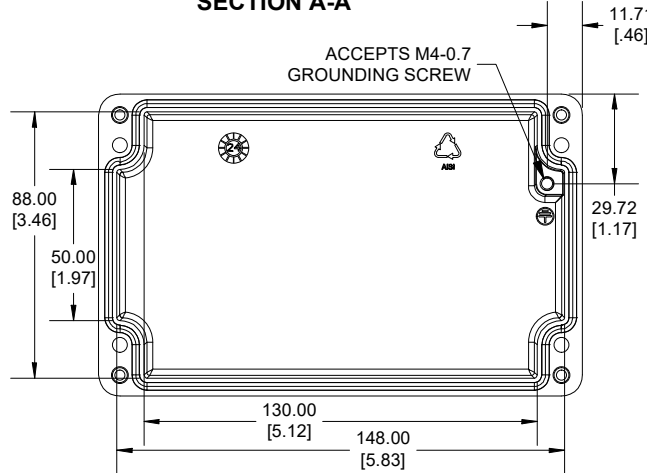

**SECTION C-C**

**Dimensions:**  
mm  
[inches]

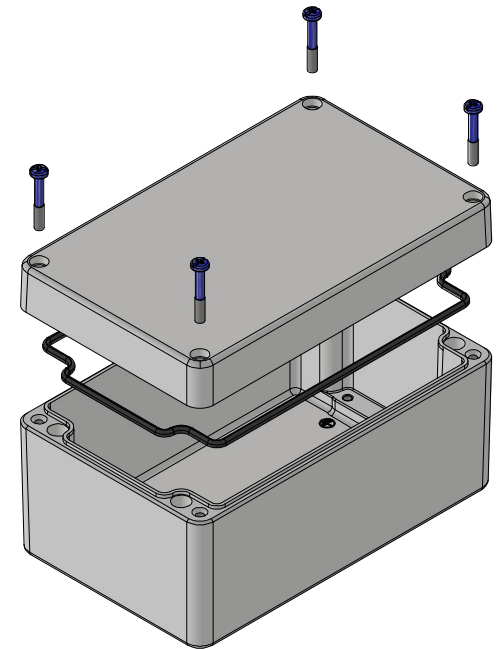

Enclosures can be Factory Modified (Milling, Drilling, Printing etc.)  
Contact Factory (modshop@hammfg.com) for quotes  
Solid models of this enclosure available in .stp or .x\_t  
(Part number and text placement/orientation on our products are subject to change,  
we do not recommend using them as a locating reference for modification purposes)

**NOTE**

Purchased assembly includes box, lid, silicone gasket,  
4 cover screws and 2 ground screws with washers.  
Box and lid are made from Diecast Aluminum Alloy.

**Recommended cover screw Torque 6.6-8.8 lbf.in (75-100 cN.m)**

**1590Z125**

**1590Z125 Enclosure**

Natural Enclosure	1590Z125
Black Enclosure	1590Z125BK
Grey Enclosure - RAL7001 Gloss	1590Z125GY

**ACCESSORIES**

Steel Inner Panel	1590Z125PL
Pre-Formed Silicone Gasket (2 Pack)	1590Z125G
Copper Ground Hardware (50 Pack) [M4 - 0.7 X 6mm / M4 Washer]	SCGM4-50
Stainless Steel Cover screws (50 pkg) [M4 - 0.7 x 25mm PN]	SC583-50



**1590125**

www.hammondmfg.com