

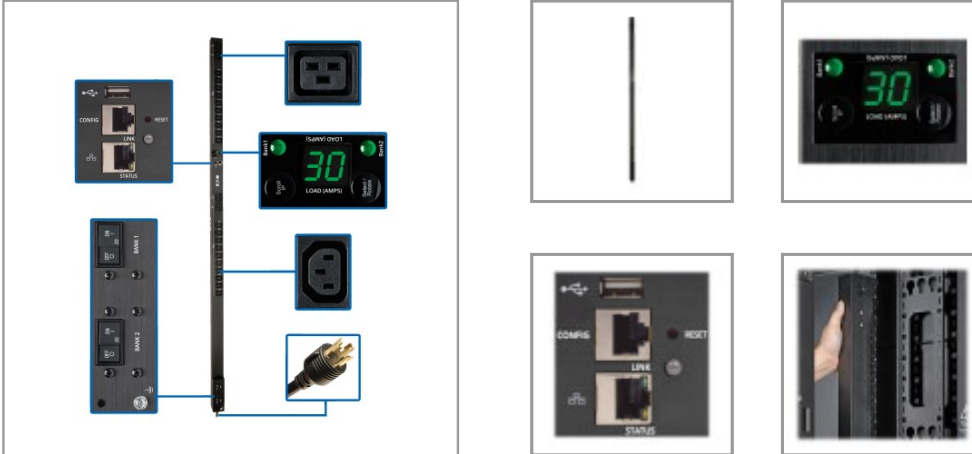

Powering Business Worldwide

5.5kW Single-Phase Switched PDU - LX Interface, 208/230V Outlets (20 C13 & 4 C19), L6-30P, 0U, TAA

MODEL NUMBER: PDUMV30HVNETLX



Cost-effective 5.5kW PDU distributes, monitors and manages single-phase power in an IT or industrial environment. Built-in network interface helps monitor load levels to prevent overloads that cause downtime.

Description

The PDUMV30HVNETLX 5/5.5kW Single-Phase Switched PDU provides advanced network control and remote power monitoring with the ability to turn on, turn off, reboot or lock out power to each outlet. Recommended for any IT or industrial application, it features 24 switched outlets (20 C13 and 4 C19) with included plug-lock insert sleeves to prevent cables from becoming accidentally disconnected. LEDs indicate each outlet's on/off power status. A 10-ft. (3.05 m) cord with NEMA L6-30P plug connects the PDU to a compatible AC power source, generator or protected UPS.

The built-in Java-free HTML5-based LX Platform network interface enables full remote access for PDU status monitoring and email notifications via secure web browser, SNMP, telnet or SSH. It supports 10/100 Mbps auto-sensing for optimum communication with an Ethernet network. Optional EnviroSense2 modules (sold separately) provide a variety of environmental monitoring capabilities. Protocols supported include HTTP, HTTPS, SMTP, SNMPv1, SNMPv2c, SNMPv3, telnet, SSH, FTP, DHCP and NTP.

A digital ammeter allows you to monitor each bank's load in real time to ensure it remains well below maximum capacity with no danger of overload. The PDU mounts in 0U of space in EIA-standard 19-inch racks using the included toolless mounting buttons or the included rack-mounting brackets. Use the included PDUMVROTATEBRKT kit to install the unit with outlets facing the rear for better airflow or equipment access.

Features

Distributes Network-Grade Single-Phase Power 5/5.5kW 208/230V 24A switched rack PDU (rPDU) with single-phase input/output Recommended for network applications requiring individual outlet control, load shedding and remote monitoring of critical network components NEMA L6-30P plug with 10-ft. (3.05 m) cord connects to compatible AC power source Firmware upgrades support future product enhancements

24 Switched Outlets Distribute AC Power 20 C13 and 4 C19 outlets split into 2 separately breakered load banks Individual outlets can be remotely controlled to power up, power down, reboot or lock out devices Plug-lock inserts prevent cables from becoming accidentally disconnected

Digital Ammeter Reports load level on each bank and total PDU output Supports IP-address self-ID Rotates 180° for easy reading at either angle

Built-In LX Platform Interface Pre-installed WEBCARDLX with the latest version of PowerAlert Device Manager firmware (PADM20) provides enhanced remote management capabilities PADM20 and

Highlights

- 5/5.5kW 208/230V 30A switched PDU
- 24 individually controllable outlets—20 C13, 4 C19
- Pre-installed WEBCARDLX with latest version of PADM20 for IP-based Auto Probe feature
- Digital ammeter for on-site load monitoring in real time
- NEMA L6-30P input with 10-ft. (3.05 m) AC power cord

Package Includes

- PDUMV30HVNETLX 5/5.5kW Single-Phase Switched PDU
- Configuration cable
- (24) Plug-lock inserts
- Rack-mounting hardware
- PDUMVROTATEBRKT mounting bracket accessory
- Owner's manual



Powering Business Worldwide

PowerAlert Element Manager (PAEM) form a powerful tool for expanding maintenance functions in large installations, including firmware update checks and backup and restoration of device configurationsIP-based Auto Probe detects lost connectivity and restores service autonomouslyOptional EnviroSense2 modules (sold separately) provide a variety of environmental monitoring capabilitiesNo Java required

Broad Communications CompatibilitySupports HTTP, HTTPS, SMTP, SNMPv1, SNMPv2c, SNMPv3, telnet, SSH, FTP, DHCP and NTPSupports automatic and manual assignment of IP address

Easy 0U Installation in EIA-Standard 19 in. RacksMounts vertically using included toolless buttons or rack-mounting bracketsIncluded PDUMVROTATEBRKT allows mounting with rear-facing outlets

TAA-CompliantCompliant with the Federal Trade Agreements Act (TAA) for GSA Schedule purchases

Specifications

OVERVIEW	
UPC Code	037332202550
PDU Type	Switched
INPUT	
Input Phase	Single-Phase
PDU Input Voltage	208; 230
Recommended Electrical Service	Single-phase 30A 208/230V service
Maximum Input Amps	24
Maximum Input Amps Details	Agency de-rated to 24A continuous
PDU Plug Type	NEMA L6-30P
Input Cord Length (ft.)	10
Input Cord Length (m)	3.05
OUTPUT	
Output Capacity Details	5.5kW (230V), 5kW (208V) total capacity / 30A max (Agency de-rated to 24A), 20A max per breakered outlet bank; 16A max per C19 outlet; 12A max per C13 outlet
Frequency Compatibility	50 / 60 Hz
Output Receptacles	(20) C13; (4) C19
Output Nominal Voltage	208/230V
Overload Protection	Two 20A breakers protect 12 outlets each
Customized Load Management Receptacles	Each outlet is individually controllable via remote interface
USER INTERFACE, ALERTS & CONTROLS	
Front Panel LCD Display	Digital display reports output amps in 3 separately metered loading segments (BANK 1: Outlets #1-12; BANK 2: Outlets #13-24; BANK 3: All outlets combined)
Switches	Pushbutton scroll button enables local power consumption display of each load bank, display rotate and display IP address functions. LX Platform Interface: Recessed reset switch for interface reboot and factory reset



Powering Business Worldwide

LED Indicators	24 power availability LEDs confirm power off/on status for each built-in outlet; Network Link/Activity Status LED (Yellow), Network Speed LED (Green); LX Platform status LED (Green)
SURGE / NOISE SUPPRESSION	
Automatic Shut-Off	No
PHYSICAL	
Material of Construction	Metal
Rack Height	0U
Form Factors Supported	0U vertical rackmount. Includes mounting brackets. Supports toolless mounting in button-mount compatible racks
PDU Form Factor	Vertical (0U)
Shipping Dimensions (hwd / in.)	5.00 x 6.20 x 73.00
Shipping Dimensions (hwd / cm)	12.70 x 15.75 x 185.42
Shipping Weight (lbs.)	15.60
Shipping Weight (kg)	7.08
Unit Dimensions (hwd / in.)	70.000 x 2.190 x 2.650
Unit Dimensions (hwd / cm)	177.8 x 5.6 x 6.7
Unit Weight (lbs.)	11.5
Unit Weight (kg)	5.22
ENVIRONMENTAL	
Operating Temperature Range	32° to 104°F (0° to 40°C)
Storage Temperature Range	-22° to 140°F (-30° to 60°C)
Relative Humidity	0-95% non-condensing
Operating Elevation	0-10000 ft. (0-3000 m)
COMMUNICATIONS	
PowerAlert Software	LX Platform Interface: PowerAlert Device Manager
Communications Cable	RJ45-to-DB9 configuration/console Access cable
Network Monitoring Port	RJ45 Network port, RJ45 Serial Config/Console Access port; USB A port supports a variety of EnviroSense2 environmental and control modules. See Accessories>Management Hardware section for more information about these modules.
SNMP Compatibility	Pre-installed LX platform interface provides remote monitoring via Java-free HTML5 web interface, telnet, SSH and SNMP management systems
Network Compatibility	10 Mbps; 100 Mbps (Fast Ethernet)
FEATURES & SPECIFICATIONS	
High Availability PDU Features	Auto Probe Monitoring and Reboot (included); Auto Load Shedding
STANDARDS & COMPLIANCE	
Product Certifications	NOM (Mexico); UL 60950-1



Powering Business Worldwide

Product Compliance	RoHS; FCC Part 15 Class A (USA); Trade Agreements Act (TAA)
WARRANTY & SUPPORT	
Product Warranty Period (Worldwide)	2-year limited warranty

1000 Eaton Boulevard
Cleveland, OH 44122
United States
<https://tripplite.eaton.com>

© 2025 Eaton. All Rights Reserved.
Eaton is a registered trademark. All other trademarks
are the property of their respective owners.