

ACTUAL SIZE

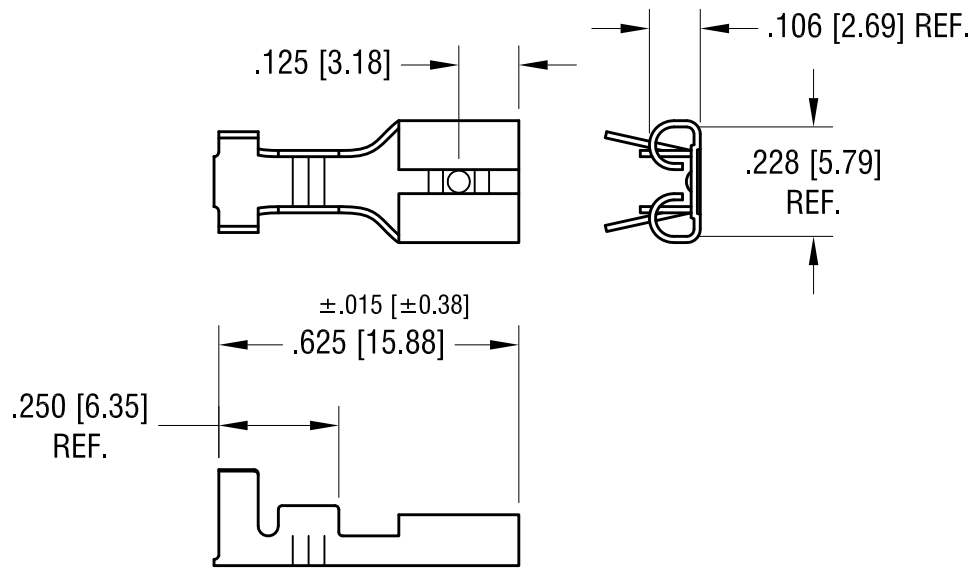
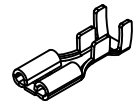

**NOTES:**

1. DESIGNED FOR .205 [5.21] x .020 [0.51] TAB
2. WIRE RANGE : 20-16 AWG

9.02.25	UPDATED REFERENCE DIM'S.	C
11.12.07	CHANGE AS PER ECN 07-077	B
7.11.96	CHANGE AS PER ECR 96-035	A
DATE	DESCRIPTION	REV.

KEYSTONE ELECTRONICS CORP.			
www.keyelco.com • NEW HYDE PARK, NY 11040 • Tel (516) 328-7500			
PART NAME			
.205 X .020 QUICK-FIT FEMALE TERMINAL			
MATERIAL			
.013 [0.33] TH'K BRASS			
FINISH		DRN BY	DATE
TIN PLATE		BOONE	5.05.82
		APP'D	SCALE
		RH	2.5X
TOLERANCES	INCH [MM]	CODE	DWG NO.
DECIMAL	$\pm .005$ [ $\pm 0.13$ ]	C	4469
ANGULAR	$\pm 1^\circ$		
UNLESS OTHERWISE SPECIFIED			