

Product data sheet

Specifications

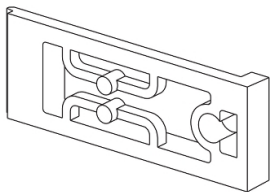

Modicon M172 Performance 12 clips-on lock for Panel Mounting

TM172AP12PM

Main

Range of product	Modicon M171/M172
Accessory / separate part category	Fixing accessory
Accessory / separate part type	Mounting panel

Complementary

Product or component type	Mounting tool
Product compatibility	Logic controller M172 performance
Colour	White
Accessory / separate part destination	Base controller
fixing mode	By screws

Packing Units

Unit Type of Package 1	PCE
Number of Units in Package 1	1
Package 1 Height	2.000 cm
Package 1 Width	5.500 cm
Package 1 Length	6.500 cm
Package 1 Weight	20.000 g
Unit Type of Package 2	S01
Number of Units in Package 2	24
Package 2 Height	15.000 cm
Package 2 Width	15.000 cm
Package 2 Length	40.000 cm
Package 2 Weight	676.000 g

Disclaimer: This documentation is not intended as a substitute for and is not to be used for determining suitability or reliability of these products for specific user applications

Environmental Data

Schneider Electric aims to achieve Net Zero status by 2050 through supply chain partnerships, lower impact materials, and circularity via our ongoing “Use Better, Use Longer, Use Again” campaign to extend product lifetimes and recyclability.

[Environmental Data explained >](#)

[How we assess product sustainability >](#)

 Environmental footprint	
Total lifecycle Carbon footprint	2
Environmental Disclosure	Product Environmental Profile

Use Better

 Materials and Substances	
Packaging made with recycled cardboard	Yes
Packaging without single use plastic	No
EU RoHS Directive	Pro-active compliance (Product out of EU RoHS legal scope)
SCIP Number	2c365b3a-5b0a-48fd-acc7-751c89a723a2
REACH Regulation	REACH Declaration
California proposition 65	WARNING: This product can expose you to chemicals including: Lead and lead compounds, which is known to the State of California to cause cancer and birth defects or other reproductive harm. For more information go to www.P65Warnings.ca.gov

Use Again

 Repack and remanufacture	
End of life manual availability	End of Life Information
Take-back	No