



## APARM2504-SG3

Request Samples



Check Inventory



25.0 x 25.0 x 4.0 mm

RoHS Compliant

MSL Level = N/A

### Features

- GPS/GLONASS/Galileo/Beidou Patch Antenna
- Compact Size: 25.0 x 25.0 x 4.0 mm
- Peak Gain: 4.1 dBic
- Antenna Efficiency: 89%
- RHCP Polarization
- Through Hole Mounting
- Light Weight: 10.4 g

### Applications

- GNSS Modules
- UAVs and Drones
- Asset Tracking & Telematics
- Intelligent Transportation
- Precision Agriculture
- Geolocation and Tracking

### Product Image

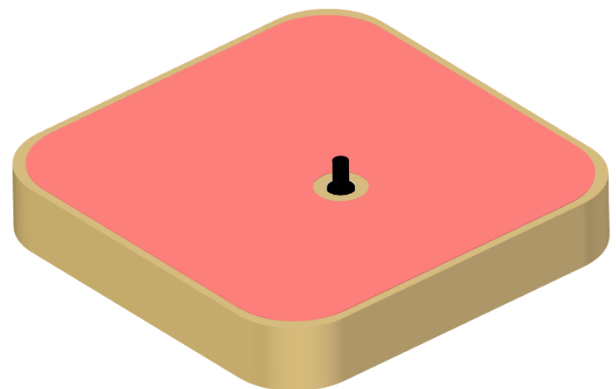



APARM2504-SG3

Request Samples



Check Inventory



25.0 x 25.0 x 4.0 mm

RoHS Compliant

MSL Level = N/A

## GNSS Frequency Bands Covered

GPS	L1 1575.42MHz	L2 1227.6MHz	L5 1176.45MHz	
GLONASS	G1 1598.06-1609.31MHz	G2 1242.93-1251.68MHz	G3 1202.025MHz	
Galileo	E1 1575.42MHz	E5a 1176.45MHz	E5b 1201.5MHz	E6 1278.75MHz
BeiDou	B1I 1561MHz	B2 1207.14MHz	B3 1268.52MHz	
QZSS	L1 1575.42MHz	L2 1227.6MHz	L5 1176.45MHz	L6 1278.75MHz
IRNSS/NAVIC			L5 1176.45MHz	
SBAS	L1/E1/B1 1575.42MHz		L5/B2a/E5a 1176.45MHz	

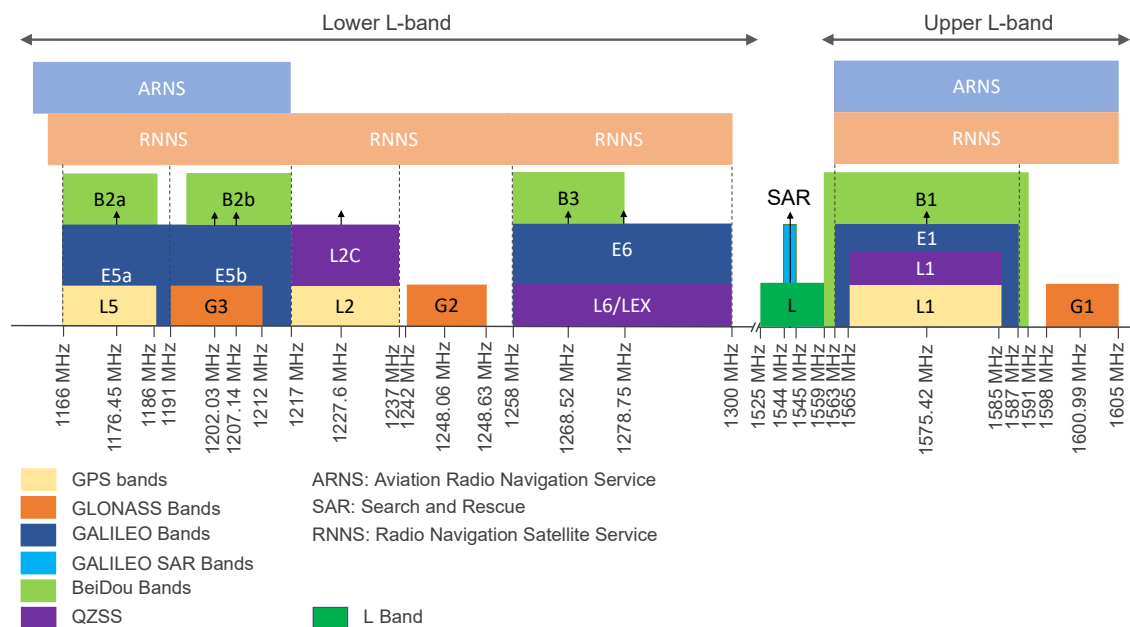

Frequency allocation: GNSS systems, upper L bands and lower L bands

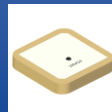

APARM2504-SG3

Request Samples



Check Inventory



25.0 x 25.0 x 4.0 mm

RoHS Compliant

MSL Level = N/A

## Electrical Specification

Parameters	Typ.			Units	Note
Frequency	1561 (B1I)	1575.42 (L1/E1)	1602 (G1)	MHz	
VSWR	< 2.0			-	
Peak Gain	3.1	4.1	4.0	dBic	
Average Gain	-0.8	-0.7	-0.5	dBic	
Maximum Efficiency	82.3	85.5	89.2	%	
Average Efficiency	82.0	82.4	88.0	%	
Polarization	RHCP			-	(Right Hand Circular Polarization)
Nominal Impedance	50			$\Omega$	

Note: All measurements were performed using the evaluation board in a free-space environment. Actual performance may vary depending on factors such as the ground plane, specific application, and surrounding environment.

## Mechanical Specification

Parameter	Specification
Antenna Dimension	25.0 x 25.0 x 4.0 mm
Evaluation Board Dimension	70 x 70 mm
Mounting Type	Through Hole & Adhesive
Mounting Location	PCB Center Mounting
Material(s)	Ceramic
Weight	10.4 g

## Environmental Specification

Parameter	Specification
Operating Temperature	-40°C to +105°C
Storage Temperature	-40°C to +105°C
RoHS Compliance	Yes

# GPS/GLONASS/Galileo/Beidou Patch Antenna

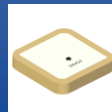

**APARM2504-SG3**

Request Samples



Check Inventory



**25.0 x 25.0 x 4.0 mm**

**RoHS Compliant**

**MSL Level = N/A**

## Ordering Information

Part Number	Description
APARM2504-SG3	GPS/GLONASS/Galileo/Beidou Patch Antenna
APARM2504-SG3-EVB	GPS/GLONASS/Galileo/Beidou Patch Antenna EVB



12117 Bee Caves Rd, Bldg-3, Suite 200 Bee  
Cave, TX 78738  
Phone: 512-371-6159 | Fax: 512-351-8858  
For terms and conditions of sales, please visit:  
[www.abracon.com](http://www.abracon.com)

**REVISED: 09-11-25**

ABRACON IS  
ISO9001-2015  
CERTIFIED

**APARM2504-SG3**

Request Samples

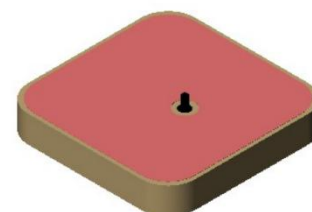
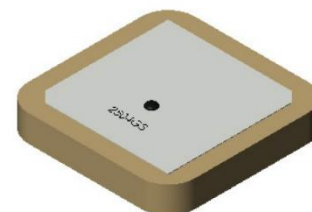
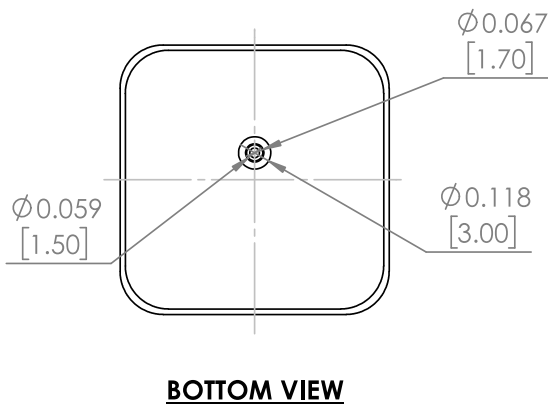
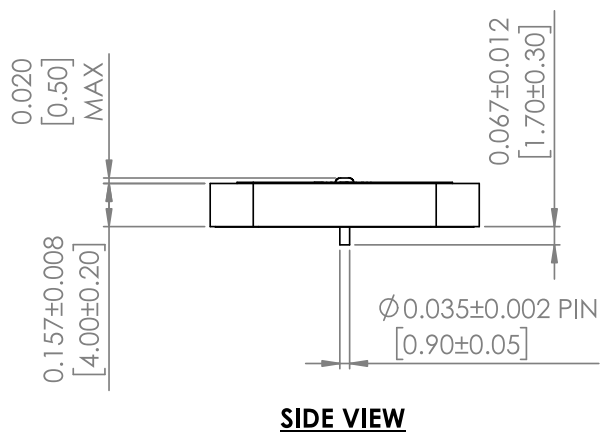
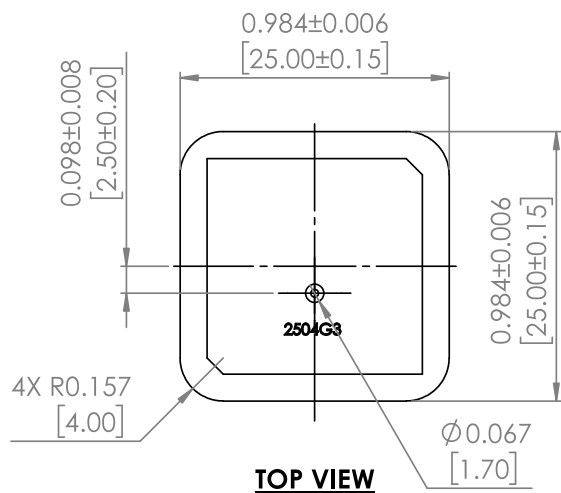

Check Inventory

**25.0 x 25.0 x 4.0 mm****RoHS Compliant****MSL Level = N/A****Product Dimensions***Unit: inches [mm]*



APARM2504-SG3

Request Samples



Check Inventory



25.0 x 25.0 x 4.0 mm

RoHS Compliant

MSL Level = N/A

## Antenna Footprint & PCB Layout Guide

Top

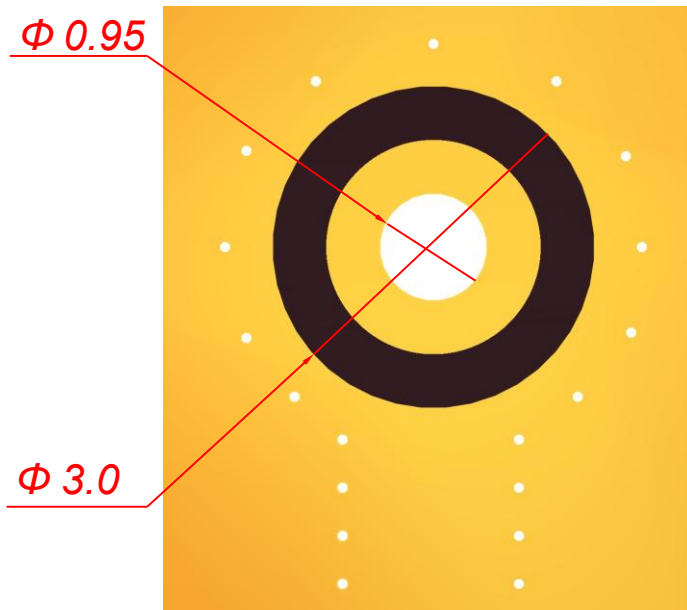

Bottom

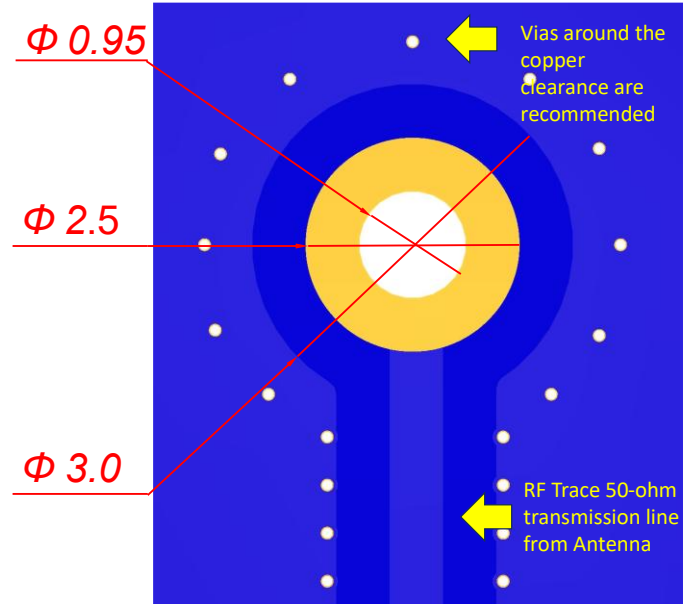

Unit: mm

**Note: Antenna welding does not support reflow soldering, please use manual soldering, the recommended soldering time is  $\leq 3s$ , and the temperature is  $390 \pm 20^\circ\text{C}$ .**

For technical assistance, please contact [Abracon online support](#) through our online support platform.

## Transmission Line

The transmission line should be kept as short as possible and be designed to have a characteristic impedance of  $50\Omega$ . Abracon recommends using a Co-Planar Waveguide with Ground (CPWG), which dimensions can be derived by any trusted calculator, using the correct input for PCB materials and layer stack-up.



**APARM2504-SG3**

Request Samples



Check Inventory



**25.0 x 25.0 x 4.0 mm**

**RoHS Compliant**

**MSL Level = N/A**

## Integration Guide

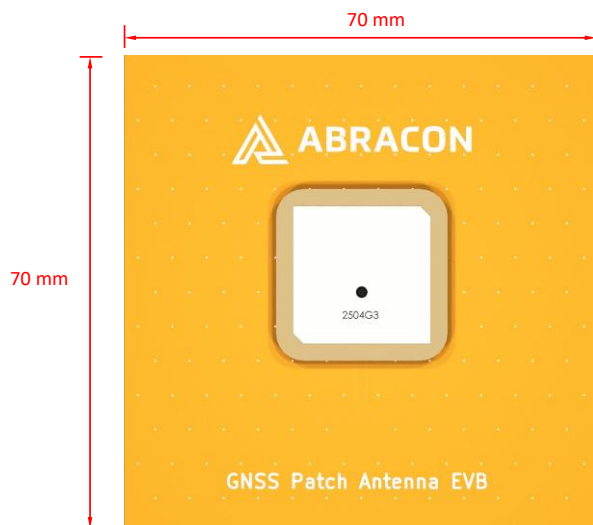

Top with Antenna

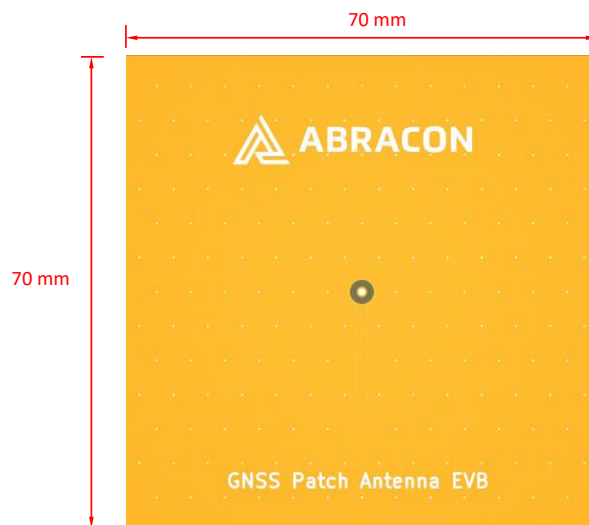

Top without Antenna

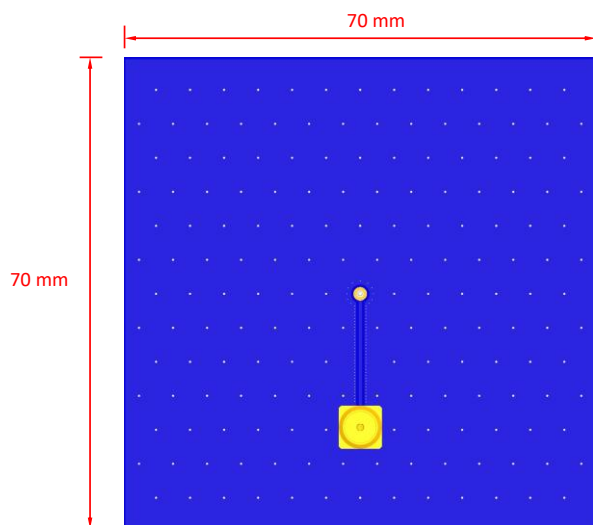

Bottom with Connector

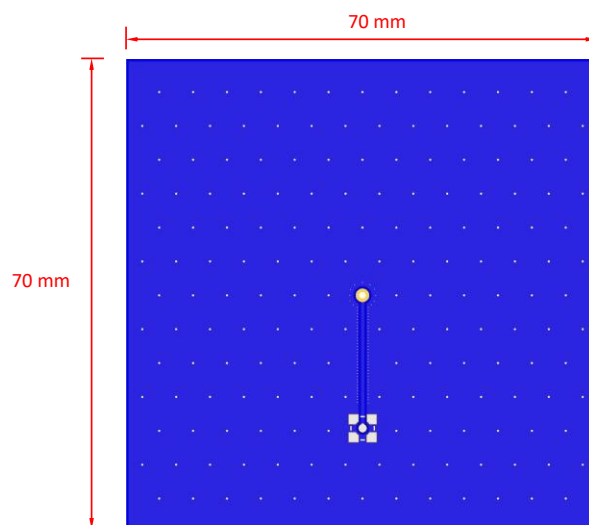

Bottom without Connector

*Unit: mm*

# GPS/GLONASS/Galileo/Beidou Patch Antenna



**APARM2504-SG3**

Request Samples



Check Inventory



**25.0 x 25.0 x 4.0 mm**

**RoHS Compliant**

**MSL Level = N/A**

## Measurement Setup

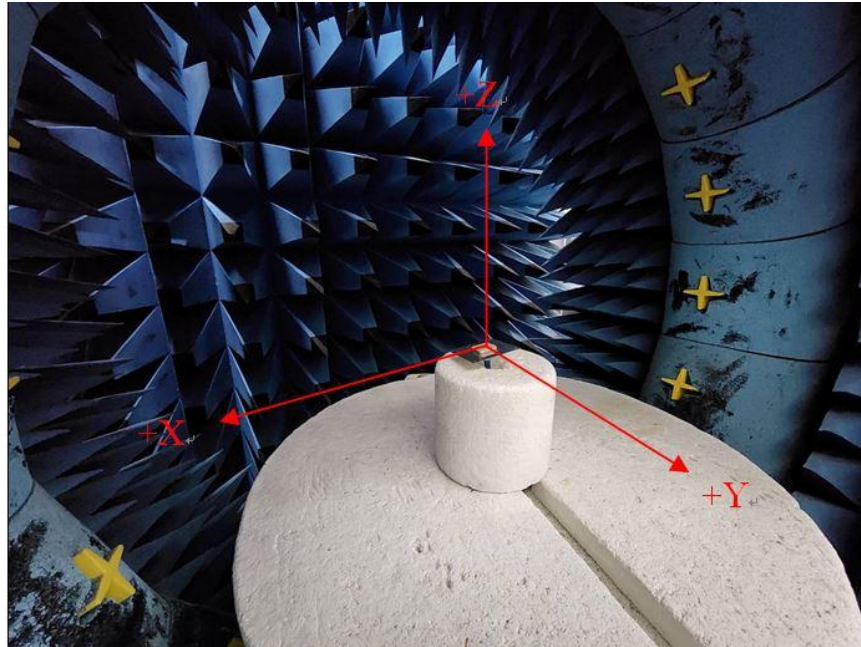



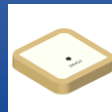

APARM2504-SG3

Request Samples



Check Inventory



25.0 x 25.0 x 4.0 mm

RoHS Compliant

MSL Level = N/A

## Reflection Characteristics – Return Loss & VSWR

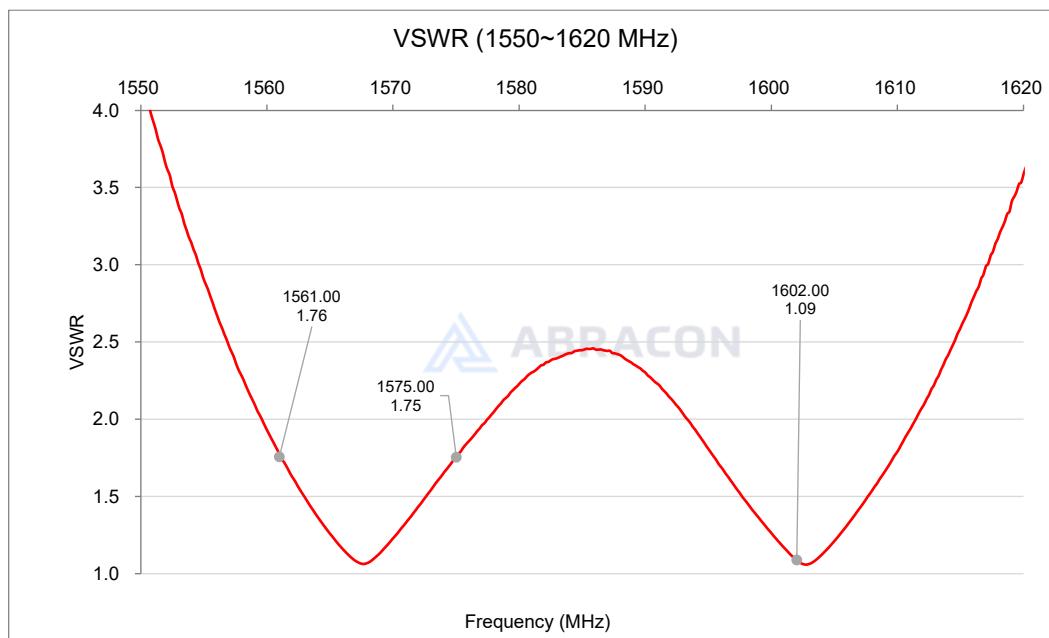
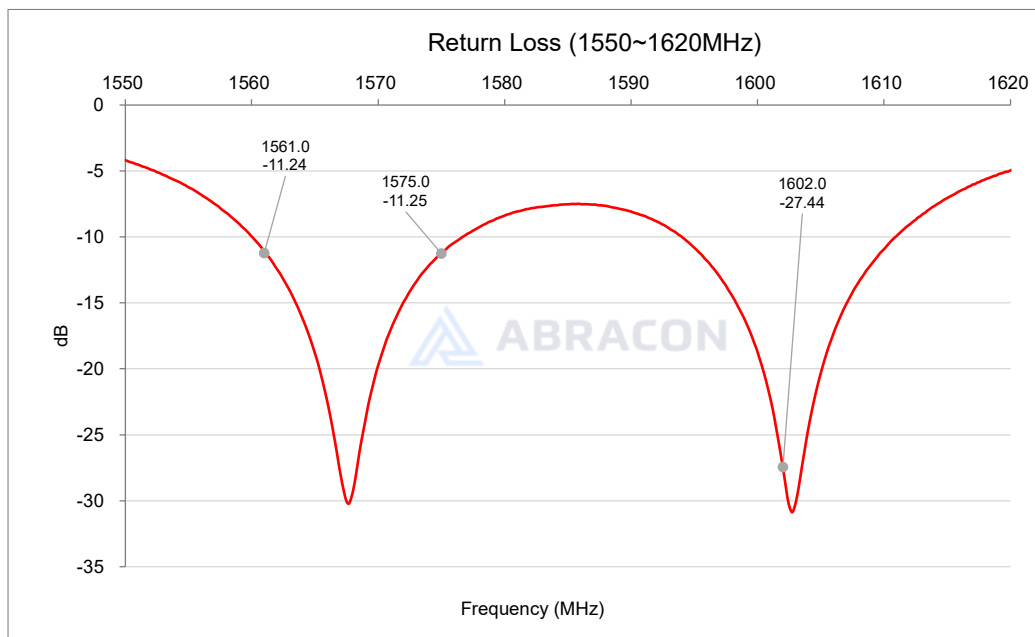



APARM2504-SG3

Request Samples



Check Inventory



25.0 x 25.0 x 4.0 mm

RoHS Compliant

MSL Level = N/A

### Radiation Characteristics – Peak Gain & Average Gain

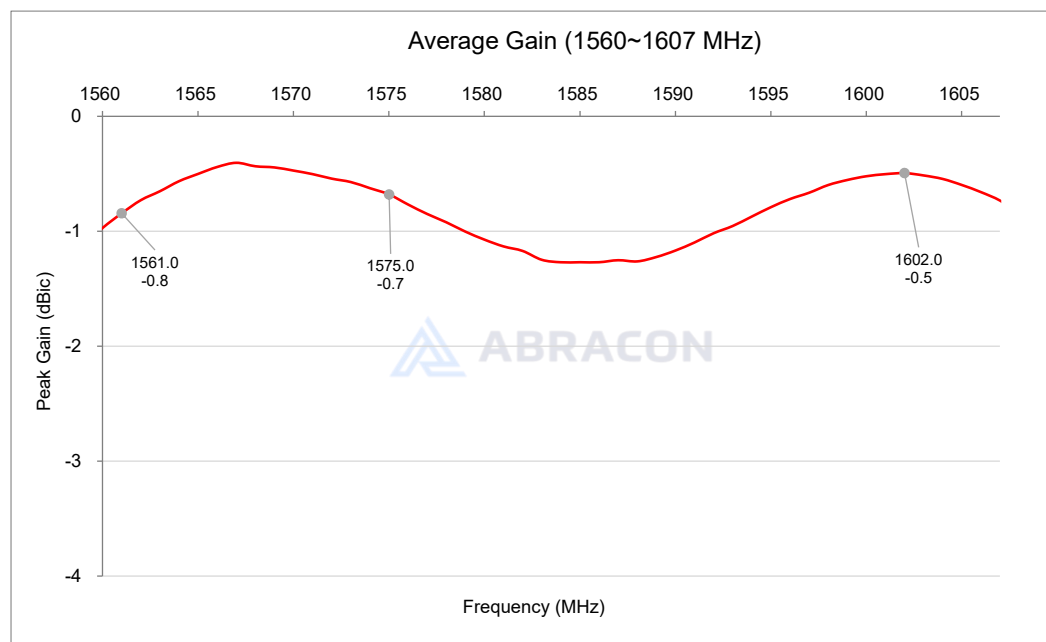
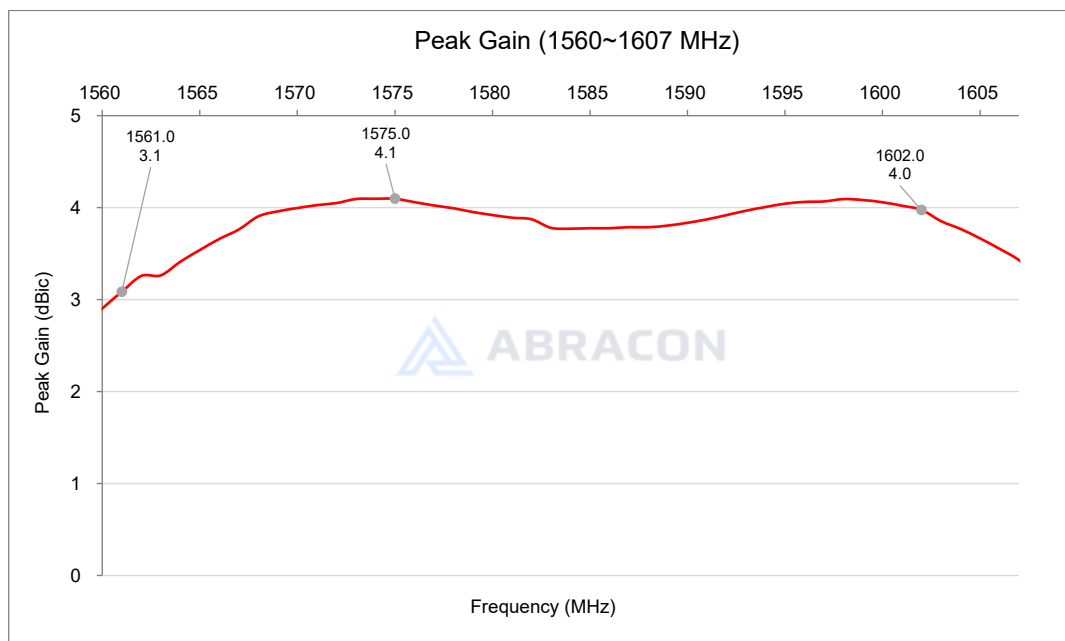

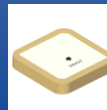

**APARM2504-SG3**

Request Samples



Check Inventory



**25.0 x 25.0 x 4.0 mm**

**RoHS Compliant**

**MSL Level = N/A**

## Radiation Characteristics – Total Efficiency (%)

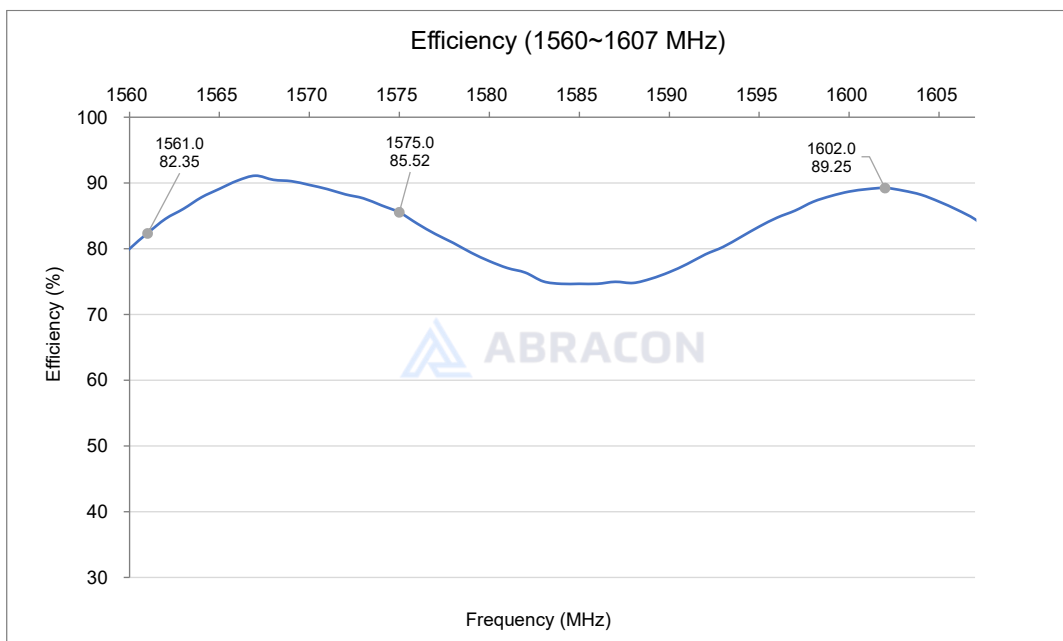

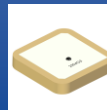

**APARM2504-SG3**

Request Samples



Check Inventory



**25.0 x 25.0 x 4.0 mm**

**RoHS Compliant**

**MSL Level = N/A**

## Radiation Characteristics – 3D & 2D Pattern

1561MHz

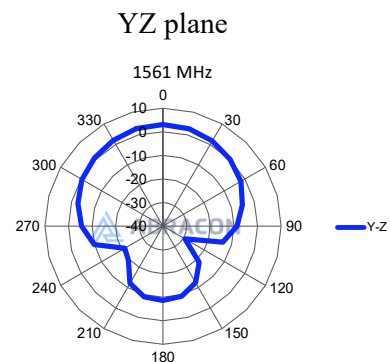
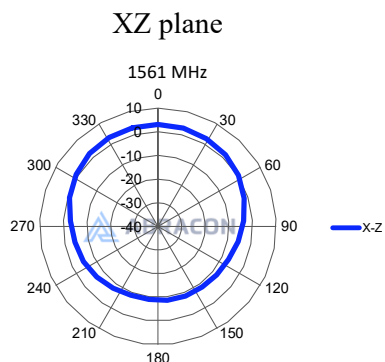
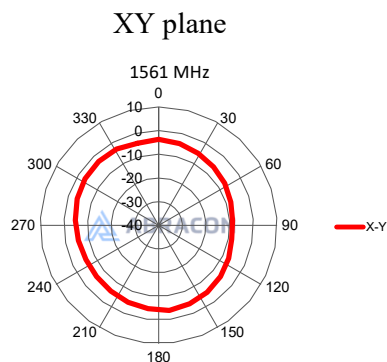
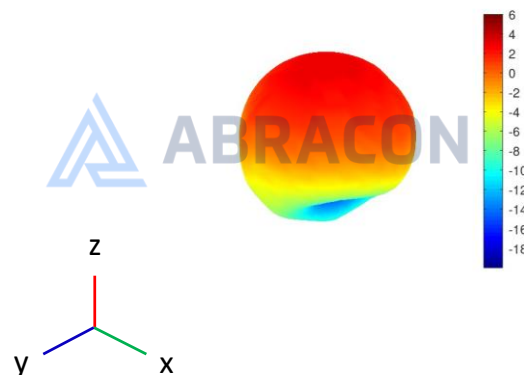
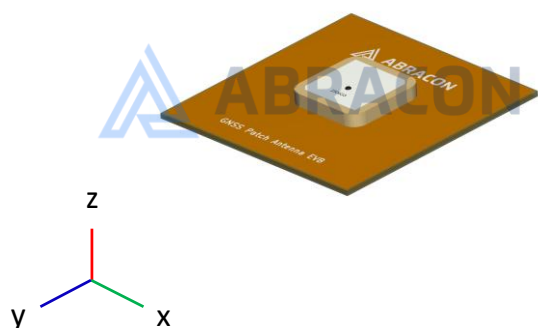

# GPS/GLONASS/Galileo/Beidou Patch Antenna

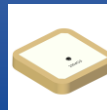

**APARM2504-SG3**

Request Samples



Check Inventory



**25.0 x 25.0 x 4.0 mm**

**RoHS Compliant**

**MSL Level = N/A**

1575MHz

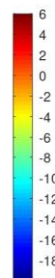
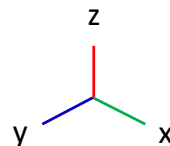
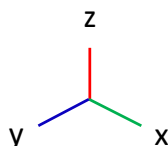
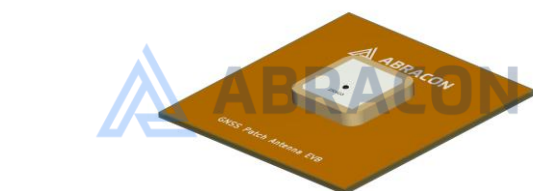

**XY plane**

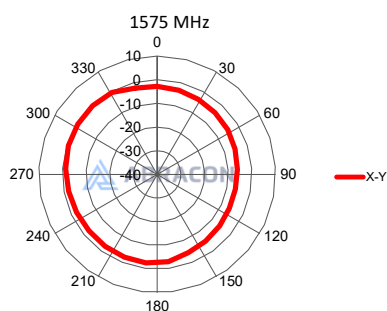

**XZ plane**

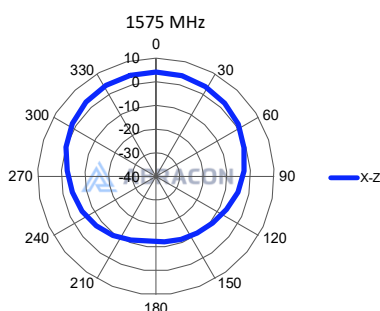

**YZ plane**

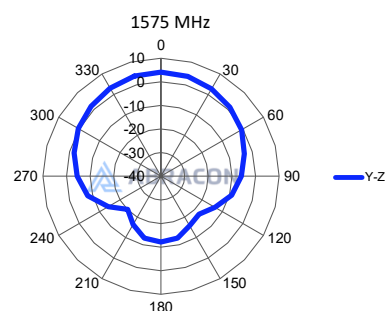

# GPS/GLONASS/Galileo/Beidou Patch Antenna

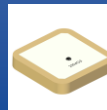

**APARM2504-SG3**

Request Samples



Check Inventory



**25.0 x 25.0 x 4.0 mm**

**RoHS Compliant**

**MSL Level = N/A**

1602MHz

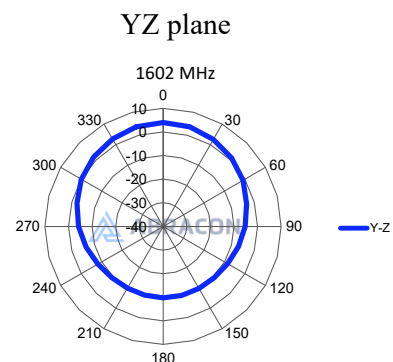
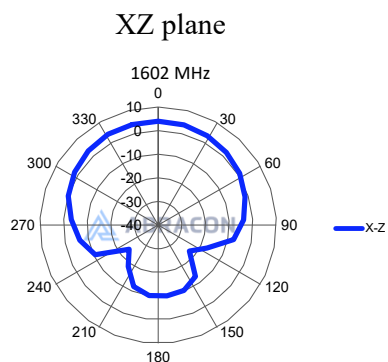
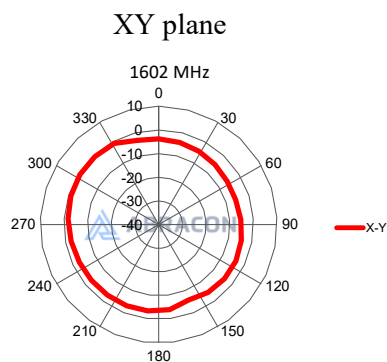
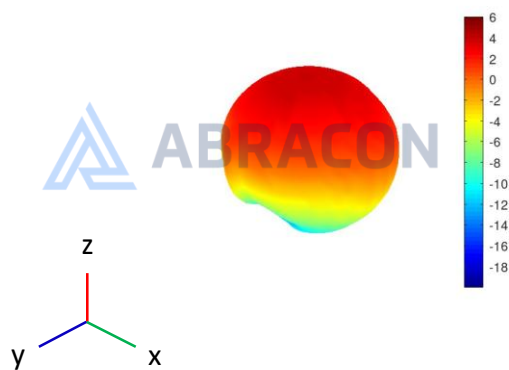
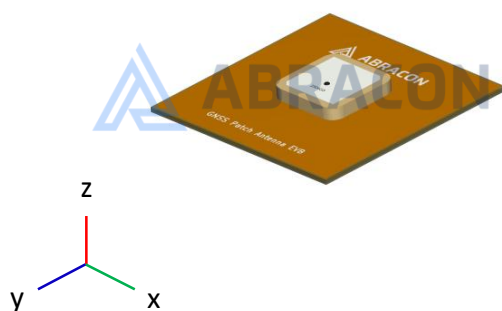

12117 Bee Caves Rd, Bldg-3, Suite 200 Bee  
Cave, TX 78738  
Phone: 512-371-6159 | Fax: 512-351-8858  
For terms and conditions of sales, please visit:  
[www.abracon.com](http://www.abracon.com)

**REVISED: 09-11-25**

ABRACON IS  
ISO9001-2015  
CERTIFIED

# GPS/GLONASS/Galileo/Beidou Patch Antenna



**APARM2504-SG3**

Request Samples



Check Inventory



**25.0 x 25.0 x 4.0 mm**

**RoHS Compliant**

**MSL Level = N/A**

## Packaging

50 pcs per tray

200 pcs per inner box

800 pcs per carton

**ATTENTION:** Abracon LLC's products are Commercial-Off-The-Shelf ('COTS'), which are designed, intended, and validated for use in commercial, industrial, and automotive applications. The customer is responsible for testing and verifying the performance of an Abracon solution to meet their system-level requirements.



12117 Bee Caves Rd, Bldg-3, Suite 200 Bee  
Cave, TX 78738  
Phone: 512-371-6159 | Fax: 512-351-8858  
For terms and conditions of sales, please visit:  
[www.abracon.com](http://www.abracon.com)

**REVISED: 09-11-25**

ABRACON IS  
ISO9001-2015  
CERTIFIED