

SMD Full Band GNSS Band Pass Ceramic Filter



AFII-LC-0081

Request Samples



Check Inventory



3.2 x 2.5 x 1.75 mm
RoHS Compliant
MSL Level = 1

Description

Designed for next-generation positioning systems, this high-performance GNSS filter offers full-band & multi-constellation support for GPS, GLONASS, BEIDOU, and GALILEO. Its compact 3.2 x 2.5 x 1.75 mm package delivers exceptional RF performance with a 550 MHz bandwidth, low 0.85 dB insertion loss, and high out-of-band rejection exceeding 25 dB. With 50-ohm impedance, 6W power handling, and critical MSL Level 1 compliance for reliable manufacturing, it is the ideal solution for automotive telematics, UAV navigation, asset tracking, and precision agriculture systems requiring robust, accurate signal integrity.

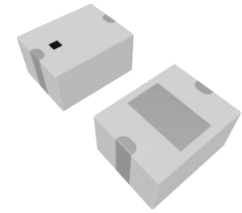

Features

- GPS/GLONASS/BEIDOU/GALILEO Support
- GNSS Full Band Support
- Bandwidth 550 MHz
- Compact in Size 3.2 x 2.5 x 1.75 mm
- Low Insertion Loss: 0.85 dB
- High Out-of-Band Rejection: > 25 dB
- Internal DC Blocking Capacitor at Input & Output
- 50-ohm Single-Ended Input and Output
- Maximum Input Power: 6W
- [RoHS Compliant](#) | [MSL Level 1](#)

Applications

- RF Modules
- RTK Systems
- Automotive Transportation & Telematics
- Asset Tracking / Fleet Management
- UAVs, Robotics & Autonomous Vehicles
- Micro-Mobility Solutions
- Precision Agriculture

Ordering Information

Part Number	Description
AFII-LC-0081	SMD Full Band GNSS Band Pass Ceramic Filter on Cut Tape
AFII-LC-0081-T	SMD Full Band GNSS Band Pass Ceramic Filter on Tape & Reel
AFII-LC-0081-EVB	SMD Full Band GNSS Band Pass Ceramic Filter Evaluation Board

Note: Other options not listed may be available upon request via [Abracon online support](#)



12117 Bee Caves Rd, Bldg-3, Suite 200 Bee
Cave, TX 78738
Phone: 512-371-6159 | Fax: 512-351-8858
For terms and conditions of sales, please visit:
www.abracon.com

REVISED: 10-09-25

ABRACON IS
ISO9001-2015
CERTIFIED

SMD Full Band GNSS Band Pass Ceramic Filter



AFII-LC-0081

Request Samples



Check Inventory



3.2 x 2.5 x 1.75 mm
RoHS Compliant
MSL Level = 1

GNSS Frequency Bands Covered

System	Band	Frequency Range
GPS	L1	1575.42MHz
	L2	1227.6MHz
GLONASS	G1	1598.06-1609.31MHz
	G2	1242.93-1251.68MHz
	G3	1202.025MHz
Galileo	E1	1575.42MHz
	E5a	1176.45MHz
	E5b	1201.5MHz
	E6	1278.75MHz
BeiDou	B1	1561MHz
	B2	1207.14MHz
	B3	1268.52MHz
QZSS	L1	1575.42MHz
	L2	1227.6MHz
	L5	1176.45MHz
	L6	1278.75MHz
IRNSS/NAVIC	L5	1176.45MHz
	L6	1278.75MHz
SBAS	L1/E1/B1	1575.42MHz
	L5/B2a/E5a	1176.45MHz

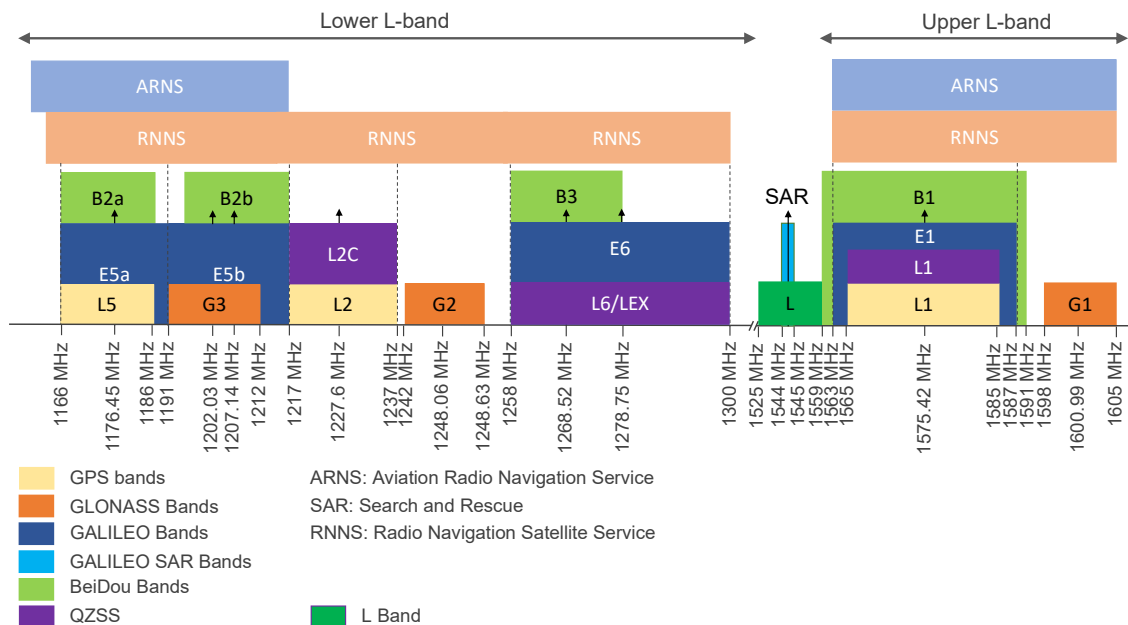

Frequency allocation: GNSS systems, upper L bands and lower L bands



12117 Bee Caves Rd, Bldg-3, Suite 200 Bee
 Cave, TX 78738
 Phone: 512-371-6159 | Fax: 512-351-8858
 For terms and conditions of sales, please visit:
www.abracon.com

REVISED: 10-09-25

ABRACON IS
 ISO9001-2015
 CERTIFIED

SMD Full Band GNSS Band Pass Ceramic Filter



AFII-LC-0081

Request Samples



Check Inventory



3.2 x 2.5 x 1.75 mm
RoHS Compliant
MSL Level = 1

Electrical Specification

Parameters	Minimum	Typical	Maximum	Units	Notes
Center Frequency (fc)	-	1400	-	MHz	-
VSWR	-	1.2	1.5	-	1125~1675 MHz
Insertion Loss	-	0.85	1.9	dB	1125~1675 MHz
Amplitude Ripple	-	0.2	1.3	dB	1125~1675 MHz
Attenuation (Reference level from 0 dB)	40	-	-	dB	DC - 900 MHz
	25	-	-		900- 1002 MHz
	35	-	-		2000 - 2500 MHz
	27	-	-		2500 - 5950 MHz
Group Delay (+25 °C)	-	1.89	4.36	ns	1125~1675 MHz
Group Delay Ripple (+25 °C)	-	0.58	2.47	ns	1125~1675 MHz
Source Impedance ⁽¹⁾ (single ended)	-	50	-	Ω	
Load Impedance ⁽¹⁾ (single ended)	-	50	-	Ω	
Input Power Level	-	-	6	W	-

Notes: (1) A matching network is unnecessary (refer to the Measurement Circuits section).

Mechanical Specification

Parameters	Specifications
Filter Dimension	3.2 x 2.5 x 1.75 mm
Mounting Type	Surface Mount
Additional Resources	Download STEP File, Package Drawing, 3D PDF

Environmental Specification

Parameters	Specifications
Operating Temperature Range	-45°C ~ +85°C
Storage Temperature Range	-10°C ~ +40°C
MSL level	1



12117 Bee Caves Rd, Bldg-3, Suite 200 Bee
Cave, TX 78738
Phone: 512-371-6159 | Fax: 512-351-8858
For terms and conditions of sales, please visit:
www.abracon.com

REVISED: 10-09-25

ABRACON IS
ISO9001-2015
CERTIFIED

SMD Full Band GNSS Band Pass Ceramic Filter



AFII-LC-0081

Request Samples



Check Inventory



3.2 x 2.5 x 1.75 mm
RoHS Compliant
MSL Level = 1

Product Dimensions

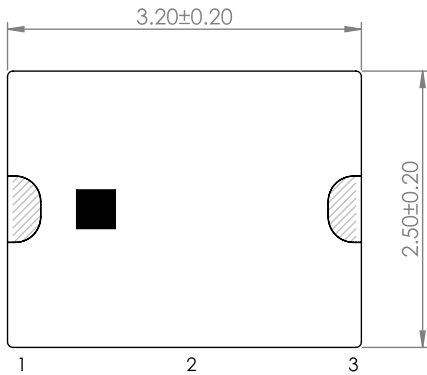

TOP VIEW

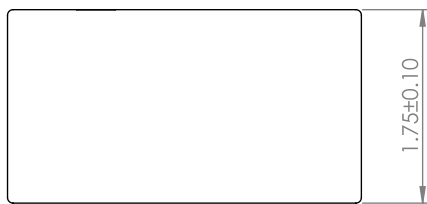

FRONT VIEW

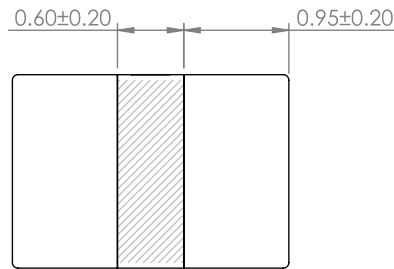

SIDE VIEW

RECOMMENDED LAND PATTERN

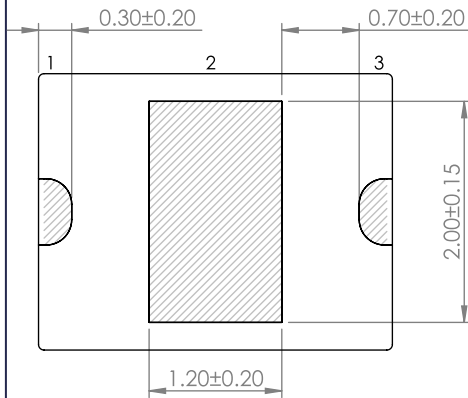
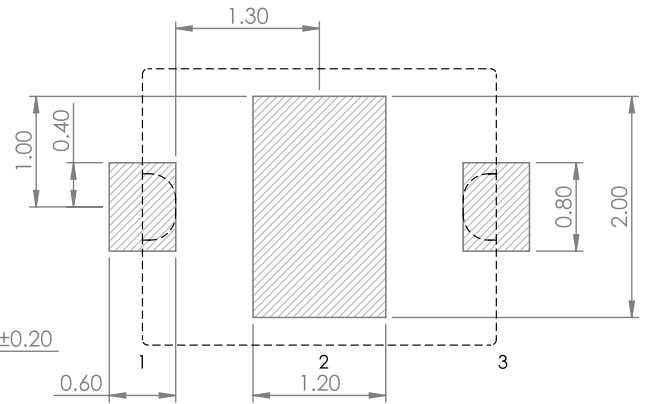

BOTTOM VIEW

Pin#	FUNCTION
1	IN
2	GND
3	OUT

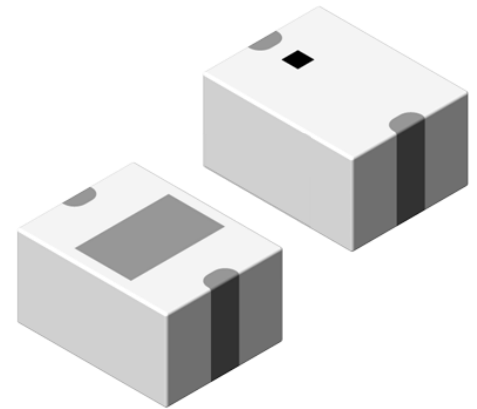

Unit: mm

SMD Full Band GNSS Band Pass Ceramic Filter



AFII-LC-0081

Request Samples



Check Inventory



3.2 x 2.5 x 1.75 mm
RoHS Compliant
MSL Level = 1

Measurement Circuit

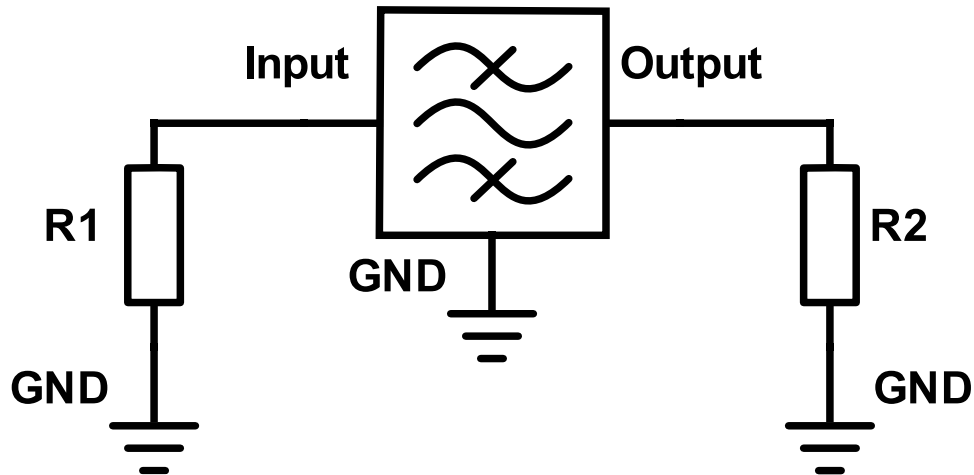

Port	Matching Component
Input (1)	R1: 50Ω
Output (3)	R2: 50Ω

SMD Full Band GNSS Band Pass Ceramic Filter



AFII-LC-0081

Request Samples



Check Inventory



3.2 x 2.5 x 1.75 mm
RoHS Compliant
MSL Level = 1

Frequency Characteristics

S21 narrow band

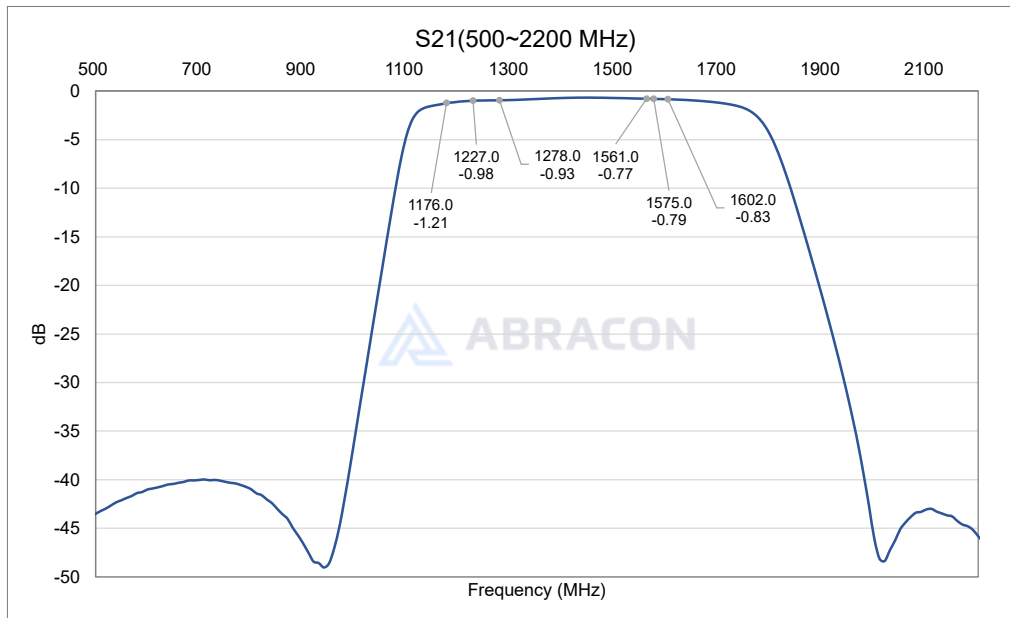
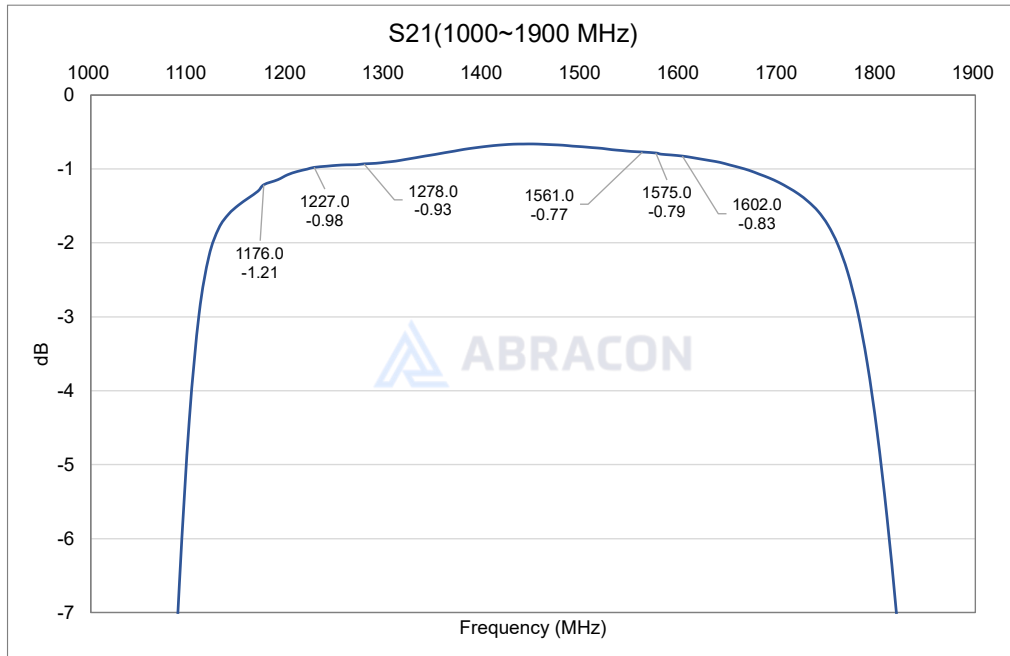

SMD Full Band GNSS Band Pass Ceramic Filter



AFII-LC-0081

Request Samples



Check Inventory



3.2 x 2.5 x 1.75 mm
RoHS Compliant
MSL Level = 1

S21 wide band

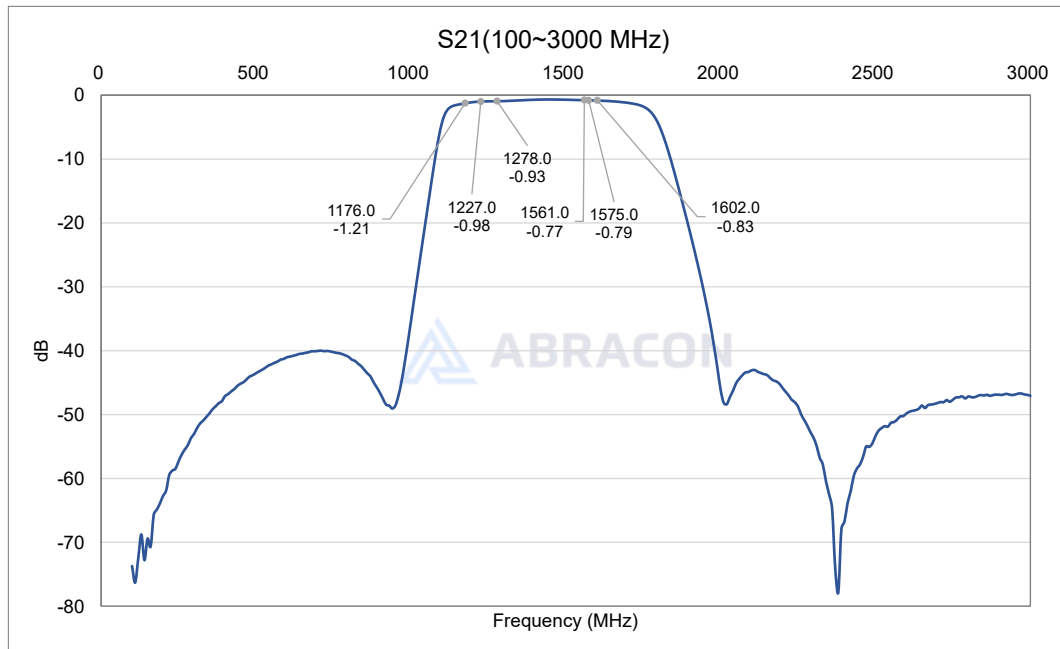

Group Delay

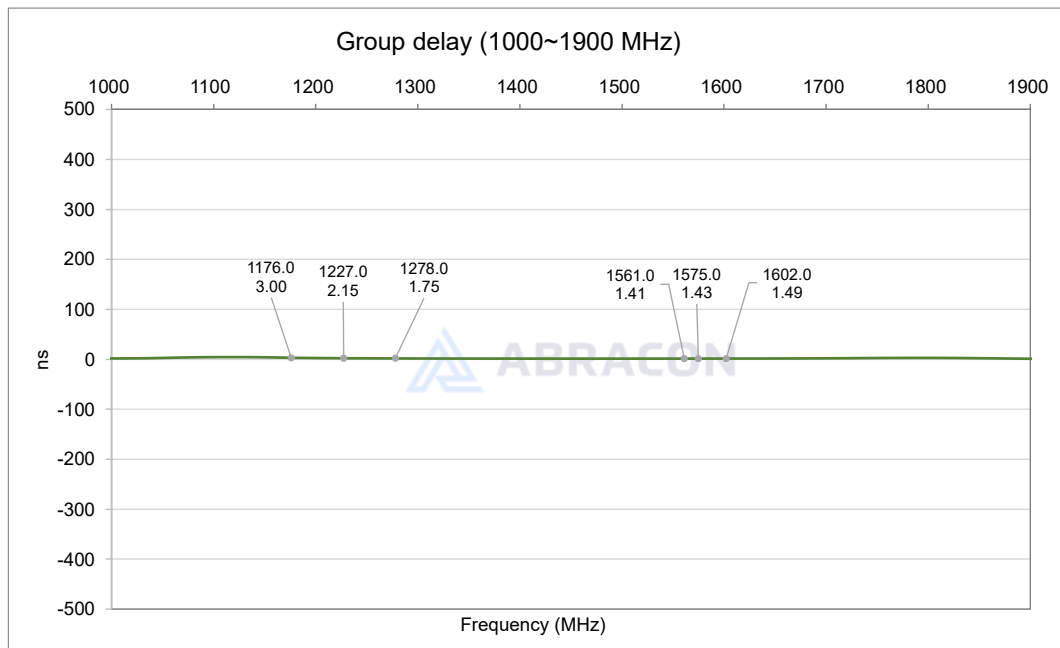

SMD Full Band GNSS Band Pass Ceramic Filter



AFII-LC-0081

Request Samples



Check Inventory



3.2 x 2.5 x 1.75 mm
RoHS Compliant
MSL Level = 1

VSWR (S11 & S22)

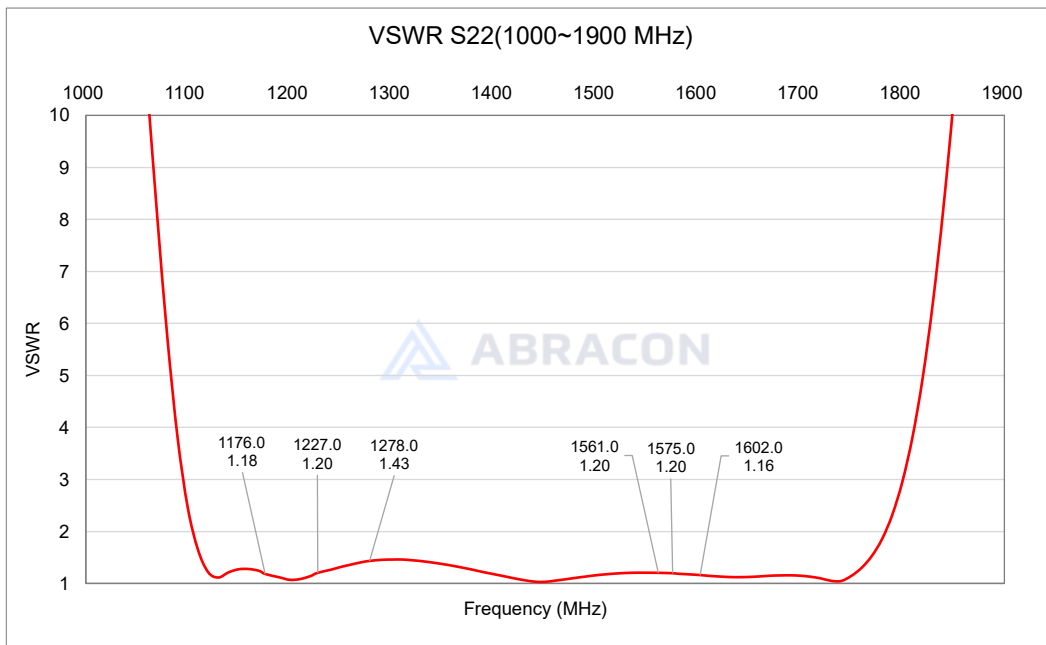
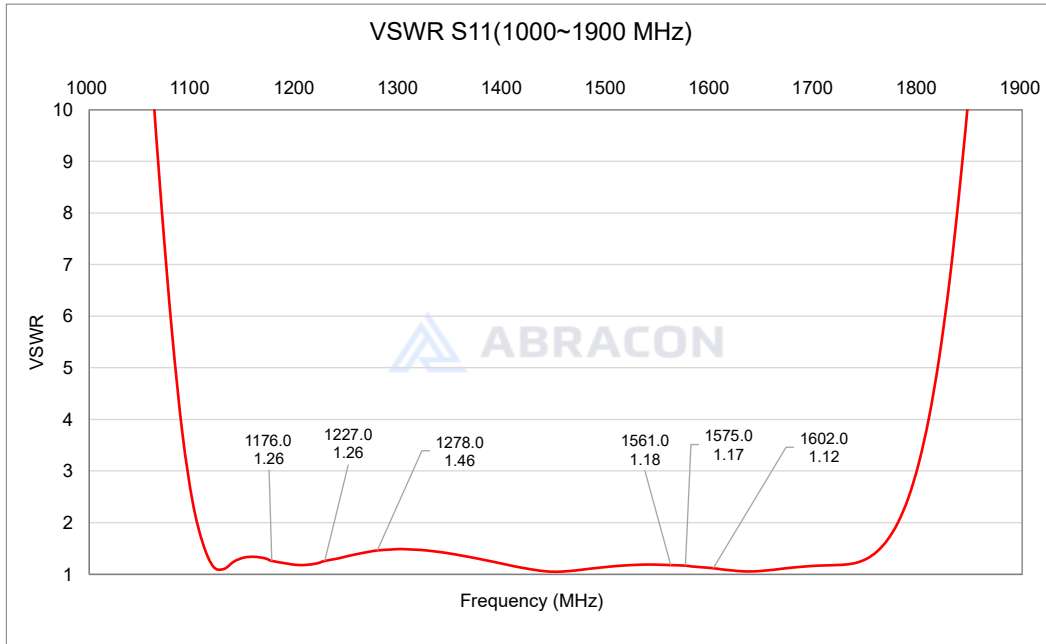

SMD Full Band GNSS Band Pass Ceramic Filter



AFII-LC-0081

Request Samples



Check Inventory



3.2 x 2.5 x 1.75 mm
RoHS Compliant
MSL Level = 1

Smith chart S11 (1120~1680MHz)

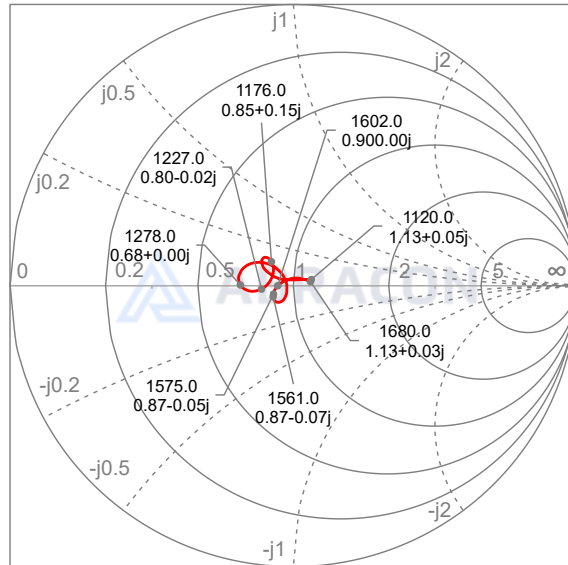

Smith chart S22 (1120~1680MHz)

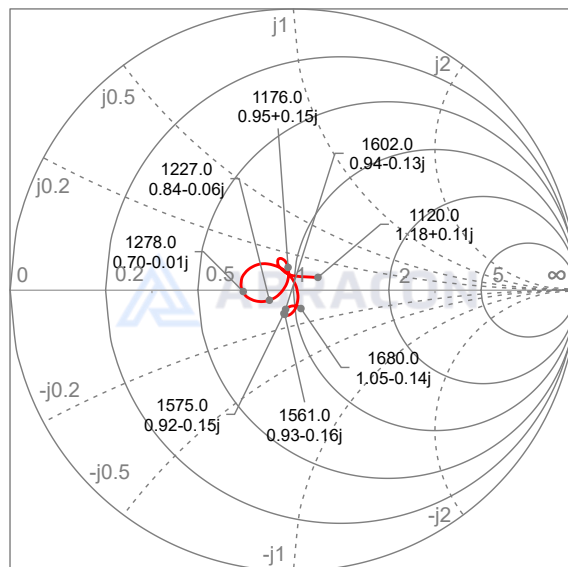

SMD Full Band GNSS Band Pass Ceramic Filter



AFII-LC-0081

Request Samples



Check Inventory



3.2 x 2.5 x 1.75 mm
RoHS Compliant
MSL Level = 1

Reflow Profile [JEDEC J-STD-020]

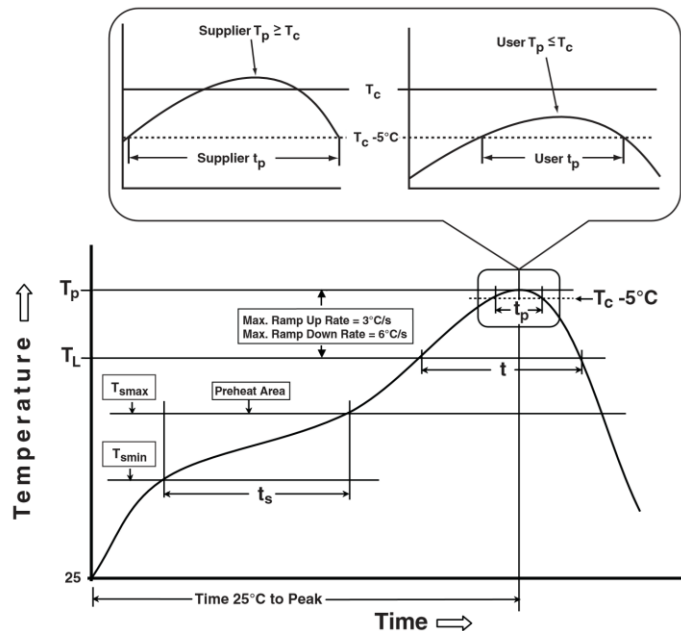

Table 1

SnPb Eutectic Process Classification Temperatures (T_c)		
Package Thickness	Volume mm^3 <350	Volume mm^3 \geq 350
<2.5mm	235°C	220°C
\geq 2.5mm	220°C	220°C

Table 2

Pb-Free Process Classification Temperatures (T_c)			
Package Thickness	Volume mm^3 <350	Volume mm^3 350-2000	Volume mm^3 >2000
<1.6mm	260°C	260°C	260°C
1.6mm - 2.5mm	260°C	250°C	245°C
>2.5mm	250°C	245°C	245°C

Profile Feature	Sn-Pb Eutectic Assembly	Pb-Free Assembly
Preheat / soak		
Temperature minimum (T_{smin})	100°C	150°C
Temperature maximum (T_{smax})	150°C	180°C
Time (T_{smin} to T_{smax}) (t_s)	60 – 120 sec.	60 – 90 sec.
Average ramp-up rate (T_{smax} to T_p)	3°C/sec. max	3°C/sec. max
Liquidous temperature (T_L)	183°C	220°C
Time at Liquidous (T_L)	60 – 150 sec.	50 – 80 sec.
Peak package body temperature (T_p)*	See Table 1	See Table 2
Time (T_p)** within 5°C of the specified classification temperature (T_c)	20 sec.	20 ~ 40 sec.
Ramp-down rate (T_p to T_{smax})	6°C/sec. max	6°C/sec. max
Time 25°C to peak temperature	6 min. max	8 min. max
Reflow cycles	2 max	2 max

*Tolerance for peak profile temperature (T_p) is defined as a supplier minimum and a user maximum.

**Tolerance for time at peak profile temperature (t_p) is defined as a supplier minimum and a user maximum.



12117 Bee Caves Rd, Bldg-3, Suite 200 Bee Cave, TX 78738
Phone: 512-371-6159 | Fax: 512-351-8858
For terms and conditions of sales, please visit: www.abracon.com

REVISED: 10-09-25

ABRACON IS
ISO9001-2015
CERTIFIED

SMD Full Band GNSS Band Pass Ceramic Filter



AFII-LC-0081

Request Samples



Check Inventory



3.2 x 2.5 x 1.75 mm
RoHS Compliant
MSL Level = 1

Packaging

Tape & Reel Dimension

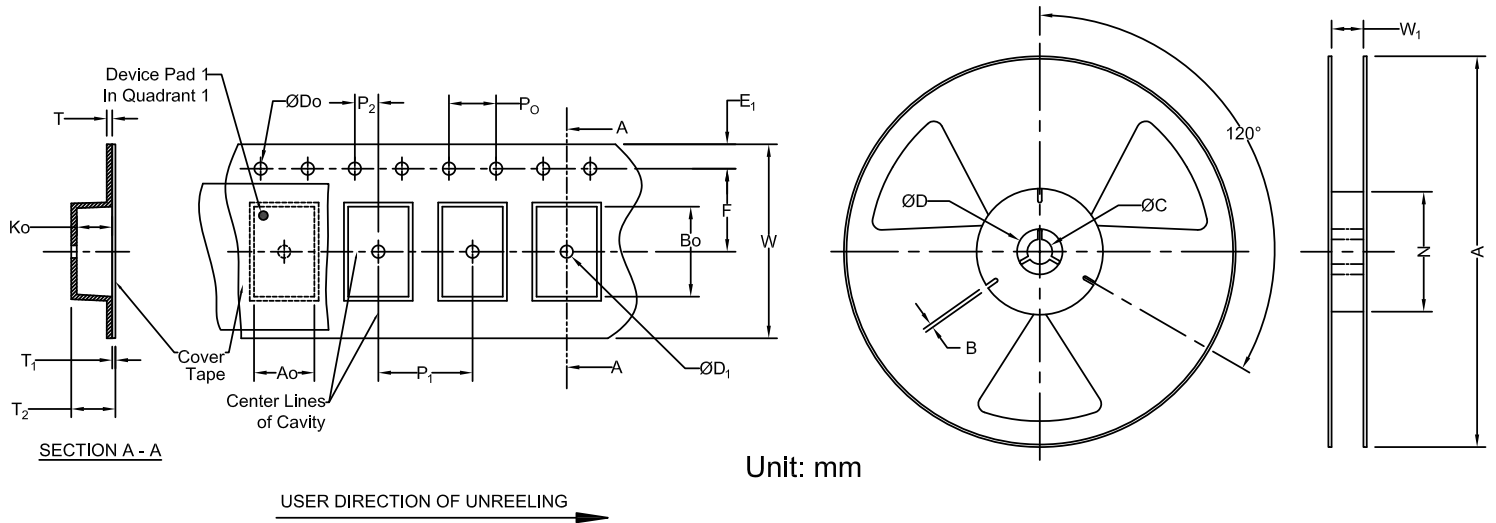

Carrier Tape Specifications (mm)

Do	E ₁	P ₀	P ₂	T	F	P ₁	W	A ₀	B ₀	K ₀	Reel Qty
1.50 ± 0.1	1.75 ± 0.1	4.0 ± 0.1	2.0 ± 0.05	0.27 Max.	3.5 ± 0.05	4.0 ± 0.1	8.0 ± 0.3	2.85 ± 0.1	3.50 ± 0.1	1.95 ± 0.05	2,000

Reel Specifications (mm)

A	W ₁	N	C	B
178.0 ± 1.0	8.4 +1.5/-0.0	58.0 ± 0.2	13.5 ± 0.2	2.45 ± 0.2

ATTENTION: Abracon LLC's products are Commercial-Off-The-Shelf ('COTS'), which are designed, intended, and validated for use in commercial, industrial, and automotive applications. The customer is responsible for testing and verifying the performance of an Abracon solution to meet their system-level requirements.



12117 Bee Caves Rd, Bldg-3, Suite 200 Bee
 Cave, TX 78738
 Phone: 512-371-6159 | Fax: 512-351-8858
 For terms and conditions of sales, please visit:
www.abracon.com

REVISED: 10-09-25

ABRACON IS
 ISO9001-2015
 CERTIFIED