

AEC-Q200 Power Common Mode Choke

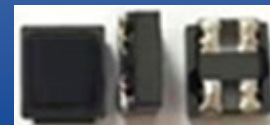

ACMP-Q5025

Request Samples



Check Inventory



5.0 x 4.5 x 2.5 mm
RoHS/RoHS II Compliant
MSL Level = 1

Features

- AEC-Q200 Grade 1
- Excellent impedance characteristics
- Rated current up to 4.0A
- Extremely Low DCR

Applications

- DC power line common mode noise suppression.
- Switch Mode Power Supplies and regulators
- Variable Frequency Drives
- AC/DC power rectifiers

Electrical Specifications

Part Number	Impedance (Ω) @100MHz	DCR (mΩ)	Rated Current (A)	Rated Voltage (Vdc)	Insulation Resistance (MΩ)
	Typ.	±40%	Max.	Max.	Min.
ACMP-Q5025-501	500	19	4.0	50	10
ACMP-Q5025-102	1000	24	3.0	50	10
ACMP-Q5025-142	1400	40	1.5	50	10

Rated Current is based on an Irms temperature rise of 40°C.

Operating Temperature: -40°C to +125°C. (Including self-heating)

Storage (in original packaging): <40°C, <60% RH.

ACMP-Q5025 is RoHS Compliant and Pb free.

ACMP-Q5025 is AEC-Q200 Grade 1

Part Identification

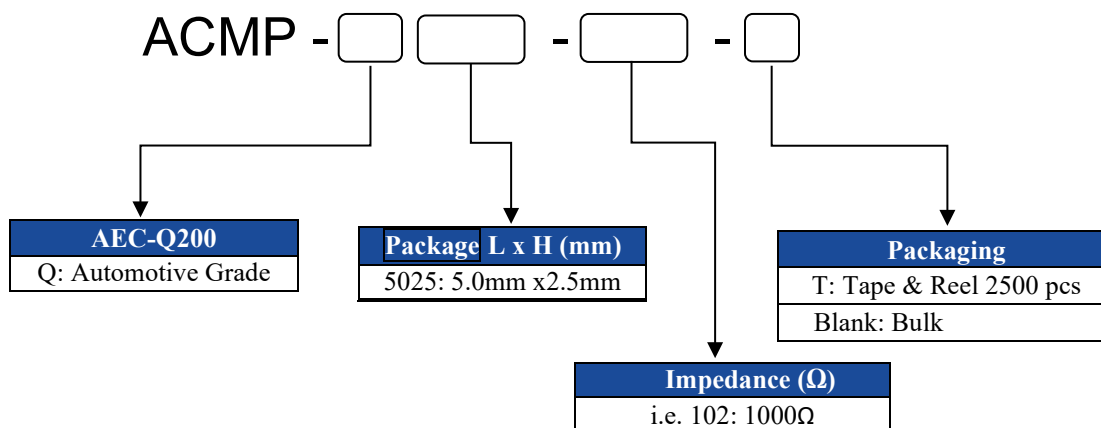

AEC-Q200 Power Common Mode Choke



ACMP-Q5025

Request Samples



Check Inventory



5.0 x 4.5 x 2.5 mm
RoHS/RoHS II Compliant
MSL Level = 1

Performance

ACMP-Q5025 Series Impedance Graphs

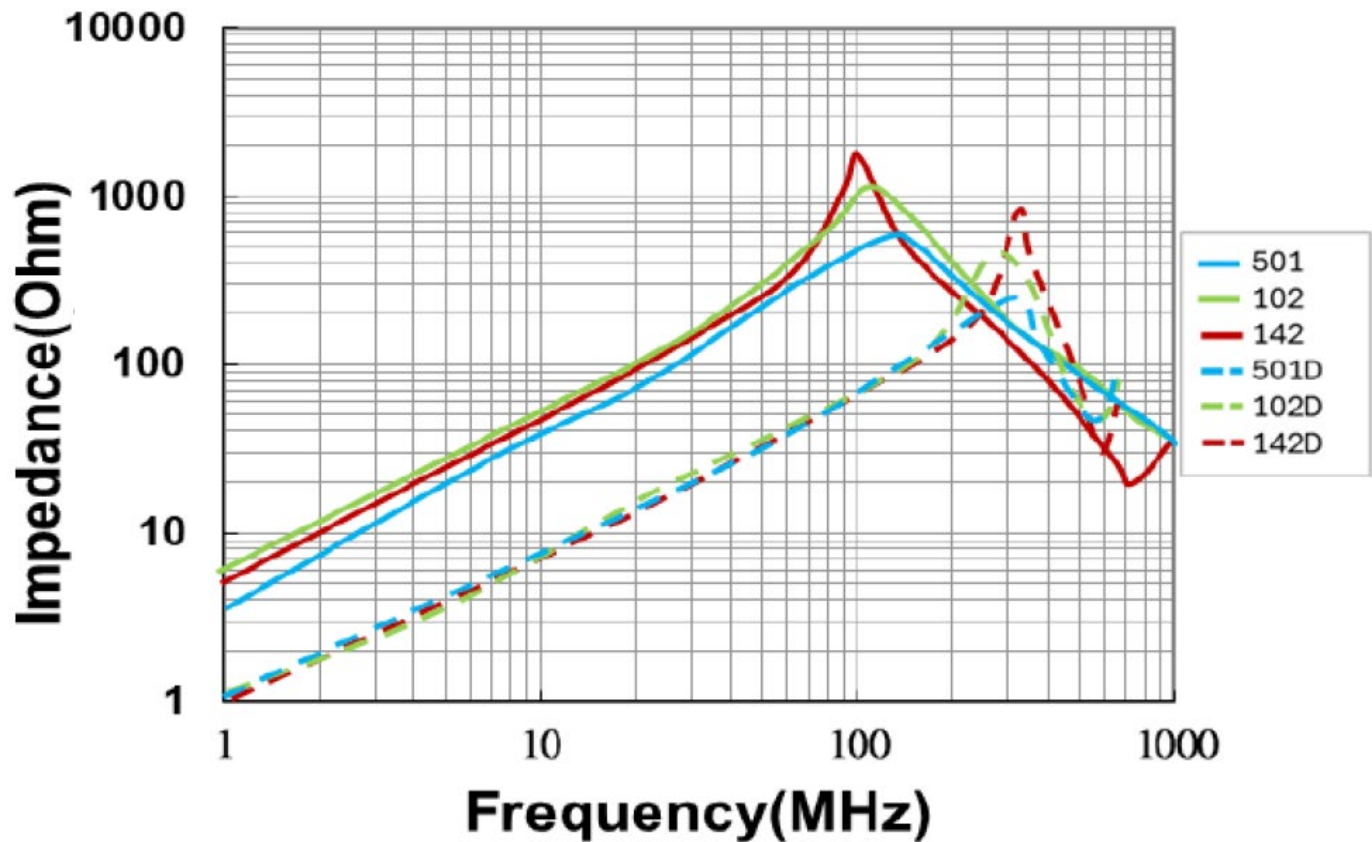

AEC-Q200 Power Common Mode Choke



ACMP-Q5025

Request Samples



Check Inventory



5.0 x 4.5 x 2.5 mm
RoHS/RoHS II Compliant
MSL Level = 1

Mechanical Specifications

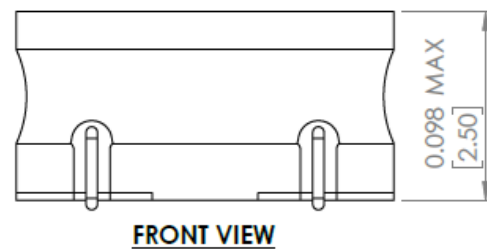
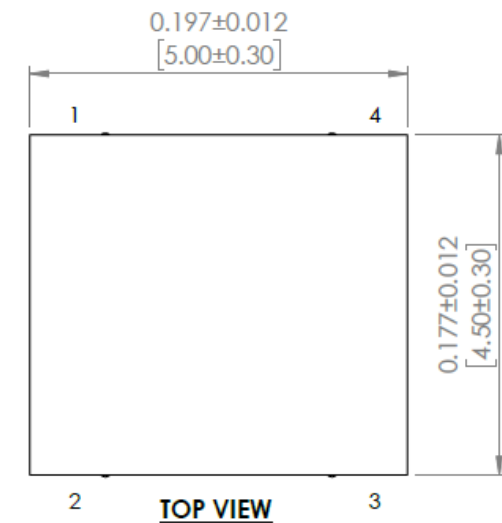

RECOMMENDED LAND PATTERN

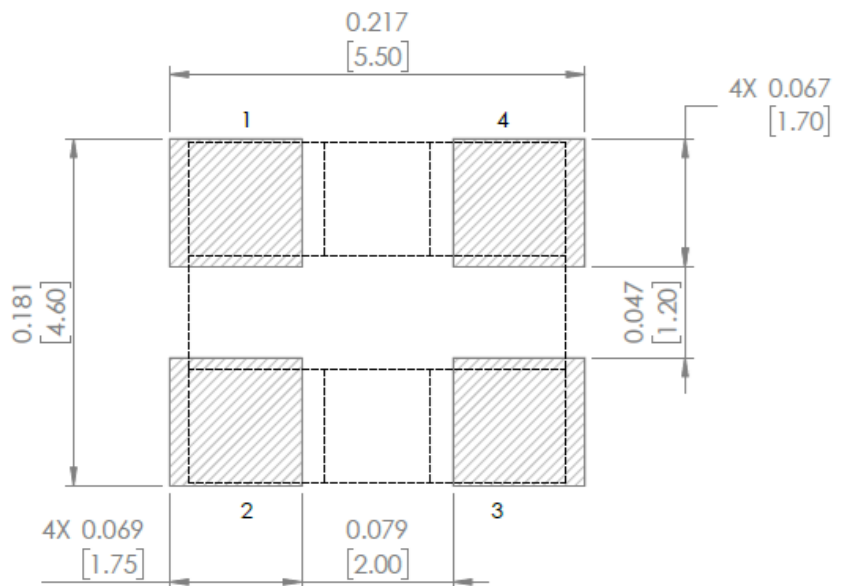
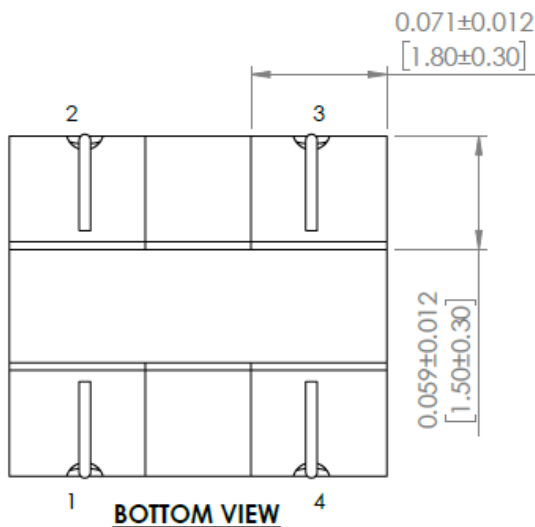

Dimensions: [inches]mm



12117 Bee Caves Rd, Bldg-3, Suite 200
Bee Cave, TX 78738
Phone: 512-371-6159 Fax: 512-351-8858
For terms and conditions of sales, please visit:
www.abracon.com

REVISION: Initial 01-19-26

ABRACON IS
ISO9001-2015
CERTIFIED

AEC-Q200 Power Common Mode Choke



ACMP-Q5025

Request Samples



Check Inventory



5.0 x 4.5 x 2.5 mm
RoHS/RoHS II Compliant
MSL Level = 1

Schematic

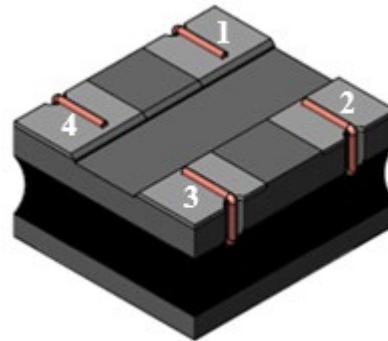
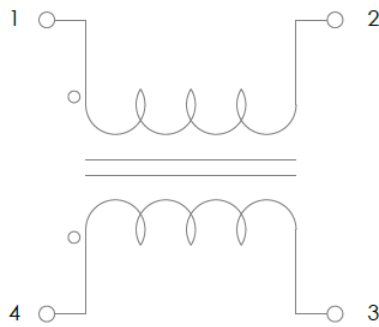

Materials

Description	Specification
Core	Ferrite core
Wire	Enameled copper wire
Adhesive	Epoxy resin
Terminal	Sn/Cu

Part Marking

No ink or laser marking on top. See schematic section for orientation.

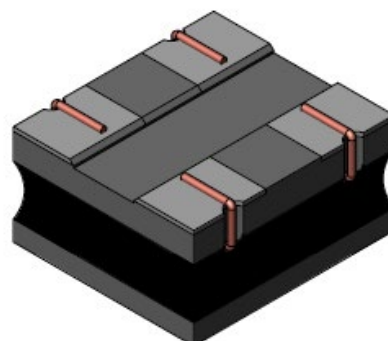
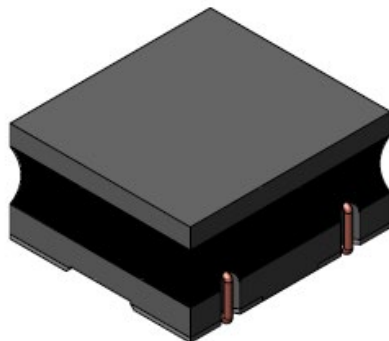

12117 Bee Caves Rd, Bldg-3, Suite 200
Bee Cave, TX 78738
Phone: 512-371-6159 Fax: 512-351-8858
For terms and conditions of sales, please visit:
www.abracon.com

REVISION: Initial 01-19-26

ABRACON IS
ISO9001-2015
CERTIFIED

AEC-Q200 Power Common Mode Choke



ACMP-Q5025

Request Samples



Check Inventory



5.0 x 4.5 x 2.5 mm
RoHS/RoHS II Compliant
MSL Level = 1

Reflow Profile

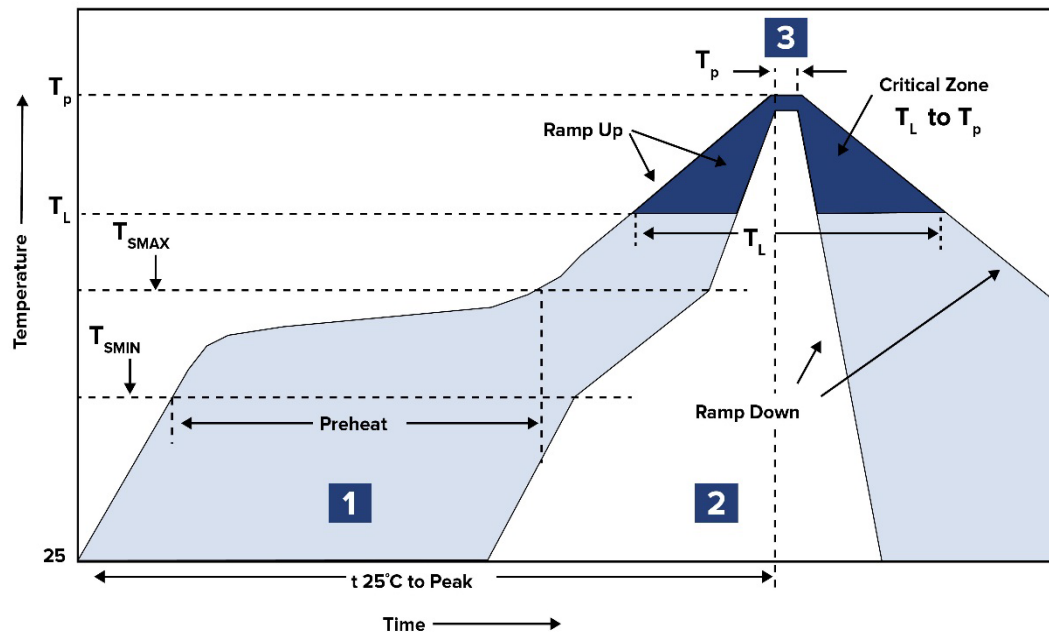

Zone	Description	Temperature	Times
1	Preheat	$T_{SMIN} \sim T_{SMAX}$ 150°C ~ 190°C	60 ~ 120 sec.
2	Reflow	T_L 250°C	40 sec. Max
3	Peak heat	T_P 260°C Max.	10 sec. Max

1~2 °C/Sec. Ramp

AEC-Q200 Power Common Mode Choke



ACMP-Q5025

Request Samples



Check Inventory



5.0 x 4.5 x 2.5 mm
RoHS/RoHS II Compliant
MSL Level = 1

Packaging

Tape & Reel: 2500pcs/reel

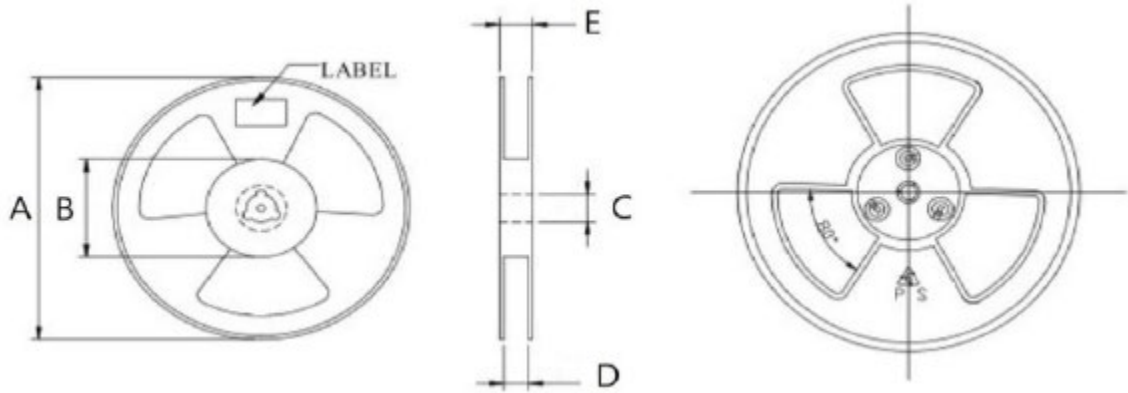

Type	A	B	C	D	E
13" x 12mm	330 ± 1.0	100 ± 2.0	13.5 ± 0.5	12.7 ± 0.50	16.7 ± 0.50

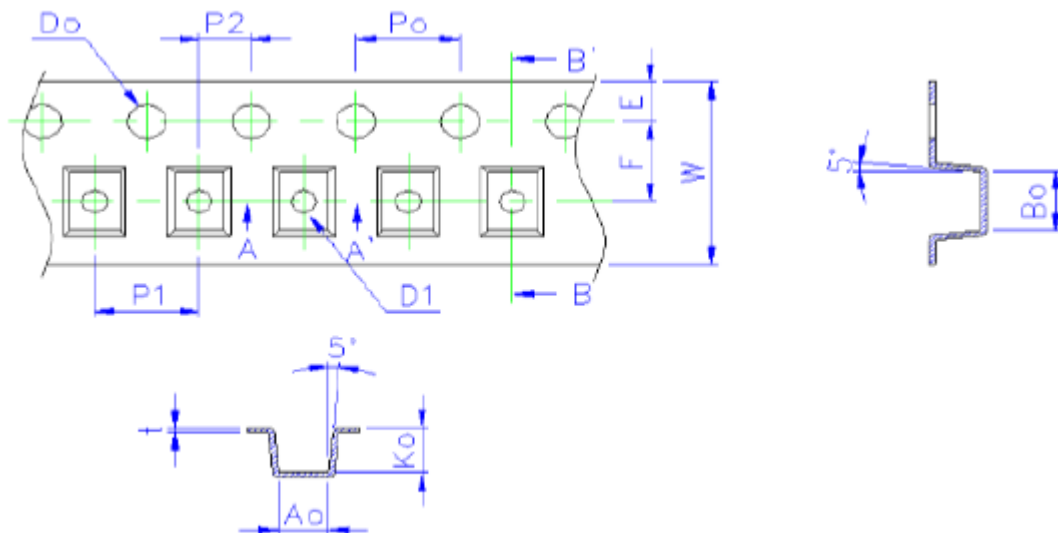

T	A0	B0	K0	W	E	F	P0	P1	P2	D0
0.25 ± 0.05	4.80 ± 0.10	5.30 ± 0.10	2.5 ± 0.10	12.0 ± 0.20	1.75 ± 0.10	5.5 ± 0.05	4.0 ± 0.05	8.0 ± 0.10	2.0 ± 0.05	1.5 ± 0.10

Dimensions: mm

ATTENTION: Abracon LLC's products are Commercial-Off-The-Shelf (COTS, which are designed, intended and validated for use in commercial, industrial and automotive applications. The customer is responsible for testing and verifying the performance of an Abracon solution to meet their system-level requirements.



12117 Bee Caves Rd, Bldg-3, Suite 200
Bee Cave, TX 78738
Phone: 512-371-6159 Fax: 512-351-8858
For terms and conditions of sales, please visit:
www.abracon.com

REVISION: Initial 01-19-26

ABRACON IS
ISO9001-2015
CERTIFIED