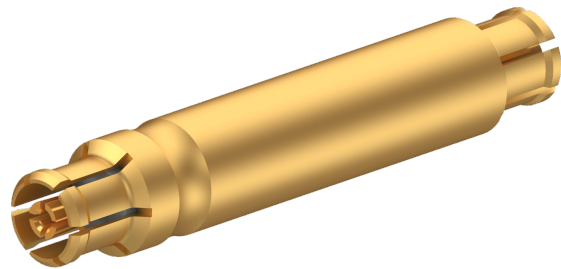

COAXIAL ADAPTER, SMPM, 50 Ohm, jack / jack (female / female)

31_SMPM-50-0-4/111_N

Properties

- Best performance-to-price ratio
- Excellent RF performance up to 65 GHz
- Small size, compact form factor
- Snap-on coupling mechanism with full detent and smooth bore
- Board-to-board solutions with bullets for axial and radial float

**Product configuration**

Interface type	Gender	Standard
SMPM	jack (female)	MIL-STD-348B
SMPM	jack (female)	MIL-STD-348B

Interface and material data

SMPM		
Piece parts	Material	Plating
Centre contact	Copper Beryllium Alloy	SUCOPRO Plating
Outer conductor	Copper Beryllium Alloy	SUCOPRO Plating
Body	Copper Beryllium Alloy	SUCOPRO Plating
Insulator	PTFE (Polytetrafluoroethylene)	
SMPM		
Piece parts	Material	Plating

Electrical Data (frequency related)

Frequency range	Return loss	VSWR
0 GHz ... 18 GHz	26 dB	1.11
18 GHz ... 40 GHz	15 dB	1.43
40 GHz ... 60 GHz	10 dB	1.92

Mechanical data

Weight	0.4 g
Mating cycles	500

Engagement / Disengagement force

	Engagement	Engagement	Disengagement	Disengagement
Interface class	Full detent	Smooth bore	Full detent	Smooth bore

COAXIAL ADAPTER, SMPM, 50 Ohm, jack / jack (female / female)

31_SMPM-50-0-4/111_N

Engagement / Disengagement force				
	Engagement	Engagement	Disengagement	Disengagement
Interface force typical	20 N	11 N	29 N	6.7 N
Interface class	The force is determined by the counterpart			
Interface force typical				

Environmental data	
Operation temperature	-65 °C ... 165 °C

Material compliance			
Item number	Directive / Regulation	Rating	Exemptions / Details
85237917	RoHS 2011/65/EU and (EU) 2015/863	Compliant with exemption	6c
	REACH 1907/2006 Article 33 SVHC	Contains one or more SVHC >0,1%	CAS: 7439-92-1 Lead
85274838	RoHS 2011/65/EU and (EU) 2015/863	Compliant with exemption	6c
	REACH 1907/2006 Article 33 SVHC	Contains one or more SVHC >0,1%	CAS: 7439-92-1 Lead

Ordering Information Table		
Item number	Item description	Packaging type
85237917	31_SMPM-50-0-4/111_NE	Single
85274838	31_SMPM-50-0-4/111_NH	Bulk 100 pcs

Additional Information	
Remarks	<p>The values provided are typical and may vary depending on factors such as the mating connector, and installation condition.</p> <p>Mating force and mating cycles are determined by the mating connector (full detent or smooth bore).</p> <p>Mating cycles: full detent: 100 smooth bore: 500</p>

HUBER+SUHNER is certified by ISO 9001, ISO 14001, ISO 45001, IATF 16949, AS/EN 9100 and ISO/TS 22163-IRIS. Waiver: Facts and figures herein are for information only and do not represent any warranty of any kind.
DOCUMENT PIM-P60539 / Date of publication: 04.12.2025 / uncontrolled copy