

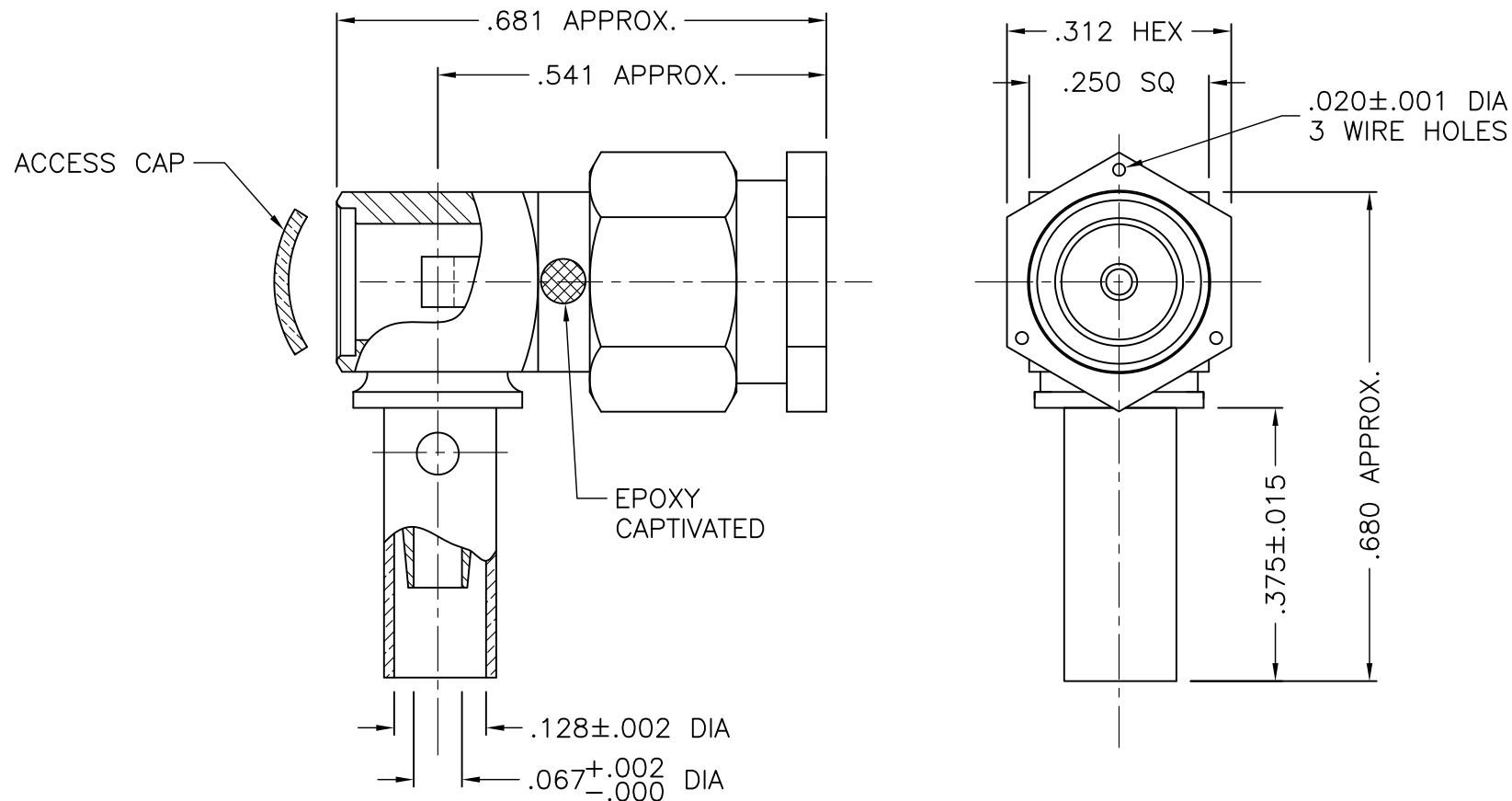

1305-037-K00E-1



1. ASSEMBLED CONNECTOR INTERFACE IS DESIGNED IN ACCORDANCE WITH MIL-STD-348.
2. MATERIAL: BODY & COUPLING NUT - CORROSION RESISTANT STEEL PER ASTM A582
CONTACT - BRASS PER ASTM B16.
GASKET - SILICONE RUBBER PER A-A-59588
INSULATORS - TEFLON PER ASTM D4894
SOLDER SLEEVE - D.H.P. COPPER CDA ALLOY 122
3. FINISHES: COUPLING NUT - PASSIVATE PER AMS-QQ-P-35
ALL OTHER METAL PARTS - GOLD PLATE PER ASTM B488

M39012/56-3007

DELTA ELECTRONICS MFG. CORP. Beverly, MA 01915

TITLE: SMA RIGHT ANGLE SOLDER PLUG FOR RG-174
179B, 187A, 188A, 316/U CABLES - CAPTIVE CONTACT

Drawn by BJM 3/22/05	Scale 4/1	Ckd. by MR	Engr Appd MR	FILE NAME: 1305037K00E-001T
----------------------------	--------------	---------------	-----------------	--------------------------------

CODE IDENT.-00795

1305-037-K00E-1

UNLESS OTHERWISE SPECIFIED: TOLERANCES: 3 PLACES = ± 0.005 , 2 PLACES = ± 0.02 , ANGLES = $\pm 1/2^\circ$, SURFACE FINISH = 63

THESE DRAWINGS AND SPECIFICATIONS ARE THE PROPERTY OF DELTA ELECTRONICS MFG CORP. AND SHALL NOT BE REPRODUCED, OR COPIED OR USED AS THE BASIS FOR THE MANUFACTURE OR SALE OF APPARATUS OR DEVICES WITHOUT THEIR EXPRESS WRITTEN CONSENT.

A	REVISED	9/13/12
-	OUTLINE	3/22/05
ALT.	REVISIONS	DATE