

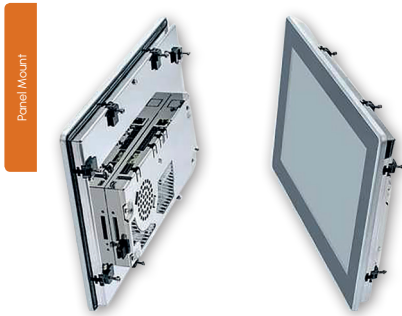

## Santaro Vision 10.1 PM MX6

10.1 inch Panel Mount HMI based on NXP i.MX6 processor

### Large high-resolution touch display



#### HIGHLIGHTS



**CPU**  
NXP i.MX 6 Family



**CONNECTIVITY**  
1x 100MbE, up to 2x USB, 2x RS232, RS485, CAN



**GRAPHICS**  
GC320 & GC355 2D accelerator + GC2000 3D accelerator



**MEMORY**  
Soldered on Board DDR3L memory



**yocto**  
PROJECT

#### MAIN FIELDS OF APPLICATION



Medical



Industrial  
Automation



Smart Devices



Digital Signage

#### FEATURES

Processor	NXP i.MX 6 Family based on Arm® Cortex®-A9 cores : i.MX 6 Quad – Full featured, 4x Cortex®-A9 cores up to 1.0GHz i.MX 6 Dual – Full featured, 4x Cortex®-A9 cores up to 1.0GHz i.MX 6 Single – Full featured, 4x Cortex®-A9 cores up to 1.0GHz	Serial Ports	2x RS-232, RS-485
Memory	1 GB 64 bit DDR3L	Power Supply	9 ÷ 32 V <sub>DC</sub>
Graphics	Integrated Graphics, with up to 3 separate HW accelerators for 2D, OpenGL® ES2.0 3D OpenVG™ accelerator HW encoding of MPEG-4, H.263 V2, H.264, MJPEG HW decoding of MPEG-2, VC1, MPEG-4 / XviD, H.263, H.264, DivX	Operating System	Yocto
Video Resolution	10.1 inch display, resolution 1280 x 800, LED lifetime typ. 50k hours typ. 420 cd/m² brightness P-Cap (Projected Capacitive touch screen), with 3.0mm toughened glass cover, RAL 9005	Operating Temperature*	0°C ÷ +60°C
Mass Storage	eMMC: 4 GB MLC SD slot: 4 bit MMC/SDIO/SD/SDHC	Dimensions	275.2 x 192.0 x 37.7 mm
Networking	1x 100MbEthernet	*Measured at any point of SECO standard heatspreader for this product, during any and all times (including start-up). Actual temperature will widely depend on application, enclosure and/or environment. Upon customer to consider application-specific cooling solutions for the final system to keep the heatspreader temperature in the range indicated.	
USB	1x USB 2.0 OTG micro-AB 1x USB 2.0 Type-A		
Audio	1x speaker (connector), 1 W RMS (8Ω) parallel to internal speaker		
Other Interfaces	2x Digital Input, 2x Digital Output		

# Santaro Vision 10.1 PM MX6

10.1 inch Panel Mount HMI based on NXP i.MX6 processor

## BLOCK DIAGRAM

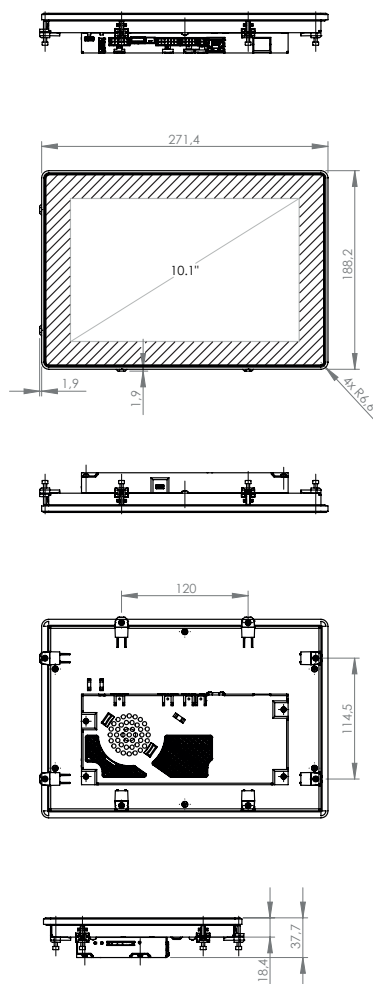

M 1:4,5  
Schräffur 0,5  
Schrift 2,0  
Bemaßung grau eingefärbt

# Streamline and expedite your edge computing implementations

## EDGEHOG OS

A flexible operating system that adapts to your needs, thanks to the customization tool and Docker support. Reliability and security are built-in through a dual-partition system and native integration with Exein's robust AI-based protection.

## DATA ORCHESTRATION

Integrate third-party services, simplify data flows and analysis, and enhance business efficiency by enabling easy and fast utilization of AI.

## DEVICE MANAGER

Update, configure, and manage remote devices. Optimize time and costs to maximize operational efficiency and security without the need for costly field interventions.

## PORTAL

Analyze data from remote devices, customize the user experience with applications tailored to user needs, and manage user rights, company access, and tenant privileges.

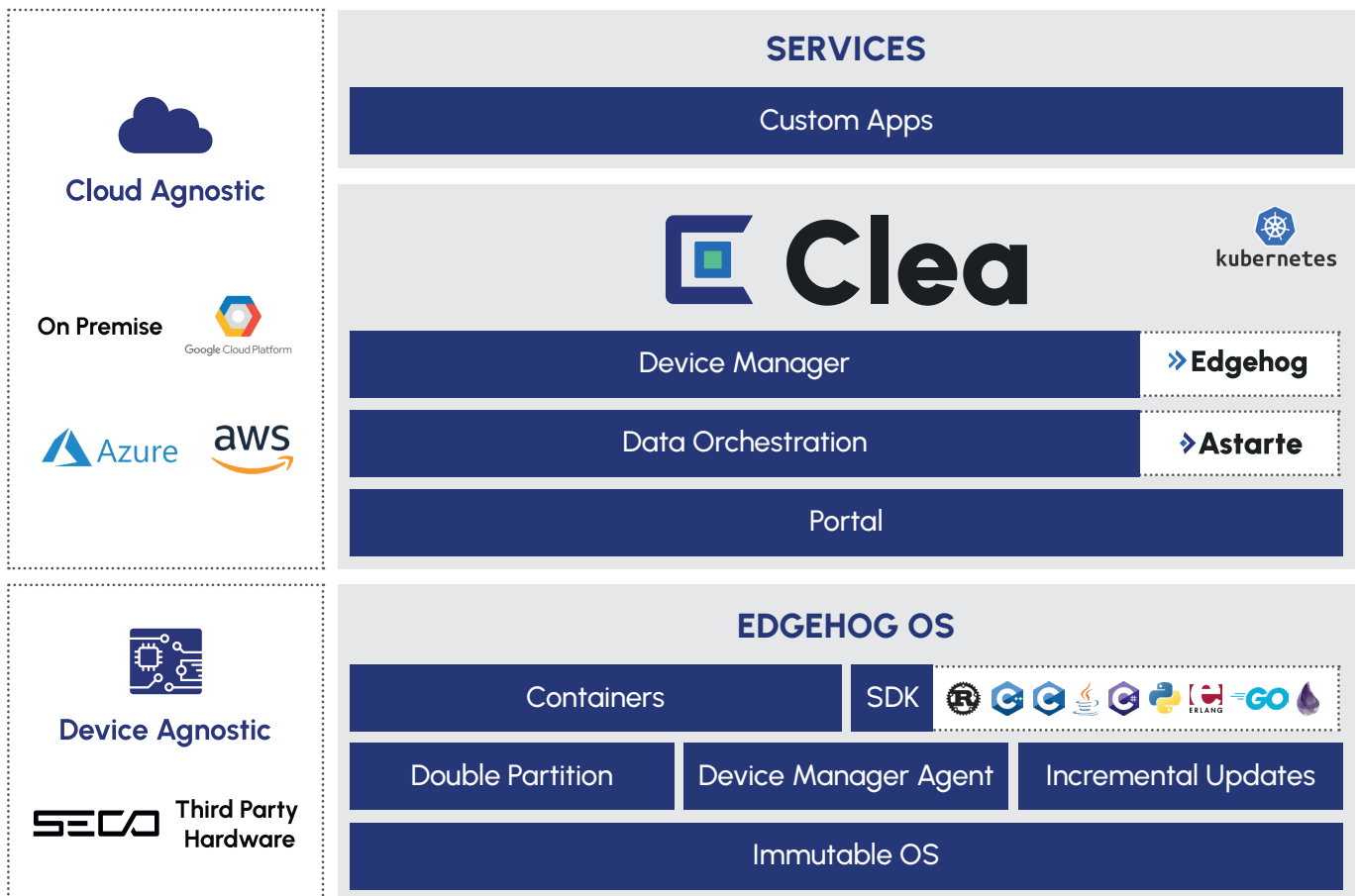

Scan to know more about our solution

EDGEHOG OS



CLEA DOCS

