

PTS641 Series

SMT Top Actuated Switches



Features/Benefits

- 6.3 x 6.3 mm footprint
- Multiple heights
- Ground pin option

Typical Applications

- Metering
- White goods
- Home and garden equipment

Specification

FUNCTION: Momentary action

CONTACT ARRANGEMENT: 1 make contact = SPST N.O.

TERMINALS: G type for SMT

Mechanical

TRAVEL:

0.20 mm ±0.15 mm for 160 & 250 gf

0.30 mm ±0.15 mm for 320 gf

OPERATING LIFE: 100,000 cycles

OPERATION FORCE:

160 gf ±50 gf blue actuator

250 gf ±50 gf red actuator

320 gf ±80 gf black actuator

Packaging

Switches in reels of 1,500 pieces.

Dimensions of reels according to EIA 481B

External diameter 330 mm

Electrical

MAXIMUM VOLTAGE: 12 VDC

MAXIMUM CURRENT DC: 50 mA

DIELECTRIC STRENGTH: 250 VA C (1mn)

CONTACT RESISTANCE: 100 m Ω

INSULATION RESISTANCE: ≥ 100 M Ω

BOUNCE TIME: < 5 ms

Environmental

OPERATING TEMPERATURE: -20°C to 85°C

Process

SOLDERING: This component is suited to the following methods:

Infrared Reflow Soldering in accordance with IEC61760-1

NOTE: Specifications listed above are for switches with standard options.
For information on specific and custom switches, consult Customer Service Center.

How To Order

Our easy build-a-switch concept allows you to mix and match options to create the switch you need. To order, select desired option from each category and and place it in the appropriate box.

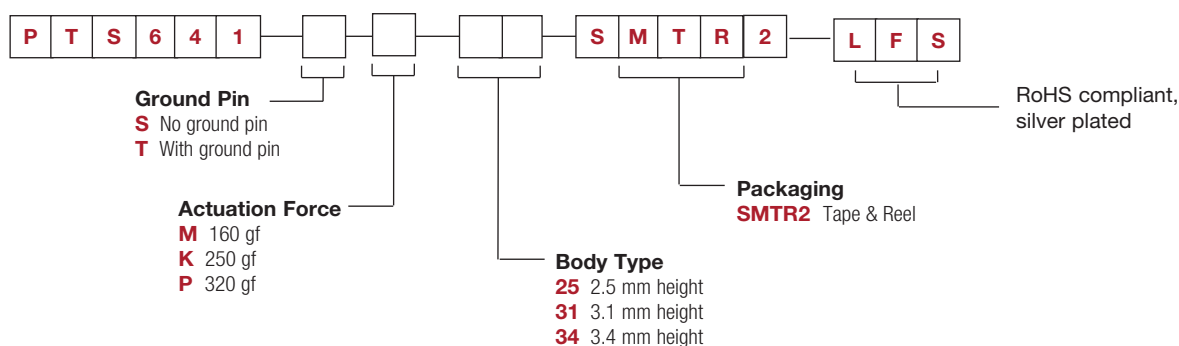

PTS641 Series SMT Top Actuated Switches

NO GROUND PIN H = 2.5, 3.1, or 3.4 mm

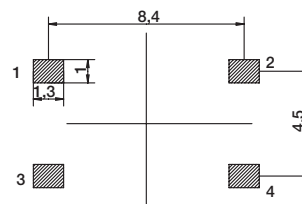
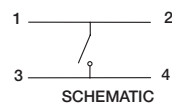
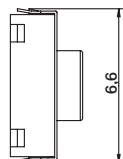
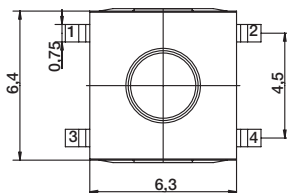
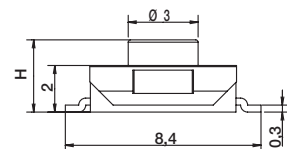

RECOMMENDED PCB LAYOUT

Tactile Switches

GROUND PIN H = 2.5, 3.1, or 3.4 mm

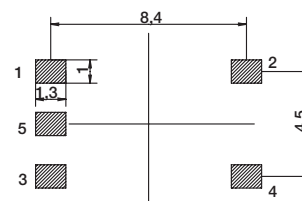
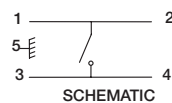
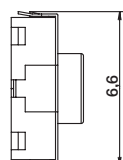
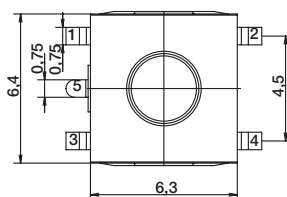
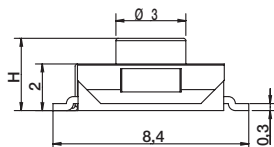

RECOMMENDED PCB LAYOUT

Mouser Electronics

Authorized Distributor

Click to View Pricing, Inventory, Delivery & Lifecycle Information:

C&K Switches:

[PTS641SK31SMTR2 LFS](#) [PTS641TK31SMTR2 LFS](#) [PTS641TM34SMTR2 LFS](#) [PTS641TP31SMTR2 LFS](#)
[PTS641SP25SMTR2 LFS](#) [PTS641SK25SMTR2 LFS](#) [PTS641SM31SMTR2 LFS](#)