

# BATTERY CONNECTORS

## Vertical Mate 2.0mm Pitch 9155-800

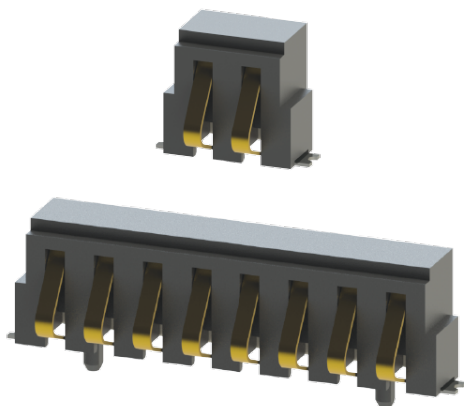

The complete 9155 family of battery connectors from KYOCERA AVX offer all the same advantages: Ultra reliable and robust gold-plated beryllium copper contacts that provide high integrity connections in harsh environments, with up to 15000 mating operations. Parts are supplied in tape and reel for automatic pick and place. Whatever your requirements, the 9155 series battery connector can be customized to suit your applications.

The 2.0mm pitch, vertical mate 9155-800 series eliminates end user damage when pluggable modules or packs are pressed down vertically into a base unit. Traditional right-angle connectors have contact geometries that rely on the pack being inserted at an angle and then rotated down into position. The unique contact design of this connector deflects cleanly and easily when a module or mating connector is pushed vertically into position, eliminating any end user damage. The 9155-800 series is rated up to 5,000 mating cycles and has a contact nose with an anti-snag feature to protect during deflection.

### APPLICATIONS

- Handheld/portable devices requiring docking or cradle charging
- Patient monitoring or portable medical electronics
- Industrial devices requiring pluggable or programming modules
- Internet appliances requiring battery back-up
- Product Specification: Refer to 201-01-204
- Application Notes: Refer to 201-01-205

### FEATURES AND BENEFITS

- Gold plated BeCu contacts provide high electrical and mechanical performance over 5000 mating cycles
- Unique contact geometry allows for full vertical engagement in pluggable module applications
- Plastic locating bosses and SMT anchor tabs maximizes the mechanical stability of the connector in harsh conditions
- Contact nose incorporates an anti-snag feature to protect during deflection

### ELECTRICAL

- Current Rating: 2p-4p: 2.0 Amps,  
5p-8p: 1.5 Amps
- Voltage Rating: 125 VAC or DC Equivalent

### ENVIRONMENTAL

- Operating Temperature: -40°C to +125°C
- Storage Temperature: -40°C to +70°C

### MECHANICAL

- Insulator Material: Glass-Filled Nylon 46; UL94V0
- Contact Material: Beryllium Copper
- Plating: Gold over Nickel, Tin leads
- Durability: 5000 Cycles

### HOW TO ORDER

**00**      **9155**      **00X**  
Prefix      Series      No. of Ways

Code	No of Ways	Packing QTY
002	2	1000
003	3	1000
004	4	1000
005	5	1000
006	6	1000
007	7	1000
008	8	1000

**8XX**  
Standard Battery Connector Right Angle  
Pitch 2.0mm  
852 = Boss: Yes  
851 = Boss: No

**00X**  
Plating Option  
006 = 0.4µm Selective Gold, Pure Tin Tail (Standard)  
008 = 0.8µm Selective Gold, Pure Tin Tail



# BATTERY CONNECTORS

## Vertical Mate 2.0mm Pitch 9155-800

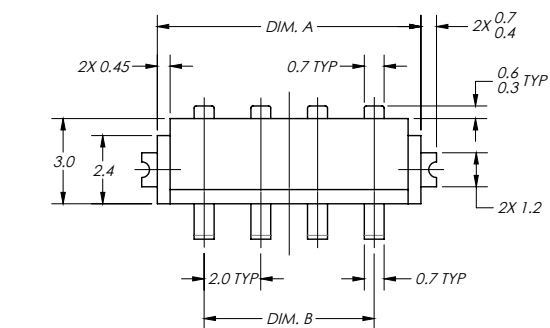

Part Number Table 1	Pos.	Dim. A	Dim. B	Dim. C	TAPE WIDTH
00-9155-002-85X-00X	2	5.3	2.0	N/A	24
00-9155-003-85X-00X	3	7.3	4.0	2.00	24
00-9155-004-85X-00X	4	9.3	6.0	4.00	24
00-9155-005-85X-00X	5	11.3	8.0	6.00	24
00-9155-006-85X-00X	6	13.3	10.0	8.00	32
00-9155-007-85X-00X	7	15.3	12.0	10.00	32
00-9155-008-85X-00X	8	17.3	14.0	12.00	32

Part Number Table 2	Locating Boss
00-9155-00X-851-00X	Without Boss
00-9155-00X-852-00X	With Boss

Part Number Table 3	Contact Plating
00-9155-00X-85X-006	0.4 $\mu$ m GOLD
00-9155-00X-85X-008	0.8 $\mu$ m GOLD

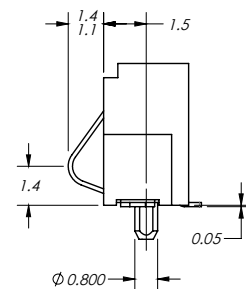
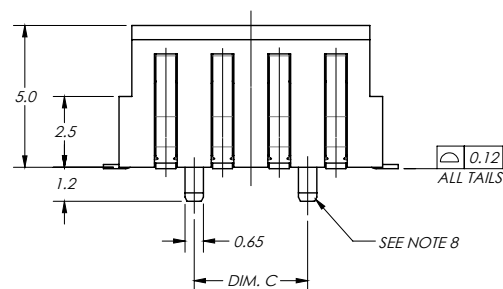

### NOTES:

- FOR FULL PRODUCT DETAILS, REFER TO KYOCERA AVX SPECIFICATION 201-01-204. FOR APPLICATION DATA, REFER TO KYOCERA AVX SPECIFICATION 201-01-205
- HOUSING MATERIAL: GLASS-FILLED NYLON 46; UL94V-0; COLOR: BLACK.
- CONTACT MATERIAL: BERYLLIUM-COPPER.
- CONTACT PLATING: NICKEL UNDERPLATE ALL OVER; LEAD-FREE TIN ON SOLDER TAILS; GOLD IN CONTACT AREA. SEE PART NUMBER TABLE 3.
- SOLDER TAB: PHOSPHOR-BRONZE ALLOY WITH LEAD-FREE TIN OVER NICKEL PLATING.
- CONTACT DEFLECTION TO BE BETWEEN 0.7 AND 1.2 mm.
- CHAMFER RECOMMENDED IF MATING DIRECTION IS VERTICAL.
- PART AVAILABLE WITH AND WITHOUT LOCATING PEGS. 2 POSITION PART HAS ONLY ONE BOSS. SEE PART NUMBER TABLE 2.

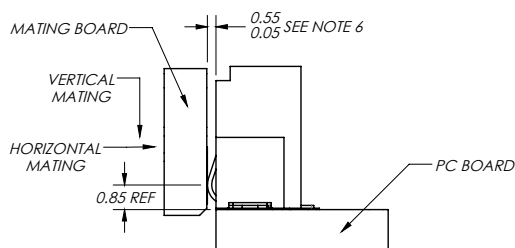

**MATED CONDITION  
PCB-TO-CONNECTOR**

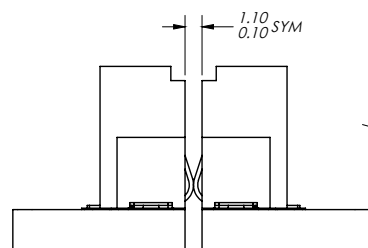

**MATED CONDITION  
CONNECTOR-TO-CONNECTOR**

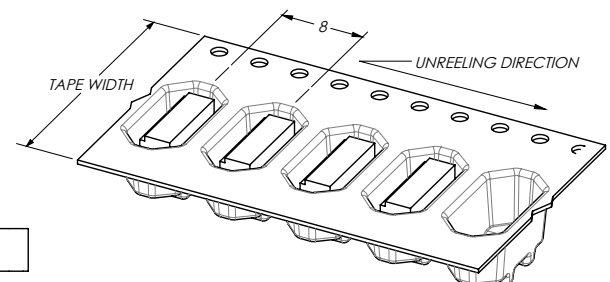

PACKAGING PER EIA-481  
1,000 PARTS PER 330 mm REEL

### PACKAGING

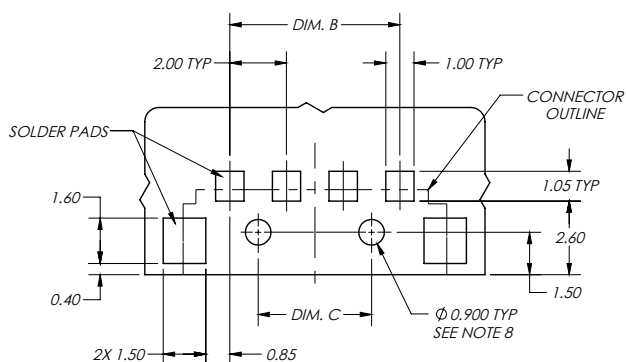

**SUGGESTED PCB LAYOUT**

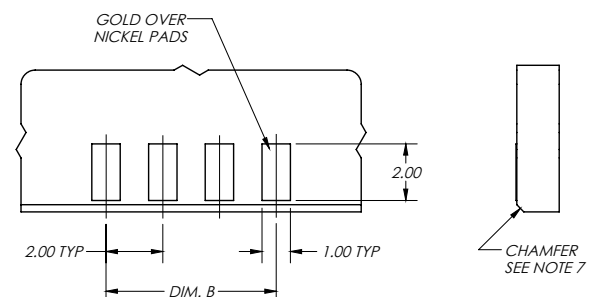

**MATING PCB LAYOUT**

**BATTERY CONNECTORS**  
**Vertical Mate 2.0mm Pitch 9155-800**



**2MM PITCH RIGHT ANGLE CONNECTOR**

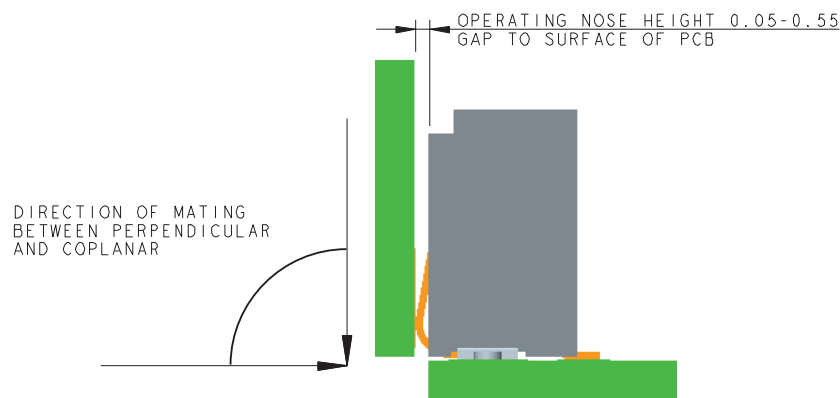
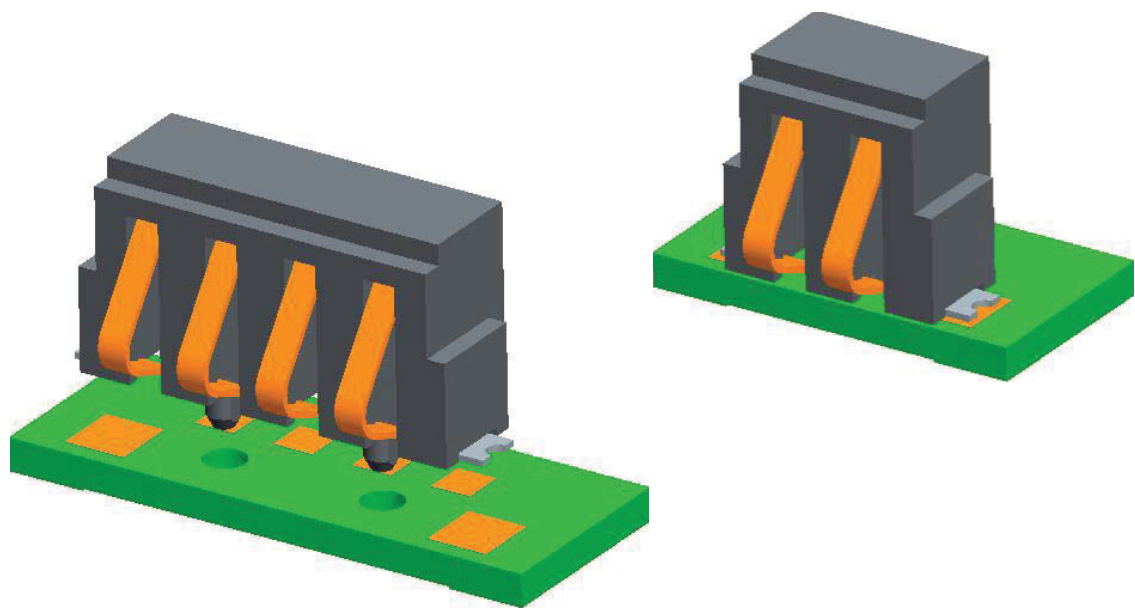

**BOARD TO BOARD/COMPONENT**  
**(REFER TO APPLICATION NOTES 201-01-205)**

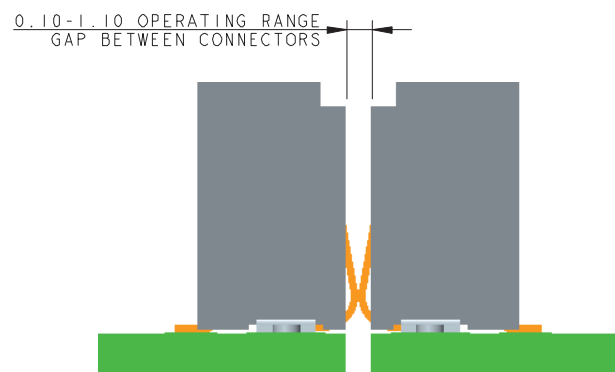

**CONNECTOR TO CONNECTOR**  
**(REFER TO APPLICATION NOTES 201-01-205)**

# Mouser Electronics

Authorized Distributor

Click to View Pricing, Inventory, Delivery & Lifecycle Information:

[KYOCERA AVX:](#)

[009155007852006](#) [009155002851006](#) [009155003851006](#) [009155004851006](#) [009155005851006](#)  
[009155006851006](#) [009155007851006](#) [009155008851006](#) [009155008852006](#)