

# ESD Protection Diode

## Micro-Packaged Diodes for ESD Protection

### ESD5Z2.5T1G Series, SZESD5Z2.5T1G Series

The ESD5Z Series is designed to protect voltage sensitive components from ESD and transient voltage events. Excellent clamping capability, low leakage, and fast response time, make these parts ideal for ESD protection on designs where board space is at a premium. Because of its small size, it is suited for use in cellular phones, portable devices, digital cameras, power supplies and many other portable applications.

#### Specification Features:

- Low Clamping Voltage
- Small Body Outline Dimensions:  
0.047" x 0.032" (1.20 mm x 0.80 mm)
- Low Body Height: 0.028" (0.7 mm)
- Stand-off Voltage: 2.5 V – 12 V
- Peak Power up to 240 Watts @ 8 x 20  $\mu$ s Pulse
- Low Leakage
- Response Time is Typically < 1 ns
- ESD Rating of Class 3 (> 16 kV) per Human Body Model
- IEC61000-4-2 Level 4 ESD Protection
- IEC61000-4-4 Level 4 EFT Protection
- SZ Prefix for Automotive and Other Applications Requiring Unique Site and Control Change Requirements; AEC-Q101 Qualified and PPAP Capable
- These Devices are Pb-Free and are RoHS Compliant\*

#### Mechanical Characteristics:

**CASE:** Void-free, transfer-molded, thermosetting plastic  
Epoxy Meets UL 94 V-0

**LEAD FINISH:** 100% Matte Sn (Tin)

**MOUNTING POSITION:** Any

**QUALIFIED MAX REFLOW TEMPERATURE:** 260°C

Device Meets MSL 1 Requirements



SOD-523  
CASE 502  
STYLE 1

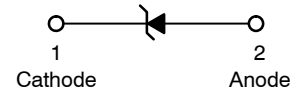

#### MARKING DIAGRAM

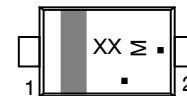

XX = Specific Device Code

M = Date Code

▪ = Pb-Free Package

(Note: Microdot may be in either location)

\*Date Code orientation may vary depending upon manufacturing location.

#### ORDERING INFORMATION

| Device         | Package            | Shipping <sup>†</sup> |
|----------------|--------------------|-----------------------|
| SZ/ESD5ZxxxT1G | SOD-523<br>Pb-Free | 3000 /<br>Tape & Reel |
| SZ/ESD5ZxxxT5G | SOD-523<br>Pb-Free | 8000 /<br>Tape & Reel |

<sup>†</sup>For information on tape and reel specifications, including part orientation and tape sizes, please refer to our Tape and Reel Packaging Specifications Brochure, BRD8011/D.

#### DEVICE MARKING INFORMATION

See specific marking information in the device marking column of the Electrical Characteristics tables starting on page 3 of this data sheet.

\*For additional information on our Pb-Free strategy and soldering details, please download the onsemi Soldering and Mounting Techniques Reference Manual, SOLDERRM/D.

## ESD5Z2.5T1G Series, SZESD5Z2.5T1G Series

### MAXIMUM RATINGS

| Rating  | Symbol         | Value                | Unit             |
|---|----------------|----------------------|------------------|
| IEC 61000-4-2 (ESD)<br>Contact<br>Air                                     |                | $\pm 30$<br>$\pm 30$ | kV               |
| IEC 61000-4-4 (EFT)   |                | 40                   | A                |
| ESD Voltage<br>Per Human Body Model<br>Per Machine Model                  |                | 16<br>400            | kV<br>V          |
| Total Power Dissipation on FR-4 Board (Note 1) @ $T_A = 25^\circ\text{C}$ | $P_D$          | 500                  | mW               |
| Junction and Storage Temperature Range                                    | $T_J, T_{stg}$ | -55 to +150          | $^\circ\text{C}$ |
| Lead Solder Temperature – Maximum (10 Second Duration)                    | $T_L$          | 260                  | $^\circ\text{C}$ |

Stresses exceeding those listed in the Maximum Ratings table may damage the device. If any of these limits are exceeded, device functionality should not be assumed, damage may occur and reliability may be affected.

1. FR-4 printed circuit board, single-sided copper, mounting pad 1 cm<sup>2</sup>.

See Application Note AND8308/D for further description of survivability specs.

### ELECTRICAL CHARACTERISTICS

( $T_A = 25^\circ\text{C}$  unless otherwise noted)

| Symbol    | Parameter   |
|-----------|---|
| $I_{PP}$  | Maximum Reverse Peak Pulse Current                  |
| $V_C$     | Clamping Voltage @ $I_{PP}$                         |
| $V_{RWM}$ | Working Peak Reverse Voltage                        |
| $I_R$     | Maximum Reverse Leakage Current @ $V_{RWM}$         |
| $V_{BR}$  | Breakdown Voltage @ $I_T$                           |
| $I_T$     | Test Current  |
| $I_F$     | Forward Current                                     |
| $V_F$     | Forward Voltage @ $I_F$                             |
| $P_{pk}$  | Peak Power Dissipation                              |
| C         | Max. Capacitance @ $V_R = 0$ and $f = 1\text{ MHz}$ |

\*See Application Note AND8308/D for detailed explanations of datasheet parameters.

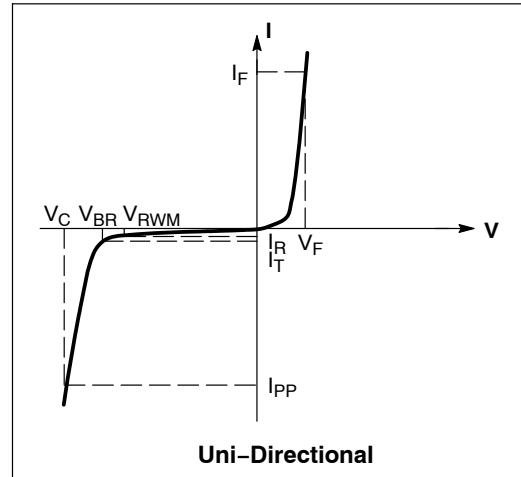

## ESD5Z2.5T1G Series, SZESD5Z2.5T1G Series

**ELECTRICAL CHARACTERISTICS** ( $T_A = 25^\circ\text{C}$  unless otherwise noted,  $V_F = 1.1\text{ V Max.}$  @  $I_F = 10\text{ mA}$  for all types)

| Device*         | Device Marking | $V_{RWM}$ (V) | $I_R$ ( $\mu\text{A}$ ) @ $V_{RWM}$ | $V_{BR}$ (V) @ $I_T$ (Note 2) | $I_T$ | $V_C$ (V) @ $I_{PP} = 5.0\text{ A}^\dagger$ | $V_C$ (V) @ Max $I_{PP}^\dagger$ | $I_{PP}$ (A) <sup>†</sup> | $P_{pk}$ (W) <sup>†</sup> | C (pF) | $V_C$                              |
|-----------------|----------------|---------------|-------------------------------------|-------------------------------|-------|---|----------------------------------|---------------------------|---------------------------|--------|------------------------------------|
|                 |                | Max           | Max                                 | Min                           | mA    | Typ   | Max                              | Max                       | Max                       | Typ    | Per IEC61000-4-2 (Note 3)          |
| ESD5Z2.5T1G/T5G | ZD             | 2.5           | 6.0                                 | 4.0                           | 1.0   | 6.5   | 10.9                             | 11.0                      | 120                       | 145    | Figures 1 and 2 See Below (Note 4) |
| ESD5Z3.3T1G/T5G | ZE             | 3.3           | 0.05                                | 5.0                           | 1.0   | 8.4   | 14.1                             | 11.2                      | 158                       | 105    |                                    |
| ESD5Z5.0T1G/T5G | ZF             | 5.0           | 0.05                                | 6.2                           | 1.0   | 11.6  | 18.6                             | 9.4                       | 174                       | 80     |                                    |
| ESD5Z6.0T1G/T5G | ZG             | 6.0           | 0.01                                | 6.8                           | 1.0   | 12.4  | 20.5                             | 8.8                       | 181                       | 70     |                                    |
| ESD5Z7.0T1G/T5G | ZH             | 7.0           | 0.01                                | 7.5                           | 1.0   | 13.5  | 22.7                             | 8.8                       | 200                       | 65     |                                    |
| ESD5Z12T1G/T5G  | ZM             | 12            | 0.01                                | 14.1                          | 1.0   | 17  | 25                               | 9.6                       | 240                       | 55     |                                    |

Product parametric performance is indicated in the Electrical Characteristics for the listed test conditions, unless otherwise noted. Product performance may not be indicated by the Electrical Characteristics if operated under different conditions.

\* Includes SZ-prefix devices where applicable.

<sup>†</sup> Surge current waveform per Figure 5.

2.  $V_{BR}$  is measured with a pulse test current  $I_T$  at an ambient temperature of  $25^\circ\text{C}$ .

3. For test procedure see Figures 3 and 4 and Application Note AND8307/D.

4. ESD5Z5.0T1G shown below. Other voltages available upon request.

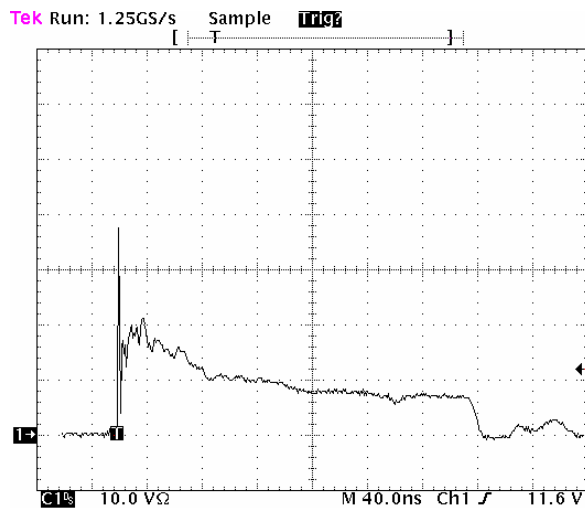

Figure 1. ESD Clamping Voltage Screenshot  
Positive 8 kV contact per IEC 61000-4-2

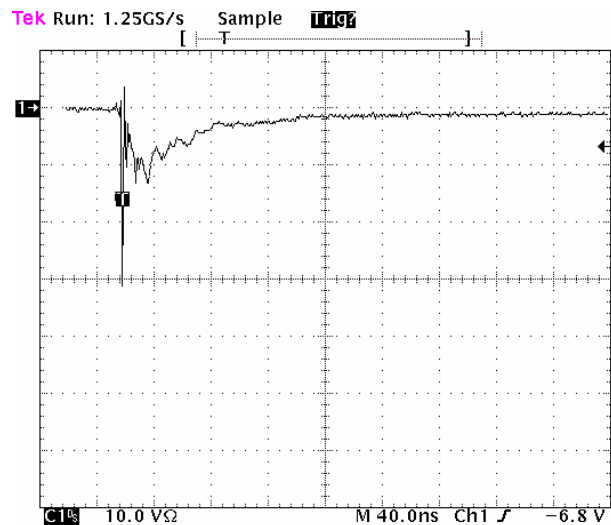

Figure 2. ESD Clamping Voltage Screenshot  
Negative 8 kV contact per IEC 61000-4-2

## ESD5Z2.5T1G Series, SZESD5Z2.5T1G Series

### IEC 61000-4-2 Spec.

| Level | Test Voltage (kV) | First Peak Current (A) | Current at 30 ns (A) | Current at 60 ns (A) |
|-------|-------------------|------------------------|----------------------|----------------------|
| 1     | 2                 | 7.5                    | 4                    | 2                    |
| 2     | 4                 | 15                     | 8                    | 4                    |
| 3     | 6                 | 22.5                   | 12                   | 6                    |
| 4     | 8                 | 30                     | 16                   | 8                    |



Figure 3. IEC61000-4-2 Spec

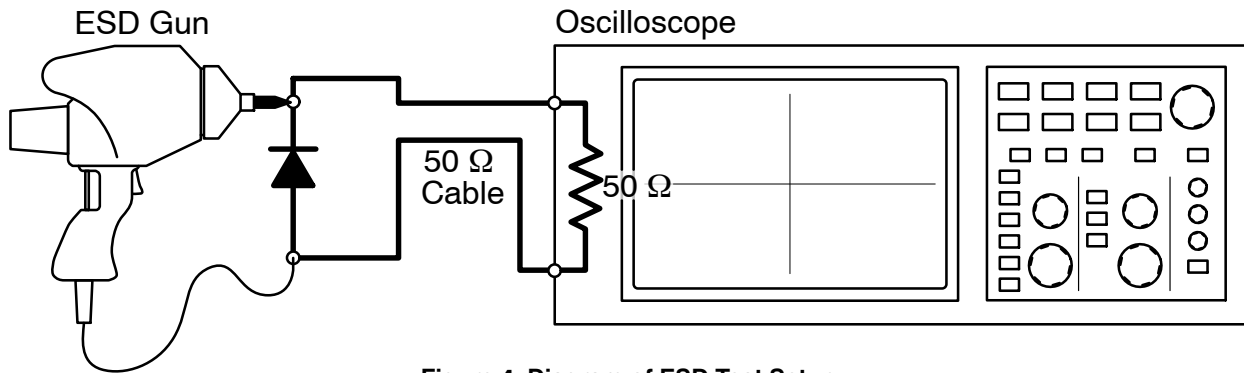

Figure 4. Diagram of ESD Test Setup

The following is taken from Application Note  
AND8308/D – Interpretation of Datasheet Parameters  
for ESD Devices.

### ESD Voltage Clamping

For sensitive circuit elements it is important to limit the voltage that an IC will be exposed to during an ESD event to as low a voltage as possible. The ESD clamping voltage is the voltage drop across the ESD protection diode during an ESD event per the IEC61000-4-2 waveform. Since the IEC61000-4-2 was written as a pass/fail spec for larger

systems such as cell phones or laptop computers it is not clearly defined in the spec how to specify a clamping voltage at the device level. **onsemi** has developed a way to examine the entire voltage waveform across the ESD protection diode over the time domain of an ESD pulse in the form of an oscilloscope screenshot, which can be found on the datasheets for all ESD protection diodes. For more information on how **onsemi** creates these screenshots and how to interpret them please refer to AND8307/D.

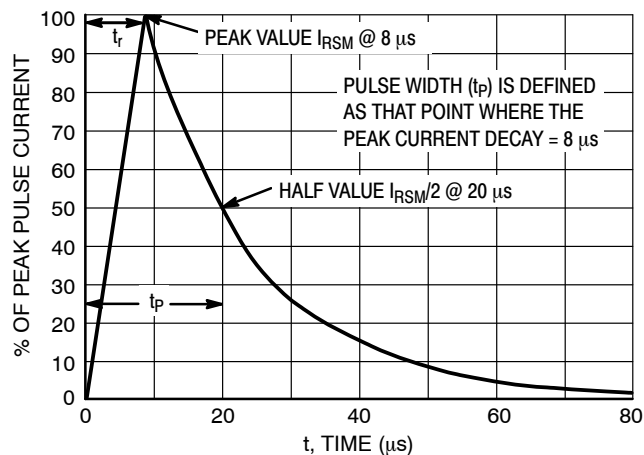
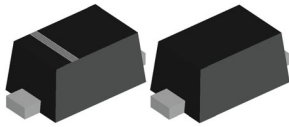

Figure 5. 8 X 20  $\mu$ s Pulse Waveform



### SOD-523 1.20x0.80x0.60

#### CASE 502

#### ISSUE F

DATE 08 FEB 2024

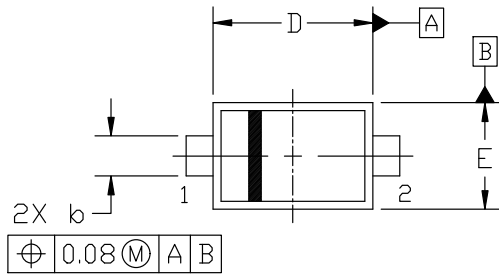

TOP VIEW

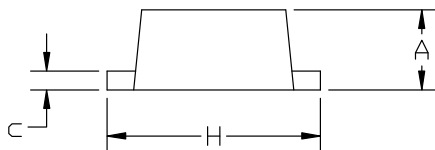

SIDE VIEW

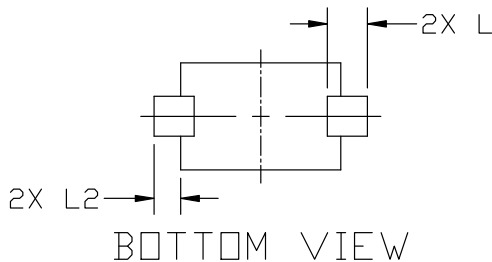

BOTTOM VIEW

#### GENERIC MARKING DIAGRAM\*

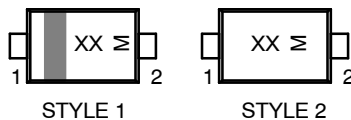

XX = Specific Device Code  
M Date Code

\*This information is generic. Please refer to device data sheet for actual part marking. Pb-Free indicator, "G" or microdot "▪", may or may not be present. Some products may not follow the Generic Marking.

STYLE 1: PIN 1: CATHODE (POLARITY BAND)  
2: ANODE  
STYLE 2: NO POLARITY

#### NOTES:

1. DIMENSIONING AND TOLERANCING PER ASME Y14.5M, 2018.
2. CONTROLLING DIMENSION: MILLIMETERS.
3. MAXIMUM LEAD THICKNESS INCLUDES LEAD FINISH, MINIMUM LEAD THICKNESS IS THE MINIMUM THICKNESS OF BASE MATERIAL.
4. DIMENSIONS D AND E DO NOT INCLUDE MOLD FLASH, PROTRUSIONS, OR GATE BURRS.

| DIM | MILLIMETERS |      |      |
|-----|-------------|------|------|
|     | MIN.        | NOM. | MAX. |
| A   | 0.50        | 0.60 | 0.70 |
| b   | 0.25        | 0.30 | 0.35 |
| c   | 0.07        | 0.14 | 0.20 |
| D   | 1.10        | 1.20 | 1.30 |
| E   | 0.70        | 0.80 | 0.90 |
| H   | 1.50        | 1.60 | 1.70 |
| L   | 0.30 REF    |      |      |
| L2  | 0.15        | 0.20 | 0.25 |

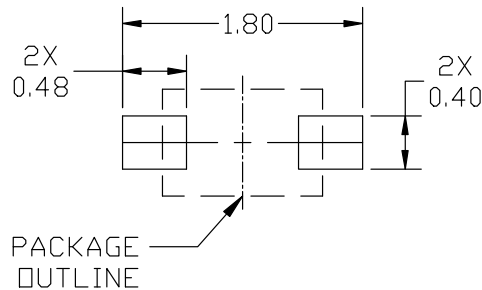

#### RECOMMENDED MOUNTING FOOTPRINT

\*For additional information on our Pb-Free strategy and soldering details, please download the ON Semiconductor Soldering and Mounting Techniques Reference manual, SOLDERRM/D.

|                  |                        |  |
|------------------|------------------------|--|
| DOCUMENT NUMBER: | 98AON11524D            | Electronic versions are uncontrolled except when accessed directly from the Document Repository. Printed versions are uncontrolled except when stamped "CONTROLLED COPY" in red. |
| DESCRIPTION:     | SOD-523 1.20x0.80x0.60 | PAGE 1 OF 1  |

onsemi and onsemi are trademarks of Semiconductor Components Industries, LLC dba onsemi or its subsidiaries in the United States and/or other countries. onsemi reserves the right to make changes without further notice to any products herein. onsemi makes no warranty, representation or guarantee regarding the suitability of its products for any particular purpose, nor does onsemi assume any liability arising out of the application or use of any product or circuit, and specifically disclaims any and all liability, including without limitation special, consequential or incidental damages. onsemi does not convey any license under its patent rights nor the rights of others.

**onsemi**, **Onsemi**, and other names, marks, and brands are registered and/or common law trademarks of Semiconductor Components Industries, LLC dba "**onsemi**" or its affiliates and/or subsidiaries in the United States and/or other countries. **onsemi** owns the rights to a number of patents, trademarks, copyrights, trade secrets, and other intellectual property. A listing of **onsemi**'s product/patent coverage may be accessed at [www.onsemi.com/site/pdf/Patent-Marking.pdf](http://www.onsemi.com/site/pdf/Patent-Marking.pdf). **onsemi** reserves the right to make changes at any time to any products or information herein, without notice. The information herein is provided "as-is" and **onsemi** makes no warranty, representation or guarantee regarding the accuracy of the information, product features, availability, functionality, or suitability of its products for any particular purpose, nor does **onsemi** assume any liability arising out of the application or use of any product or circuit, and specifically disclaims any and all liability, including without limitation special, consequential or incidental damages. Buyer is responsible for its products and applications using **onsemi** products, including compliance with all laws, regulations and safety requirements or standards, regardless of any support or applications information provided by **onsemi**. "Typical" parameters which may be provided in **onsemi** data sheets and/or specifications can and do vary in different applications and actual performance may vary over time. All operating parameters, including "Typicals" must be validated for each customer application by customer's technical experts. **onsemi** does not convey any license under any of its intellectual property rights nor the rights of others. **onsemi** products are not designed, intended, or authorized for use as a critical component in life support systems or any FDA Class 3 medical devices or medical devices with a same or similar classification in a foreign jurisdiction or any devices intended for implantation in the human body. Should Buyer purchase or use **onsemi** products for any such unintended or unauthorized application, Buyer shall indemnify and hold **onsemi** and its officers, employees, subsidiaries, affiliates, and distributors harmless against all claims, costs, damages, and expenses, and reasonable attorney fees arising out of, directly or indirectly, any claim of personal injury or death associated with such unintended or unauthorized use, even if such claim alleges that **onsemi** was negligent regarding the design or manufacture of the part. **onsemi** is an Equal Opportunity/Affirmative Action Employer. This literature is subject to all applicable copyright laws and is not for resale in any manner.

## ADDITIONAL INFORMATION

### TECHNICAL PUBLICATIONS:

Technical Library: [www.onsemi.com/design/resources/technical-documentation](http://www.onsemi.com/design/resources/technical-documentation)  
onsemi Website: [www.onsemi.com](http://www.onsemi.com)

### ONLINE SUPPORT: [www.onsemi.com/support](http://www.onsemi.com/support)

For additional information, please contact your local Sales Representative at  
[www.onsemi.com/support/sales](http://www.onsemi.com/support/sales)

# Mouser Electronics

Authorized Distributor

Click to View Pricing, Inventory, Delivery & Lifecycle Information:

[onsemi:](#)

[ESD5Z12T1](#) [ESD5Z2.5T1](#) [ESD5Z5.0T1](#) [ESD5Z7.0T1](#) [SZESD5Z5.0T5G](#) [SZESD5Z6.0T1G](#)