

# Customer Information Sheet

IF IN DOUBT - ASK

©

NOT TO SCALE

THIRD ANGLE PROJECTION

ALL DIMENSIONS IN mm

SPECIFICATIONS:  
MATERIAL:  
  MOULDING = GLASS-FILLED PPS,  
              UL94V-0, BLACK  
  CONTACT = PHOSPHOR BRONZE  
  JACKSCREW = STAINLESS STEEL  
FINISH (CONTACTS) = SEE ORDER CODE  
PACKING:  
  TUBE  
FOR COMPLETE SPECIFICATION, SEE COMPONENT  
SPECIFICATION C005XX (LATEST ISSUE)

ORDER CODE:  
**M80-509XXXX**

TOTAL No. OF CONTACTS  
04 TO 50,  
(EVEN NUMBERS ONLY)

FINISH  
05 - GOLD ALL OVER  
22 - GOLD CLIP, TIN/LEAD  
42 - GOLD CLIP, 100% TIN

TABLE 1: CONNECTOR DIMENSIONS			
PART No.	DIM A	DIM B	DIM C
M80-50904XX	2.00	9.00	14.0
M80-50906XX	4.00	11.00	16.0
M80-50908XX	6.00	13.00	18.0
M80-50910XX	8.00	15.00	20.0
M80-50912XX	10.00	17.00	22.0
M80-50914XX	12.00	19.00	24.0
M80-50920XX	18.00	25.00	30.0
M80-50926XX	24.00	31.00	36.0
M80-50934XX	32.00	39.00	44.0
M80-50942XX	40.00	47.00	52.0
M80-50950XX	48.00	55.00	60.0

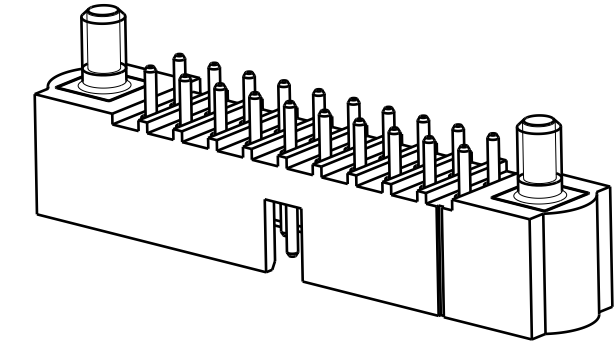
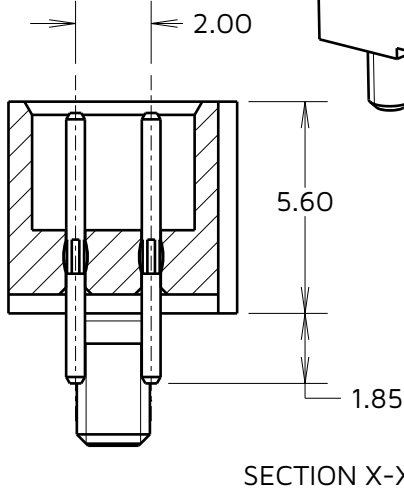
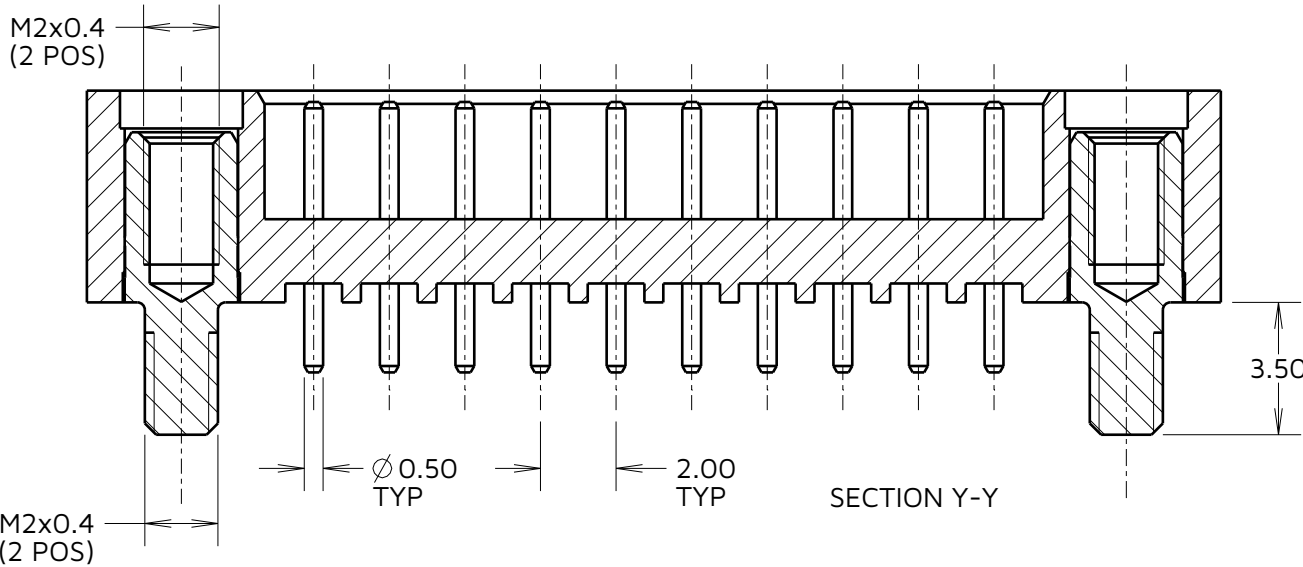
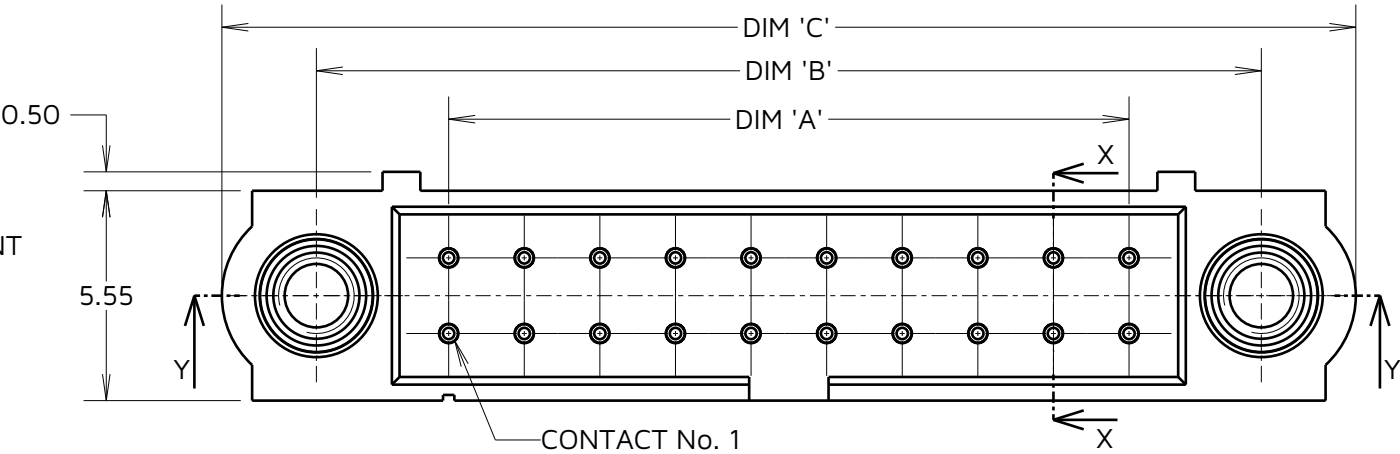

ASSEMBLY M80-50920XX SHOWN FOR ILLUSTRATION PURPOSES ONLY

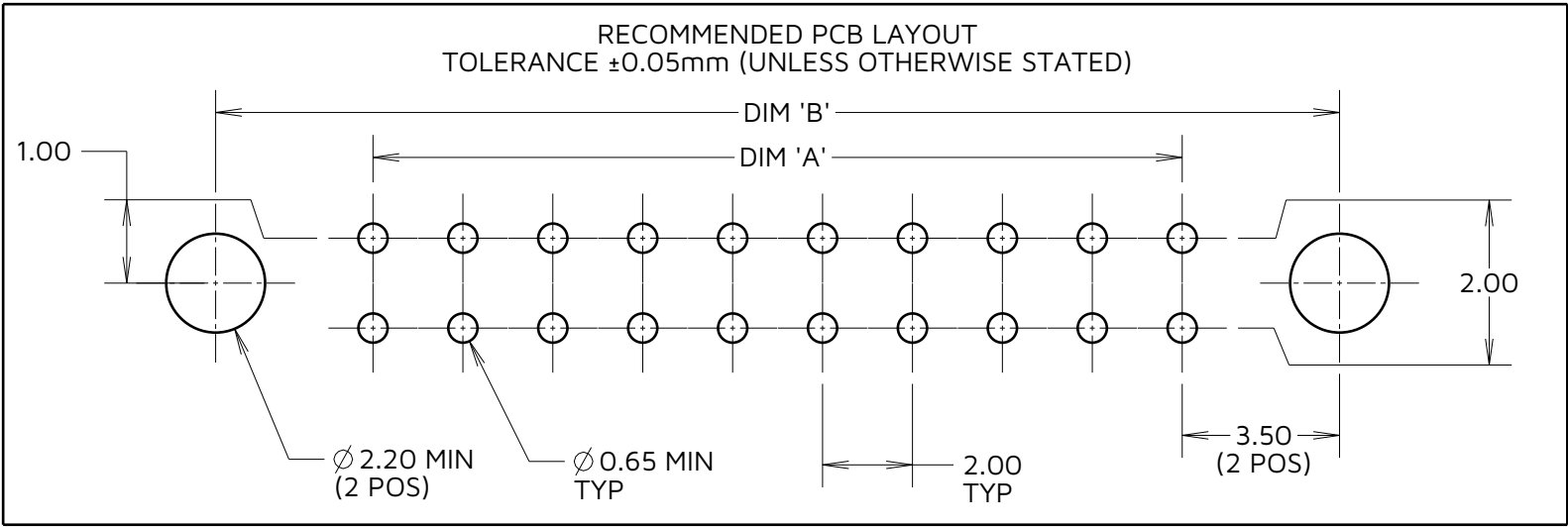
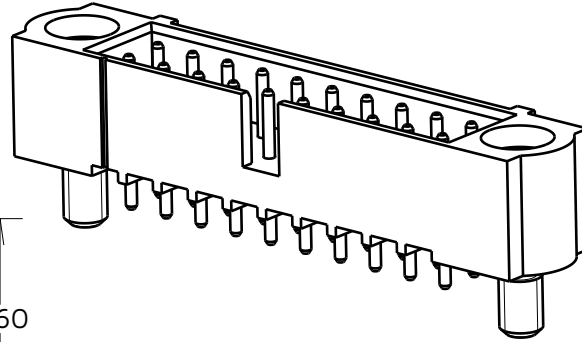

NOTES:  
1. BOARD MOUNT NUTS M80-2130000 TO BE ORDERED SEPARATELY  
2. ASSEMBLY M80-50920XX SHOWN FOR ILLUSTRATION PURPOSES ONLY

**HARWIN**

www.harwin.com

TOLERANCES  
X. =  $\pm 1\text{mm}$   
X.X =  $\pm 0.50\text{mm}$   
X.XX =  $\pm 0.20\text{mm}$   
X.XXX =  $\pm 0.01\text{mm}$   
ANGLES =  $\pm 5^\circ$   
UNLESS STATED

THIS DRAWING AND ANY INFORMATION OR DESCRIPTIVE MATTER SET OUT HEREON ARE CONFIDENTIAL AND COPYRIGHT PROPERTY OF THE HARWIN GROUP AND MUST NOT BE DISCLOSED, LOANED, COPIED OR USED FOR MANUFACTURING, TENDERING OR FOR ANY OTHER PURPOSE WITHOUT THEIR WRITTEN PERMISSION.

MATERIAL:  
  
SEE ABOVE

TITLE: DATAMATE J-TEK DIL  
VERT 2.0mm PC TAIL MALE ASSY  
WITH BOARD MOUNT  
DRAWING NUMBER: M80-509XXXX

AY	1	08.08.24	34637
NAME	ISS.	DATE	CN/CO
APPROVED: A.YEOMANS			
CHECKED: A.BOXALL			
DRAWN: A.YEOMANS			

# Mouser Electronics

Authorized Distributor

Click to View Pricing, Inventory, Delivery & Lifecycle Information:

[Harwin:](#)

[M80-5092042](#) [M80-5094242](#) [M80-5095042](#) [M80-5091442](#) [M80-5092642](#) [M80-5090642](#) [M80-5093442](#) [M80-5091242](#) [M80-5090842](#) [M80-5090442](#) [M80-5091042](#)