

Customer Information Sheet

IF IN DOUBT - ASK

©

NOT TO SCALE

THIRD ANGLE PROJECTION

ALL DIMENSIONS IN mm

SPECIFICATIONS:
MATERIAL:
MOULDING = GLASS-FILLED PPS, UL94V-0, BLACK
CONTACT CLIP = BERYLLIUM COPPER
CONTACT SHELL = BRASS
JACKSCREW, CIRCLIP = STAINLESS STEEL
FINISH (CONTACTS):
SEE ORDER CODE
FOR COMPLETE SPECIFICATION, SEE COMPONENT
SPECIFICATION C005XX (LATEST ISSUE)

ORDER CODE:
M80-403XXXX
TOTAL No. OF CONTACTS
04 TO 50
(EVEN NUMBERS ONLY)

FINISH
01 - GOLD CLIP, TIN/LEAD SHELL
05 - GOLD CLIP, GOLD SHELL
42 - GOLD CLIP, 100% TIN SHELL

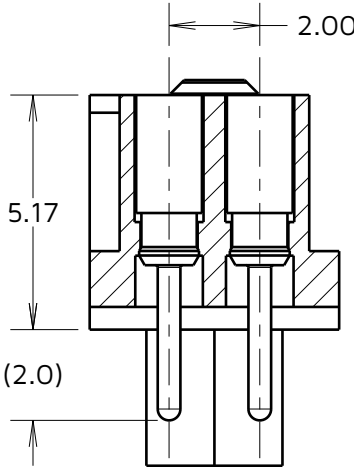
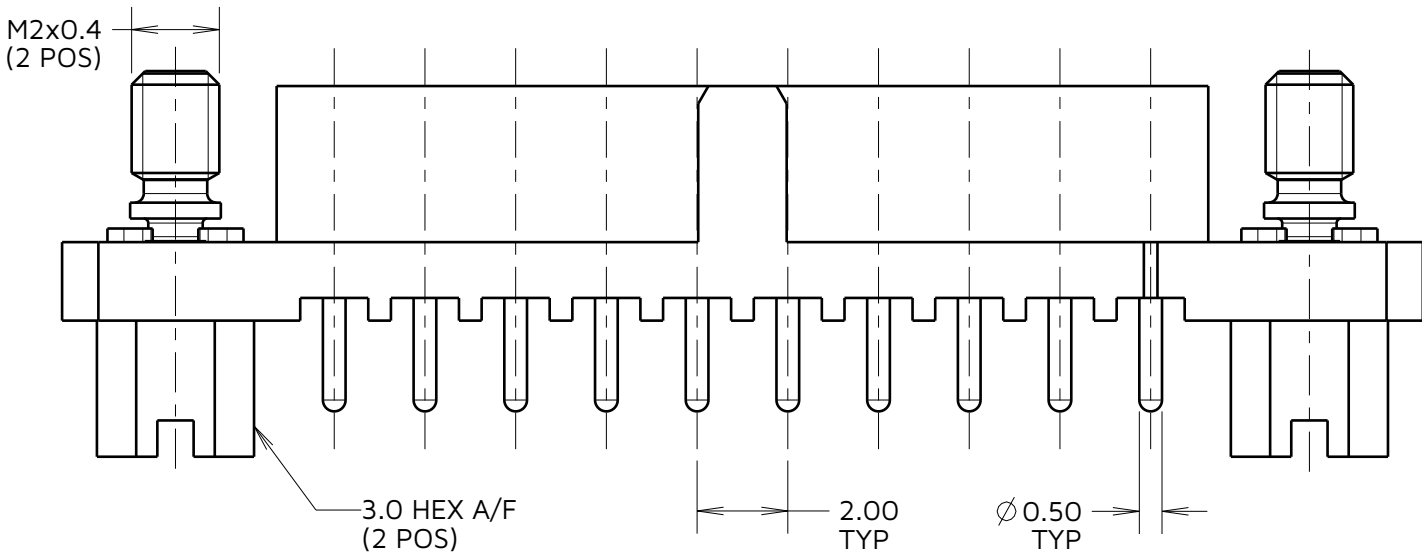
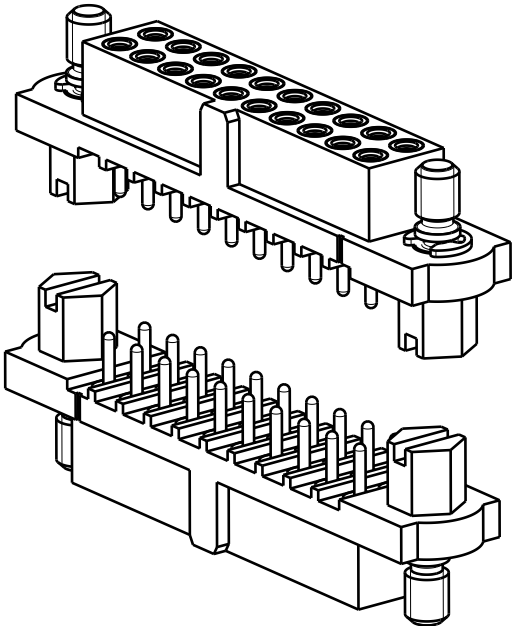
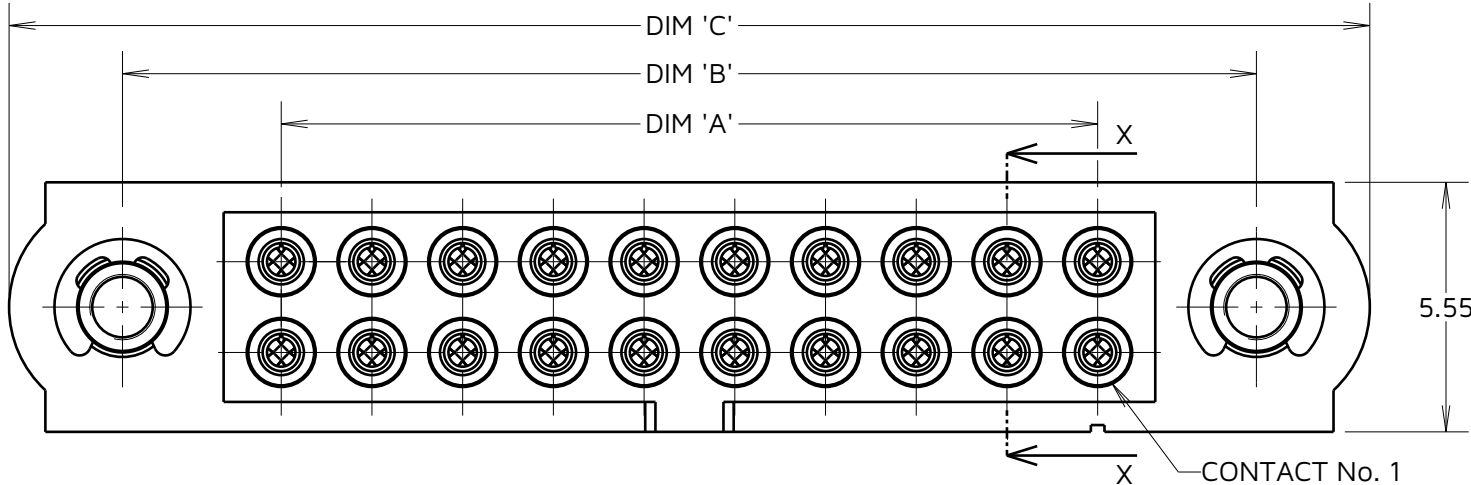

SECTION X-X

RECOMMENDED PCB LAYOUT
ALL TOLERANCES ± 0.05 (UNLESS OTHERWISE STATED)

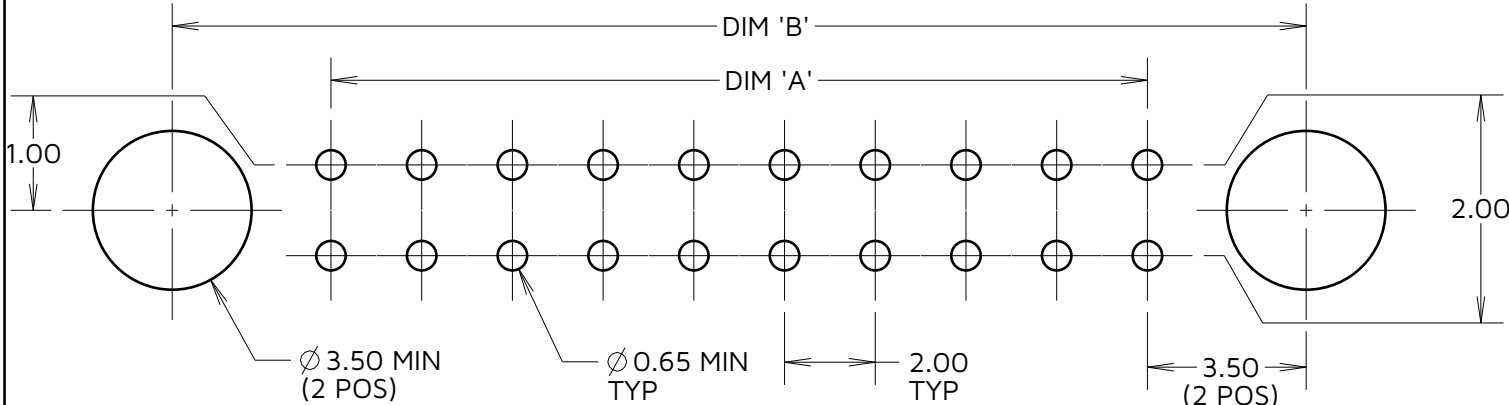

TABLE 1: CONNECTOR DIMENSIONS			
PART No.	DIM A	DIM B	DIM C
M80-40308XX	6.00	13.00	18.0
M80-40310XX	8.00	15.00	20.0
M80-40312XX	10.00	17.00	22.0
M80-40314XX	12.00	19.00	24.0
M80-40320XX	18.00	25.00	30.0
M80-40326XX	24.00	31.00	36.0
M80-40334XX	32.00	39.00	44.0
M80-40342XX	40.00	47.00	52.0

HARWIN

www.harwin.com

TOLERANCES
X. = $\pm 1\text{mm}$
X.X = $\pm 0.50\text{mm}$
X.XX = $\pm 0.20\text{mm}$
X.XXX = $\pm 0.01\text{mm}$
ANGLES = $\pm 5^\circ$
UNLESS STATED

THIS DRAWING AND ANY
INFORMATION OR DESCRIPTIVE
MATTER SET OUT HEREON ARE
CONFIDENTIAL AND COPYRIGHT
PROPERTY OF THE HARWIN GROUP
AND MUST NOT BE DISCLOSED,
LOANED, COPIED OR USED FOR
MANUFACTURING, TENDERING OR FOR
ANY OTHER PURPOSE WITHOUT THEIR
WRITTEN PERMISSION.

MATERIAL:

SEE ABOVE

TITLE: JACKSCREW DATAMATE
DIL VERTICAL PC TAIL
FEMALE ASSEMBLY

DRAWING NUMBER:
M80-403XXXX

SHT
2
OF
2

AY	1	23.08.24	34637
NAME	ISS.	DATE	CN/CO
APPROVED: A.YEOMANS			
CHECKED: A.BOXALL			
DRAWN: A.YEOMANS			

Mouser Electronics

Authorized Distributor

Click to View Pricing, Inventory, Delivery & Lifecycle Information:

[Harwin:](#)

[M80-4030842](#) [M80-4031042](#) [M80-4033442](#) [M80-4031242](#) [M80-4034242](#) [M80-4031442](#) [M80-4032042](#) [M80-4032642](#) [M80-4032005](#)