

Compact Outer Rotor BLDC Motor

BLIM5C01CH3

Minebea

Features

- 3-phase 12-pole outer rotor DC brushless motor
- Standard outer diameter of shaft is $\Phi 3$
- Built-in driver circuit
- Oil-retaining sleeve bearing

ST-Curve

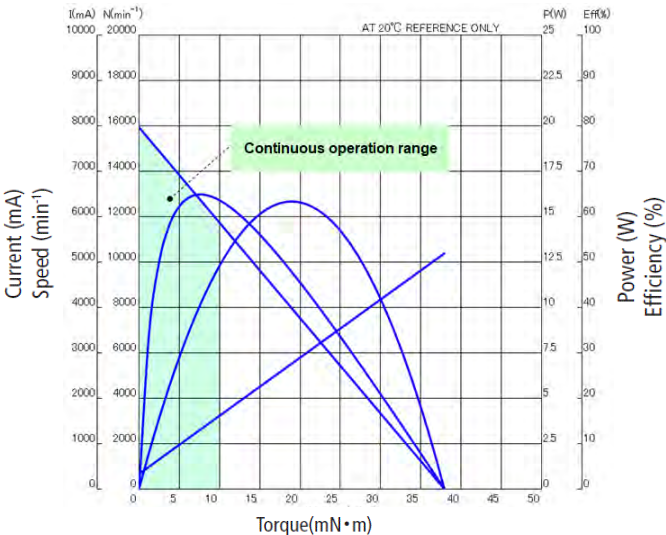

Specifications (at 12V)

Characteristic	Value
No Load Speed	16000min ⁻¹
Max. Efficiency	65% (at 8mN·m)
Speed at Max. Efficiency	13500min ⁻¹
Max. Output Power	13W (at 8mN·m)
Speed at Max. Output Power	12000min ⁻¹
Life at 50°C	2000 hours

Dimensions

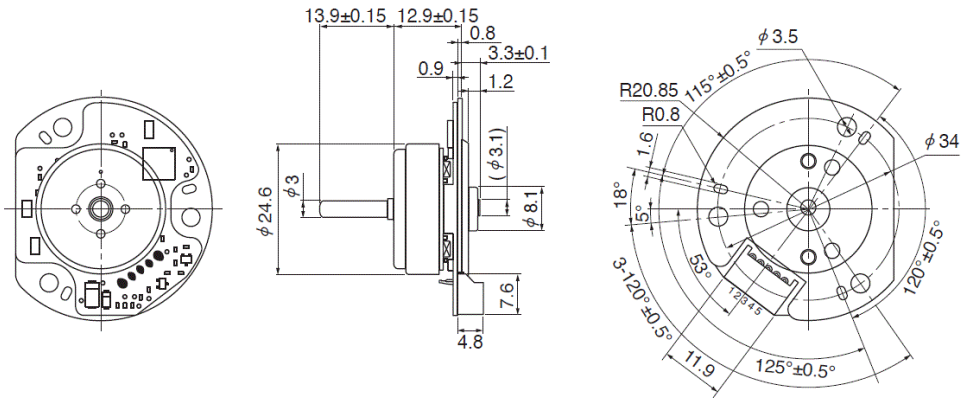

Connector Type

Pin No.	Signal
1	FG
2	PWM
3	GND
4	12VDC

*J.S.T. S4B-PH-ZR or JCTC
12001W90-4P

Mouser Electronics

Authorized Distributor

Click to View Pricing, Inventory, Delivery & Lifecycle Information:

[Minebea:](#)

[BML5C01CH3](#)