

ETI SYSTEMS High Precision Single Turn Potentiometers

RoHS Compliant This product is RoHS compliant.

SP22E / SW22E SERIES

SP22E Series: Conductive Plastic

- Life Expectancy: 10 million turns
- Resistance Tolerance: ±15% standard (±10% available)
- Linearity Tolerance: ±1.5% standard (±1% available)
- Operating temp.: -55°C to +125°C (105°C sustained)
- Power Rating: 1 Watt
- Electrical Angle: 320° ± 5°
- Mechanical Angle: 320° ± 5°

For quantities greater than listed, call for quote.

MOUSER STOCK NO.	ETI Systems Part No.	Fig.	Ohms	Price Each		
				1	5	10
882-SP22E-1K	SP22E-1K	A	1K	19.23	17.60	15.35
882-SP22E-2K	SP22E-2K	A	2K	19.23	17.60	15.35
882-SP22E-5K	SP22E-5K	A	5K	19.23	17.60	15.35
882-SP22E-10K	SP22E-10K	A	10K	19.23	17.60	15.35

SW22E Series: Wirewound

- Life Expectancy: 500,000 turns
- Resistance Tolerance: ±3% standard (±1.0% available)
- Linearity Tolerance: ±0.5% standard (±0.25% available)
- Power Rating: 0.5 Watt

For quantities greater than listed, call for quote.

MOUSER STOCK NO.	ETI Systems Part No.	Fig.	Ohms	Price Each		
				1	5	10
882-SW22E-1K	SW22E-1K	A	1K	34.31	30.50	25.89
882-SW22E-5K	SW22E-5K	A	5K	34.31	30.50	25.89
882-SW22E-10K	SW22E-10K	A	10K	34.31	30.50	25.89

SP22G / SP22GS SERIES

- Conductive Plastic Element, Solderable Double Turret Terminals
- Operating Temperature: -55°C to +125°C (105°C sustained)
- Resistance Tolerance: ±10% standard (±5% available)
- Linearity: ±1.0% standard (up to ±0.25% available)
- Life Expectancy: 10 million turns
- Power Rating: 1 Watt
- Electrical Angle: 340° ± 5°
- Mechanical Angle: 360°

SP22G Series: Conductive Plastic

- Brass Bushing, 1/4" Dia. Stainless Steel Shaft

For quantities greater than listed, call for quote.

MOUSER STOCK NO.	ETI Systems Part No.	Fig.	Ohms	Price Each		
				1	5	10
882-SP22G-1K	SP22G-1K	B	1K	20.39	18.68	16.28
882-SP22G-2K	SP22G-2K	B	2K	21.65	19.82	17.30
882-SP22G-5K	SP22G-5K	B	5K	20.39	18.68	16.28
882-SP22G-10K	SP22G-10K	B	10K	20.39	18.68	16.28

SP22GS Series: Servo Mount, Conductive Plastic

- 1/8" Dia. Stainless Steel Shaft, Ball Bearing

For quantities greater than listed, call for quote.

MOUSER STOCK NO.	ETI Systems Part No.	Fig.	Ohms	Price Each		
				1	5	10
882-SP22GS-1K	SP22GS-1K	C	1K	57.20	51.47	45.75
882-SP22GS-5K	SP22GS-5K	C	5K	57.20	51.47	45.75
882-SP22GS-10K	SP22GS-10K	C	10K	57.20	51.47	45.75

PRECISION TURN COUNTING DIALS / POT COMBINATIONS

DW22 Series: Digital

- Uses ETI Systems Potentiometer MW22B
- Resistance Range: 100 to 100KΩ
- Resistance Tolerance: ±5% standard
- Linearity Tolerance: ±0.25% standard
- Power Rating: 2 Watts
- Counts 10 turns (000 to 999 counts)
- Over the Center Lock
- Diameter -1 1/16", Extension from Panel -1.24"
- Operating Temperature: -30°C to +85°C

For quantities greater than listed, call for quote.

MOUSER STOCK NO.	ETI Systems Part No.	Fig.	Ohms	Price Each		
				1	5	10
882-DW22-10-100	DW22-10-100	D	100	96.04	88.25	80.51
882-DW22-10-1K	DW22-10-1K	D	1K	96.04	88.25	80.51
882-DW22-10-2K	DW22-10-2K	D	2K	96.04	88.25	80.51
882-DW22-10-5K	DW22-10-5K	D	5K	96.04	88.25	80.51
882-DW22-10-10K	DW22-10-10K	D	10K	92.27	84.78	77.35

DC22 Series: With Lock

- Resistance Tolerance: ±5%
- Power Rating: 2 Watts
- Operating Temperature: -30°C to +85°C
- Temp Coefficient: ±20ppm/°C
- Counts up to 10 turns (000-999)

For quantities greater than listed, call for quote.

MOUSER STOCK NO.	ETI Systems Part No.	Fig.	Ohms	Price Each		
				1	5	10
882-DC22-10-1K	DC22-10-1K	E	1K	72.18	66.32	60.51
882-DC22-10-2K	DC22-10-2K	E	2K	72.18	66.32	60.51
882-DC22-10-5K	DC22-10-5K	E	5K	72.18	66.32	60.51
882-DC22-10-10K	DC22-10-10K	E	10K	72.18	66.32	60.51

CONCENTRIC TURN COUNTING DIALS

MF46 Series: Counts 20 Turns

- 100 Dial Gradations for Exceptional Setability
- Aluminum Housing, Black Nylon Knob
- Over the Center Lock Available
- Diameter -1 13/16", Extension from Panel -1"

For quantities greater than listed, call for quote.

MOUSER STOCK NO.	ETI Systems Part No.	Fig.	Ohms	Price Each		
				1	5	10
882-MF46L-1/4	MF46L-1/4	F	Satin	64.58	53.79	49.79

MG Series: Counts 20 Turns

- One Piece Mounting
- Over the Center Lock Available
- Diameter -7/8", Extension from Panel -1.0"
- Maximum Panel Thickness -1/4"

For quantities greater than listed, call for quote.

MOUSER STOCK NO.	ETI Systems Part No.	Fig.	Ohms	Price Each		
				1	5	10
882-MGA22L-1/4	MGA22L-1/4	G	Black	28.62	24.56	22.20
882-MG22L-1/4	MG22L-1/4	G	Satin	26.92	23.11	20.88

MB Series: Counts 10 Turns

- Over the Center Lock Available
- Diameter -1", Extension from Panel -1.06"
- Panel Thickness -1/16" to 1/8"

For quantities greater than listed, call for quote.

MOUSER STOCK NO.	ETI Systems Part No.	Fig.	Ohms	Price Each		
				1	5	10
882-MB25L-1/4	MB25L-1/4	H	Satin	40.43	36.50	33.71
882-MBA25L-1/4	MBA25L-1/4	H	Black	44.12	39.84	36.78

DB Series: Counts 10 Turns

- Counts up to 10 turns (000-999)
- Over the Center Lock Standard
- Height -1 3/4", Width -1", Extension from Panel -1"

For quantities greater than listed, call for quote.

MOUSER STOCK NO.	ETI Systems Part No.	Fig.	Ohms	Price Each
882-DB10SL-1/4	DB10SL-1/4	I	Satin	95.51 85.96 78.04

DIMENSIONS: in.

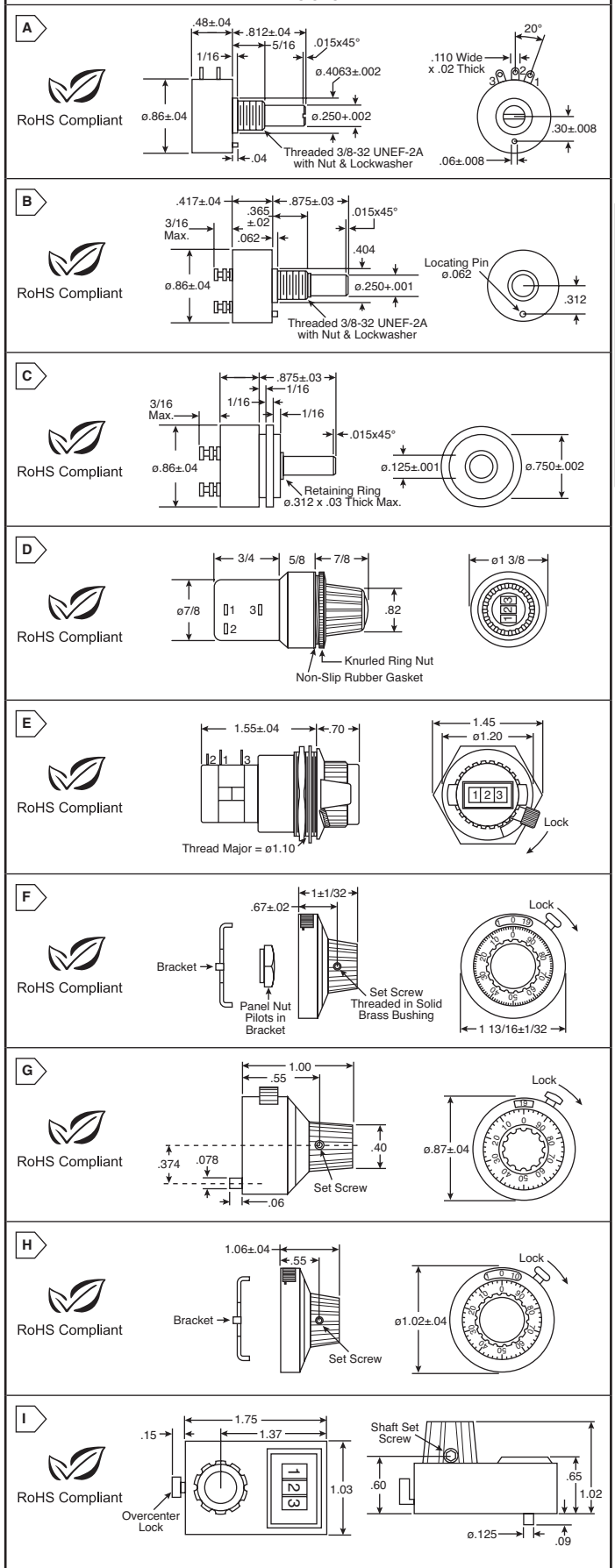

Precision Pots

ETI Systems