

LITTELFUSE Greentube™ Gas Plasma Arresters

(High Performance Beta Range)

RoHS Compliant This product is RoHS compliant.

LITTELFUSE SG SERIES

Features:

- RoHS Compliant
- GHz working frequency
- Excellent stability on multiple pulse duty cycle
- Excellent response to fast rising transients

- Ultra low insertion loss
- 1-2KA surge capability tested with 8/20µs pulse
- Low capacitance
- UL recognized

DIMENSIONS: mm



2 Electrode GDT Graphical Symbol

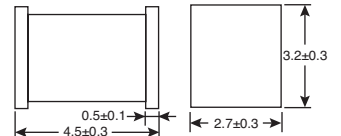

For quantities greater than listed, call for quote.

MOUSER STOCK NO.	Littelfuse Part No.	Type	DC Voltage (V)	DC Breakover Voltage Min-Max @ 100V/sec (V)	Max Dynamic Breakover Voltage @100µs (V)	Alternating Discharge Current (A)	Max Repetitive Impulse Discharge Current (kA)	Capacitance (pF)	DC Holdover Voltage (V)	Price Each			
										1	10	100	250
576-SG75	SG75	4.5x3.2x2.7mm	75	52-98	500	2	2	1	135	1.48	1.36	1.11	.96
576-SG90	SG90	4.5x3.2x2.7mm	90	63-117	500	2	2	1	135	1.48	1.36	1.11	.96
576-SG150	SG150	4.5x3.2x2.7mm	150	105-195	500	2	2	1	135	1.48	1.36	1.11	.96
576-SG230	SG230	4.5x3.2x2.7mm	230	172-288	650	2	1	1	135	1.48	1.36	1.11	.96
576-SG300	SG300	4.5x3.2x2.7mm	300	225-375	700	2	1	1	135	1.48	1.36	1.11	.96
576-SG300Q	SG300Q	4.5x3.2x2.7mm	300	210-390	580	-	1	1	135	1.48	1.36	1.11	.96
576-SG350	SG350	4.5x3.2x2.7mm	350	263-437	750	2	1	0.8	135	1.48	1.36	1.11	.96
576-SG350Q	SG350Q	4.5x3.2x2.7mm	350	263-437	600	-	1	0.8	135	1.48	1.36	1.11	.96
576-SG400	SG400	4.5x3.2x2.7mm	400	300-500	800	2	1	0.8	135	1.48	1.36	1.11	.96
576-SG420	SG420	4.5x3.2x2.7mm	420	315-525	800	2	1	1	135	1.48	1.36	1.11	.96
576-SG420Q	SG420Q	4.5x3.2x2.7mm	420	315-525	650	-	1	1	135	1.48	1.36	1.11	.96

LITTELFUSE SL1002 SURFACE MOUNT SERIES

Features:

- RoHS compliant
- Ultra Low Insertion Loss
- Surface mountable
- 5KA surge capability tested with 8/20µs pulse as defined by IEC 61000-4-5
- Excellent response to fast rising transients
- Can be used to meet Telcordia GR1089 without series resistance
- 10/700 6KV capability, as per ITUT K.21, enhanced test level
- 2000 Amp 2/10µs surge rating
- Meets FCC part 68 10/160µs waveform, 200A test and 10/560µs waveform 100A test

Mechanical Specifications:

- Weight: 0.63g (0.022 oz.)
- Materials: Electrode Base: Nickel Iron Alloy
- Electrode Plating: Bright Sn
- Body: Ceramic
- Device Marking: 'LF' logo, Voltage and date code

Applications:

- Broadband equipment
- ADSL equipment
- XDSL equipment
- Satellite and CATV equipment
- General telecom equipment



2 Electrode GDT Graphical Symbol

DIMENSIONS: mm

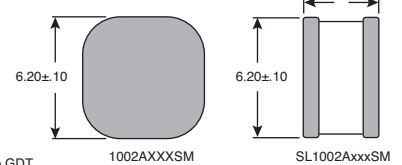

For quantities greater than listed, call for quote.

MOUSER STOCK NO.	DC Voltage @ 100V/sec (V)	Max Dynamic Breakover Voltage @ 100V/µs (Vbr)	Max Dynamic Breakover Voltage @ 1kV/µs (Vbr)	Max Repetitive Impulse Discharge Current (kA)	Max Single Impulse Discharge Current (A)	Max Leakage Current (nA)	Max Capacitance (pF)	Holdover Voltage (V)	Nominal On-State Voltage @ 1A	Price Each			
										1	10	100	250
576-SL1002A090SM	90	360	700	5	5	100	1.2	50	20	1.13	1.06	1.01	.85
576-SL1002A230SM	230	400	500	5	2	100	1.2	135	20	1.13	1.06	1.01	.85
576-SL1002A350SM	350	500	600	5	2	100	1.2	135	20	1.13	1.06	1.01	.85
576-SL1002A600SM	600	800	900	5	2	100	1.2	135	20	1.13	1.06	1.01	.85

LITTELFUSE SL1003 SERIES

Features:

- RoHS compliant
- Low insertion loss
- Surface mountable
- 5KA surge capability tested with 8/20µs pulse as defined by IEC 61000-4-5
- GHz working frequency
- Excellent response to fast rising transients

- Can be used to meet Telcordia GR1089 without series resistance
- 10/700 6KV capability, as per ITUT K.21, enhanced test level
- 2000 Amp 2/10µs surge rating

Applications:

- Broadband equipment
- ADSL equipment
- XDSL equipment
- Satellite and CATV equipment
- General telecom equipment



3 Electrode GDT Graphical Symbol

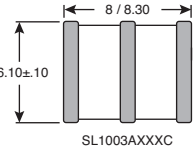

For quantities greater than listed, call for quote.

MOUSER STOCK NO.	Type	DC Voltage @ 100V/sec (V)	Max Dynamic Breakover Voltage @ 100V/µs (Vbr)	Max Dynamic Breakover Voltage @ 1kV/µs (Vbr)	Max Repetitive Impulse Discharge Current (kA)	Insulation Resistance (Ω)	Alternating Discharge Current (A)	Max Capacitance (pF)	Holdover Voltage (V)	Nominal On-State Voltage @ 1A (V)	Price Each			
											1	10	100	250
576-SL1003A090C	Core	90	600	700	5	1x109 @50V	5	1.2	50	20	3.69	3.54	3.36	3.15
576-SL1003A090R	Radial	90	600	700	5	1x109 @50V	5	1.2	50	20	1.79	1.73	1.61	1.52
576-SL1003A090SM	SMD	90	600	700	5	1x109 @50V	5	1.2	50	20	3.45	3.28	3.11	2.95
576-SL1003A230C	Core	230	350	500	5	1x109 @100V	5	1.2	135	20	3.69	3.54	3.36	3.19
576-SL1003A230R	Radial	230	350	500	5	1x109 @100V	5	1.2	135	20	1.79	1.73	1.61	1.52
576-SL1003A230SM	SMD	230	350	500	5	1x109 @100V	5	1.2	135	20	3.45	3.28	3.11	2.95
576-SL1003A350C	Core	350	500	700	5	1x109 @100V	5	1.2	135	20	3.69	3.54	3.36	3.15
576-SL1003A350SM	SMD	350	500	700	5	1x109 @100V	5	1.2	135	20	3.45	3.28	3.11	2.95
576-SL1003A400C	Core	400	550	800	5	1x109 @100V	5	1.2	135	20	3.69	3.54	3.36	3.15
576-SL1003A400R	Radial	400	550	800	5	1x109 @100V	5	1.2	135	20	1.79	1.73	1.61	1.52
576-SL1003A400SM	SMD	400	550	800	5	1x109 @100V	5	1.2	135	20	3.45	3.28	3.11	2.95

LITTELFUSE SL0902A SURFACE MOUNT SERIES - BROADBAND OPTIMIZED™

Features:

- 2.5KA surge capability tested with 8/20µs pulse as defined by IEC 100-4-5
- Excellent stability on multiple pulse duty cycle
- Excellent response to fast rising transients
- Surface mountable
- GHz working frequency

Applications:

- Broadband equipment
- ADSL equipment, incl. ADSL+
- XDSL equipment
- Satellite and CATV equipment
- General telecom equipment

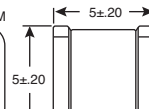

DIMENSIONS: mm

Typical capacitance (pF) measured at bias voltages of 0 to 35 vs

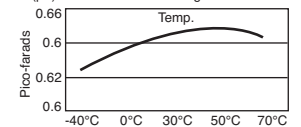

For quantities greater than listed, call for quote.

MOUSER STOCK NO.	Holdover Voltage (V)	DC Breakover Voltage @2kV/sec (V)	Max Dynamic Breakover Voltage @100µs (V)	Max Dynamic Breakover Voltage @1kV/µs (V)	Alternating Discharge Current (A)	Impulse Discharge Current (kA)	Insulation Resistance (Ω)	Max Capacitance (pF)	Price Each			
									1	10	100	250
576-SL0902A090SM	50	72-108	400	600	2.5	2.5	1000M	1.5	2.12	1.97	1.79	1.48
576-SL0902A230SM	135	184-276	400	500	2.5	2.5	1000M	1.5	2.12	1.97	1.79	1.48
576-SL0902A420SM	135	350-504	675	800	2.5	2.5	1000M	1.5	2.12	1.97	1.79	1.48