

LITTELFUSE Teccor® Thyristors

RoHS Compliant This product is RoHS compliant.



Thyristors

Littelfuse

SCRs

MOUSER STOCK NO.	Littelfuse Part No.	Pkg.	IT(RMS)	VDRM	IDRM@VDRM (mA)		Max Gate Trigger Current (µA)	VTM (V)	Non-Repetitive Surge Current (A)	di/dt @110°C (A/µs)	TGT (µs)	Tq (µs)	Price Each		
					@25°C	@125°C							1	10	100
576-S6008R	S6008R	TO-220	8	600	0.01	0.5	15000	1.6	100	100	2	35	1.67	1.35	1.12
576-S6008L	S6008L	TO-220	8	600	0.01	0.5	15000	1.6	100	100	2	35	1.36	1.28	1.13
576-S6015L	S6015L	TO-220	15	600	0.01	1	30000	1.6	225	125	2	35	1.90	1.80	1.38
576-S6025L	S6025L	TO-220	25	600	0.01	2	35000	1.6	350	150	2	35	2.16	2.02	1.79
576-S6055R	S6055R	TO-220	55	600	0.01	2	40000	1.8	650	175	2.5	35	4.00	3.47	3.03
576-S8040R	S8040R	TO-220	40	800	0.02	3	40000	1.8	520	175	2.5	35	3.52	3.29	2.91
576-S8055R	S8055R	TO-220	55	800	0.02	3	40000	1.8	650	175	2.5	35	3.28	3.18	2.70
576-S601E	S601E	TO-92	1	600	0.01	0.5	10000	1.6	30	50	2	35	.89	.78	.67
576-S6006L	S6006L	TP-92	6	600	0.01	0.5	15000	1.6	100	100	2	35	1.55	1.36	1.11
576-S6010L	S6010L	TO-220	10	600	0.01	0.5	15000	1.6	100	100	2	35	1.54	1.46	1.39
576-S8010L	S8010L	TO-220	10	800	0.02	1	15000	1.6	100	100	2	35	1.90	1.80	1.38
576-S6020L	S6020L	TO-220	20	600	0.01	1	30000	1.6	300	125	2	35	1.85	1.73	1.53
576-S8020L	S8020L	TO-220	20	800	0.02	2	30000	1.6	300	125	2	35	1.96	1.83	1.62
576-S8035K	S8035K	TO-218	35	800	0.02	3	40000	1.8	500	150	2	35	4.02	3.95	3.90
576-S8015L	S8015L	TO-220	15	800	0.02	2	30000	1.6	225	125	2	35	1.73	1.62	1.44

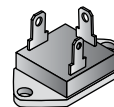

TO-3

TRIACS

◆ Surface Mount

MOUSER STOCK NO.	Pkg.	IT (RMS)	VDRM	IGT (mA)				IDRM Max. (mA)			VTM (V)	VGT (V)	Watts	Price Each			
				Max.	Typ.	Q1	Q2	Q3	Q4	TC=25°C				TC=100°C	TC=125°C	PGM	PG(AV)
576-Q401E3	TO-92	1	400	10	10	10	25	0.02	0.5	1	1.6	2	10	0.2	1.00	.88	.77
◆ 576-Q4004D3RP	TO-252	4	400	10	10	10	25	0.05	0.5	2	1.6	2	15	0.3	1.36	1.15	1.00
576-Q4004L3	TO-220	4	400	10	10	10	25	0.05	0.5	2	1.6	2	15	0.3	1.35	1.31	1.11
576-Q4004L4	TO-220	4	400	25	25	25	50	0.05	0.5	2	1.6	2.5	15	0.3	1.40	1.27	1.08
576-Q6004L4	TO-220	4	600	25	25	25	50	0.05	0.5	2	1.6	2.5	15	0.3	1.52	1.47	1.25
576-Q4006L4	TO-220	6	400	25	25	25	50	0.05	0.5	2	1.6	2.5	18	0.5	1.47	1.42	1.20
576-Q6006L5	TO-220	6	600	50	50	50	75	0.05	0.5	2	1.6	2.5	18	0.5	1.67	1.62	1.37
576-Q6006R5	TO-220	6	600	50	50	50	75	0.05	0.5	2	1.6	2.5	18	0.5	1.52	1.47	1.25
576-Q4008L4	TO-220	8	400	25	25	25	50	0.05	0.5	2	1.6	2.5	20	0.5	1.87	1.70	1.43
576-Q4008R4	TO-220	8	400	25	25	25	50	0.05	0.5	2	1.6	2.5	20	0.5	1.47	1.42	1.20
576-Q6008L5	TO-220	8	600	50	50	50	75	0.05	0.5	2	1.6	2.5	20	0.5	2.05	1.73	1.46
576-Q6008R5	TO-220	8	600	50	50	50	75	0.05	0.5	2	1.6	2.5	20	0.5	1.88	1.70	1.45
576-Q4010L5	TO-220	10	400	50	50	50	75	0.05	0.5	2	1.6	2.5	20	0.5	1.85	1.77	1.50
576-Q4010R5	TO-220	10	400	50	50	50	75	0.05	0.5	2	1.6	2.5	20	0.5	1.87	1.70	1.43
576-Q6010L5	TO-220	10	600	50	50	50	75	0.05	0.5	2	1.6	2.5	20	0.5	2.18	2.00	1.79
576-Q6010R5	TO-220	10	600	50	50	50	75	0.05	0.5	2	1.6	2.5	20	0.5	1.90	1.84	1.55
576-Q8010L5	TO-220	10	800	50	50	50	75	0.1	0.5	2	1.6	2.5	20	0.5	2.38	2.31	1.95
576-Q4015L5	TO-220	15	400	50	50	50	-	0.05	0.5	2	1.6	2.5	20	0.5	2.36	2.11	2.00
576-Q4015R5	TO-220	15	400	50	50	50	-	0.05	0.5	2	1.6	2.5	20	0.5	2.07	1.90	1.65
576-Q6015L5	TO-220	15	600	50	50	50	-	0.05	0.5	2	1.6	2.5	20	0.5	2.68	2.55	2.20
576-Q6015R5	TO-220	15	600	50	50	50	-	0.05	0.5	2	1.6	2.5	20	0.5	2.62	2.40	2.09
576-Q8015L5	TO-220	15	800	50	50	50	-	0.1	1	3	1.8	2.5	20	0.5	2.87	2.78	2.35
◆ 576-Q4025N5RP	TO-263	25	400	50	50	50	-	0.1	1	3	1.8	2.5	20	0.5	3.20	2.67	2.26
576-Q4025R5	TO-220	25	400	50	50	50	-	0.1	1	3	1.8	2.5	20	0.5	2.68	2.55	2.20
◆ 576-Q4025R5	TO-263	25	600	50	50	50	-	0.1	1	3	1.8	2.5	20	0.5	2.68	2.55	2.20
576-Q6025P5	TO-3	25	600	50	50	50	-	0.1	0	5	1.4	0.2	20	0.5	9.92	9.62	8.13
576-Q6025R5	TO-220	25	600	50	50	50	-	0.1	1	3	1.8	2.5	20	0.5	3.00	2.84	2.40
576-Q6035P5	TO-3	35	600	50	50	50	120	0.1	5	3	1.5	2.75	20	0.5	12.06	11.70	9.89

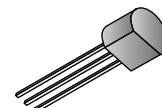

TO-92

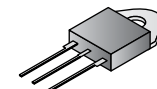

TO-218

ALTERNISTOR TRIACS

MOUSER STOCK NO.	Pkg.	IT (RMS)	VDRM	IGT (mA) (Max.)				IDRM Max. (mA)			VTM (V)	VGT (V)	Watts	Price Each		
				Q1	Q2	Q3	Q4	TC=25°C	TC=100°C	TC=125°C				PGM	PG(AV)	1
576-Q4025K6	TO-218	25	400	80	80	80	80	0.05	0.5	2	1.8	2.5	20	0.5	5.16	4.93
576-Q6025K6	TO-218	25	600	80	80	80	80	0.05	0.5	2	1.8	2.5	20	0.5	5.04	4.79
576-Q6040K7	TO-218	40	600	100	100	100	100	0.2	2	5	1.8	2.5	40	0.8	8.71	8.06
576-Q6006LH4	TO-220	6	600	35	35	35	35	0.01	0.5	2	1.6	1.3	18	0.5	1.85	1.77
576-Q4012LH5	TO-220	12	400	50	50	50	50	0.01	0.5	2	1.6	1.3	20	0.5	2.11	1.96
576-Q8016LH4	TO-220	16	800	35	35	35	35	0.1	1	3	1.6	2	20	0.5	3.00	2.84
576-Q4025L6	TO-220	25	400	80	80	80	80	0.05	0.5	2	1.8	2.5	20	0.5	3.40	3.10
576-Q6025L6	TO-220	25	600	80	80	80	80	0.05	0.5	2	1.8	2.5	20	0.5	3.65	3.34
576-Q6025R6	TO-220	25	600	80	80	80	80	0.05	0.5	2	1.8	2.5	20	0.5	3.40	3.10
576-Q8025L6	TO-220	25	800	80	80	80	80	0.1	1	3	1.8	2.5	20	0.5	4.28	3.98
576-Q4030LH5	TO-220	30	400	50	50	50	50	0.05	0	2	1.4	2	20	0.5	3.65	3.34
576-Q4040J7	TO-218X	40	400	100	100	100	100	0.2	2	5	1.8	2.5	40	0.8	8.70	7.28

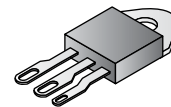

TO-218X

SENSITIVE TRIACS

MOUSER STOCK NO.	Pkg.	IT (RMS)	VDRM	IGT (mA) Max.				IDRM Max. (mA)			VTM (V)	VGT (V)	Watts	ITSM (Amps)	Price Each	
				Q1	Q2	Q3	Q4	TC=25°C	TC=110°C	(TC=25°C)					(TC=25°C)	PGM
576-L601E3	TO-92	1	600	3	3	3	3	0.01	0.1	1.6	2	10	0.2	20/16.7	1.35	1.15
576-L4004L3	TO-220	4	400	3	3	3	3	0.01	0.2	1.6	2	15	0.3	40/33	1.55	1.51
576-L6004L3	TO-220	4	600	3	3	3	3	0.01	0.2	1.6	2	15	0.3	40/33	1.98	1.88
576-L6008L6	TO-220	8	600	5	5	5	10	0.02	0.5	1.6	2	18	0.4	80/65	2.07	1.90

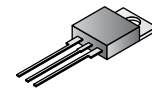

TO-92

QUADRACS

MOUSER STOCK NO.	Pkg.	IT (RMS)	VDRM	IDRM Max. (mA) (TC=X°C)			VTM (V)	ΔVBO (V)	VBO (V)	ΔV ±(V)	IBO (µA)	CT (µF)	ITSM (Amps)	Price Each		
				25°C	100°C	125°C								(TC=25°C)	(TC=25°C)	Min.
576-Q4004L4	TO-220	4	400	0.05	0.5	2	1.6	3	33	43	5	25	0.1	55/46	1.77	1.54
576-Q6004L4	TO-220	4	600	0.05	0.5	2	1.6	3	33	43	5	25	0.1	55/46	2.05	1.73
576-Q4006L4	TO-220	6	400	0.05	0.5	2	1.6	3	33	43	5	25	0.1	80/65	1.67	1.62
576-Q6006L4	TO-220	6	600	0.05	0.5	2	1.6	3	33	43	5	25	0.1	80/65	1.98	1.92
576-Q4006LTH	TO-220	6	400	0.05	0.5	2	1.6	3	33	43	5	25	0.1	80/65	1.56	1.50
576-Q4008L4	TO-220	8	400	0.05	0.5	2	1.6	3	33	43	5	25	0.1	100/83	1.98	1.76
576-Q6008L4	TO-220	8	600	0.05	0.5	2	1.6	3	33	43	5	25	0.1	100/83	2.15	2.09
576-Q4008LTH	TO-220	8	400	0.05	0.5	2	1.6	3	33	43	5	25	0.1	100/83	2.11	1.96
576-Q6008LTH	TO-220	8	600	0.05	0.5	2	1.6	3								