

LITTELFUSE SIDACTor®, Triacs, and SCRs



RoHS Compliant This product is RoHS compliant.

MICROCAPACITANCE (MC) SC SIDACTOR DEVICES

These DO-214AA SCMC SIDACTor devices are intended for applications sensitive to load values. Typically, high speed connections, such as xDSL and T1/E1, require a lower capacitance. CO values for the MicroCapacitance device are 40 percent lower than a standard SC part.

MOUSER STOCK NO.	Littelfuse Part No.	Package	Volts			Idrm Uamps	Is mAmps	It Amps	Ih mAmps	Price Each			Reel Qty.	Price Per Piece
			Vdrm	Vs	Vt					1	10	50		
576-P0080SCMCLRP	P0080SCMCLRP	DO-214AA	6	25	4	5	800	2.2	50	1.43	1.20	1.14	2500	.788
576-P0300SCMCLRP	P0300SCMCLRP	DO-214AA	25	40	4	5	800	2.2	50	1.43	1.20	1.14	2500	.788
576-P0640SCMCLRP	P0640SCMCLRP	DO-214AA	58	77	4	5	800	2.2	150	1.43	1.20	1.14	2500	.788
576-P0900SCMCLRP	P0900SCMCLRP	DO-214AA	75	98	4	5	800	2.2	150	1.13	1.01	.95	2500	.785
576-P1800SCMCLRP	P1800SCMCLRP	DO-214AA	170	220	4	5	800	2.2	150	1.43	1.20	1.14	2500	.788
576-P3100SCMCLRP	P3100SCMCLRP	DO-214AA	275	350	4	5	800	2.2	150	1.43	1.20	1.14	2500	.788

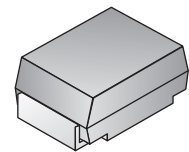

DO-214AA

HIGH SURGE CURRENT (D-RATED) SIDACTOR DEVICES

DO-214AA SIDACTor solid state protection devices with a D surge rating protect telecommunications equipment located in hostile environments. Surge ratings are twice that of a device with a C surge rating.

MOUSER STOCK NO.	Littelfuse Part No.	Package	Volts			Ih mAmps	Is mAmps	It Amps	Ih mAmps	Price Each			Reel Qty.	Price Per Piece
			Vdrm	Vs	Vt					1	10	50		
576-P0080SDLRP	P0080SDLRP	DO-214AA	6	25	4	5	800	2	50	1.06	1.00	.97	2500	.928
576-P0640SDLRP	P0640SDLRP	DO-214AA	58	77	4	5	800	2.2	50	1.06	1.00	.97	2500	.928
576-P0720SDLRP	P0720SDLRP	DO-214AA	65	88	4	5	800	2.2	50	1.10	1.08	1.06	2500	.942
576-P3100SDLRP	P3100SDLRP	DO-214AA	275	350	4	5	800	2.2	50	1.06	1.00	.97	2500	.928
576-P3500SDLRP	P3500SDLRP	DO-214AA	320	400	4	5	800	2.2	50	1.60	1.35	1.28	2500	.895

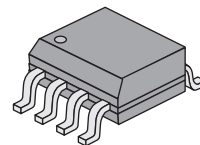

MS-012

SIDACTOR PROTECTION THYRISTORS - FIXED VOLTAGE ENHANCED SINGLE PORT SERIES

The MS-012 packaged fixed voltage enhanced single port series are SIDACTor devices designed to protect sensitive SLICs (subscriber line interface circuits) from damaging overvoltage transients.

- Single port protection in one package
- Does not degrade with use
- Low voltage overshoot
- Pin-to-pin SO-8 compatible footprint

MOUSER STOCK NO.	Littelfuse Part No.	Package	Volts		Ih mAmps	Is mAmps	It Amps	Price Each			Reel Qty.	Price Per Piece
			Vdrm	Vs				1	50	100		
576-P0641DF-1E	P0641DF-1E	MS-012	58	77	150	800	1	.84	.79	.76	2500	.69
576-P1701DF-1E	P1701DF-1E	MS-012	160	200	150	800	1	.86	.81	.767	2500	.641

SENSITIVE TRIACS

L01 EV Series, 1A

- Static dv/dt >20 Volts/μsec
- Blocking voltage capability: up to 800V
- Thru hole and surface mount packages
- Surge Capability: >10Amps

MOUSER STOCK NO.	Littelfuse Part No.	Package	Voltage (V)	I gt (mA)	V gt	IH Max	dv/dt (s)	dv/dt (c)	T gt μs	Price Each		
										1	10	100
576-L0103MTRP	L0103MTRP	TO-92	600	3-5	1.3	7	10	0.5	2	.33	.325	.275
576-L0103NERP	L0103NERP	TO-92	600	3-5	1.3	7	10	0.5	2	.37	.367	.319
576-L0103NTRP	L0103NTRP	SOT-223	800	3-5	1.3	7	10	0.5	2	.36	.35	.299
576-L0107MTRP	L0107MTRP	TO-92	800	3-5	1.3	7	10	0.5	2	.40	.395	.343
576-L0107MERP	L0107MERP	TO-92	600	5-7	1.3	10	20	1	2	.33	.325	.275
576-L0107MTRP	L0107MTRP	SOT-223	600	5-7	1.3	10	20	1	2	.37	.367	.319
576-L0109MTRP	L0109MTRP	TO-92	600	10	1.3	10	50	2	2	.33	.325	.275
576-L0109MERP	L0109MERP	TO-92	600	10	1.3	10	50	2	2	.37	.367	.319
576-L0109MTRP	L0109MTRP	SOT-223	600	10	1.3	10	50	2	2	.40	.395	.343

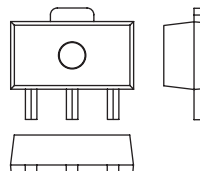

SOT-89

LX8 EV Series, 0.8A

- Blocking voltage capability: up to 600V
- Static dv/dt >10 Volts/μsec
- Surge Capability: >9.5Amps
- Thru hole and surface mount packages

MOUSER STOCK NO.	Littelfuse Part No.	Package	Voltage (V)	Gate Sensitivity	V gt	IH Max	dv/dt (s)	T q μs	T gt μs	Price Each		
										1	10	100
576-LX803MTRP	LX803MTRP	TO-92	600	3-5	1.3	5	10	1.5	2	.23	.22	.21
576-LX803MERP	LX803MERP	TO-92	600	3-5	1.3	5	10	1.5	2	.78	.63	.312
576-LX807DERP	LX807DERP	TO-92	400	5-7	1.3	5	10	1.5	2	.21	.20	.19
576-LX807DTRP	LX807DTRP	SOT-223	400	5-7	1.3	5	10	1.5	2	.25	.24	.23
576-LX807MERP	LX807MERP	TO-92	600	5-7	1.3	5	10	1.5	2	.23	.22	.21
576-LX807MTRP	LX807MTRP	SOT-223	600	5-7	1.3	5	10	1.5	2	.41	.36	.312

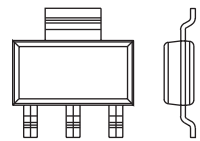

SOT-223

SENSITIVE SCRS

Sx02xS EV Series, 1.5A

- Blocking voltage capability: up to 600V
- High dv/dt noise immunity
- Thru hole and surface mount packages
- Surge Capability: >15Amps
- Improved turn-off time (Tq): <35μsec.
- ROHS compliant

MOUSER STOCK NO.	Littelfuse Part No.	Package	Voltage (V)	Gate Sensitivity	V gt	IH Max	dv/dt (s)	T q μs	T gt μs	Price Each		
										1	10	100
576-S402ESRP	S402ESRP	TO-92	400	200μa	0.8	5	25	35	3	.51	.44	.39
576-S602ESRP	S602ESRP	TO-92	600	200μa	0.8	5	25	35	3	.44	.41	.36
576-S602TSRP	S602TSRP	SOT-223	600	200μa	0.8	5	25	35	3	.70	.56	.48

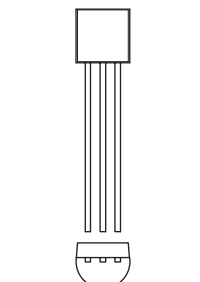

TO-92

Sx8xSx EV Series, 0.8A

- Blocking voltage capability: up to 800V
- High dv/dt noise immunity
- Thru hole and surface mount packages
- Surge Capability: >10Amps
- Sensitive gate or direct microprocessor interface
- ROHS compliant

MOUSER STOCK NO.	Littelfuse Part No.	Package	Voltage (V)	Gate Sensitivity	V gt	IH Max	dv/dt (s)	T q μs	T gt μs	Price Each		
										1	10	100
576-S6X8BSRP	S6X8BSRP	SOT-89	600	200μa	0.8	5	75	25	2	.51	.44	.39
576-S6X8ES1RP	S6X8ES1RP	TO-92	600	5μa	0.8	5	75	30	2	.29	.27	.24
576-S6X8ES2RP	S6X8ES2RP	TO-92	600	50μa	0.8	5	75	25	2	.29	.27	.24
576-S4X8ES	S4X8ES	TO-92	400	200μa	0.8	5	75	25	2	.21	.20	.19
576-S4X8ESAP	S4X8ESAP	TO-92	400	200μa	0.8	5	75	25	2	.21	.20	.19
576-S4X8ESRP	S4X8ESRP	TO-92	400	200μa	0.8	5	75	25	2	.21	.20	.19
576-S6X8ES	S6X8ES	TO-92	600	200μa	0.8	5	75	25	2	.29	.27	.24
576-S6X8TS1RP	S6X8TS1RP	SOT-223	600	5μa	0.8	5	75	30	2	.35	.32	.28
576-S6X8TS2RP	S6X8TS2RP	SOT-223	600	50μa	0.8	5	75	25	2	.35	.32	.28
576-S6X8TSRP	S6X8TSRP	SOT-223	600	200μa	0.8	5	75	25	2	.35	.32	.28
576-S8X8ES1RP	S8X8ES1RP	TO-92	800	5μa	0.8	5	75	30	2	.35	.32	.28
576-S8X8ES2RP	S8X8ES2RP	TO-92	800	50μa	0.8	5	75	25	2	.35	.32	.28
576-S8X8ESRP	S8X8ESRP	TO-92	800	200μa	0.8	5	75	25	2	.35	.32	.28
576-S8X8TS1RP	S8X8TS1RP	SOT-223	800	5μa	0.8	5	75	30	2	.51	.44	.39
576-S8X8TS2RP	S8X8TS2RP	SOT-223	800	50μa	0.8	5	75	25	2	.51	.44	.39
576-S8X8TSRP	S8X8TSRP	SOT-223	800	200μa	0.8	5	75	25	2	.51	.44	.39