

VISHAY Zener Diodes

Products may be RoHS compliant.
Check mouser.com for RoHS status.

Diodes & Rectifiers

Vishay Semiconductors

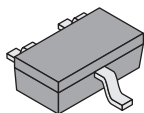

SOT-23-3

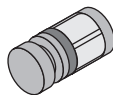

MELF/SOD-80C

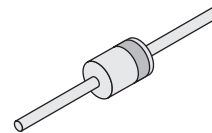

DO-41

VISHAY ZENER DIODES (CONT.)

For quantities greater than listed, call for quote.

For quantities greater than listed, call for quote.

MOUSER STOCK NO.	Vishay Part No.	Nominal Voltage (V)	Power Rating (W)	Test Current (mA)	Price Each			
					1	100	500	1000
Surface Mount • SOT-23-3 Case Type								
625-BZX84C6V2-V	BZX84C6V2-V-GS08	6.2	0.35	10	.07	.03	.029	.02
625-BZX84C6V8-V	BZX84C6V8-V-GS08	6.8	0.35	15	.07	.03	.029	.02
625-BZX84C7V5-V	BZX84C7V5-V-GS08	7.5	0.35	15	.07	.03	.029	.02
625-BZX84C8V2-V	BZX84C8V2-V-GS08	8.2	0.35	15	.07	.03	.029	.02
625-BZX84C9V1-V	BZX84C9V1-V-GS08	9.1	0.35	15	.07	.03	.029	.02
625-BZX84C10-V	BZX84C10-V-GS08	10	0.35	20	.07	.03	.029	.02
625-BZX84C11-V	BZX84C11-V-GS08	11	0.35	20	.07	.03	.029	.02
625-BZX84C12-V	BZX84C12-V-GS08	12	0.35	25	.10	.067	.061	.04
625-BZX84C13-V	BZX84C13-V-GS08	13	0.35	30	.07	.03	.029	.02
625-BZX84C15-V	BZX84C15-V-GS08	15	0.35	30	.06	.035	.031	.021
625-BZX84C16-V	BZX84C16-V-GS08	16	0.35	40	.07	.03	.029	.02
625-BZX84C18-V	BZX84C18-V-GS08	18	0.35	45	.07	.03	.029	.02
625-BZX84C20-V	BZX84C20-V-GS08	20	0.35	55	.07	.03	.029	.022
625-BZX84C22-V	BZX84C22-V-GS08	22	0.35	55	.07	.03	.029	.02
625-BZX84C24-V	BZX84C24-V-GS08	24	0.35	70	.07	.03	.029	.02
625-BZX84C27-V	BZX84C27-V-GS08	27	0.35	80	.07	.033	.03	.024
625-BZX84C30-V	BZX84C30-V-GS08	30	0.35	80	.07	.03	.029	.02
625-BZX84C33-V	BZX84C33-V-GS08	33	0.35	80	.07	.03	.029	.02
625-BZX84C36-V	BZX84C36-V-GS08	36	0.35	90	.07	.03	.029	.02
625-BZX84C39-V	BZX84C39-V-GS08	39	0.35	130	.07	.03	.029	.02
625-BZX84C43-V	BZX84C43-V-GS08	43	0.35	150	.07	.03	.029	.02
625-BZX84C47-V	BZX84C47-V-GS08	47	0.35	170	.07	.03	.029	.02
625-BZX84C51-V	BZX84C51-V-GS08	51	0.35	180	.07	.03	.029	.02

MOUSER STOCK NO.	Vishay Part No.	Nominal Voltage (V)	Power Rating (W)	Test Current (mA)	Price Each			
					1	100	500	1000
Surface Mount • SOD-80C Case Type								
78-TZM5221B	TZM5221B-GS08	2.4	0.5	20	.07	.039	.035	.034
78-TZM5222B	TZM5222B-GS08	2.5	0.5	20	.07	.039	.035	.034
78-TZM5223B	TZM5223B-GS08	2.7	0.5	20	.07	.039	.035	.034
78-TZM5224B	TZM5224B-GS08	2.8	0.5	20	.07	.029	.026	.025
78-TZM5225B	TZM5225B-GS08	3.0	0.5	20	.07	.029	.026	.025
78-TZM5226B	TZM5226B-GS08	3.3	0.5	20	.07	.029	.026	.025
78-TZM5227B	TZM5227B-GS08	3.6	0.5	20	.07	.029	.026	.025
78-TZM5228B	TZM5228B-GS08	3.9	0.5	20	.07	.029	.026	.025
78-TZM5229B	TZM5229B-GS08	4.3	0.5	20	.07	.029	.026	.025
78-TZM5230B	TZM5230B-GS08	4.7	0.5	20	.07	.029	.026	.025
78-TZM5231B	TZM5231B-GS08	5.1	0.5	20	.07	.029	.026	.025
78-TZM5232B	TZM5232B-GS08	5.6	0.5	20	.07	.029	.026	.025
78-TZM5233B	TZM5233B-GS08	6.0	0.5	20	.07	.029	.027	.026
78-TZM5234B	TZM5234B-GS08	6.2	0.5	20	.07	.029	.027	.026
78-TZM5235B	TZM5235B-GS08	6.8	0.5	20	.07	.029	.027	.026
78-TZM5236B	TZM5236B-GS08	7.5	0.5	20	.07	.029	.026	.025
78-TZM5237B	TZM5237B-GS08	8.2	0.5	20	.07	.029	.026	.025
78-TZM5239B	TZM5239B-GS08	9.1	0.5	20	.07	.029	.026	.025
78-TZM5240B	TZM5240B-GS08	10	0.5	20	.07	.029	.026	.025
78-TZM5241B	TZM5241B-GS08	11	0.5	20	.07	.029	.026	.025
78-TZM5242B	TZM5242B-GS08	12	0.5	20	.07	.029	.026	.025
78-TZM5243B	TZM5243B-GS08	13	0.5	9.5	.07	.029	.026	.025
78-TZM5244B	TZM5244B-GS08	14	0.5	9.0	.07	.029	.026	.025
78-TZM5245B	TZM5245B-GS08	15	0.5	8.5	.07	.029	.026	.025
78-TZM5246B	TZM5246B-GS08	16	0.5	7.8	.07	.029	.026	.025
78-TZM5247B	TZM5247B-GS08	17	0.5	7.4	.07	.029	.026	.025
78-TZM5248B	TZM5248B-GS08	18	0.5	7.0	.07	.029	.026	.025
78-TZM5250B	TZM5250B-GS08	20	0.5	6.2	.07	.029	.026	.025
78-TZM5251B	TZM5251B-GS08	22	0.5	5.6	.07	.029	.026	.025
78-TZM5252B	TZM5252B-GS08	24	0.5	5.2	.07	.029	.026	.025
78-TZM5254B	TZM5254B-GS08	27	0.5	4.6	.07	.029	.026	.025
78-TZM5255B	TZM5255B-GS08	28	0.5	4.5	.07	.029	.027	.026
78-TZM5256B	TZM5256B-GS08	30	0.5	4.2	.07	.029	.027	.026
78-TZM5257B	TZM5257B-GS08	33	0.5	3.8	.07	.029	.027	.026
78-TZM5258B	TZM5258B-GS08	36	0.5	3.4	.07	.029	.026	.025
78-TZM5259B	TZM5259B-GS08	39	0.5	3.2	.07	.029	.026	.025
78-TZM5260B	TZM5260B-GS08	43	0.5	3.0	.07	.029	.026	.025
78-TZM5262B	TZM5262B-GS08	51	0.5	2.5	.07	.029	.025	.024
78-TZM5263B	TZM5263B-GS08	56	0.5	2.2	.07	.029	.026	.025
78-TZM5267B	TZM5267B-GS08	75	0.5	1.7	.07	.029	.026	.025

MOUSER STOCK NO.	Vishay Part No.	Nominal Voltage (V)	Power Rating (W)	Test Current (mA)	Price Each			
					1	100	500	1000
Surface Mount • MELF Case Type								
78-TZMB13	TZMB13-GS08	13	0.5	5	.07	.04	.035	.034
78-TZMB16	TZMB16-GS08	16	0.5	5	.07	.04	.035	.034
78-TZMB18	TZMB18-GS08	18	0.5	5	.07	.04	.035	.034
78-TZMB20	TZMB20-GS08	20	0.5	5	.07	.04	.035	.034
78-TZMB22	TZMB22-GS08	22	0.5	5	.07	.04	.035	.034
78-TZMB24	TZMB24-GS08	24	0.5	5	.07	.04	.035	.034
78-TZMC2V4	TZMC2V4-GS08	2.4	0.5	5	.07	.029	.026	.025
78-TZMC2.7	TZMC2V7-GS08	2.7	0.5	5	.07	.029	.026	.025
78-TZMC3.6	TZMC3V6-GS08	3.6	0.5	5	.07	.029	.026	.025
78-TZMC3.9	TZMC3V9-GS08	3.9	0.5	5	.07	.029	.026	.025
78-TZMC4.3	TZMC4V3-GS08	4.3	0.5	5	.07	.029	.026	.025
78-TZMC4.7	TZMC4V7-GS08	4.7	0.5	5	.07	.029	.026	.025
78-TZMC5.1	TZMC5V1-GS08	5.1	0.5	5	.07	.029	.026	.025
78-TZMC6.2	TZMC6V2-GS08	6.2	0.5	5	.07	.029	.026	.025
78-TZMC6.8	TZMC6V8-GS08	6.8	0.5	5	.07	.029	.026	.025
78-TZMC7.5	TZMC7V5-GS08	7.5	0.5	5	.07	.029	.026	.025
78-TZMC8.2	TZMC8V2-GS08	8.2	0.5	5	.07	.029	.026	.025
78-TZMC10	TZMC10-GS08	10	0.5	5	.07	.029	.026	.025
78-TZMC11	TZMC11-GS08	11	0.5	5	.07	.029	.026	.025
78-TZMC12	TZMC12-GS08	12	0.5	5	.07	.029	.026	.025
78-TZMC15	TZMC15-GS08	15	0.5	5	.07	.029	.026	.025
78-TZMC16	TZMC16-GS08	16	0.5	5	.07	.029	.026	.025
78-TZMC18	TZMC18-GS08	18	0.5	5	.07	.029	.026	.025
78-TZMC24	TZMC24-GS08	24	0.5	5	.07	.029	.026	.025
78-TZMC27	TZMC27-GS08	27	0.5	5	.07	.029	.026	.025
78-TZMC30	TZMC30-GS08	30	0.5	5	.07	.029	.026	.025
78-TZMC33	TZMC33-GS08	33	0.5	5	.07	.029	.026	.025
78-TZMC36	TZMC36-GS08	36	0.5	5	.07	.029	.026	.025
78-TZMC39	TZMC39-GS08	39	0.5	2.5	.07	.029	.026	.025
78-TZMC47	TZMC47-GS08	47	0.5	2.5	.07	.029	.026	.025
78-TZMC51	TZMC51-GS08	51	0.5	2.5	.07	.029	.026	.025
78-TZMC56	TZMC56-GS08	56	0.5	2.5	.07	.029	.026	.025
78-TZMC62	TZMC62-GS08	62	0.5	2.5	.07	.029	.026	.025
78-TZMC68	TZMC68-GS08	68	0.5	2.5	.07	.029	.026	.025
78-TZMC75	TZMC75-GS08	75	0.5	2.5	.07	.029	.026	.025

© Copyright 2012 Mouser Electronics

MOUSER STOCK NO.	Vishay Part No.	Nominal Voltage (V)	Power Rating (W)	Test Current (mA)	Price Each			
					1	100	500	1000
Surface Mount • SOD-80C Case Type (Cont.)								
78-TZM4730A	ZM4730A-GS08	3.9	1	64	.14	.12	.099	.095
625-ZM4731A	ZM4731A-GS08	4.3	1	58	.14	.12	.099	.095
625-ZM4732A	ZM4732A-GS08	4.7	1	53	.14	.12	.099	.095
625-ZM4733A	ZM4733A-GS08	5.1	1	49	.14	.12	.099	.095
625-ZM4734A	ZM4734A-GS08	5.6	1	45	.14	.12	.099	.095
625-ZM4735A	ZM4735A-GS08	6.2	1	41	.14	.12	.099	.095
625-ZM4736A	ZM4736A-GS08	6.8	1	37	.14	.12	.099	.095
625-ZM4737A	ZM4737A-GS08	7.5	1	34	.14	.12	.099	.095
625-ZM4738A	ZM4738A-GS08	8.2	1	31	.14	.12	.099	.095
625-ZM4739A	ZM4739A-GS08	9.1	1	28	.14	.12	.099	.095
625-ZM4740A	ZM4740A-GS08	10	1	25	.14	.12	.099	.095
625-ZM4741A	ZM4741A-GS08	11	1	23	.14	.12	.099	.095
625-ZM4742A	ZM4742A-GS08	12	1	21	.14			