

# VISHAY Diodes

RoHS Compliant This product is RoHS compliant.

## VISHAY SCHOTTKY DIODES

For quantities greater than listed, call for quote.

MOUSER STOCK NO.	Vishay Part No.	Case Type	VRMM Max. (V)	IF Max. (A)	VF @ IF Max. (V)	IF (mA)	IFSM Max. (A)	trr Typ/Max (ns)	Tj Max. (°C)	Price Each				
										1	100	500	1000	
<b>Surface Mount</b>														
625-SD103CW-V	SD103CW-V-GS08	SOD-123	20	0.35	0.37	20	2	10/----	125	.10	.07	.06	.055	
625-LL103C	LL103C-GS08	SOD-80C	20	0.35	0.37	20	15	----/10	125	.15	.075	.06	.055	
625-BAT54-V	BAT54-V-GS08	SOT-23-3	30	0.2	0.4	10	0.6	----/5	125	.06	.04	.037	.033	
625-BAT54A-V	BAT54A-V-GS08	SOT-23-3	30	0.2	0.4	10	0.6	----/5	125	.07	.05	.044	.034	
625-BAT54C-V	BAT54C-V-GS08	SOT-23-3	30	0.2	0.4	10	0.6	----/5	125	.07	.05	.042	.031	
625-BAT54S-V	BAT54S-V-GS08	SOT-23-3	30	0.2	1	100	0.6	----/5	125	.07	.054	.042	.037	
625-SD103BW-V	SD103BW-V-GS08	SOD-123	30	0.35	0.37	20	2	10/----	125	.10	.07	.06	.055	
625-LL103B	LL103B-GS08	SOD-80C	30	0.35	0.37	20	15	----/10	125	.08	.064	.057	.055	
625-LL101C	LL101C-GS08	SOD-80C	40	0.2	0.39	1	2	----/1	125	.07	.058	.051	.049	
625-SD101CW-V	SD101CW-V-GS08	SOD-123	40	0.2	0.39	1	2	----/1	125	.09	.067	.063	.055	
78-BAS40-05-V	BAS40-05-V-GS08	SOT-23-3	40	0.2	0.38	1	0.6	----/5	125	.09	.07	.065	.06	
625-SD103AW-V	SD103AW-V-GS08	SOD-123	40	0.35	0.37	20	2	10/----	125	.10	.07	.06	.055	
625-LL103A	LL103A-GS08	SOD-80C	40	0.35	0.37	20	15	----/10	125	.07	.05	.043	.043	
625-LL101B	LL101B-GS08	SOD-80C	50	0.2	0.4	1	2	----/1	125	.09	.062	.052	.048	
625-SD101BW-V	SD101BW-V-GS08	SOD-123	50	0.2	0.4	1	2	----/1	125	.09	.067	.063	.055	
625-LL101A	LL101A-GS08	SOD-80C	60	0.2	0.41	1	2	----/1	125	.07	.063	.055	.052	
625-SD101AW-V	SD101AW-V-GS08	SOD-123	60	0.2	0.41	1	2	----/1	125	.09	.067	.063	.055	
625-BAS70-00-V	BAS70-00-V-GS08	SOT-23-3	70	0.2	0.41	1	0.6	----/5	150	.10	.07	.056	.042	
625-BAS70-04-V	BAS70-04-V-GS08	SOT-23-3	70	0.2	0.41	1	0.6	----/5	150	.16	.095	.063	.054	
625-BAS70-05-V	BAS70-05-V-GS08	SOT-23-3	70	0.2	0.41	1	0.6	----/5	150	.16	.095	.063	.054	
625-BAS70-06-V	BAS70-06-V-GS08	SOT-23-3	70	0.2	0.41	1	0.6	----/5	150	.12	.09	.077	.075	
<b>Thru-Hole</b>														
625-SD103C	SD103C-TR	DO-35	20	0.35	0.37	20	15	10/----	125	.11	.075	.064	.05	
625-BAT42	BAT42-TR	DO-35	30	0.2	0.4	10	4	----/5	125	.11	.08	.07	.063	
625-SD101C	SD101C-TR	DO-35	40	0.2	0.39	1	2	----/1	125	.07	.056	.049	.047	
625-SD103A	SD103A-TR	DO-35	40	0.35	0.37	20	15	10/----	125	.10	.08	.065	.054	
625-SD101A	SD101A-TR	DO-35	60	0.2	0.41	1	2	----/1	125	.08	.06	.05	.045	

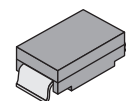

SOD-123

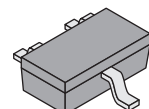

SOT-23-3

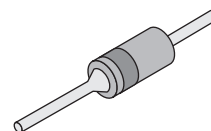

DO-35

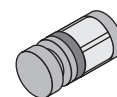

MELF/SOD-80C

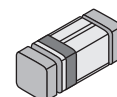

Quadro MELF



MicroMELF



SOD-323

Diodes & Rectifiers Vishay Semiconductors

## VISHAY SMALL SIGNAL DIODES

For quantities greater than listed, call for quote.

MOUSER STOCK NO.	Vishay Part No.	Case Type	VRMM Max. (V)	IF Max. (A)	VF @ IF Max. (V)	IF (mA)	IFSM Max. (A)	trr Typ/Max (ns)	Tj Max. (°C)	Price Each				
										1	100	500	1000	
<b>Surface Mount</b>														
78-BAS85-GS18	BAS85-GS18	SOD-80C	30	200	0.2	25	1	200	----/5	.09	.066	.06	.053	
78-BAS81	BAS81-GS08	SOD-80C	40	30	200	40	1	410	----/5	.08	.066	.06	.051	
78-BAS82	BAS82-GS08	SOD-80C	50	30	200	50	1	410	----/5	.08	.066	.06	.051	
78-BAS86	BAS86-GS08	SOD-80C	50	200	40	50	1	200	----/5	.09	.076	.07	.058	
78-1N4150W-V	1N4150W-V-GS08	SOD-123	50	200	100	50	1	200	----/4	.10	.071	.049	.038	
78-LL4150	LL4150-GS08	SOD-80C	50	600	0.1	50	1	200	----/4	.06	.04	.02	.017	
78-BAS83	BAS83-GS08	SOD-80C	60	30	200	60	1	410	----/5	.09	.07	.06	.053	
625-BAV99-V	BAV99-V-GS08	SOT-23-3	70	250	25000	70	1	50	----/6	.05	.033	.03	.02	
625-BAV70-V	BAV70-V-GS08	SOT-23-3	70	250	25000	70	1	50	----/6	.08	.05	.028	.019	
625-BAW56-V	BAW56-V-GS08	SOT-23-3	70	250	25000	70	1	50	----/6	.33	.12	.064	.045	
78-LL4151	LL4151-GS08	SOD-80C	75	200	50	50	1	50	----/4	.06	.04	.023	.02	
625-1N4148W-V	1N4148W-V-GS08	SOD-123	100	150	5000	75	1	10	----/4	.09	.068	.032	.026	
625-IMBD4148-V	IMBD4148-V-GS08	SOT-23-3	100	150	25000	70	1	10	----/4	.08	.06	.035	.03	
78-LL4448	LL4448-GS08	SOD-80C	100	150	0.005	75	1	100	----/8	.06	.038	.017	.015	
625-BAS16-V	BAS16-V-GS08	SOT-23-3	100	150	1000	75	1	50	----/6	.30	.13	.062	.043	
625-MMBD7000-V	MMBD7000-V-GS08	SOT-23-3	100	200	3000	100	0.82	10	----/4	.09	.06	.029	.018	
78-LS4448	LS4448GS08	SOD-80C	100	300	25	75	720mV	5	----/4	.05	.04	.02	.018	
78-LL4148	LL4148-GS08	SOD-80C	100	450	5	75	1	10	----/8	.05	.038	.018	.015	
78-LS4148	LS4148-GS08	Quadro MELF	100	500	5	75	1	50	----/8	.05	.037	.017	.014	
78-BAV202	BAV202-GS08	SOD-80C	200	100	100	150	1	10	----/50	.07	.057	.051	.024	
78-BAV302	BAV302-TR	MicroMELF	200	100	100	150	1000mV	100	----/50	.09	.07	.06	.03	
78-BAV21WS-V	BAV21WS-V-GS08	SOD-323	200	200	100	200	1	100	----/50	.09	.08	.078	.071	
78-BAV102	BAV102-GS08	SOD-80C	200	250	100	150	1	10	----/50	.07	.054	.043	.024	
78-BAV21W-V	BAV21W-V-GS08	SOD-123	200	250	100	200	1	100	----/50	.12	.08	.04	.036	
78-BAV303	BAV303-TR	MicroMELF	250	100	100	200	1000mV	100	----/50	.09	.07	.03	.029	
625-BAS21-V	BAS21-V-GS08	SOT-23-3	250	200	100	200	1	100	----/50	.07	.04	.03	.02	
<b>Thru-Hole</b>														
78-BAT85S	BAT85S-TR	DO-35	30	200	2	25	1	10	----/5	.08	.065	.059	.049	
78-1N4154	1N4154-TR	DO-35	35	450	0.1	25	1	30	----/4	.06	.03	.023	.02	
78-1N4150	1N4150-TR	DO-35	50	600	0.1	50	1	200	----/4	.06	.043	.022	.019	
78-1N4151	1N4151-TR	DO-35	75	450	0.05	50	1	50	----/4	.06	.03	.023	.019	
78-1N914	1N914-TR	DO-35	100	300	5	75	1	10	----/4	.06	.033	.025	.02	
78-1N4148	1N4148-TR	DO-35	100	500	5	75	1	10	----/4	.08	.02	.017	.013	
78-1N4448	1N4448-TR	DO-35	100	500	5	75	1	100	----/4	.06	.03	.023	.019	
78-BAV20	BAV20-TR	DO-35	200	200	100	100	1	100	----/50	.06	.044	.021	.019	
78-BAV21	BAV21-TR	DO-35	250	250	100	200	1	100	----/50	.08	.053	.025	.02	

## VISHAY ZENER DIODES

For quantities greater than listed, call for quote.

MOUSER STOCK NO.	Vishay Part No.	Case Type	Nominal Voltage (V)	Power Rating (W)	Test Current (mA)	Price Each			
						1	100	500	1000
<b>Surface Mount</b>									
625-BZX84C2V4-V	BZX84C2V4-V-GS08	SOT-23-3	2.4	0.35	5	.07	.04	.034	.024
625-BZX84C2V7-V	BZX84C2V7-V-GS08	SOT-23-3	2.7	0.35	5	.07	.028	.025	.023
625-BZX84C3V0-V	BZX84C3V0-V-GS08	SOT-23-3	3.0	0.35	5	.07	.03	.029	.02
625-BZX84C3V3-V	BZX84C3V3-V-GS08	SOT-23-3	3.3	0.35	5	.07	.03	.029	.02
625-BZX84C3V6-V	BZX84C3V6-V-GS08	SOT-23-3	3.6	0.35	5	.07	.03	.029	.02
625-BZX84C3V9-V	BZX84C3V9-V-GS08	SOT-23-3	3.9	0.35	5	.07	.03	.029	.02
625-BZX84C4V3-V	BZX84C4V3-V-GS08	SOT-23-3	4.3	0.35	5	.07	.03	.029	.02
625-BZX84C4V7-V	BZX84C4V7-V-GS08	SOT-23-3	4.7	0.35	5	.07	.03	.029	.02
625-BZX84C5V1-V	BZX84C5V1-V-GS08	SOT-23-3	5.1	0.35	5	.07	.03	.029	.02
625-BZX84C5V6-V	BZX84C5V6-V-GS08	SOT-23-3	5.6	0.35	5	.07	.03	.029	.02