

PANASONIC Lithium Batteries



HI-TEMP COIN CELL LITHIUM BATTERIES



For quantities greater than listed, call for quote.

| MOUSER STOCK NO. | Panasonic Part No. | Fig. | Capacity (mAh) | Dimensions: mm | Price Each | | | |
|------------------|--------------------|------|----------------|----------------|------------|------|------|------|
| | | | | | 1 | 10 | 50 | 100 |
| 658-BR1225A/FAN | BR1225A/FAN | A | 48 | 12.5 x 2.5 | 1.98 | 1.78 | 1.58 | 1.55 |
| 658-BR1225A/HA | BR1225A/HA | A | 48 | 12.5 x 2.5 | 1.98 | 1.78 | 1.58 | 1.55 |
| 658-BR1225A/HBN | BR1225A/HBN | A | 48 | 12.5 x 2.5 | 1.98 | 1.78 | 1.58 | 1.55 |
| 658-BR1632A/FAN | BR1632A/FAN | B | 120 | 16.0 x 3.2 | 1.93 | 1.73 | 1.58 | 1.55 |
| 658-BR1632A/GAN | BR1632A/GAN | B | 120 | 16.0 x 3.2 | 1.93 | 1.73 | 1.58 | 1.55 |
| 658-BR1632A/HAN | BR1632A/HAN | B | 120 | 16.0 x 3.2 | 1.93 | 1.73 | 1.58 | 1.55 |
| 658-BR1632A/VAN | BR1632A/VAN | B | 120 | 16.0 x 3.2 | 1.93 | 1.73 | 1.58 | 1.55 |
| 658-BR2330A/FAN | BR2330A/FAN | C | 255 | 23.0 x 3.0 | 2.20 | 1.98 | 1.76 | 1.68 |
| 658-BR2330A/GAN | BR2330A/GAN | C | 255 | 23.0 x 3.0 | 2.20 | 1.98 | 1.76 | 1.68 |
| 658-BR2330A/HDN | BR2330A/HDN | C | 255 | 23.0 x 3.0 | 2.20 | 1.98 | 1.76 | 1.68 |
| 658-BR2330A/VAN | BR2330A/VAN | C | 255 | 23.0 x 3.0 | 2.20 | 1.98 | 1.76 | 1.68 |
| 658-BR2477A/FBN | BR2477A/FBN | D | 1000 | 24.5 x 7.7 | 3.68 | 3.31 | 2.94 | 2.72 |
| 658-BR2477A/GAN | BR2477A/GAN | D | 1000 | 24.5 x 7.7 | 3.68 | 3.31 | 2.94 | 2.72 |
| 658-BR-2477A-HBN | BR2477A/HBN | D | 1000 | 24.5 x 7.7 | 3.68 | 3.31 | 2.94 | 2.68 |
| 658-BR2477A/VAN | BR2477A/VAN | D | 1000 | 24.5 x 7.7 | 3.68 | 3.31 | 2.94 | 2.72 |

3V LITHIUM COIN CELLS

BR Series:

- Lithium Poly-Carbonmonofluoride
- Stable voltage discharge
- Suitable for low drain devices
- Suitable for high temperature applications
- Operating temperature range: -30°C ~ +80°C

CR Series:

- Lithium Manganese Dioxide
- Tapered voltage discharge
- Suitable for high drain devices
- Operating temperature range: -30°C ~ +60°C

Coin Cells

For quantities greater than listed, call for quote.

| MOUSER STOCK NO. | Panasonic Part No. | Fig. | Capacity (mAh) | Dimensions: mm | Price Each | | | |
|------------------|--------------------|------|----------------|----------------|------------|------|------|------|
| | | | | | 1 | 10 | 25 | 50 |
| 658-BR1216 | BR1216 | F | 25 | 12.5 x 1.6 | 1.35 | 1.24 | 1.16 | 1.09 |
| 658-BR1225 | BR1225 | F | 48 | 12.5 x 2.0 | 1.51 | 1.38 | 1.30 | 1.21 |
| 658-BR1616 | BR1616 | F | 48 | 16.0 x 2.5 | 1.37 | 1.25 | 1.18 | 1.10 |
| 658-BR2032 | BR2032 | F | 190 | 20.0 x 3.2 | 1.90 | 1.79 | 1.75 | 1.70 |
| 658-BR2325 | BR2325 | F | 165 | 23.0 x 2.5 | 1.44 | 1.32 | 1.24 | 1.16 |
| 658-BR2330 | BR2330 | F | 255 | 23.0 x 3.0 | 2.04 | 1.80 | 1.68 | 1.56 |
| 658-BR3032 | BR3032 | F | 500 | 30.0 x 3.2 | 3.38 | 3.04 | 2.87 | 2.70 |
| 658-CR1025 | CR1025 | F | 30 | 10.0 x 2.5 | 1.14 | 1.01 | .94 | .90 |
| 658-CR1216 | CR1216 | F | 25 | 12.0 x 1.6 | 1.11 | 1.02 | .90 | .84 |
| 658-CR1220 | CR1220 | F | 35 | 12.0 x 2.0 | 1.81 | 1.59 | 1.36 | 1.26 |
| 658-CR1616 | CR1616 | F | 55 | 16.0 x 1.6 | .81 | .72 | .68 | .63 |
| 658-CR1620 | CR1620 | F | 75 | 16.0 x 2.0 | .96 | .88 | .80 | .75 |
| 658-CR1632 | CR1632 | F | 140 | 16.0 x 3.2 | 1.31 | 1.19 | 1.13 | 1.07 |
| 658-CR2012 | CR2012 | F | 55 | 20.0 x 1.2 | 1.41 | 1.32 | 1.25 | 1.22 |
| 658-CR2016 | CR2016 | F | 90 | 20.0 x 1.6 | .45 | .42 | .40 | .39 |
| 658-CR2025 | CR2025 | F | 165 | 20.0 x 2.5 | .66 | .60 | .59 | .57 |
| 658-CR2032 | CR2032 | F | 225 | 20.0 x 3.2 | .45 | .42 | .40 | .39 |
| 658-CR2330 | CR2330 | F | 265 | 23.0 x 3.0 | 1.57 | 1.45 | 1.36 | 1.28 |
| 658-CR2354 | CR2354 | F | 560 | 23.0 x 5.4 | 1.67 | 1.57 | 1.51 | 1.46 |
| 658-CR2412 | CR2412 | E | 100 | 24.52 x 1.2 | 3.10 | 2.79 | 2.48 | 2.29 |
| 658-CR2450 | CR2450 | E | 620 | 24.0 x 5.0 | 1.13 | 1.01 | .90 | .89 |
| 658-CR2477 | CR2477 | F | 1000 | 24.5 x 7.7 | 3.30 | 3.09 | 2.98 | 2.88 |
| 658-CR3032 | CR3032 | F | 500 | 30.0 x 3.2 | 2.76 | 2.55 | 2.39 | 2.31 |

Coin Cells w/ PC Mount Pins

For quantities greater than listed, call for quote.

| MOUSER STOCK NO. | Panasonic Part No. | Fig. | Capacity (mAh) | Dimensions: mm | | Price Each | | | | |
|------------------|--------------------|------|----------------|----------------|------|------------|------|------|------|------|
| | | | | Battery | A B | 1 | 10 | 25 | 50 | |
| 658-BR1225-1VC | BR1225/1VC | G | 48 | 12.5 x 2.5 | 3.0 | 3.25 | 1.74 | 1.63 | 1.57 | 1.51 |
| 658-BR2325-1VC | BR2325/1VC | H | 165 | 23.0 x 2.5 | 3.2 | 10.70 | 2.03 | 1.94 | 1.87 | 1.81 |
| 658-BR2330-1VC | BR2330/1VC | H | 255 | 23.0 x 3.0 | 3.9 | 11.45 | 2.09 | 2.02 | 1.95 | 1.88 |
| 658-BR2325-1VG | BR2325/1VG | I | 165 | 23.0 x 2.5 | 5.1 | 15.24 | 1.86 | 1.74 | 1.68 | 1.62 |
| 658-BR2325-1HG | BR2325/1HG | J | 165 | 23.0 x 2.5 | 20.5 | 7.50 | 2.50 | 2.31 | 2.18 | 2.06 |
| 658-BR1225-1HC | BR1225/1HC | K | 48 | 12.5 x 2.0 | 10.0 | 3.25 | 1.73 | 1.58 | 1.53 | 1.48 |
| 658-BR2032-1HE | BR2032/1HE | L | 190 | 20.0 x 3.2 | 20.5 | --- | 2.42 | 2.36 | 2.28 | 2.22 |
| 658-BR2325-1HC | BR2325/1HC | M | 165 | 23.0 x 2.5 | 20.5 | --- | 1.71 | 1.61 | 1.55 | 1.50 |
| 658-BR2330-1HE | BR2330/1HE | N | 255 | 23.0 x 3.0 | 20.5 | --- | 2.30 | 2.03 | 1.90 | 1.83 |
| 658-CR2477-1HF | CR2477/1HF | O | 1000 | 24.5 x 7.7 | 20.5 | --- | 4.15 | 3.70 | 3.35 | 3.30 |

3V Lithium Pin Type

For quantities greater than listed, call for quote.

| MOUSER STOCK NO. | Panasonic Part No. | Fig. | Capacity (mAh) | Dimensions: mm | Price Each | | | |
|------------------|--------------------|------|----------------|----------------|------------|------|------|------|
| | | | | | 1 | 10 | 25 | 50 |
| 658-BR425 | BR425 | P | 25 | 4.2 x 25.9 | 3.60 | 3.30 | 3.10 | 2.90 |
| 658-BR435 | BR435 | P | 50 | 4.2 x 35.9 | 3.75 | 3.38 | 3.30 | 3.25 |

3V LITHIUM CYLINDRICAL CELLS

- High energy density
- Long shelf life
- Operating temperature range: -40°C ~ +85°C
- High rate discharge

For quantities greater than listed, call for quote.

| MOUSER STOCK NO. | Panasonic Part No. | Fig. | Capacity (mAh) | Dimensions: mm | Price Each | | | |
|------------------|--------------------|------|----------------|----------------|------------|-------|-------|-------|
| | | | | | 1 | 10 | 25 | 50 |
| 658-BR2-3ASSP | BR-2/3ASSP | Q | 1200 | 17.0 x 33.5 | 4.15 | 3.85 | 3.60 | 3.50 |
| 658-BR2-3AT2SP | BR-2/3AT2SP | R | 1200 | 17.0 x 33.5 | 5.88 | 5.56 | 5.27 | 4.99 |
| 658-BR2-3AE2SP | BR-2/3AE2SP | S | 1200 | 17.0 x 33.5 | 5.18 | 4.62 | 4.20 | 3.92 |
| 658-BR-A | BR-A | Q | 1800 | 17.0 x 45.5 | 9.75 | 8.99 | 8.25 | 7.99 |
| 658-BR-C | BR-C | Q | 5000 | 26.0 x 50.0 | 18.49 | 17.34 | 15.79 | 14.66 |
| 658-BR-CT2SP | BR-CT2SP | R | 5000 | 26.0 x 50.0 | 17.45 | 16.13 | 15.28 | 14.85 |

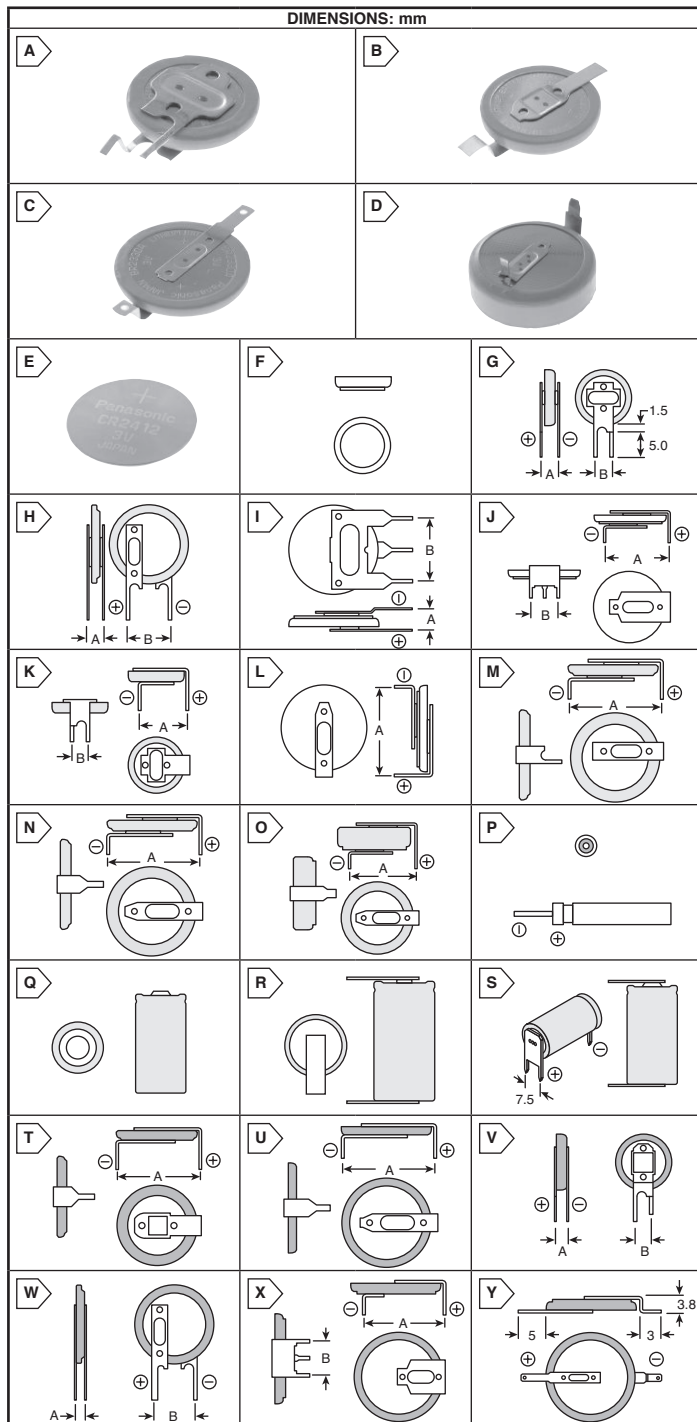

VANADIUM PENTOXIDE LITHIUM 3V RECHARGEABLE BATTERIES

Compact, high energy batteries that have nearly twice the energy of conventional button-shaped NiCd batteries.

- Operating temperature range: -20°C ~ +60°C
- Self-discharge per year: 2%
- Charge voltage: 3.25V ~ 3.55V
- Charge-discharge cycles: 1000

For quantities greater than listed, call for quote.

| MOUSER STOCK NO. | Panasonic Part No. | Fig. | Capacity (mAh) | Dimensions: mm | | | Price Each | | | |
|------------------|--------------------|------|----------------|----------------|-------------|------|------------|------|------|------|
| | | | | Battery | A | B | 1 | 10 | 25 | 50 |
| 658-VL1220-1HF | VL1220-1HF | T | 7.0 | 12.5 x 2.0 | 10.0 | --- | 4.17 | 3.76 | 3.62 | 3.54 |
| 658-VL2020-1HF | VL2020-1HF | U | 20.0 | 20.0 x 2.0 | 20.5 | --- | 4.30 | 3.80 | 3.62 | 3.48 |
| 658-VL2320-1HF | VL2320-1HF | U | 30.0 | 23.0 x 2.0 | 20.5 | --- | 5.90 | 5.49 | 5.13 | 4.82 |
| 658-VL2330-1HF | VL2330-1HF | U | 50.0 | 23.0 x 3.0 | 20.5 | --- | 6.67 | 6.07 | 5.84 | 5.62 |
| 658-VL1220-1VC | VL1220-1VC | V | 7.0 | 12.5 x 2.0 | 2.5 | 3.25 | 4.17 | 3.76 | 3.62 | 3.54 |
| 658-VL2020-1VC | VL2020-1VC | W | 20.0 | 20.0 x 2.0 | 2.7 | 10.2 | 4.72 | 4.50 | 3.98 | 3.82 |
| 658-VL2320-1VC | VL2320-1VC | W | 30.0 | 23.0 x 2.0 | 2.7 | 10.2 | 6.41 | 6.03 | 5.63 | 5.23 |
| 658-VL2330-1VC | VL2330-1VC | W | 50.0 | 23.0 x 3.0 | 3.7 | 10.2 | 6.67 | 5.88 | 5.68 | 5.49 |
| 658-VL3032-1GUF | VL3032-1GUF | X | 100.0 | 30.0 x 3.2 | 25.4 | 10.2 | 8.89 | 8.27 | 7.73 | 7.44 |
| 658-VL3032-1F2 | VL3032-1F2 | Y | 100.0 | 30.0 x 3.2 | solder tabs | --- | 8.89 | 8.27 | 7.73 | 7.44 |