

MEAN WELL Single Output Desktop Power Supplies



RoHS Compliant This product is RoHS compliant.

10-220W AC-DC SINGLE OUTPUT DESKTOP SERIES

- Universal AC input
- Fully enclosed plastic case
- Protections: Short circuit, overload, overvoltage
- EISA



For quantities greater than listed, call for quote.

MOUSER STOCK NO.	Mean Well Part No.	Fig.	Output Voltage	Output Current	Power	Dimensions: mm			Price Each		
						L	W	H	1	10	20
• No load power consumption <0.3W • Pass energy star level V and ErP Step 2 • Output connector: 2.1x5.5 center positive											
709-GS15A-1P1J	GS15A-1P1J	A	5V	2.40A	12W	100	58.5	32.8	19.61	18.02	16.43
709-GS15A-11P1J	GS15A-11P1J	A	7.5V	1.60A	12W	100	58.5	32.8	19.61	18.02	16.43
709-GS15A-2P1J	GS15A-2P1J	A	9V	1.66A	15W	100	58.5	32.8	19.61	18.02	16.43
709-GS15A-3P1J	GS15A-3P1J	A	12V	1.25A	15W	100	58.5	32.8	19.61	18.02	16.43
709-GS15A-4P1J	GS15A-4P1J	A	15V	1.00A	15W	100	58.5	32.8	19.61	18.02	16.43
709-GS15A-6P1J	GS15A-6P1J	A	24V	0.62A	15W	100	58.5	32.8	19.61	18.02	16.43
• No load power consumption <0.3W • Pass energy star level V and ErP Step 2 • Output connector: 2.1x5.5 center positive											
709-GS15B-3P1J	GS15B-3P1J	B	12V	1.25A	15W	100	58.5	32.8	19.61	18.02	16.43
• No load power consumption <0.5W • Pass energy star (CEC) level IV for 5-48V output • Output connector: 2.1x5.5 center positive											
709-GS18A03-P1J	GS18A03-P1J	C	3.3V	3.0A	10W	93	54	36	19.57	16.80	15.54
709-GS18A05-P1J	GS18A05-P1J	C	5V	3.0A	15W	93	54	36	24.48	22.02	19.80
709-GS18A07-P1J	GS18A07-P1J	C	7.5V	2.0A	15W	93	54	36	22.02	19.80	17.00
709-GS18A48-P1J	GS18A48-P1J	C	48V	0.375A	18W	93	54	36	24.12	21.70	18.62
709-GS18A09-P1J	GS18A09-P1J	C	9V	2.0A	18W	93	54	36	21.76	19.57	16.80
709-GS18A12-P1J	GS18A12-P1J	C	12V	1.5A	18W	93	54	36	22.02	19.80	17.00
709-GS18A15-P1J	GS18A15-P1J	C	15V	1.2A	18W	93	54	36	21.76	19.57	16.80
709-GS18A18-P1J	GS18A18-P1J	C	18V	1.0A	18W	93	54	36	19.80	17.00	15.72
709-GS18A24-P1J	GS18A24-P1J	C	24V	0.75A	18W	93	54	36	21.44	18.40	17.02
709-GS18A28-P1J	GS18A28-P1J	C	28V	0.64A	18W	93	54	36	21.70	18.62	17.22
• No load power consumption <0.5W • Pass energy star (CEC) level IV for 5-48V output • Output connector: 2.1x5.5 center positive											
709-GS18B15-P1J	GS18B15-P1J	D	15V	1.2A	18W	79	54	33	19.80	17.00	15.72
709-GS18B28-P1J	GS18B28-P1J	D	28V	0.64A	18W	79	54	33	21.70	18.62	17.22
• No load power consumption <0.5W • Pass energy star (CEC) level IV regulation • Output connector: 2.1x5.5 center positive											
709-GS25A05-P1J	GS25A05-P1J	C	5V	4.0A	20W	93	54	36	20.74	17.80	16.46
709-GS25A07-P1J	GS25A07-P1J	C	7.5V	2.93A	22W	93	54	36	20.98	18.01	16.65
709-GS25A09-P1J	GS25A09-P1J	C	9V	2.77A	25W	93	54	36	20.74	17.80	16.46
709-GS25A12-P1J	GS25A12-P1J	C	12V	2.08A	25W	93	54	36	20.74	17.80	16.46
709-GS25A15-P1J	GS25A15-P1J	C	15V	1.66A	25W	93	54	36	20.74	17.80	16.46
709-GS25A18-P1J	GS25A18-P1J	C	18V	1.38A	25W	93	54	36	20.74	17.80	16.46
709-GS25A24-P1J	GS25A24-P1J	C	24V	1.04A	25W	93	54	36	22.83	19.60	18.13
709-GS25A28-P1J	GS25A28-P1J	C	28V	0.89A	25W	93	54	36	22.83	19.60	18.13
709-GS25A48-P1J	GS25A48-P1J	C	48V	0.52A	25W	93	54	36	25.68	23.10	19.83
• No load power consumption <0.5W • Pass energy star (CEC) level IV regulation • Output connector: 2.1x5.5 center positive											
709-GS25B05-P1J	GS25B05-P1J	D	5V	4.0A	20W	79	54	33	20.98	18.01	16.65
709-GS25B07-P1J	GS25B07-P1J	D	7.5V	2.93A	22W	79	54	33	20.98	18.01	16.65
709-GS25B09-P1J	GS25B09-P1J	D	9V	2.77A	25W	79	54	33	20.98	18.01	16.65
709-GS25B12-P1J	GS25B12-P1J	D	12V	2.08A	25W	79	54	33	20.74	17.80	16.46
709-GS25B15-P1J	GS25B15-P1J	D	15V	1.66A	25W	79	54	33	23.32	20.98	18.01
709-GS25B24-P1J	GS25B24-P1J	D	24V	1.04A	25W	79	54	33	23.10	19.83	18.34
709-GS25B28-P1J	GS25B28-P1J	D	28V	0.89A	25W	79	54	33	22.83	19.60	18.13
• No load power consumption <0.3W • Pass energy star level V and ErP Step 2 • Output connector: 2.1x5.5 center positive											
709-GS40A05-P1J	GS40A05-P1J	A	5V	5A	25W	125	50	31.5	32.87	30.79	28.72
709-GS40A07-P1J	GS40A07-P1J	A	7.5V	5.34A	40W	125	50	31.5	32.87	30.79	28.72
709-GS40A09-P1J	GS40A09-P1J	A	9V	4.45A	40W	125	50	31.5	32.87	30.79	28.72
709-GS40A12-P1J	GS40A12-P1J	A	12V	3.34A	40W	125	50	31.5	32.87	30.79	28.72
709-GS40A15-P1J	GS40A15-P1J	A	15V	2.67A	40W	125	50	31.5	32.87	30.79	28.72
709-GS40A18-P1J	GS40A18-P1J	A	18V	2.22A	40W	125	50	31.5	32.87	30.79	28.72
709-GS40A24-P1J	GS40A24-P1J	A	24V	1.67A	40W	125	50	31.5	32.87	30.79	28.72
709-GS40A48-P1J	GS40A48-P1J	A	48V	0.84A	40W	125	50	31.5	32.87	30.79	28.72
• No load power consumption <0.3W • Pass energy star level V and ErP Step 2 • Output connector: 2.1x5.5 center positive											
709-GS60A05-P1J	GS60A05-P1J	A	5V	6A	30W	125	50	31.5	44.00	41.58	38.71
709-GS60A09-P1J	GS60A09-P1J	A	9V	6A	54W	125	50	31.5	44.00	41.58	38.71
709-GS60A12-P1J	GS60A12-P1J	A	12V	5A	60W	125	50	31.5	44.00	41.58	38.71
709-GS60A15-P1J	GS60A15-P1J	A	15V	4A	60W	125	50	31.5	44.00	41.58	38.71
709-GS60A18-P1J	GS60A18-P1J	A	18V	3.33A	60W	125	50	31.5	44.00	41.58	38.71
709-GS60A24-P1J	GS60A24-P1J	A	24V	2.5A	60W	125	50	31.5	44.00	41.58	38.71
• No load power consumption <0.5W • Pass energy star level V and ErP Step 2 • Output connector: 2.5x5.5 center positive											
709-GS90A12-P1M	GS90A12-P1M	A	12V	6.67A	80W	145	60	32	55.60	52.54	48.93
709-GS90A15-P1M	GS90A15-P1M	A	15V	6A	90W	145	60	32	55.60	52.54	48.93
709-GS90A19-P1M	GS90A19-P1M	A	19V	4.74A	90W	145	60	32	55.60	52.54	48.93
709-GS90A24-P1M	GS90A24-P1M	A	24V	3.75A	90W	145	60	32	55.60	52.54	48.93
709-GS90A48-P1M	GS90A48-P1M	A	48V	1.87A	90W	145	60	32	55.60	52.54	48.93
• No load power consumption <0.5W • Pass energy star level V and ErP Step 2 • Output connector: 4pin DIN											
709-GS120A12-R7B	GS120A12-R7B	E	12V	8.5A	102W	167	67	35	70.37	64.41	62.76
709-GS120A15-R7B	GS120A15-R7B	E	15V	7A	105W	167	67	35	76.40	71.05	67.23
709-GS120A20-R7B	GS120A20-R7B	E	20V	6A	120W	167	67	35	76.40	71.05	67.23
709-GS120A24-R7B	GS120A24-R7B	E	24V	5A	120W	167	67	35	70.37	64.41	62.76
709-GS120A48-R7B	GS120A48-R7B	E	48V	2.5A	120W	167	67	35	70.37	64.41	62.76
709-GS160A12-R7B	GS160A12-R7B	E	12V	11.5A	138W	175	72	35	96.80	91.48	86.15
709-GS160A15-R7B	GS160A15-R7B	E	15V	9.6A	144W	175	72	35	96.80	91.48	86.15
709-GS160A20-R7B	GS160A20-R7B	E	20V	8A	160W	175	72	35	96.80	91.48	86.15
709-GS160A24-R7B	GS160A24-R7B	E	24V	6.67A	160W	175	72	35	96.80	91.48	86.15
709-GS160A48-R7B	GS160A48-R7B	E	48V	3.34A	160W	175	72	35	96.80	91.48	86.15
• No load power consumption <0.5W • Pass energy star level V and ErP Step 2 • Output connector: 4pin DIN											
709-GS220A12-R7B	GS220A12-R7B	E	12V	15A	180W	210	85	46	127.89	115.71	109.62
709-GS220A15-R7B	GS220A15-R7B	E	15V	13.4A	201W	210	85	46	127.89	115.71	109.62
709-GS220A20-R7B	GS220A20-R7B	E	20V	11A	220W	210	85	46	127.89	115.71	109.62
709-GS220A24-R7B	GS220A24-R7B	E	24V	9.2A	221W	210	85	46	127.89	115.71	109.62
709-GS220A48-R7B	GS220A48-R7B	E	48V	4.6A	221W	210	85	46	127.89	115.71	109.62

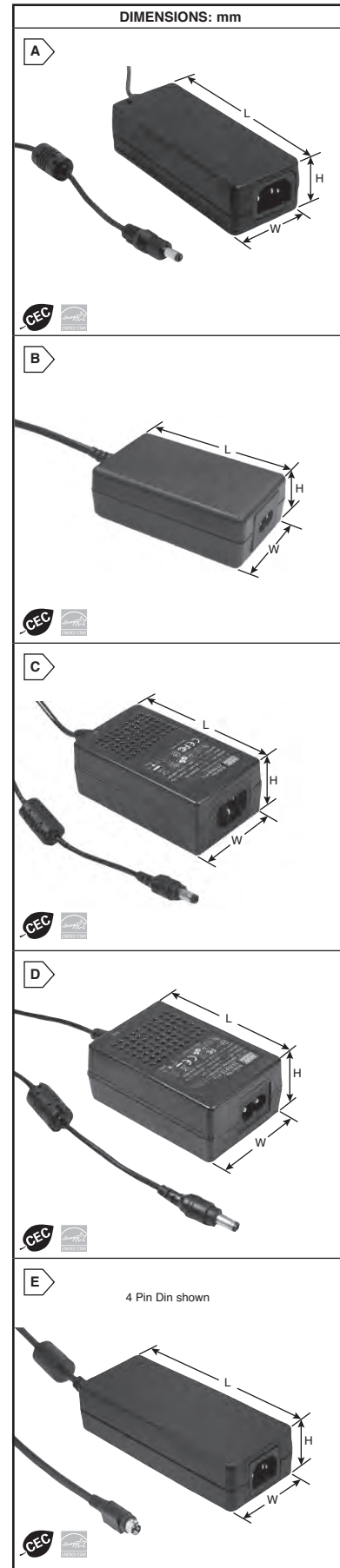

AC Adapters Mean Well

