

ADDA DC Brushless Fans



This product is RoHS compliant.



ADDA DC BRUSHLESS FANS

Specifications:

- Frame housing and impeller; black PBT per UL94V-0, glass-filled
- Operating temperature: -10°C ~+75°C
- Life expectancy: 50,000 hours min. @ 25°C, relative humidity by 65%
- Lead wire termination
- Storage temperature: -40°C to +75°C
- Motor protection and polarity protection

Features:

- All products are tested to stringent 6-Sigma quality in addition to statistical process control
- ADDA also performs periodic audits on each product to ensure the best quality control

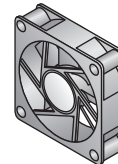

*Wire is at 12 o'clock position

**3rd wire speed sensor (tachometer)

† 3rd wire alarm

For quantities greater than listed, call for quote.

MOUSER STOCK NO.	ADDA Part No.	Dimmensions (mm)	Voltage (VDC)	Power (W)	Air Flow (CFM)	Noise (dBA)	Speed (RPM)	Price Each			
								1	10	25	50
Ball Bearing Type											
664-D2510LB-5VLF	AD0205LB-G50GL-LF	25x10	5	0.50	1.80	15.6	8000	16.18	15.33	14.48	14.06
664-D3010LB-12VLF	AD0312LB-G50-LF	30x10	12	0.72	2.10	20.2	8000	14.95	14.30	13.65	13.00
664-AD3505LB-G53-LF	AD3505LB-G53-LF	35x10	5	0.60	5.10	27.5	7000	18.75	14.25	12.00	10.50
664-AD3512HB-G50LF	AD3512HB-G50-LF	35x10	12	0.35	3.80	14.5	3300	16.88	15.00	13.50	12.75
664-AD0405DB-G70-LF	AD0405DB-G70-LF	40x10	5	0.40	3.80	14.5	3300	14.49	13.23	12.60	11.97
* 664-D4010LB-12VLF	AD0412LB-G70(T)-LF	40x10	12	0.84	4.70	14.0	4200	11.26	11.02	10.79	10.32
664-D4010MB-12V-LF	AD0412MB-G70-LF	40x10	12	0.96	5.70	20.0	4800	10.54	9.76	9.25	8.79
664-D4010HB-12VLF	AD0412HB-G70-LF	40x10	12	1.20	6.70	25.0	6000	10.78	9.99	9.46	8.99
664-AD0412HB-G76LF	AD0412HB-G76-LF	40x10	12	1.08	6.20	26.0	6000	18.75	18.52	18.30	17.78
664-AD0424MB-G70LF	AD0424MB-G70-LF	40x10	24	1.92	5.70	20.0	4800	14.36	14.06	13.76	13.16
664-AD0424HB-G76	AD0424HB-G76-LF	40x10	24	2.16	6.70	25.0	6000	13.85	13.00	12.35	11.70
664-D4015HB-12VLF	AD0412HB-D50-LF	40x15	12	1.44	9.20	39.3	8000	9.03	8.60	8.17	7.74
664-D4020HB-5VLF	AD0405HB-C50-LF	40x20	5	1.45	9.90	31.9	7800	13.07	12.45	11.83	11.20
664-D4020MB-12VLF	AD0412MB-C50-LF	40x20	12	0.96	8.50	28.5	6900	10.93	9.89	8.85	8.59
664-D4020HB-12VLF	AD0412HB-C50-LF	40x20	12	2.16	10.10	31.9	7800	11.46	10.48	9.35	9.19
** 664-AD0412HB-C56LF	AD0412HB-C56-LF	40x20	12	1.20	10.10	31.9	7800	13.23	12.65	12.08	11.50
664-D0424HB-C50-LF	AD0424HB-C50-LF	40x20	24	1.20	10.10	31.9	7800	12.11	11.59	11.06	10.53
664-AD0412HB-B33-LF	AD0412HB-B33-LF	40x28	12	1.92	12.20	39.0	9000	12.08	11.55	8.92	8.40
664-D5215HB1-12VLF	AD5012HB-D71-LF	50x15	12	1.20	12.00	28.7	4600	12.51	11.69	10.85	10.01
664-D5215HB1-24VLF	AD5024HB-D71-LF	50x15	24	1.92	12.00	28.7	4600	12.58	11.66	11.04	10.49
664-D5210MB-5VLF	AD0505MB-G70-LF	52x10	5	0.90	9.00	24.0	4300	12.67	12.12	11.02	10.47
664-AD0512LB-G70LF	AD0512LB-G70-LF	52x10	12	0.72	9.40	20.0	3900	13.85	13.00	12.35	11.70
664-AD0512HB-G70LF	AD0512HB-G70-LF	52x10	12	1.08	11.20	26.0	5000	11.27	10.78	10.29	9.80
* 664-D0524HBG70(T)LF	AD0524HB-G70(T)-LF	52x10	24	1.56	11.20	26.0	5000	13.08	10.74	10.07	9.12
664-D6010HB-G70LF	AD0612HB-G70-LF	60x10	12	1.68	16.60	32.8	4200	13.14	12.86	12.57	11.43
664-D0605HBD73GLLF	AD0605HB-D73GL-LF	60x15	5	1.10	16.60	33.4	4500	10.45	10.15	9.85	9.55
† 664-D612LB-D72GL-LF	AD0612LB-D72GL-LF	60x15	12	1.08	12.62	25.3	3500	12.50	11.58	10.97	10.42
664-D6015HB1-12V-LF	AD0612HB-D71GL-LF	60x15	12	1.56	15.82	32.4	4500	11.70	11.36	11.03	10.69
664-D6020HB1-24LF	AD0624HB-C71GL-LF	60x20	24	2.16	16.31	29.7	4500	10.91	10.37	9.83	9.28
† 664-AD0605LB-A72GLLF	AD0605LB-A72GL-LF	60x25	5	1.10	13.20	16.1	2500	14.95	14.30	13.65	13.00
664-D0612LB-A70GLLF	AD0612LB-A70GL-LF	60x25	12	0.50	13.20	18.1	2500	15.00	14.00	13.00	12.00
664-D0625MB-12VLF	AD0612MB-A70GL-LF	60x25	12	1.68	18.00	24.0	3500	7.39	6.66	6.47	6.10
664-D0625HB-12VLF	AD0612HB-A70GL-LF	60x25	12	2.76	23.98	32.3	4500	11.02	9.92	9.64	9.09
† 664-AD0612HBA72GL-LF	AD0612HB-A72GL-LF	60x25	12	2.76	24.78	35.2	4600	15.46	14.64	13.74	13.40
664-D0625UB1-12VLF	AD0612UB-A71GL-LF	60x25	12	3.24	28.30	37.0	5300	10.39	9.85	9.29	8.75
664-D0625HB-24VLF	AD0624HB-A70GL-LF	60x25	24	3.60	23.98	32.3	4500	11.44	10.84	10.23	9.63
† 664-D0624HBA72GLLF	AD0624HB-A72GL-LF	60x25	24	3.60	23.20	32.3	4500	17.23	15.87	12.38	11.21
664-AD0712MBA73GL-LF	AD0712MB-A73GL-LF	70x25	12	1.80	31.00	32.0	3800	12.65	12.00	11.40	10.80
664-D0812LB-12V-LF	AD0812LB-D70-LF	80x15	12	0.72	20.00	19.6	2000	14.85	9.90	8.66	7.92
664-D8015HB1-24VLF	AD0824HB-D71-LF	80x15	24	3.12	32.00	33.6	3200	13.99	13.30	12.60	11.90
664-D8020HB-12VLF	AD0812HB-C70-LF	80x20	12	2.88	29.08	32.4	3100	10.04	9.54	9.03	8.54
664-D8025LB-12VLF	AD0812LB-A70GL-LF	80x25	12	1.44	28.10	28.0	2100	12.14	11.16	10.33	9.61
664-D8025MB-12VLF	AD0812MB-A70GL-LF	80x25	12	1.80	33.50	28.3	2500	12.14	11.16	10.33	9.61
664-AD0812MB-A76LF	AD0812MB-A76GL-LF	80x25	12	1.80	31.40	28.3	2440	11.15	8.73	8.48	7.99
664-D8025HB-12VLF	AD0812HB-A70GL-LF	80x25	12	3.00	40.80	34.4	3000	14.51	11.35	11.05	10.41
664-AD0812UB-A73GLLF	AD0812UB-A73GL-LF	80x25	12	3.60	52.49	41.0	3900	11.25	10.00	8.75	8.00
664-D8025LB-24V-LF	AD0824LB-A70GL-LF	80x25	24	2.16	26.20	22.5	2100	12.32	9.64	9.38	8.84
664-D8025HB-24LF	AD0824HB-A70GL-LF	80x25	24	3.84	38.99	35.0	3100	12.32	9.64	9.38	8.84
† 664-D9225LB-A72GL-LF	AD0912LB-A72GL-LF	92x25	12	1.56	36.00	25.0	2000	17.77	15.99	15.65	14.36
664-D9225HB-12VLF	AD0912HB-A70GL-LF	92x25	12	3.00	49.30	35.0	2900	8.26	8.04	7.72	7.43
664-D0912HBA73GLLF	AD0912HB-A73GL-LF	92x25	12	2.88	52.50	35.0	2900	13.25	11.70	10.24	9.36
664-AD0912HB-A76GL	AD0912HB-A76GL-LF	92x25	12	2.88	52.50	35.0	2900	13.85	13.00	12.35	11.70
664-D9225UB12V-LF	AD0912UB-A71GL-LF	92x25	12	4.68	60.00	39.4	3300	10.98	9.88	9.66	8.78
664-D9225HB-24LF	AD0924HB-A70GL-LF	92x25	24	3.60	49.30	35.0	2900	13.77	12.40	12.12	11.02
664-AD0924UB-A71GLLF	AD0924UB-A71GL-LF	92x25	24	3.84	60.00	39.4	3300	16.17	14.52	14.19	12.87
664-D12025LB1-12VLF	AD1212LB-A71GL-LF	120x25	12	2.88	72.00	34.4	1800	19.22	18.39	16.72	15.46
664-D12025HB1-12VLF	AD1212HB-A71GL-LF	120x25	12	4.44	88.70	39.1	2200	17.47	16.71	15.20	14.05
664-AD1212HBA73GL-LF	AD1212HB-A73GL-LF	120x25	12	4.40	88.71	39.1	2200	17.95	17.18	15.62	14.45
664-AD1212UBA73GL-LF	AD1212UB-A73GL-LF	120x25	12	6.00	98.60	43.3	2500	20.68	19.30	17.92	16.54
664-D12025HB-12VLF	AD1212HB-Y53-LF	120x32	12	4.80	108.00	43.3	2750	24.00	20.00	17.00	14.00
664-D12038MB1-12VLF	AD1212MB-F51-LF	120x38	12	4.20	94.00	41.0	2540	22.53	21.55	19.59	18.12
664-D12038HB1-24LF	AD1224HB-F51-LF	120x38	24	7.68	104.80	42.8	2800	23.70	22.67	20.61	19.06
664-AD1224UB-F51-LF	AD1224UB-F51-LF	120x38	24	9.60	120.24	48.0	3200	18.97	16.50	14.85	14.19
† 664-AD1224UBF52-LF	AD1224UB-F52-LF	120x38	24	9.60	122.00	48.0	3200	16.86	14.66	12.83	11.73
One Ball/One Sleeve Bearing Type											
664-D2506MB-12VLF	AD0212MB-K50(S)-LF	25x6	12	0.84	2.20	26.0	12000	18.95	18.49	17.66	16.45
664-AD0312HBG50(S)LF	AD0312HB-G50(S)-LF	30x10	12	1.32	4.20	30.7	10500	14.95	14.30	13.65	13.00
664-D3506LB-12VLF	AD3512LB-K70(S)-LF	35x6	12	0.60	3.50	19.0	6500	17.50	16.63	15.61	14.63
Sleeve Bearing Type											
664-D4010MS-12VLF	AD0412MS-G70-LF	40x10	12	0.96	5.70	20.0	4800	14.25	11.40	9.99	8.55
664-AD0405DS-C50-LF	AD0405DS-C50-LF	40x20	5	0.60	4.70	14.0	3700	10.35	9.45	9.00	8.55
664-D5210MS12V-LF	AD0512MS-G70-LF	50x10	12	0.96	8.50	24.9	3300	12.04	11.51	11.00	10.46
664-D6015MS-12V-LF	AD0612MS-D70GL-LF	60x15	12	1.32	14.20	28.8	2900	10.47	10.01	9.56	9.10
664-D6020LS-12VLF	AD0612LS-C70GL-LF	60x20	12	0.96	13.30	21.6	3500	7.84	7.57	7.30	6.76
664-D6020HS-12VLF	AD0612HS-C70GL-LF	60x20	12	1.92	16.40	29.7	4500	7.84	7.57	7.30	6.76
664-D6025HS-12VLF	AD0612HS-A70GL-LF	60x25	12	2.76	23.20	32.3	4500	8.31	7.93	7.55	7.18
664-AD0712HSD71LF	AD0712HS-D71-LF	70x15	12	2.76	33.65	39.4	4000	12.78	12.00	11.70	11.10
664-AD0812HS-D70LF	AD0812HS-D70-LF	80x15	12	2.16	30.26	33.4	3200	13.50	13.05	12.60	12.15
664-D8025MS-12VLF	AD0812MS-A70GL-LF</										