

# PANASONIC PhotoMos Relays



This product is RoHS compliant.

Panasonic PhotoMOS™ relays offer high reliability with stable performance. Fast switching speed, low capacitance and small package size ensure that PhotoMOS relays meet the requirements of high performance switching applications, such as ATE, Instrumentation and Medical equipment.



RoHS Compliant

## AQW614 EH SERIES

- 60V type couples high capacity (0.5A) with low ON resistance (1Ω)
- Reinforced insulation 5,000V type
- Controls low-level analog signals
- Low-level off-state leakage current
- High sensitivity, high speed response

For quantities greater than listed, call for quote.

| MOUSER STOCK NO.         | Panasonic Part No. | Package Style | Current Rating (mA) | Max. Load Voltage (V) | Contact Arrangement | Price Each |      |      |      |
|--------------------------|--------------------|---------------|---------------------|-----------------------|---------------------|------------|------|------|------|
|                          |                    |               |                     |                       |                     | 1          | 25   | 50   | 100  |
| <b>Through-Hole Type</b> |                    |               |                     |                       |                     |            |      |      |      |
| 769-AQW610EH             | AQW610EH           | DIP-8         | 120                 | 350                   | 1 Form A/1 Form B   | 6.52       | 5.90 | 5.25 | 4.57 |
| 769-AQW612EH             | AQW612EH           | DIP-8         | 500                 | 60                    | 1 Form A/1 Form B   | 9.20       | 8.46 | 7.52 | 6.38 |
| 769-AQW614EH             | AQW614EH           | DIP-8         | 100                 | 400                   | 1 Form A/1 Form B   | 6.58       | 6.03 | 5.38 | 4.57 |
| <b>SMD Type</b>          |                    |               |                     |                       |                     |            |      |      |      |
| 769-AQW614EHA            | AQW614EHA          | SMD-8         | 100                 | 400                   | 1 Form A/1 Form B   | 6.71       | 6.16 | 5.48 | 4.77 |
| 769-AQW610EHA            | AQW610EHA          | SMD-8         | 120                 | 350                   | 1 Form A/1 Form B   | 6.59       | 6.05 | 5.38 | 4.57 |

## AQW61 S SERIES

- 2 channels in super miniature design
- Controls low-level analog signals
- Low-level off-state leakage current
- 60V type couples high capacity (0.45A) with low ON resistance (1Ω)



RoHS Compliant

For quantities greater than listed, call for quote.

| MOUSER STOCK NO. | Panasonic Part No. | Package Style | Current Rating (mA) | Max. Load Voltage (V) | Contact Arrangement | Price Each |      |      |      |
|------------------|--------------------|---------------|---------------------|-----------------------|---------------------|------------|------|------|------|
|                  |                    |               |                     |                       |                     | 1          | 25   | 50   | 100  |
| 769-AQW610S      | AQW610S            | SMD-8         | 100                 | 350                   | 1 Form A/1 Form B   | 9.86       | 9.06 | 8.06 | 6.84 |

## AQV10 AND AQV20 SERIES

- Controls low-level analog signals
- Controlled with low-level input signals
- Low-level off state leakage current
- Optical coupling for extremely high isolation
- Stable ON resistance
- Low-level thermal electromotive force (Approx. 1μV)



RoHS Compliant

For quantities greater than listed, call for quote.

| MOUSER STOCK NO.         | Panasonic Part No. | Package Style | Current Rating (mA) | Max. Load Voltage (V) | Contact Arrangement | Price Each |      |      |      |
|--------------------------|--------------------|---------------|---------------------|-----------------------|---------------------|------------|------|------|------|
|                          |                    |               |                     |                       |                     | 1          | 25   | 50   | 100  |
| <b>Through-Hole Type</b> |                    |               |                     |                       |                     |            |      |      |      |
| 769-AQV101               | AQV101             | DIP-6         | 700                 | 40                    | 1 Form A            | 5.94       | 5.45 | 4.85 | 4.53 |
| 769-AQV102               | AQV102             | DIP-6         | 600                 | 60                    | 1 Form A            | 5.94       | 5.45 | 4.85 | 4.53 |
| 769-AQV201               | AQV201             | DIP-6         | 500                 | 40                    | 1 Form A            | 7.83       | 7.47 | 6.65 | 5.78 |
| 769-AQV202               | AQV202             | DIP-6         | 400                 | 250                   | 1 Form A            | 7.27       | 6.68 | 5.80 | 5.04 |
| <b>SMD Type</b>          |                    |               |                     |                       |                     |            |      |      |      |
| 769-AQV102A              | AQV102A            | SMD-6         | 600                 | 60                    | 1 Form A            | 7.41       | 6.81 | 6.06 | 5.14 |
| 769-AQV201A              | AQV201A            | SMD-6         | 500                 | 40                    | 1 Form A            | 8.34       | 7.66 | 6.82 | 5.78 |
| 769-AQV202A              | AQV202A            | SMD-6         | 400                 | 60                    | 1 Form A            | 8.33       | 7.63 | 6.82 | 5.78 |

## AQV21 AND AQV214H SERIES

- Controls low-level analog signals
- Controlled with low-level input signals
- Optical coupling for extremely high isolation
- Stable ON resistance
- Low-level thermal electromotive force (Approx. 1μV)



RoHS Compliant

For quantities greater than listed, call for quote.

| MOUSER STOCK NO.         | Panasonic Part No. | Package Style | Current Rating (mA) | Max. Load Voltage (V) | Contact Arrangement | Price Each |      |      |      |
|--------------------------|--------------------|---------------|---------------------|-----------------------|---------------------|------------|------|------|------|
|                          |                    |               |                     |                       |                     | 1          | 25   | 50   | 100  |
| <b>Through-Hole Type</b> |                    |               |                     |                       |                     |            |      |      |      |
| 769-AQV212               | AQV212             | DIP-6         | 400                 | 60                    | 1 Form A            | 3.73       | 3.60 | 3.35 | 3.14 |
| 769-AQV214               | AQV214             | DIP-6         | 120                 | 400                   | 1 Form A            | 5.07       | 4.65 | 4.14 | 3.51 |
| 769-AQV216               | AQV216             | DIP-6         | 40                  | 600                   | 1 Form A            | 4.60       | 4.21 | 3.76 | 3.19 |
| 769-AQV214H              | AQV214H            | DIP-6         | 120                 | 400                   | 1 Form A            | 4.92       | 4.50 | 4.01 | 3.77 |
| <b>SMD Type</b>          |                    |               |                     |                       |                     |            |      |      |      |
| 769-AQV212A              | AQV212A            | SMD-6         | 400                 | 60                    | 1 Form A            | 4.41       | 4.05 | 3.51 | 3.06 |
| 769-AQV214A              | AQV214A            | SMD-6         | 120                 | 400                   | 1 Form A            | 4.40       | 4.03 | 3.60 | 3.06 |
| 769-AQV210A              | AQV210A            | SMD-6         | 120                 | 350                   | 2 Form A            | 8.49       | 7.60 | 6.76 | 5.89 |

## AQV21 E AND EH SERIES

- Controls low-level analog signals
- Controlled with low-level input signals
- Optical coupling for extremely high isolation
- Stable ON resistance
- Low-level off state leakage current
- Low-level thermal electromotive force (Approx. 1μV)



RoHS Compliant

For quantities greater than listed, call for quote.

| MOUSER STOCK NO.         | Panasonic Part No. | Package Style | Current Rating (mA) | Max. Load Voltage (V) | Contact Arrangement | Price Each |      |      |      |
|--------------------------|--------------------|---------------|---------------------|-----------------------|---------------------|------------|------|------|------|
|                          |                    |               |                     |                       |                     | 1          | 25   | 50   | 100  |
| <b>Through-Hole Type</b> |                    |               |                     |                       |                     |            |      |      |      |
| 769-AQV210E              | AQV210E            | DIP-6         | 130                 | 350                   | 1 Form A            | 2.59       | 2.51 | 2.43 | 2.30 |
| 769-AQV214E              | AQV214E            | DIP-6         | 120                 | 400                   | 1 Form A            | 2.77       | 2.54 | 2.26 | 2.17 |
| 769-AQV210EH             | AQV210EH           | DIP-6         | 130                 | 350                   | 1 Form A            | 2.99       | 2.74 | 2.44 | 2.34 |
| 769-AQV214EH             | AQV214EH           | DIP-6         | 120                 | 400                   | 1 Form A            | 2.80       | 2.74 | 2.44 | 2.38 |
| <b>SMD Type</b>          |                    |               |                     |                       |                     |            |      |      |      |
| 769-AQV210EA             | AQV210EA           | SMD-6         | 130                 | 350                   | 1 Form A            | 2.79       | 2.56 | 2.28 | 2.20 |
| 769-AQV214EA             | AQV214EA           | SMD-6         | 120                 | 400                   | 1 Form A            | 2.79       | 2.56 | 2.28 | 2.20 |
| 769-AQV210EHA            | AQV210EHA          | SMD-6         | 130                 | 350                   | 1 Form A            | 3.06       | 2.82 | 2.50 | 2.40 |
| 769-AQV214EHA            | AQV214EHA          | SMD-6         | 120                 | 400                   | 1 Form A            | 3.06       | 2.81 | 2.50 | 2.40 |

## AQV21 S AND AQV22 NS SERIES

- 1 channel (Form A) in super miniature design
- Controls low-level analog signals
- Low-level off state leakage current



RoHS Compliant

For quantities greater than listed, call for quote.

| MOUSER STOCK NO.       | Panasonic Part No. | Package Style | Current Rating (mA) | Max. Load Voltage (V) | Contact Arrangement | Price Each |      |      |      |
|------------------------|--------------------|---------------|---------------------|-----------------------|---------------------|------------|------|------|------|
|                        |                    |               |                     |                       |                     | 1          | 25   | 50   | 100  |
| <b>AQV21 S Series</b>  |                    |               |                     |                       |                     |            |      |      |      |
| 769-AQV210S            | AQV210S            | SOP-6         | 120                 | 350                   | 1 Form A            | 5.36       | 4.80 | 4.27 | 3.71 |
| 769-AQV212S            | AQV212S            | SOP-6         | 350                 | 60                    | 1 Form A            | 4.68       | 4.29 | 3.82 | 3.24 |
| 769-AQV214S            | AQV214S            | SOP-6         | 100                 | 400                   | 1 Form A            | 5.36       | 4.91 | 4.38 | 3.71 |
| 769-AQV215S            | AQV215S            | SOP-6         | 900                 | 100                   | 1 Form A            | 4.67       | 4.28 | 3.82 | 3.24 |
| 769-AQV216S            | AQV216S            | SOP-6         | 40                  | 600                   | 1 Form A            | 5.36       | 4.91 | 4.38 | 3.71 |
| <b>AQV22 NS Series</b> |                    |               |                     |                       |                     |            |      |      |      |
| 769-AQV227NS           | AQV227NS           | SOP-6         | 50                  | 200                   | 1 Form B            | 6.21       | 5.68 | 5.08 | 4.30 |

# Panasonic

DIP-6

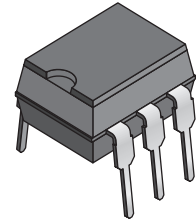

DIP-8

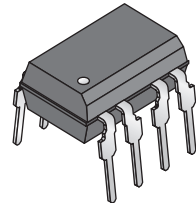

SMD-6

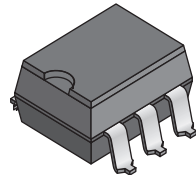

SMD-8

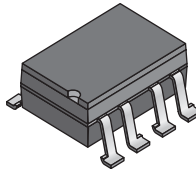

SOP-6

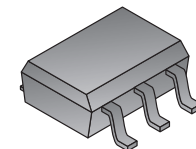

Panasonic Solid State Relays