

PANDUIT Terminals

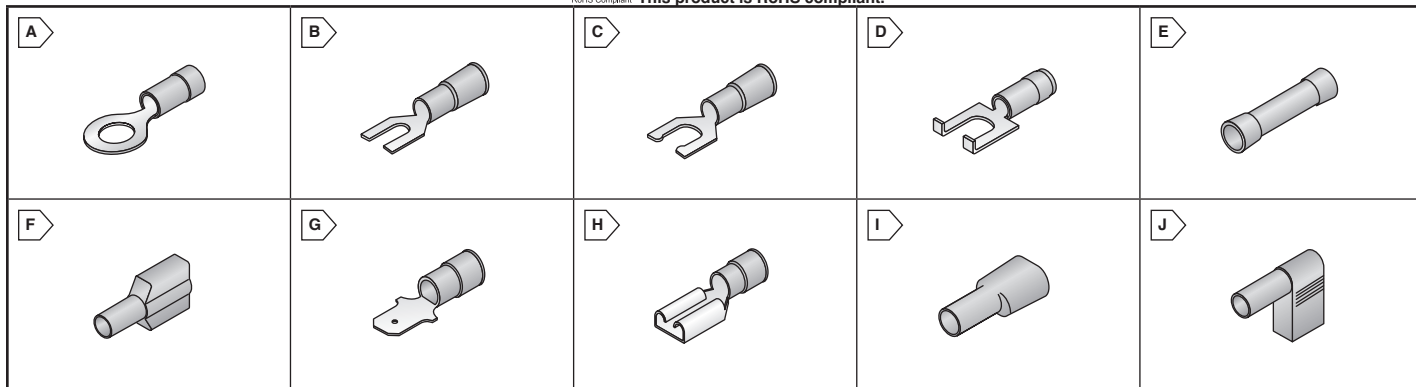

RoHS Compliant This product is RoHS compliant.



SOLDERLESS TERMINALS

- Price each is per terminal
- All terminals feature brazed seam construction

Stock No. Suffix Denotes Standard Package Quantity:
L = 50, C = 100, D = 500, M = 1000



RoHS Compliant



RoHS Compliant

For quantities greater than listed, call for quote.

MOUSER STOCK NO.	Fig.	Wire Size	Stud Size	Color	Price Each			
					1	100	500	1000
Vinyl Ring - Funnel Entry - Insulated								
644-PV18-6R-MY	A	22-18	6	Red	.82	.669	.507	.334
644-PV18-8R-MY	A	22-18	8	Red	.32	.291	.259	.237
644-PV18-4RX-MY	A	22-18	4	Red	.31	.28	.249	.218
644-PV18-6RX-MY	A	22-18	6	Red	.29	.237	.216	.205
644-PV18-8RX-MY	A	22-18	8	Red	.32	.291	.259	.237
644-PV18-10RX-MY	A	22-18	10	Red	.30	.269	.248	.215
644-PV14-6R-M	A	16-14	6	Blue	.25	.226	.205	.183
644-PV14-8R-M	A	16-14	8	Blue	.31	.28	.259	.226
644-PV14-10R-M	A	16-14	10	Blue	.30	.27	.24	.21
644-PV14-14R-M	A	16-14	1/4	Blue	.43	.388	.345	.313
644-PV14-4RX-C	A	16-14	4	Blue	.97	.886	.796	.718
644-PV14-6RX-M	A	16-14	6	Blue	.28	.25	.22	.19
644-PV14-8RX-M	A	16-14	8	Blue	.28	.25	.23	.20
644-PV14-10RX-M	A	16-14	10	Blue	.30	.27	.248	.216
644-PV14-14RX-M	A	16-14	1/4	Blue	.41	.367	.334	.302
644-PV10-8R-D	A	12-10	8	Yellow	.44	.393	.358	.337
644-PV10-10R-D	A	12-10	10	Yellow	.48	.43	.38	.33
644-PV10-14R-D	A	12-10	1/4	Yellow	.47	.432	.388	.345
644-PV10-6RX-L	A	12-10	6	Yellow	1.19	.971	.874	.659
644-PV10-8RX-L	A	12-10	8	Yellow	1.26	1.02	.92	.693
644-PV10-10RX-L	A	12-10	10	Yellow	1.09	.918	.842	.723
644-PV10-14RX-L	A	12-10	1/4	Yellow	1.32	1.04	.81	.788
Nylon Ring - Insulated								
644-PN18-14R-M	A	22-18	1/4	Red	.54	.475	.432	.388
644-PN18-4R-M	A	22-18	4	Red	.45	.41	.377	.345
644-PN18-10R-M	A	22-18	10	Red	1.24	.69	.485	.377
644-PN18-4RN-M	A	22-18	4	Red	.42	.377	.334	.302
644-PN18-6RN-M	A	22-18	6	Red	.42	.378	.334	.313
644-PN18-8R-M	A	22-18	8	Red	.42	.378	.334	.302
644-PN14-4R-M	A	16-14	4	Blue	.43	.388	.345	.313
644-PN14-56R-M	A	16-14	5/16	Blue	.52	.475	.421	.378
644-PN14-6R-M	A	16-14	6	Blue	.43	.388	.345	.313
644-PN14-8R-M	A	16-14	8	Blue	.42	.377	.334	.302
644-PN14-6RX-C	A	16-14	6	Blue	1.59	1.43	1.28	1.12
644-PN14-8RX-C	A	16-14	8	Blue	1.34	1.04	.842	.777
644-PN14-10RX-C	A	16-14	10	Blue	1.45	1.14	.907	.885
644-PN10-6R-D	A	12-10	6	Yellow	.52	.482	.426	.381
644-PN10-8R-L	A	12-10	8	Yellow	1.49	1.35	1.20	1.08
644-PN10-14R-L	A	12-10	1/4	Yellow	1.42	1.28	1.15	1.03
644-PN10-6RX-L	A	12-10	6	Yellow	2.04	1.57	1.25	1.13
644-PN10-8RX-L	A	12-10	8	Yellow	1.93	1.53	1.20	1.14
644-PN10-10RX-L	A	12-10	10	Yellow	1.91	1.52	1.19	1.10
644-PN10-56R-D	A	12-10	5/16	Yellow	.55	.496	.442	.399
644-PN10-38R-D	A	12-10	3/8	Yellow	.47	.421	.377	.345
Vinyl Fork - Insulated								
644-PV18-6F-MY	B	22-18	6	Red	.32	.27	.237	.216
644-PV18-8F-MY	B	22-18	8	Red	.32	.269	.237	.205
644-PV18-6FX-MY	B	22-18	6	Red	.29	.259	.237	.216
644-PV18-6FN-MY	B	22-18	6	Red	.27	.237	.205	.183
644-PV18-8FX-MY	B	22-18	8	Red	.29	.259	.237	.205
644-PV18-10F-M	B	22-18	10	Red	.35	.325	.291	.246
644-PV14-8F-M	B	16-14	8	Blue	.30	.269	.237	.205
644-PV14-10F-M	B	16-14	10	Blue	.76	.637	.497	.205
644-PV14-6FX-M	B	16-14	6	Blue	.25	.212	.207	.201
644-PV14-6FN-M	B	16-14	6	Blue	.25	.226	.205	.183
644-PV14-8FX-M	B	16-14	8	Blue	.30	.27	.237	.205

For quantities greater than listed, call for quote.

MOUSER STOCK NO.	Fig.	Wire Size	Stud Size	Color	Price Each			
					1	100	500	1000
Vinyl Fork (Cont.)								
644-PV14-10FX-M	B	16-14	10	Blue	.31	.279	.246	.235
644-PV14-14F-M	B	16-14	1/4	Blue	.36	.323	.291	.259
644-PV10-6F-D	B	12-10	6	Yellow	.44	.393	.358	.325
644-PV10-10F-D	B	12-10	10	Yellow	.65	.595	.527	.482
644-PV10-14F-D	B	12-10	1/4	Yellow	.49	.442	.399	.356
644-PV10-14FX-L	B	12-10	1/4	Yellow	1.32	1.04	.853	.763
Nylon Fork Insulated								
644-PNF18-6F-M	B	22-18	6	Red	.48	.45	.38	.35
644-PNF18-8F-M	B	22-18	8	Red	.49	.468	.395	.364
644-PNF18-10F-M	B	22-18	10	Red	.49	.468	.395	.364
644-PNF18-14F-C	B	22-18	1/4	Red	1.29	1.01	.81	.78
644-PNF14-6F-M	B	16-14	6	Blue	.49	.447	.405	.364
644-PNF14-8F-M	B	16-14	8	Blue	.45	.42	.38	.35
644-PNF14-10F-M	B	16-14	10	Blue	.49	.447	.405	.364
644-PNF10-6F-L	B	12-10	6	Yellow	1.55	1.21	.967	.915
644-PNF10-10F-L	B	12-10	10	Yellow	1.55	1.21	.967	.915
Vinyl Locking Fork								
644-PV18-6LF-MY	C	22-18	6	Red	.72	.62	.48	.31
Nylon Locking Fork								
644-PN18-8LF-M	C	22-18	8	Red	.53	.46	.403	.37
644-PN14-6LF-M	C	16-14	6	Blue	.45	.414	.37	.335
644-PN14-8LF-M	C	16-14	8	Blue	1.30	1.04	.842	.377
644-PN14-10LF-M	C	16-14	10	Blue	.43	.388	.345	.302
Vinyl Flanged Fork								
644-PN18-6LF-M	D	22-18	6	Red	.52	.475	.421	.377
644-PN18-8FF-M	D	22-18	8	Red	.51	.453	.41	.367
644-PN18-10FF-M	D	22-18	10	Red	.58	.538	.482	.437
644-PN14-6FF-M	D	16-14	6	Blue	.64	.583	.518	.464
Vinyl Flanged Fork								
644-PN14-8FF-M	D	16-14	8	Blue	.54	.486	.432	.388
Vinyl Butt Splice								
644-BSV18X-MY	E	22-18	---	Red	.44	.381	.358	.336
644-BSV14X-M	E	16-14	---	Blue	.38	.356	.334	.313
644-BSV10X-D	E	12-10	---	Yellow	.59	.527	.493	.448
Nylon Butt Splice								
644-BSN14-M	E	16-14	---	Blue	.43	.388	.345	.323
Disconnect (Male)								
644-DNF18-250FIM-M	F	22-18	.250x.032	Red	.61	.55	.496	.453
644-DNF18-250FIM-L	F	22-18	.250x.032	Red	1.24	1.12	1.00	.904
644-DNF14-250M-M	G	16-14	.250x.032	Blue	.67	.604	.542	.491
644-DV14-250B-M	G	16-14	.250x.032	Blue	.58	.539	.483	.448
644-DNF10-250M-D	G	12-10	.250x.032	Yellow	.65	.58	.52	.47
Disconnect (Female)								
644-DNF18-110-M	H	22-18	.110x.032	Red	.83	.751	.672	.616
644-DNF18-187-M	H	22-18	.187x.032	Red	.62	.561	.496	.453
644-DNF18-250-M	H	22-18	.250x.032	Red	.59	.518	.475	.453
644-DNF18-250FIB-M	I	22-18	.250x.032	Red	.70	.626	.561	.507
644-DNF14-110-M	H	16-14	.110x.032	Blue	.51	.464	.41	.367
644-DNF14-187-M	H	16-14	.187x.032	Blue	.46	.414	.381	.347
644-DNF14-250-M	H	16-14	.250x.032	Blue	1.23	.95	.745	.334
644-DV14-250B-M	H	16-14	.250x.032	Blue	.51	.453	.41	.367
644-DNF14-250FIB-M	I	16-14	.250x.032	Blue	1.12	.929	.799	.378
644-DNF10-250FI-D	I	12-10	.250x.032	Yellow	.66	.604	.54	.486
Right Angle Disconnect (Female) Tab Width								
644-DNFR14-250B-M	J	16-14	.250x.032	Blue	.56	.496	.475	.453

Terminals Panduit