

Test Points, Terminal Strips, and Terminal Blocks

KOBICONN TEST POINTS GLASS BEAD INSULATOR

Our PCB test point and terminals feature a large loop for easy probe attachment or to facilitate the clipping on of other components.

They are ideal for components which need frequent replacement and are also suitable for raising hot components above the surface of the PCB.

A glass bead in a choice of eight colors for identification purposes ensures a snug fit on the board. White, yellow, black, brown, blue, pink, red and green are available. Other colors available upon request.

The unique shape of the test point will not damage through-plated holes during assembly yet prevents any movement prior to soldering.

- Also ideal as terminals.
- Three sizes
 - Choice of eight colors



RoHS Compliant

DIMENSIONS: in.	
.040" Mounting Hole	.052" Mounting Hole
A= .120-.130	A= .112-.122
B= .051-.059	B= .080-.085
C= .087-.097	C= .113-.123
D= .042-.052	D= .059-.069
E= .020	E= .032
F= .109	F= .109
	F= .141*

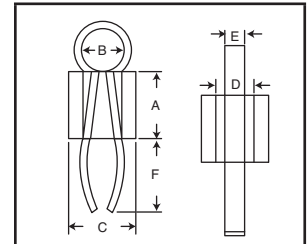

† Note: Coefficient of expansion is quoted for the range of 50°C to 300°C.

Material:

Bead: boro silicate sintered glass
Tag: phosphor bronze B5384 solder tinned

Price Each					
1	100	500	1000	5000	10000
.30	.198	.152	.132	.119	.107

Glass Bead				
† Coeff.	Density	Viscosity Poise °C	Log (OHM. CM)	Dielectric Properties
Term. Expn x10 ⁻⁶ /°C	g/cc	14.6 13 7.6	TR. DC. Resistivity	at 1MHZ at 20°C
4.94	2.27	10 10 10	100 250°C 350°C	Const Loss Angle
		475 515 719	365 10.01 8.2	5.7 0.003

MOUSER STOCK NO.	Board Thickness (In.)	Mounting Hole (In.)	MOUSER STOCK NO.	Board Thickness (In.)	Mounting Hole (In.)	MOUSER STOCK NO.	Board Thickness (In.)	Mounting Hole (In.)	Color
151-201-RC	1/16	.040	151-101-RC	1/16	.052	151-301-RC	3/32	.052	White
151-202-RC	1/16	.040	151-102-RC	1/16	.052	151-302-RC	3/32	.052	Yellow
151-203-RC	1/16	.040	151-103-RC	1/16	.052	151-303-RC	3/32	.052	Black
151-204-RC	1/16	.040	151-104-RC	1/16	.052	151-304-RC	3/32	.052	Brown
151-205-RC	1/16	.040	151-105-RC	1/16	.052	151-305-RC	3/32	.052	Blue
151-206-RC	1/16	.040	151-106-RC	1/16	.052	151-306-RC	3/32	.052	Pink
151-207-RC	1/16	.040	151-107-RC	1/16	.052	151-307-RC	3/32	.052	Red
151-208-RC	1/16	.040	151-108-RC	1/16	.052	151-308-RC	3/32	.052	Green

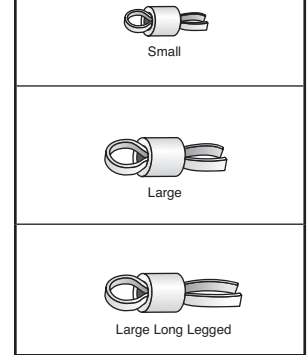

Terminals

KOBICONN TERMINAL STRIPS

- Lug: tin plated
- Strip: phenolic .375"x.062"
- Mount: for #6 screw

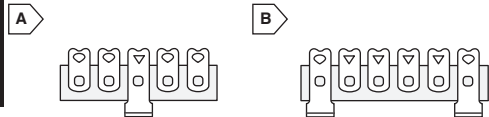

For quantities greater than listed, call for quote.

MOUSER STOCK NO.	Fig.	Description	Price Each		
			1	10	100
158-1002	A	2 lugs	.41	.31	.28
158-1003	A	3 lugs	.59	.45	.41
158-1004	A	4 lugs	1.00	.76	.69
158-1005	A	5 lugs	1.15	.82	.74
158-1006	B	6 lugs	1.31	1.01	.92
158-1008	B	8 lugs	1.75	1.34	1.22

MILL-MAX SMT PINS/TEST POINTS

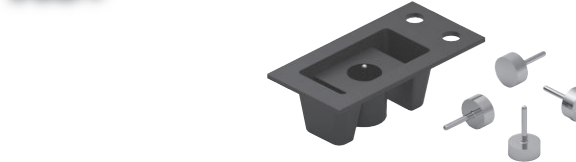

NEW PRODUCT



RoHS Compliant

Loose Piece

For quantities greater than listed, call for quote.

MOUSER STOCK NO.	Mill-Max Part No.	Plating	Tail/Pin Dia. In.(mm)	Price Each			
				1	10	100	200
575-1508000150000030	1508-0-00-15-00-00-03-0	10 μ" Gold over Nickel	.018 (.46)	.14	.13	.124	.119
Reels - reel qty 1600				Price Per Piece			
575-1508057150000030	1508-0-57-15-00-00-03-0	10 μ" Gold over Nickel	.018 (.46)	.062			

KOBICONN FAHNESTOCK CLIPS

- Features:
- Quick connect/disconnect
 - Wire clip
 - Battery clip
 - Terminal/connector
 - Nickel plated, spring brass



For quantities greater than listed, call for quote.

MOUSER STOCK NO.	Screw Size	W x L (In.)	Price Each			
			1	100	1000	5000
524-11-4034C	6	5/16 x 3/4	.35	.32	.29	.26

KOBICONN COMPRESSION TERMINAL BLOCKS

Quick connect terminals. Ideal for speaker systems and other audio or low voltage applications. These terminal blocks firmly grasp stripped wire. Color coded (black and red)

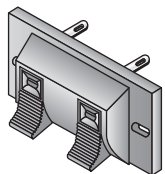

RoHS Compliant

For quantities greater than listed, call for quote.

MOUSER STOCK NO.	Position	Price Each			
		1	10	100	500
151-R225-E	2	1.76	1.24	1.13	1.03
151-R242-E	4	2.54	1.79	1.63	1.48

KOBICONN COMPRESSION TERMINALS

Printed circuit terminals. Ideal for speaker systems and other audio or low voltage applications. These terminal blocks firmly grasp stripped wire. Buttons are color coded black and red.



RoHS Compliant

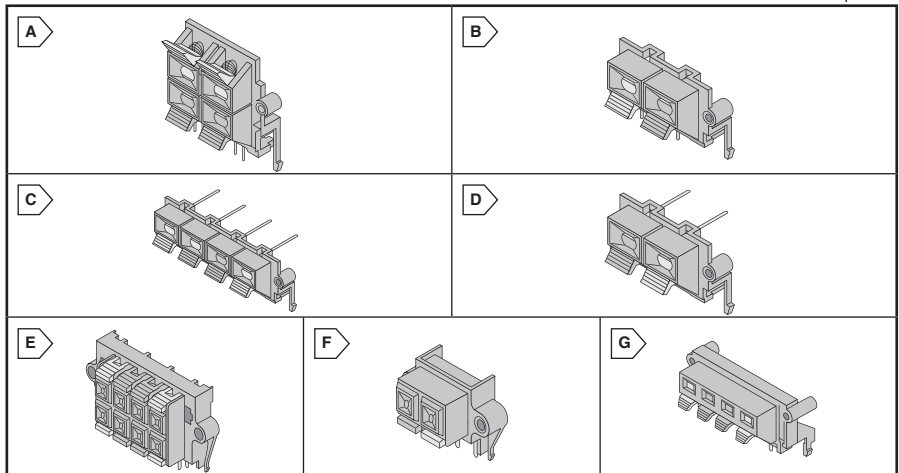

For quantities greater than listed, call for quote.

MOUSER STOCK NO.	Fig.	Position	Price Each			
			1	10	100	500
151-CJ9007-E	A	4	1.18	.91	.70	.63
151-CJ9008-E	B	2	.86	.66	.51	.39
151-CJ9012-E	C	4	1.31	1.01	.78	.60
151-CJ9018-E	D	2	.86	.66	.51	.39

For quantities greater than listed, call for quote.

MOUSER STOCK NO.	Fig.	Position	Price Each			
			1	10	100	500
151CJ9019-E	E	8	1.98	1.52	1.17	1.00
151-CJ9021-E	F	2	.86	.66	.51	.39
151-CJ9028-E	G	4	1.39	1.07	.82	.63