

VCC LED Assemblies and Mounting Components

OPTOELECTRONICS

VCC LED Indication

PRE-WIRED SOLDERLESS LED INTERCONNECTIONS

Material Specifications:

- Panel connector socket and ring: thermoplastic
- Header connector: thermoplastic (UL Listed materials)
- Terminals: phosphor bronze, tin plated
- Wire: 24AWG, 7 strand copper, insulated
- For **Locking Header** use Mouser Stock No.: 538-22-23-2021
- For **Plain Header** use Mouser Stock No.: 538-22-03-2021

Electrical Specifications:

- Terminal: 3A continuous service
- Unique three-finger design mates to round, square, or rectangular leads .017" to .025"

This product is RoHS compliant.

Insert LED into connector. Install lens in panel opening. Press connector and lens together.

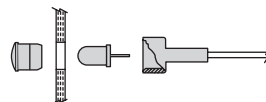

PANEL MOUNT

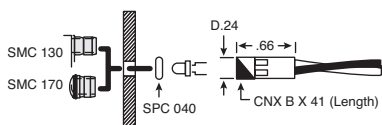

3mm Bi-Lead LED

For quantities greater than listed, call for quote.

MOUSER STOCK NO.	Length: in.	Price Each			
		1	10	100	500
.025" Header Post					
593-CNXBE4104	4	1.88	1.73	1.58	1.43
593-CNXBE4108	8	1.88	1.73	1.58	1.43
593-CNXBE4112	12	2.02	1.86	1.69	1.53
593-CNXBE4118	18	2.16	1.98	1.81	1.64
593-CNXBE4124	24	2.30	2.11	1.93	1.75
Stripped Ends					
593-CNXBX4104	4	1.27	1.17	1.06	.96
593-CNXBX4108	8	1.27	1.17	1.06	.96
593-CNXBX4112	12	1.41	1.29	1.18	1.07
593-CNXBX4118	18	1.55	1.42	1.30	1.18
593-CNXBX4124	24	1.69	1.55	1.42	1.28

PANEL MOUNT

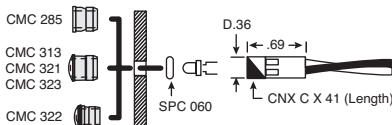

5mm Bi-Lead LED

For quantities greater than listed, call for quote.

MOUSER STOCK NO.	Length: in.	Price Each			
		1	10	100	500
.025" Header Post					
593-CNXCE4104	4	1.88	1.73	1.58	1.43
593-CNXCE4108	8	1.88	1.73	1.58	1.43
593-CNXCE4112	12	2.02	1.86	1.69	1.53
593-CNXCE4118	18	2.16	1.98	1.81	1.64
593-CNXCE4124	24	2.30	2.11	1.93	1.75
Stripped Ends					
593-CNXC4104	4	1.27	1.17	1.06	.96
593-CNXC4108	8	1.27	1.17	1.06	.96
593-CNXC4112	12	1.41	1.29	1.18	1.07
593-CNXC4118	18	1.55	1.42	1.30	1.18
593-CNXC4124	24	1.69	1.55	1.42	1.28

PANEL MOUNT

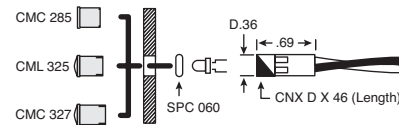

5mm Tri-Lead LED

For quantities greater than listed, call for quote.

MOUSER STOCK NO.	Length: in.	Price Each			
		1	10	100	500
.025" Header Post					
593-CNXDF4608	8	2.67	2.46	2.24	2.03
593-CNXDF4612	12	2.96	2.72	2.48	2.25
593-CNXDF4624	24	3.38	3.11	2.84	2.57
Stripped Ends					
593-CNXDX4608	8	1.74	1.60	1.46	1.32
593-CNXDX4618	18	2.25	2.07	1.89	1.71
593-CNXDX4624	24	2.44	2.24	2.05	1.85

LOW PROFILE PANEL MOUNTS AND LENS FOR PBC MOUNTED LEDS

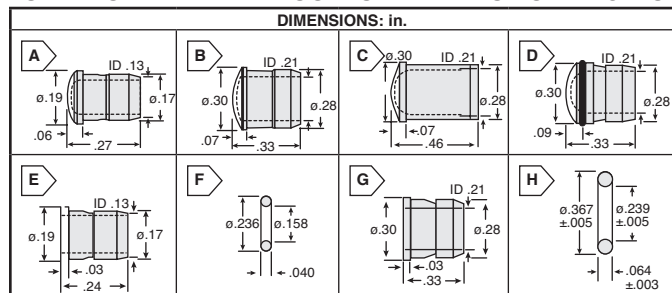

Low Profile Diffused Lens

For quantities greater than listed, call for quote.

MOUSER STOCK NO.	VCC Part No.	Fig.	Lens Color	Price Each			
				1	10	100	500
T1-3/4 (5mm), Mounting Hole 0.281"							
593-3130RTP	CMC313RTP	D	Red	.31	.26	.24	.19
593-3130ATP	CMC313ATP	D	Amber	.31	.27	.25	.19
593-3130YTP	CMC313YTP	D	Yellow	.31	.27	.25	.19
593-3130GTP	CMC313GTP	D	Green	.31	.26	.24	.19
593-3130BTP	CMC313BTP	D	Blue	.31	.26	.24	.19
593-3130CTP	CMC313CTP	D	Clear	.31	.26	.24	.19
T1-3/4 (5mm), Moisture Seal, Mounting Hole 0.281"							
593-3220R	CMS322RTP	D	Red	.84	.77	.69	.56
593-3220A	CMS322ATP	D	Amber	.84	.77	.69	.56
593-3220Y	CMS322YTP	D	Yellow	.84	.77	.69	.56
593-3220G	CMS322GTP	D	Green	.84	.77	.69	.56
593-3220B	CMS322BTP	D	Blue	.84	.77	.69	.56
593-3220C	CMS322CTP	D	Clear	.84	.77	.69	.56

Low Profile Fresnel Lens

For quantities greater than listed, call for quote.

MOUSER STOCK NO.	VCC Part No.	Fig.	Length: in.	Color	Price Each			
					1	10	100	500
T1 (3mm), Mounting Hole 0.171"								
593-1700R	SMC170RTP	A	Red	.28	.24	.22	.17	
593-1700A	SMC170ATP	A	Amber	.28	.24	.22	.17	
593-1700Y	SMC170YTP	A	Yellow	.28	.25	.23	.17	
593-1700G	SMC170GTP	A	Green	.28	.25	.23	.17	
593-1700B	SMC170BTP	A	Blue	.28	.25	.23	.17	
593-1700C	SMC170CTP	A	Clear	.28	.24	.22	.17	
T1-3/4 (5mm), Mounting Hole 0.281"								
593-3210R	CMC321RTP	B	Red	.31	.26	.24	.19	
593-3210A	CMC321ATP	B	Amber	.31	.26	.24	.19	
593-3210Y	CMC321YTP	B	Yellow	.31	.26	.24	.19	
593-3210G	CMC321GTP	B	Green	.31	.26	.24	.19	
593-3210B	CMC321BTP	B	Blue	.31	.26	.24	.19	
593-3210C	CMC321CTP	B	Clear	.31	.27	.25	.19	
593-3250C	CML325CTP	C	Clear	.31	.27	.25	.19	

Low Profile Plain End Lens

For quantities greater than listed, call for quote.

MOUSER STOCK NO.	VCC Part No.	Fig.	Description	Price Each			
				1	10	100	500
T1-3/4 (5mm), Mounting Hole 0.281"							
593-3230C	CMC323CTP	B	Clear	.31	.26	.24	.19
593-3270C	CML327CTP	C	Clear	.31	.26	.24	.19

Mounts and Spacers

For quantities greater than listed, call for quote.

MOUSER STOCK NO.	VCC Part No.	Fig.	Description	Price Each			
				1	10	100	500
3mm							
593-SMC130CTP	SMC130CTP	E	T1 Clear	.20	.17	.15	.12
593-SMC130BLK	SMC130BLK	F	T1 Black	.15	.13	.12	.09
593-SPC040	SPC040	F	T1 Spacer	.11	.09	.08	.07
5mm							
593-CMC285CTP	CMC285CTP	G	T1-3/4 Clear	.24	.21	.19	.15
593-CMC285BLK	CMC285BLK	G	T1-3/4 Black	.21	.18	.16	.13
593-SPC060	SPC060	H	T1-3/4 Spacer	.11	.09	.08	.07

SOLDERLESS LED CONNECTORS

1/4W Current limiting resistor built into the natural polypropylene housing. 1/2W Resistor can be built upon request. Terminals are phosphor bronze, tin plated.

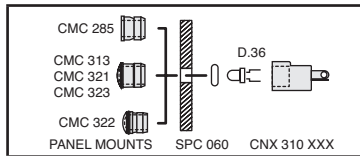
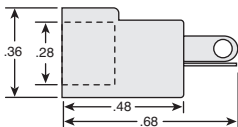

MOUSER STOCK NO.	Resistance Value (Ω)	Price Each			
		1	10	100	500
593-CNX310000	No resistor	.60	.52	.47	.37
593-CNX310033	330	.98	.84	.75	.60
593-CNX310056	560	.98	.84	.75	.60
593-CNX310120	1.2K	.98	.84	.75	.60
593-CNX310220	2.2K	.98	.84	.75	.60

MOISTURE SEALED LENSES & LIGHTPIPES

VCC LSS Series Moisture-Sealed Litepipes® provide a display panel moisture seal and 180° viewing angle with VCC's SMS 172 Series panel lens. Panel assembly is easily accomplished by slipping the unit through a .171" panel opening, sliding the retaining ring over the Litepipe® barrel, and pressing the ring on while holding the lens surface tightly against the panel. The gasket is compressed as the ring is forced into place against the rear of the panel.

Features:

- LED Size: 3mm
- Mounting Hole: 0.171 in.
- Diameter: 4.91mm



SMS Series Sealed Lenses

For quantities greater than listed, call for quote.

MOUSER STOCK NO.	VCC Part No.	Color	Height (mm)	Price Each			
				1	10	100	500
593-SMS172ATP	SMS172ATP	Amber	6.86	.60	.52	.47	.37
593-SMS172BTP	SMS172BTP	Blue	6.86	.60	.52	.47	.37
593-SMS172CTP	SMS172CTP	Clear	6.86	.60	.52	.47	.37
593-SMS172GTP	SMS172GTP	Green	6.86	.60	.52	.47	.37
593-SMS172RTP	SMS172RTP	Red	6.86	.60	.52	.47	.37
593-SMS172YTP	SMS172YTP	Yellow	6.86	.60	.52	.47	.37

LSS Series Lightpipes

For quantities greater than listed, call for quote.

MOUSER STOCK NO.	VCC Part No.	Color	Length (in.)	Price Each			
				1	10	100	500
593-LSS024CTP	LSS024CTP	Clear	0.24	1.98	1.85	1.73	1.42
593-LSS024GTP	LSS024GTP	Green	0.24	1.98	1.85	1.73	1.42
593-LSS024RTP	LSS024RTP	Red	0.24	1.98	1.85	1.73	1.42
593-LSS044CTP	LSS044CTP	Clear	0.44	1.98	1.85	1.73	1.42
593-LSS044GTP	LSS044GTP	Green	0.44	1.98	1.85	1.73	1.42
593-LSS044RTP	LSS044RTP	Red	0.44	1.98	1.85	1.73	1.42
593-LSS064CTP	LSS064CTP	Clear	0.64	1.98	1.85	1.73	1.42
593-LSS064GTP	LSS064GTP	Green	0.64	1.98	1.85	1.73	1.42
593-LSS064RTP	LSS064RTP	Red	0.64	1.98	1.85	1.73	1.42
593-LSS084CTP	LSS084CTP	Clear	0.84	1.98	1.85	1.73	1.42
593-LSS084GTP	LSS084GTP	Green	0.84	1.98	1.85	1.73	1.42
593-LSS084RTP	LSS084RTP	Red	0.84	1.98	1.85	1.73	1.42
593-LSS104CTP	LSS104CTP	Clear	1.04	1.98	1.85	1.73	1.42
593-LSS104GTP	LSS104GTP	Green	1.04	1.98	1.85	1.73	1.42
593-LSS104RTP	LSS104RTP	Red	1.04	1.98	1.85	1.73	1.42
593-LSS124CTP	LSS124CTP	Clear	1.24	1.98	1.85	1.73	1.42
593-LSS124GTP	LSS124GTP	Green	1.24	1.98	1.85	1.73	1.42
593-LSS124RTP	LSS124RTP	Red	1.24	1.98	1.85	1.73	1.42