

JOHNSON COMPONENTS RF Connectors & Adaptors Johnson

Connectivity Solutions

EMERSON Network Power

RoHS Compliant This product is RoHS compliant.

MCX CONNECTORS

- Impedance: 50Ω
- Connector Bodies: Machined Brass
- Body Plating: Gold or Nickel
- Durability: 500 Cycles minimum
- Frequency Range: 0-6.0 GHz for Flexible Cable Types
- Insulators: PTFE Fluorocarbon
- Temperature Range: -65°C to +165°C; Meets or exceeds MIL-C-39012
- Contact Plating: Gold

For quantities greater than listed, call for quote.

MOUSER STOCK NO.	Johnson Components Part No.	Fig.	Plating	Description / Cable Type	Price Each			
					1	10	25	100
Straight Plug - Flexible Cable								
530-133-3403-001	133-3403-001	A	Gold	RG-188/U, 316, 161, 174 - Captivated Contact	4.32	3.33	2.93	2.60
Right Angle Plugs - Flexible Cable								
530-133-3402-101	133-3402-101	B	Gold	RG-178/U, 196 - Captivated Contact	4.90	4.30	3.68	3.45
530-133-3403-101	133-3403-101	B	Gold	RG-188/U, 316, 161, 174 - Captivated Contact	4.99	4.26	3.91	3.60
530-133-3403-106	133-3403-106	B	Nickel	RG-188/U, 316, 161, 174 - Captivated Contact	3.19	2.96	2.42	2.10
Vertical PCB Jacks								
530-133-3701-201	133-3701-201	C	Gold	.155" Legs, .236" Square Base	5.48	4.44	4.04	3.55
530-133-3701-211	133-3701-211	C	Gold	.110" Legs, .236" Square Base	3.78	2.99	2.71	2.32
530-133-3701-216	133-3701-216	C	Nickel	.110" Legs, .236" Square Base	5.02	4.41	3.77	3.25
530-133-3701-231	133.3701-231	D	Gold	.155" Legs, .188" Diameter Round Base	5.11	4.40	3.78	3.29
530-133-3711-201	133-3711-201	E	Gold	.236" Square Base	4.41	3.72	3.47	3.20
Right Angle PCB Jacks								
530-133-3701-301	133-3701-301	F	Gold	.155" Legs, .236" Square Base	8.34	7.31	6.72	6.48
530-133-3701-306	133-3701-306	F	Nickel	.155" Legs, .236" Square Base	10.32	9.49	9.15	8.72
530-133-3701-311	133-3701-311	F	Gold	.110" Legs, .236" Square Base	8.88	7.78	6.69	6.22
530-133-3711-301	133-3711-301	G	Gold	.236" Square Base	9.08	8.13	6.99	6.32
End Launch Jacks								
530-133-3701-801	133-3701-801	H	Gold	.062" Board Thickness, .250" Sq. Mnt. Rnd Cont.	4.45	3.97	3.66	3.28
530-133-3711-801	133-3711-801	I	Gold	Surface Mount, Round Contact	5.85	5.51	4.94	4.41

MMCX CONNECTORS

- Impedance: 50Ω
- Connector Body: Brass
- Temperature Range: -65°C to 165°C
- Frequency Range: 0-6GHz
- Durability: 500 Cycles Minimum

For quantities greater than listed, call for quote.

MOUSER STOCK NO.	Johnson Components Part No.	Fig.	Plating	Description / Cable Type	Price Each		
					1	10	25
530-135-3402-001	135-3402-001	J	Gold	Straight Plug for RG-178/U, 196	6.46	5.31	4.58
530-135-3403-001	135-3403-001	J	Gold	Straight Plug for RG-316/U, 188, 161, 174	9.62	8.33	7.14
530-135-3402-101	135-3402-101	K	Gold	Right Angle Plug for RG-178/U, 196	10.56	9.82	8.90
530-135-3403-101	135-3403-101	K	Gold	Right Angle Plug for RG-316/U, 188, 161, 174	8.01	6.79	6.15
530-135-3701-201	135-3701-201	L	Gold	Vertical PCB Jack, .115" legs	4.25	3.53	3.19
530-135-3701-211	135-3701-211	L	Gold	Vertical PCB Jack, .068" legs	4.72	4.23	4.09
530-135-3711-201	135-3711-201	M	Gold	Surface Mount Vertical Jack, .030" legs	5.56	4.65	4.08
530-135-3701-301	135-3701-301	N	Gold	Right Angle PCB Jack, .115" legs	9.47	8.49	7.12
530-135-3701-311	135-3701-311	N	Gold	Right Angle PCB Jack, .068" legs	8.24	7.49	6.44
530-135-3711-801	135-3711-801	O	Gold	End Launch Surface Mount Jack	3.76	3.46	3.20

MMCX CONNECTOR TOOLING

For quantities greater than listed, call for quote.

MOUSER STOCK NO.	Johnson Components Part No.	Fig.	Description	Price Each	
				1	5
530-140-0000-952	140-0000-952	P	Economy Hand Crimp Tool (Frame Only)	101.55	91.13
530-140-0000-953	140-0000-953	--	Die Set for Crimp Tool (RG178, 316/DS)	211.33	189.65

IN-SERIES AND BETWEEN SERIES ADAPTERS

- Connector Body: Brass
- Body Plating: Gold
- Durability: 500 Cycles Minimum
- Temperature Range: -65°C to 165°C

For quantities greater than listed, call for quote.

MOUSER STOCK NO.	Johnson Components Part No.	Fig.	Description	Frequency Range	Price Each	
					1	10
530-142-0901-801	142-0901-801	Q	SMA Jack to SMA Jack	0-18GHz	8.89	7.87
530-142-0901-401	142-0901-401	R	SMA Jack to SMA Jack (Bulkhead Type)	0-18GHz	14.12	12.13
530-142-0901-941	142-0901-941	S	SMA Jack to SMA Plug (Right Angle)	0-18GHz	13.63	11.45
530-134-1012-011	134-1012-011	T	SMA Plug to SMB Jack	0-4GHz	39.09	33.88
530-134-1012-041	134-1012-041	U	SMA Jack to SMB Plug	0-4GHz	36.31	32.32
530-134-1018-021	134-1018-021	V	SMA Jack to MCX Jack	0-6GHz	37.22	34.56

IN-SERIES AND BETWEEN SERIES ADAPTER KIT

For quantities greater than listed, call for quote.

MOUSER STOCK NO.	Johnson Components Part No.	Description	Price Each	
			1	2
530-142-0000-005	142-0000-005	72 Piece Adapter Kit (SMA, BNC, RCA, AND N Types)	458.33	343.75

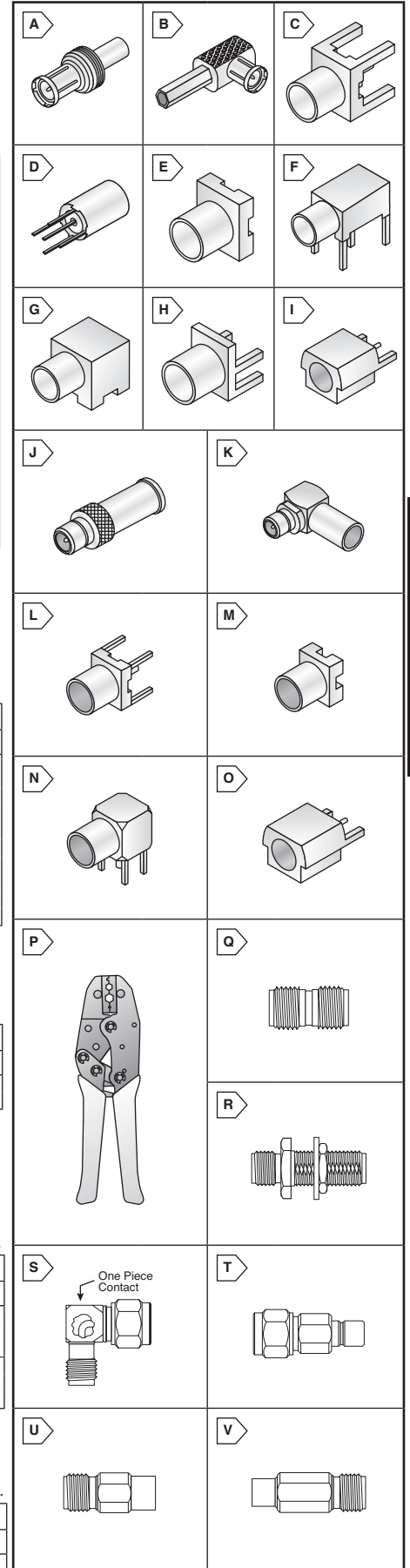

RF Connectors

Johnson Components