

SUMIDA Power Inductors



This product is RoHS compliant.



CDRH127 SERIES

CDRH127 series are SMD power inductors with electrodes directly attached to the ferrite core. EMI Shielding is used to minimize crosstalk interference.

For quantities greater than listed, call for quote.

MOUSER STOCK NO.	Sumida Part No.	Value (μH)	Current (A)	Price Each			
				1	10	100	500
851-CDRH127NP-4R7NC	CDRH127NP-4R7NC	4.7	6.8	3.05	2.78	2.07	1.75
851-CDRH127NP-6R1NC	CDRH127NP-6R1NC	6.1	6.6	3.05	2.78	2.07	1.75
851-CDRH127NP-7R6NC	CDRH127NP-7R6NC	7.6	5.9	3.05	2.78	2.07	1.75
851-CDRH127NP-100MC	CDRH127NP-100MC	10	5.4	3.05	2.78	2.07	1.75
851-CDRH127NP-150MC	CDRH127NP-150MC	15	4.5	3.05	2.78	2.07	1.75
851-CDRH127NP-220MC	CDRH127NP-220MC	22	3.6	3.05	2.78	2.07	1.75
851-CDRH127NP-270MC	CDRH127NP-270MC	27	3.4	3.05	2.78	2.07	1.75
851-CDRH127NP-330MC	CDRH127NP-330MC	33	3	3.05	2.78	2.07	1.75
851-CDRH127NP-390MC	CDRH127NP-390MC	39	2.75	3.05	2.78	2.07	1.75
851-CDRH127NP-470MC	CDRH127NP-470MC	47	2.5	3.05	2.78	2.07	1.75
851-CDRH127NP-560MC	CDRH127NP-560MC	56	2.35	3.05	2.78	2.07	1.75
851-CDRH127NP-680MC	CDRH127NP-680MC	68	2.1	3.05	2.78	2.07	1.75
851-CDRH127NP-101MC	CDRH127NP-101MC	100	1.7	3.05	2.78	2.07	1.75
851-CDRH127NP-102MC	CDRH127NP-102MC	1000	0.55	3.05	2.78	2.07	1.75

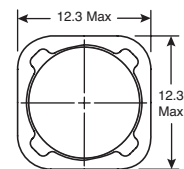

DIMENSIONS: mm

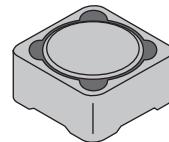
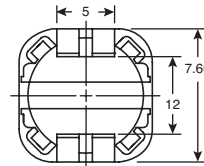
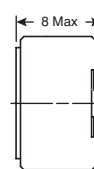

CDRH127L SERIES

Specifications:

- Ferrite drum core construction
- Magnetically shielded
- Moisture Sensitivity Level: 1
- Halogen Free available
- Operating temperature range: -40°C to 125°C
- Solder reflow temperature: 260°C peak



For quantities greater than listed, call for quote.

MOUSER STOCK NO.	Sumida Part No.	Value (μH)	Current (A)	Inductance Tolerance	Price Each			
					1	10	100	500
851-CDRH127L125NP100	CDRH127L125NP-100MC	10	6.6	±20%	.92	.90	.63	.62
851-CDRH127L125NP470	CDRH127L125NP-470MC	47	3.15	±20%	.92	.90	.63	.62
851-CDRH127L125NP4R7	CDRH127L125NP-4R7MC	4.7	12.3	±30%	.92	.90	.63	.62
851-CDRH127L125NP4R7	CDRH127L125NP-4R7NC	4.7	12.3	±30%	.92	.90	.63	.62
851-CDRH127L125NP220	CDRH127L125NP-220MC	22	4.4	±20%	.92	.90	.63	.62

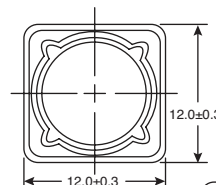

DIMENSIONS: mm

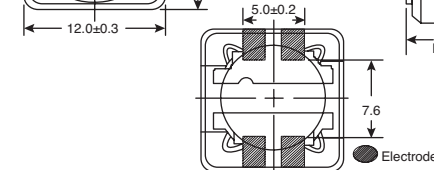
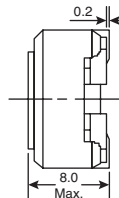

Electrode

CDRH127LD SERIES

CDRH127LD is a low DCR direct drop-in version of Sumida's most popular series, the CDRH127 series. EMI Shielding is used to minimize crosstalk interference.

For quantities greater than listed, call for quote.

MOUSER STOCK NO.	Sumida Part No.	Value (μH)	Current (A)	Price Each			
				1	10	100	500
851-CDRH127LDNP2R4NC	CDRH127LDNP-2R4NC	2.4	10.3	3.05	2.78	2.07	1.75
851-CDRH127LDNP100MC	CDRH127LDNP-100MC	10	6.7	3.05	2.78	2.07	1.75
851-CDRH127LDNP120MC	CDRH127LDNP-120MC	12	6.45	3.05	2.78	2.07	1.75
851-CDRH127LDNP150MC	CDRH127LDNP-150MC	15	5.65	3.05	2.78	2.07	1.75
851-CDRH127LDNP180MC	CDRH127LDNP-180MC	18	5.1	3.05	2.78	2.07	1.75
851-CDRH127LDNP220MC	CDRH127LDNP-220MC	22	4.7	3.05	2.78	2.07	1.75
851-CDRH127LDNP270MC	CDRH127LDNP-270MC	27	4.2	3.05	2.78	2.07	1.75
851-CDRH127LDNP330MC	CDRH127LDNP-330MC	33	3.9	3.05	2.78	2.07	1.75
851-CDRH127LDNP390MC	CDRH127LDNP-390MC	39	3.5	3.05	2.78	2.07	1.75
851-CDRH127LDNP470MC	CDRH127LDNP-470MC	47	3.25	3.05	2.78	2.07	1.75
851-CDRH127LDNP680MC	CDRH127LDNP-680MC	68	2.6	3.05	2.78	2.07	1.75
851-CDRH127LDNP820MC	CDRH127LDNP-820MC	82	2.4	3.05	2.78	2.07	1.75
851-CDRH127LDNP101MC	CDRH127LDNP-101MC	100	2.1	3.05	2.78	2.07	1.75
851-CDRH127LDNP151MC	CDRH127LDNP-151MC	150	1.8	3.05	2.78	2.07	1.75
851-CDRH127LDNP221MC	CDRH127LDNP-221MC	220	1.45	3.05	2.78	2.07	1.75
851-CDRH127LDNP331MC	CDRH127LDNP-331MC	330	1.2	3.05	2.78	2.07	1.75
851-CDRH127LDNP471MC	CDRH127LDNP-471MC	470	1	3.05	2.78	2.07	1.75
851-CDRH127LDNP681MC	CDRH127LDNP-681MC	680	0.85	3.05	2.78	2.07	1.75
851-CDRH127LDNP102MC	CDRH127LDNP-102MC	1000	0.7	3.05	2.78	2.07	1.75

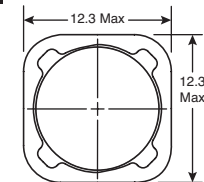

DIMENSIONS: mm

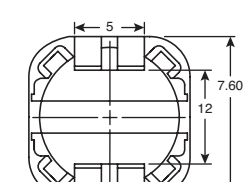
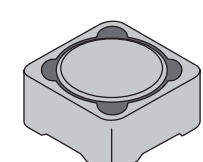
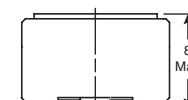

CDRH12D58A SERIES

Specifications:

- Ferrite drum core construction
- Magnetically shielded
- Moisture Sensitivity Level: 1
- Operating temperature range: -40°C to 155°C
- Solder reflow temperature: 260°C peak



For quantities greater than listed, call for quote.

MOUSER STOCK NO.	Sumida Part No.	Value (μH)	Current (A)	Inductance Tolerance	Price Each			
					1	10	100	500
851-CDRH12D58/ANP470	CDRH12D58/ANP-470MC	47	1.8	±20%	.97	.95	.67	.66

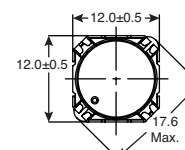

DIMENSIONS: mm

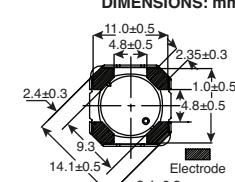

Electrode

CDRH12D78A SERIES

Specifications:

- Ferrite drum core construction
- Magnetically shielded
- Moisture Sensitivity Level: 1
- Operating temperature range: -40°C to 155°C
- Solder reflow temperature: 260°C peak



For quantities greater than listed, call for quote.

MOUSER STOCK NO.	Sumida Part No.	Value (μH)	Current (A)	Inductance Tolerance	Price Each			
					1	10	100	500
851-CDRH12D78/ANP100	CDRH12D78/ANP-100MC	10	4.2	±20%	1.47	1.43	1.00	.99
851-CDRH12D78/ANP150	CDRH12D78/ANP-150MC	15	3.7	±20%	1.47	1.43	1.00	.99
851-CDRH12D78/ANP220	CDRH12D78/ANP-220MC	22	2.9	±20%	1.47	1.43	1.00	.99
851-CDRH12D78/ANP470	CDRH12D78/ANP-470MC	47	2.1	±20%	1.47	1.43	1.00	.99

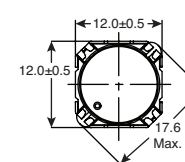

DIMENSIONS: mm

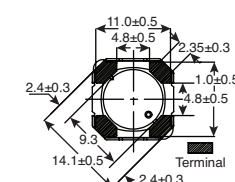
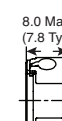

Terminal