

PANASONIC Fixed Inductors



RoHS Compliant This product is RoHS compliant.

ELL-ATV SERIES - SMD CHOKE COILS

Applications:

- DC-DC converter circuitry for computer peripherals and cellular phones
- Chopper circuit decoupling chokes for DC-DC converter circuitry

Features:

- Magnetically shielded structure
- Low DC resistance and large current capability
- Available on tape and reel for automatic insertion

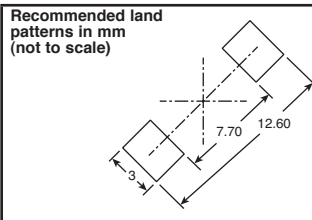

DIMENSIONS: mm (not to scale)

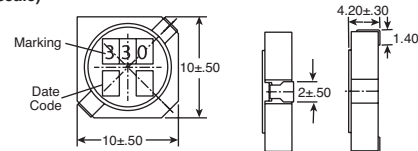

For quantities greater than listed, call for quote.

| MOUSER STOCK NO. | Panasonic Part No. | Value (μF) | Tolerance | DCR (mΩ) | Isat (mA max.) | Price Each | | | Reel Quantity | Price Each |
|------------------|--------------------|------------|-----------|----------|----------------|------------|------|------|---------------|------------|
| | | | | | | 1 | 25 | 100 | | |
| 667-ELL-ATV1R5N | ELL-ATV1R5N | 1.5 | ±30% | 5.3 | 6700 | 1.66 | 1.54 | 1.15 | 500 | .709 |
| 667-ELL-ATV2R2N | ELL-ATV2R2N | 2.2 | ±30% | 6.3 | 6200 | 1.66 | 1.54 | 1.15 | 500 | .709 |
| 667-ELL-ATV3R3N | ELL-ATV3R3N | 3.3 | ±30% | 8.8 | 5350 | 1.66 | 1.54 | 1.15 | 500 | .709 |
| 667-ELL-ATV4R3N | ELL-ATV4R3N | 4.3 | ±30% | 10 | 5000 | 1.66 | 1.54 | 1.15 | 500 | .709 |
| 667-ELL-ATV5R1N | ELL-ATV5R1N | 5.1 | ±30% | 14 | 4350 | 1.66 | 1.54 | 1.15 | 500 | .709 |
| 667-ELL-ATV6R8N | ELL-ATV6R8N | 6.8 | ±30% | 16 | 4000 | 1.66 | 1.54 | 1.15 | 500 | .709 |
| 667-ELL-ATV8R2N | ELL-ATV8R2N | 8.2 | ±30% | 18 | 3700 | 1.66 | 1.54 | 1.15 | 500 | .709 |
| 667-ELL-ATV100M | ELL-ATV100M | 10 | ±20% | 23 | 3300 | 1.66 | 1.54 | 1.15 | 500 | .709 |
| 667-ELL-ATV120M | ELL-ATV120M | 12 | ±20% | 25 | 2900 | 1.66 | 1.54 | 1.15 | 500 | .709 |
| 667-ELL-ATV150M | ELL-ATV150M | 15 | ±20% | 32 | 2800 | 1.66 | 1.54 | 1.15 | 500 | .709 |
| 667-ELL-ATV180M | ELL-ATV180M | 18 | ±20% | 38 | 2500 | 1.66 | 1.54 | 1.15 | 500 | .709 |
| 667-ELL-ATV220M | ELL-ATV220M | 22 | ±20% | 45 | 2200 | 1.66 | 1.54 | 1.15 | 500 | .709 |
| 667-ELL-ATV270M | ELL-ATV270M | 27 | ±20% | 56 | 2000 | 1.66 | 1.54 | 1.15 | 500 | .709 |
| 667-ELL-ATV330M | ELL-ATV330M | 33 | ±20% | 62 | 1800 | 1.66 | 1.54 | 1.15 | 500 | .709 |
| 667-ELL-ATV390M | ELL-ATV390M | 39 | ±20% | 74 | 1600 | 1.66 | 1.54 | 1.15 | 500 | .709 |
| 667-ELL-ATV470M | ELL-ATV470M | 47 | ±20% | 94 | 1550 | 1.66 | 1.54 | 1.15 | 500 | .709 |
| 667-ELL-ATV560M | ELL-ATV560M | 56 | ±20% | 100 | 1350 | 1.66 | 1.54 | 1.15 | 500 | .709 |
| 667-ELL-ATV680M | ELL-ATV680M | 68 | ±20% | 130 | 1200 | 1.66 | 1.54 | 1.15 | 500 | .709 |
| 667-ELL-ATV820M | ELL-ATV820M | 82 | ±20% | 150 | 1100 | 1.66 | 1.54 | 1.15 | 500 | .709 |
| 667-ELL-ATV101M | ELL-ATV101M | 100 | ±20% | 180 | 1000 | 1.66 | 1.54 | 1.15 | 500 | .709 |
| 667-ELL-ATV121M | ELL-ATV121M | 120 | ±20% | 190 | 840 | 1.66 | 1.54 | 1.15 | 500 | .709 |
| 667-ELL-ATV151M | ELL-ATV151M | 150 | ±20% | 250 | 780 | 1.66 | 1.54 | 1.15 | 500 | .709 |
| 667-ELL-ATV181M | ELL-ATV181M | 180 | ±20% | 320 | 750 | 1.66 | 1.54 | 1.15 | 500 | .709 |
| 667-ELL-ATV221M | ELL-ATV221M | 220 | ±20% | 360 | 700 | 1.66 | 1.54 | 1.15 | 500 | .709 |
| 667-ELL-ATV271M | ELL-ATV271M | 270 | ±20% | 460 | 600 | 1.66 | 1.54 | 1.15 | 500 | .709 |
| 667-ELL-ATV331M | ELL-ATV331M | 330 | ±20% | 550 | 550 | 1.66 | 1.54 | 1.15 | 500 | .709 |
| 667-ELL-ATV391M | ELL-ATV391M | 390 | ±20% | 690 | 520 | 1.66 | 1.54 | 1.15 | 500 | .709 |
| 667-ELL-ATV471M | ELL-ATV471M | 470 | ±20% | 780 | 470 | 1.66 | 1.54 | 1.15 | 500 | .709 |
| 667-ELL-ATV561M | ELL-ATV561M | 560 | ±20% | 820 | 390 | 1.66 | 1.54 | 1.15 | 500 | .709 |
| 667-ELL-ATV681M | ELL-ATV681M | 680 | ±20% | 1150 | 370 | 1.66 | 1.54 | 1.15 | 500 | .709 |
| 667-ELL-ATV821M | ELL-ATV821M | 820 | ±20% | 1270 | 340 | 1.66 | 1.54 | 1.15 | 500 | .709 |
| 667-ELL-ATV102M | ELL-ATV102M | 1000 | ±20% | 1750 | 320 | 1.66 | 1.54 | 1.15 | 500 | .709 |

Inductors

Panasonic

ELL-CTV SERIES - SMD CHOKE COILS

Applications:

- DC-DC converter circuitry for computer peripherals and cellular phones
- Chopper circuit decoupling chokes for DC-DC converter circuitry

Features:

- Magnetically shielded structure
- Low DC resistance and large current capability
- Available on tape and reel for automatic insertion

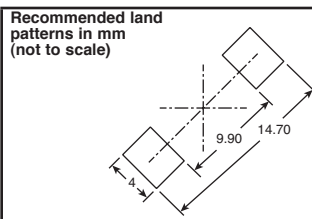

DIMENSIONS: mm (not to scale)

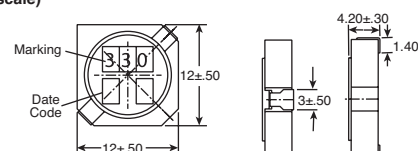

For quantities greater than listed, call for quote.

| MOUSER STOCK NO. | Panasonic Part No. | Value (μF) | Tolerance | DCR (mΩ) | Isat (mA max.) | Price Each | | | Reel Quantity | Price Each |
|------------------|--------------------|------------|-----------|----------|----------------|------------|------|------|---------------|------------|
| | | | | | | 1 | 25 | 100 | | |
| 667-ELL-CTV1R2N | ELL-CTV1R2N | 1.2 | ±30% | 4.6 | 6,500 | 1.74 | 1.62 | 1.21 | 500 | .746 |
| 667-ELL-CTV2R0N | ELL-CTV2R0N | 2 | ±30% | 5.6 | 6,300 | 1.74 | 1.62 | 1.21 | 500 | .746 |
| 667-ELL-CTV2R7N | ELL-CTV2R7N | 2.7 | ±30% | 7 | 5,700 | 1.74 | 1.62 | 1.21 | 500 | .746 |
| 667-ELL-CTV3R9N | ELL-CTV3R9N | 3.9 | ±30% | 8.5 | 5,600 | 1.74 | 1.62 | 1.21 | 500 | .746 |
| 667-ELL-CTV4R7N | ELL-CTV4R7N | 4.7 | ±30% | 9.9 | 5,200 | 1.74 | 1.62 | 1.21 | 500 | .746 |
| 667-ELL-CTV5R6N | ELL-CTV5R6N | 5.6 | ±30% | 11 | 4,900 | 1.74 | 1.62 | 1.21 | 500 | .746 |
| 667-ELL-CTV6R8N | ELL-CTV6R8N | 6.8 | ±30% | 14 | 4,500 | 1.74 | 1.62 | 1.21 | 500 | .746 |
| 667-ELL-CTV8R2N | ELL-CTV8R2N | 8.2 | ±30% | 15 | 4,400 | 1.74 | 1.62 | 1.21 | 500 | .746 |
| 667-ELL-CTV100M | ELL-CTV100M | 10 | ±20% | 17 | 3,900 | 1.74 | 1.62 | 1.21 | 500 | .746 |
| 667-ELL-CTV120M | ELL-CTV120M | 12 | ±20% | 22 | 3,700 | 1.74 | 1.62 | 1.21 | 500 | .746 |
| 667-ELL-CTV150M | ELL-CTV150M | 15 | ±20% | 25 | 3,100 | 1.74 | 1.62 | 1.21 | 500 | .746 |
| 667-ELL-CTV180M | ELL-CTV180M | 18 | ±20% | 30 | 3,000 | 1.74 | 1.62 | 1.21 | 500 | .746 |
| 667-ELL-CTV220M | ELL-CTV220M | 22 | ±20% | 37 | 2,700 | 1.74 | 1.62 | 1.21 | 500 | .746 |
| 667-ELL-CTV270M | ELL-CTV270M | 27 | ±20% | 43 | 2,300 | 1.74 | 1.62 | 1.21 | 500 | .746 |
| 667-ELL-CTV330M | ELL-CTV330M | 33 | ±20% | 50 | 2,200 | 1.74 | 1.62 | 1.21 | 500 | .746 |
| 667-ELL-CTV390M | ELL-CTV390M | 39 | ±20% | 61 | 2,100 | 1.74 | 1.62 | 1.21 | 500 | .746 |
| 667-ELL-CTV470M | ELL-CTV470M | 47 | ±20% | 69 | 1,900 | 1.74 | 1.62 | 1.21 | 500 | .746 |
| 667-ELL-CTV560M | ELL-CTV560M | 56 | ±20% | 87 | 1,600 | 1.74 | 1.62 | 1.21 | 500 | .746 |
| 667-ELL-CTV680M | ELL-CTV680M | 68 | ±20% | 100 | 1,500 | 1.74 | 1.62 | 1.21 | 500 | .746 |
| 667-ELL-CTV820M | ELL-CTV820M | 82 | ±20% | 120 | 1,400 | 1.74 | 1.62 | 1.21 | 500 | .746 |
| 667-ELL-CTV101M | ELL-CTV101M | 100 | ±20% | 150 | 1,200 | 1.74 | 1.62 | 1.21 | 500 | .746 |
| 667-ELL-CTV121M | ELL-CTV121M | 120 | ±20% | 190 | 1,100 | 1.74 | 1.62 | 1.21 | 500 | .746 |
| 667-ELL-CTV151M | ELL-CTV151M | 150 | ±20% | 220 | 1,000 | 1.74 | 1.62 | 1.21 | 500 | .746 |
| 667-ELL-CTV181M | ELL-CTV181M | 180 | ±20% | 270 | 930 | 1.74 | 1.62 | 1.21 | 500 | .746 |
| 667-ELL-CTV221M | ELL-CTV221M | 220 | ±20% | 310 | 840 | 1.74 | 1.62 | 1.21 | 500 | .746 |
| 667-ELL-CTV271M | ELL-CTV271M | 270 | ±20% | 400 | 810 | 1.74 | 1.62 | 1.21 | 500 | .746 |
| 667-ELL-CTV331M | ELL-CTV331M | 330 | ±20% | 500 | 660 | 1.74 | 1.62 | 1.21 | 500 | .746 |
| 667-ELL-CTV391M | ELL-CTV391M | 390 | ±20% | 560 | 630 | 1.74 | 1.62 | 1.21 | 500 | .746 |
| 667-ELL-CTV471M | ELL-CTV471M | 470 | ±20% | 690 | 580 | 1.74 | 1.62 | 1.21 | 500 | .746 |
| 667-ELL-CTV561M | ELL-CTV561M | 560 | ±20% | 810 | 540 | 1.74 | 1.62 | 1.21 | 500 | .746 |
| 667-ELL-CTV681M | ELL-CTV681M | 680 | ±20% | 1010 | 470 | 1.74 | 1.62 | 1.21 | 500 | .746 |
| 667-ELL-CTV821M | ELL-CTV821M | 820 | ±20% | 1140 | 440 | 1.74 | 1.62 | 1.21 | 500 | .746 |
| 667-ELL-CTV102M | ELL-CTV102M | 1000 | ±20% | 1500 | 410 | 1.74 | 1.62 | 1.21 | 500 | .746 |